

Model:E035

## Installation instructions of shower head

### Step 1

Twist the four screws, and put down the ss cover (keep the screws)

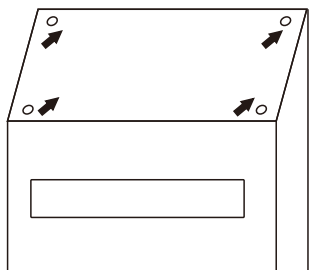

### Step 2

Twist the two screws, in the back top body. (keep the screws)

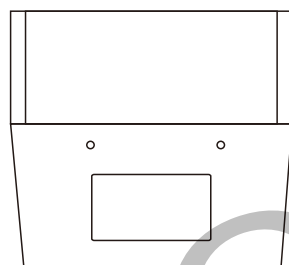

### Step 3

Inset the rainfall parts in to the inlet

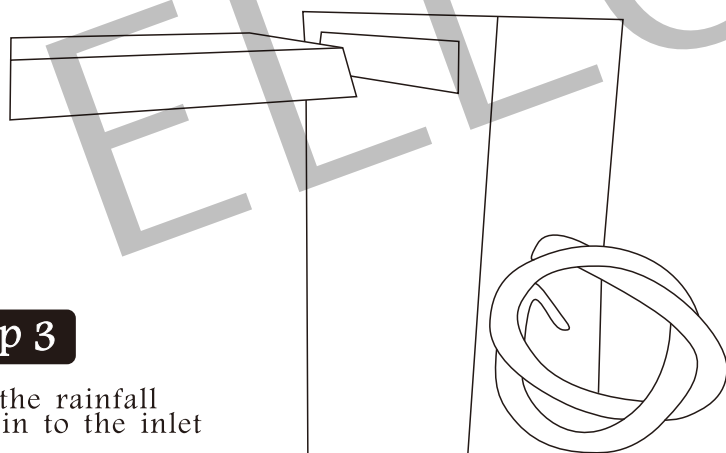

### Step 4

Connect the pipes

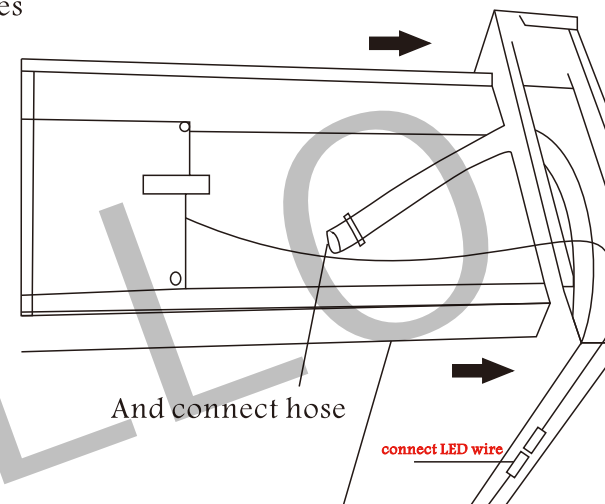

### Step 5

Hold on the rainfall parts with screws of two back top body.

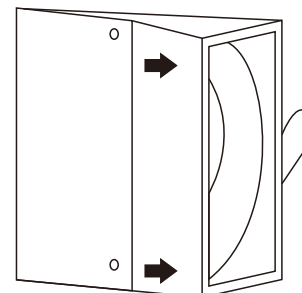

### Step 5

Put the ss cover on the top, then fix four the screws

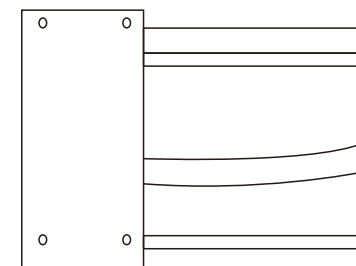

## Handwheel

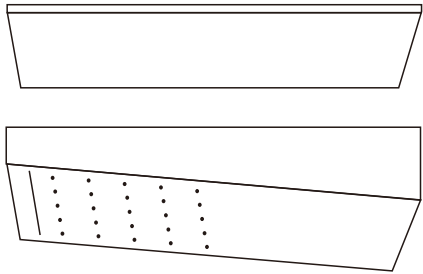

1. Take out the shower haed. And remove the cover.

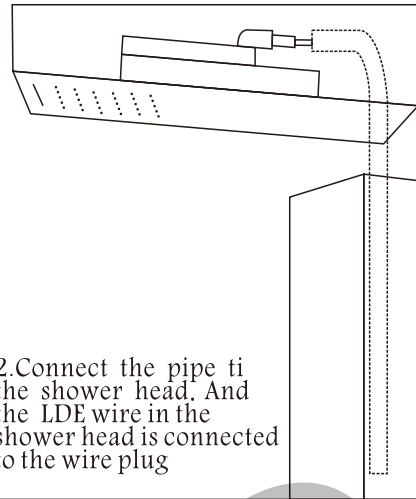

2. Connect the pipe ti the shower head. And the LDE wire in the shower head is connected to the wire plug

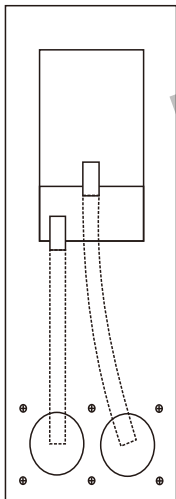

3. Tighten the screws with a screwdriver to complete the instation.



4. Finally put the cover in the shower head.

### Function Handwheel

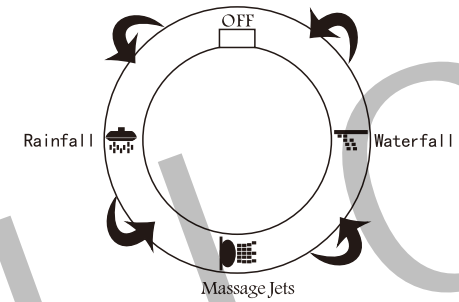

### Function Handwheel

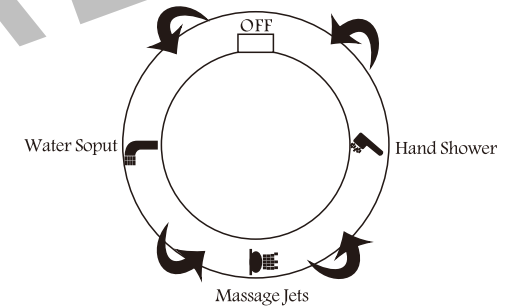

### Mixing Valve

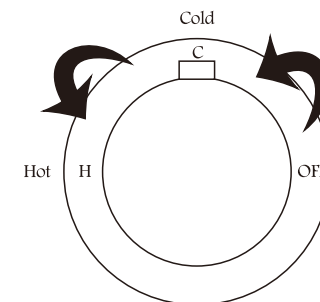

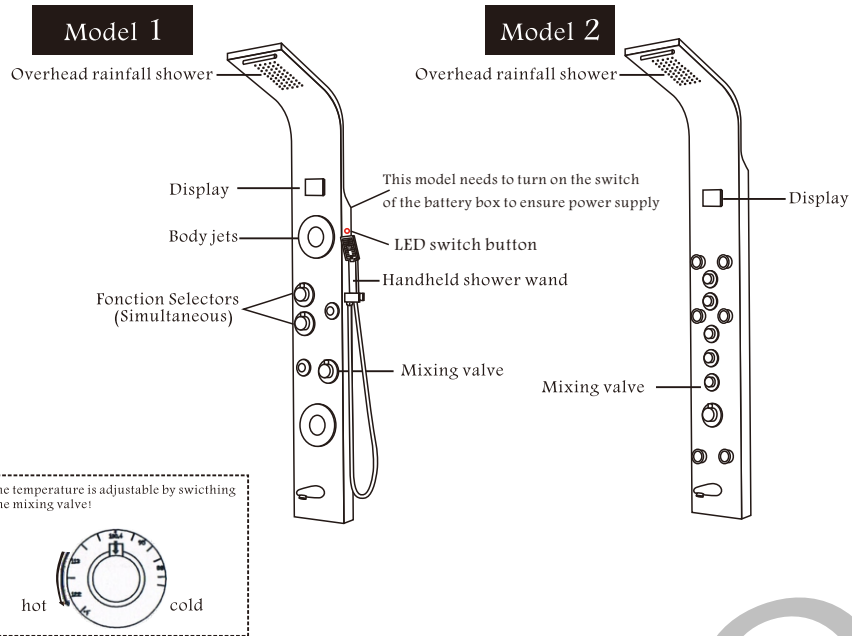

Note, the installation of the shower panel of different models is the same, only the appearance of the product is updated

### Read Before Using Your New Shower Panel

Congratulations on purchasing our Shower Panel. Your new shower panel will be a great addition to your bathroom for years to come. This manual will be your reference for installation, instructions for care of the shower panel, operation of the shower panel and for the benefits of using our Shower Panel.

Before using our Shower Panel, please read this document carefully and thoroughly.

The instructions and safety information in this document are essential to the safe operation of your new unit. Additionally, not adhering to the conditions regarding maintenance and installation in this document may affect your new product's warranty.

Our luxury Shower Panel brings a spa experience into your life in the comfort of your personal bathroom. Adding the shower panel as a modification to your present shower will allow you to enjoy the pleasures of massaging body spray jets, an overhead rain shower and a shower wand. Furthermore, the shower panel will operate with your existing plumbing supply lines with standard line pressure and flow rates.

### <Instructions for Installation >

Carefully read and follow the instructions in the following guidelines. If you fail to follow these recommended instructions and techniques for installation, you risk affecting the warranty claims for your product and causing damage to the unit and the surrounding area.

#### IMPORTANT:

In order to install this shower panel, simple understanding of plumbing techniques will be necessary. Please contact your dealer or a professional plumber if you are unfamiliar with plumbing techniques or have questions.

While determining the installation location for your new unit, we recommend you take into account the guidelines below. All installations are unique and these guidelines are general:

1. This shower panel is designed for indoor use ONLY. It is not intended for outdoor use or other uses.
2. We have provided flexible supply hoses. It is recommended that you consider installing individual cut off valves for the cold and hot water supplies.

Prior to installation, please make sure your package is complete and your unit is not damaged. Look over all of the unit's components. Check for damaged and broken components and sections. Contact your dealer or the manufacturer if you find damaged sections.

### Tools needed

Electric drill	Tape	Adjustable wrench	Pencil
Rubber hammer	Sealing strip	PH ⊕	PH ⊖
		Philips screwdriver	Flat screwdriver

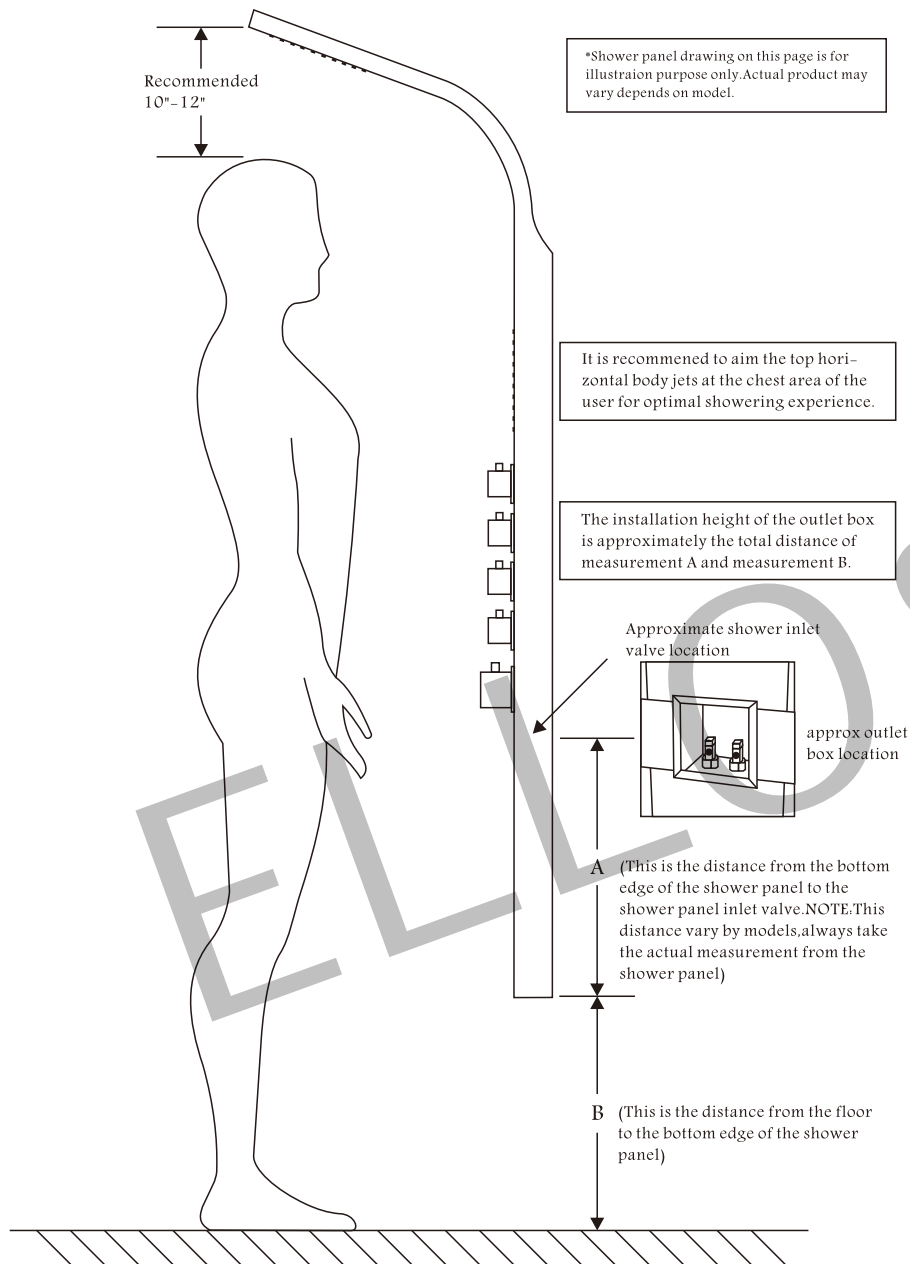

#### Plumbing Requirements:

- Flow rate: 2.5 gallons per minute (gpm)
- Water pressure: 60 to 80 psi for both cold and hot supply lines

You will have to speak with a plumber regarding the installation of a booster pump or enlarging your supply lines if your water supply is unable to meet the requirements above.

#### <Mounting the Brackets of the Shower Panel >

While mounting the brackets of your new shower panel, the following will influence your decision on which height to mount the unit at:

- It is recommended that the shower panel be mounted at a height that will make the unit accessible to people of varying heights. That way, various people in the home can enjoy the shower panel.
- A comparison between the height of the overhead rain shower to the body jets and the height of all of the people who will be using the shower panel.
- Whether or not the height you choose will allow the shower panel to completely cover up the connection points for the cold and hot water supplies. In order to determine your installation location of the shower panel, you will require the use of a tape measure and pencil (or some type of marking tool).

**IMPORTANT:** Check the condition of the wall and the electric wires before drilling!

#### STEPS:

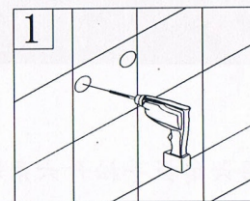

Hole on the wall

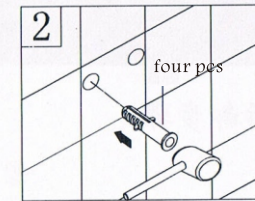

Place the wall anchors into the mounting holes.

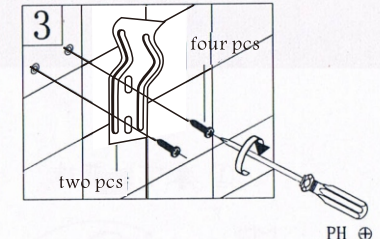

Put the screws through the holes of the brackets, and then tighten them with the screwdriver at the maximum as it can be.

## Steps for Mounting the Shower Panel

- a. Two mounting brackets are used in units with two single bar straps. (one will go on the top strap and one will go on the bottom strap.)
  - b. Determine the distance between the top and bottom strap. Determine the distance between the most outside measurement from the bottom of the top strap to the bottom of the shower panel. Mark them on the mounting wall. The distance between two straps can determine the mounting locations of two mounting brackets.
  - c. Hold one mounting bracket flat against the wall with the mounting holes over the mark indicating the bracket's location from the center line. The mounting holes must point towards the bottom of the shower.
  - d. You will have to line up this mounting bracket so that the bend in the bracket is on the horizontal line. Meanwhile, make sure the mounting holes are still centered on the mark you made for the bracket's location
  - e. Mark the two screwing holes location with the pencil.
  - f. Drill each hole location with 5/16" diameter drill bit.
- TIP: Pilot drill with a smaller drill bit before stepping up to the final size if your wall surface is prone to chipping and cracking.
- g. Place the wall anchors into the mounting holes you just drilled.
  - h. With a Phillips screwdriver, or a drill with a Phillips bit, attach the mounting brackets to the wall surface with the use of the provided screws.

## <Connect Your Shower Panel to Your Water Supply>

After installing the mounting brackets for your shower panel, the final water connections will be made.

1. You will find the input cold and hot water connections on the back of the shower panel. The cold connection is labeled with a blue/yellow sticker and the hot connection is labeled with a red sticker.
2. Connect each hose to the corresponding cold and hot water supplies. Tighten both hoses. **IMPORTANT:** Use the rubber washer included in your purchase.
3. Turn on each of the valves if you installed cut off valves on your supply line. Check for leaks in both the cold and hot water supply. If there are no leaks, you may move on to the next process in the installation.

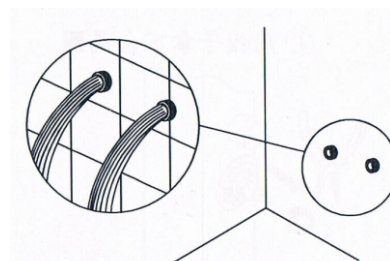

## IMPORTANT:

1. Before installing the shower panel, please clean the water supply valve with water for 5 minutes. Otherwise, it is very easy to block the generator and affect the work of LED lights and display.
2. Please make sure the hose does not twist when hanging the panel on the wall.

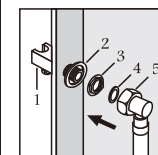

1. Install hand shower cradle (1) to the shower panel by installing the rubber washer (2) and the locking nut (3) and attach white plastic hose tube connector (5) with PVC tubing to complete the connection. (NOTE: Make sure the silicon gasket (4) is seated properly inside the connector.)

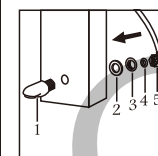

2. Connect the tub spout (1) to the shower panel with the rubber washer (2) and the locking nut (3) and attach plastic hose connector (5) with PVC tubing to complete the connection. (NOTE: Make sure the silicon gasket (4) is seated properly inside the connector.)

## <Hanging your Shower Panel>

– Make sure the water supply hoses are connected to the corresponding shut off valves – i.e. cold water hose to the cold water valve and hot water hose to the hot water valve. The mixing valve will not function properly if the hoses are installed incorrectly.

1. Put your shower panel on the wall surface with the mounting straps above the corresponding mounting brackets while making sure that the flexible supply lines are in the shower panel enclosure.
2. Slide the shower panel down. Stop when it rests on the mounting brackets you installed. The shower panel must be seated onto the mounting brackets by pulling down on the shower panel. You will have seated the unit on the mounting brackets properly after you feel a slight movement downward and the shower panel stops moving.
3. Before hanging the shower panel on the wall, turn on both shut-off valves and test all water functions on the shower panel and check for leaks at this point. You should have good water flow to the shower panel and full temperature control from the knobs.

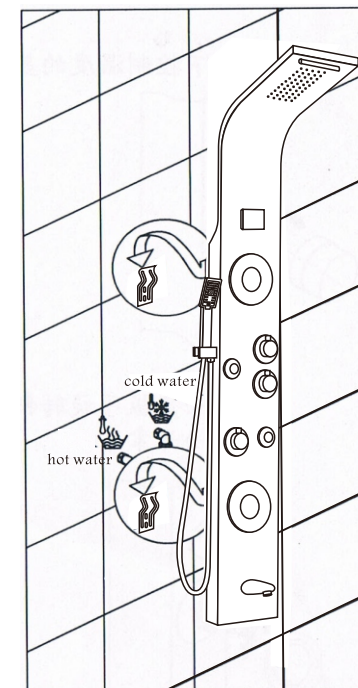

## IMPORTANT:

Abrasive cleaners should be never used on the shower panel unit. Mild, non-abrasive cleaners should be used to clean the shower panel unit.

If the led light does not work properly,  
please clean the water impurities in the generator.

① Fixed screw

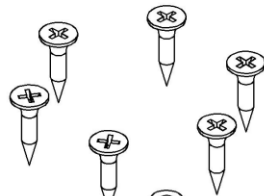

② On cover

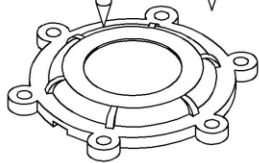

③ Magnet sleeve

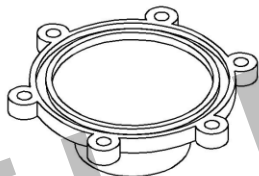

④ Impeller

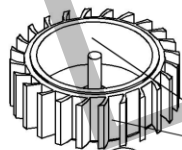

⑤ Under cover

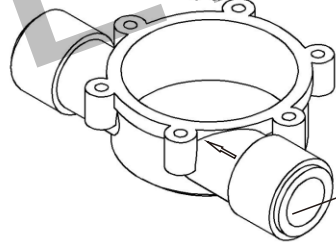

- (1)、 Loosen the screws
- (2)、 Take off the cover
- (3)、 Dial out magnet sleeve
- (4)、 Clean the inner ring of impeller  
And impeller with water.  
After cleaning, wipe the scale  
inside with the paper towel
- (5)、 After the cleaning is completed,  
the power will be assembled back
- (6) Take out the filter and clean  
the impurities

Find the location of the arrow and must be  
connected to the water inlet

The assembly and disassembly steps of shower panel.

Disassembly steps

1. Take of the blue sticker.

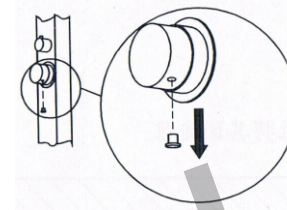

2. Loose the allen screw with the hexagon wrench.

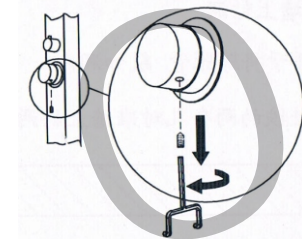

3. Take off the thermostatic valve cover.

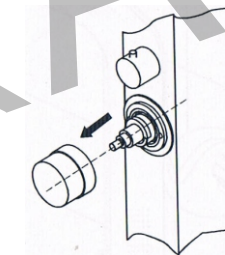

4. Take off the metal rim with the plier.

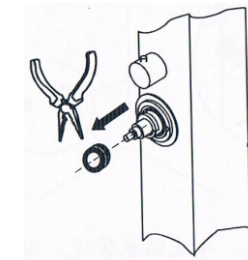

5. Use hexagon wrench loose the brass shifting ring and take it off.

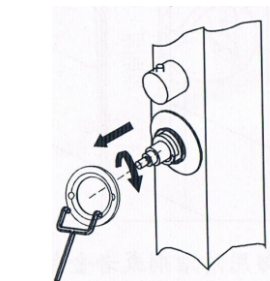

6. Take off the valve core and clean it.  
use soft brush clean the build-up of  
calcium, rust lime.

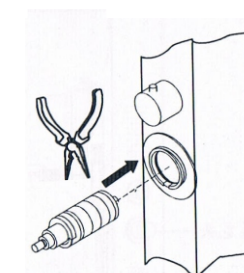

## The assembly and disassembly steps of shower panel.

### Assembly steps

1. Put the valve back into.

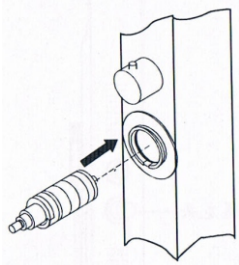

2. Put the brass rim onto the valve.

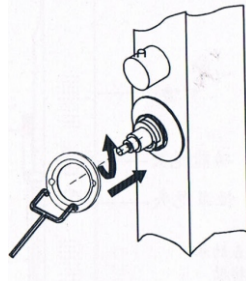

3. To put the metal ring back

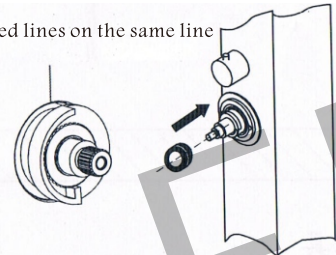

The red lines on the same line

4. Put the valve cover on.

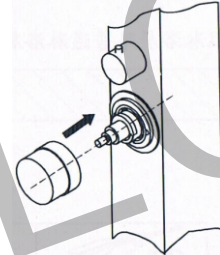

5. Use the hexagon wrench tighten the allen screw. 6. Put the red/blue sticker on.

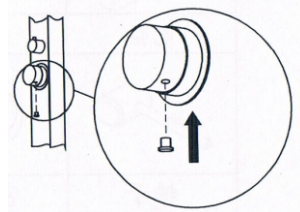
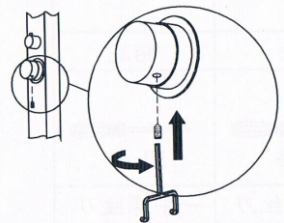

### <Mixing valve>

In order to improve the service life of the product. After the shower, turn the ALL handwheels to OFF. Must be turn the shower faucet (Cold and hot water mixing valve) handwheels to OFF.

### <Showerhead, Body Jets, Shower wand>

Set the diverter valve to the showerhead, body jets or shower wand setting, the water will start. Designate the water temperature you want with the thermostatic valve. Turn the diverter valve "off" when you are done showering.

### <How to fix the problems that you will meet while using your shower panel>

There is lack of water pressure to the showerhead, shower wand and body jets.

Solution. Any restriction in the water supply hoses will greatly reduce the performance of the shower panel. The first step is to make sure both shut-off valves are fully open. Secondly, check the water supply hoses for kinks. Due to limited space behind the shower panel, the hoses can get kinked very easily. Make sure the hoses are free of kinks when hanging the shower panel on the wall. Lastly, make sure your line pressure is at 60 to 80 PSI. If it is not, you may need to speak to a professional plumber to install a booster pump.

### Leaks:

Once you find any leaks, the connection fittings and hose clamp may be loose. Tighten them. Contact us or your dealer if the leak continues.

### Care and maintenance of your shower panel

Follow these instructions to ensure your luxury shower unit lasts long time and to keep the warranty intact. It is very important that you follow our proper maintenance instructions, so that your shower life will last longer. Any damages resulted by the improper care and maintenance will not be covered by the product warranty.

The showerhead and body jets may need to be cleaned occasionally due to the build-up of on the chemistry of your water.

Remove the showerhead and body jets before cleaning. Use the warm water and mild vinegar to soak the piece before cleaning it. Or you may need to use CLR or another hard water cleaner.

If you have any questions, please feel free to contact us.  
customer service: [elloallosshop@gmail.com](mailto:elloallosshop@gmail.com)