

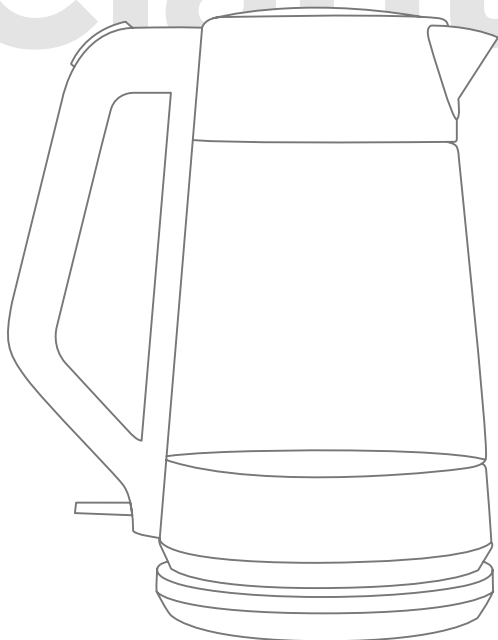

Clarity



**CORDLESS GLASS ELECTRIC KETTLE
INSTRUCTIONS FOR USE**



CONGRATULATIONS
on your new OXO On appliance!

Don't forget to register your product
at OXO.com/registration.aspx
for updates and other relevant information.

Although greatly appreciated, product registration is not required to activate any warranty.

Pure and Simple

They say a watched pot never boils, but with stainless steel construction and crystal-clear borosilicate glass, it will be hard to look away.

The Clarity Cordless Glass Electric Kettle provides peace of mind through thoughtful details like an auto shut-off safety feature and BPA-free borosilicate glass to provide thermal shock protection. The Kettle features a generous opening for easy filling and a comfortable handle for a secure grip that stays cool to the touch, as well as a soft-open lid that slowly releases steam and prevents splatter.

Cordless convenience and elegant design allow the Kettle to move seamlessly between kitchen and table. Whether you're creating a delicious cup of hot chocolate or serving afternoon tea, the OXO Clarity Kettle ensures a pure and enjoyable experience.

A Note About Safety.....	3	Troubleshooting & Descaling.....	10
Before We Begin.....	5	Cleaning, Care and Storage.....	11
Quick-Start Guide.....	6	Our Guarantee	12
Meet Your Kettle.....	7	Registration Info	12
The Particulars of Boiling Water....	9		

A Note About Safety



IMPORTANT SAFEGUARDS

Read all instructions.

When using electrical appliances, basic safety precautions should always be followed to reduce the risk of fire, electric shock, and/or injury to persons, including the following:

- **Read All Instructions.** Use this product only as described in this manual.
- Keep the packaging material (cardboard, plastic, etc.) out of the reach of children (danger of asphyxiation or injury).
- To protect against fire, electrical shock and injury to persons do not immerse cord, plugs or Kettle/base in water or other liquid.
- Always use the Kettle on a dry, level surface well away from the edge of any countertop.
- Do not leave the appliance unattended when in use.
- Do not operate any appliance with a damaged cord or plug, or after the appliance has malfunctioned or has been damaged in any way or is not operating properly. Contact OXO Customer Service at (800) 545-4411. **Do not return to store.**
- When using this appliance, provide adequate air space above and on all sides for circulation. Do not use under cabinetry.
- Do not overfill Kettle past the “MAX” fill line. Do not under-fill beneath the “MIN” line.
- Do not allow Kettle to boil dry.
- Do not place this appliance on or near a hot gas or electric burner, or where it could touch a heated oven.
- Do not touch hot surfaces, including the glass or metal areas on the Kettle or the inside of the base after use. Touch only the handle and on/off button.
- Handle the Kettle with care at all times. Do not use Kettle if it is cracked or handle is loose.
- Do not allow glass kettle to come in contact with hard or sharp material. The glass kettle is fragile and can break if dropped or struck with hard/sharp material.
- Take care to keep fingers, hair, clothing, and other objects clear while removing the Kettle from and returning it to the base.
- Do not let the cord hang over the edge of a table or counter where it can be pulled on by children or tripped over unintentionally. Do not let the cord hang over or touch hot surfaces or become knotted.
- The use of accessory attachments not recommended by the appliance manufacturer may result in fire, electric shock or personal injury.
- Close supervision is necessary when any appliance is used by or near children.
- Unplug from outlet when not in use and before cleaning. Allow to cool before putting on or taking off parts, and before cleaning the appliance.
- Do not put any substances other than water and descaling products into the Kettle. Never attempt to cook or warm food in the Kettle.
- Always attach plug to appliance first, then plug cord into the wall outlet. To disconnect, turn any control to “off,” then remove plug from wall outlet.

- Do not touch the Kettle during a boiling cycle. Scalding may occur if the lid is removed/opened during the boiling cycles.
- Do not use this appliance for other than its intended use.
- Do not use outdoors.
- **This appliance is intended for household use only.**

SAVE THESE INSTRUCTIONS.

 **WARNING! Shock Hazard:** This appliance is equipped with a power cord that has a grounding wire with grounding plug. The appliance must be grounded using a 3-hole properly grounded outlet. In the event of an electrical short circuit, grounding reduces the risk of electric shock. If the power outlet is a standard 2-prong wall outlet, it is your personal responsibility and obligation to have it replaced with a properly grounded 3-prong outlet. **Do not, under any circumstances, cut or remove the third (ground) prong from power cord or use adaptor.** Consult a qualified electrician if the grounding instructions are not completely understood, or if doubt exists as to whether the appliance is properly grounded. Do not plug this appliance into an outlet with a voltage other than specified on the bottom of Kettle.

SHORT CORD STATEMENT

The length of the cord used on this appliance was selected to reduce the hazards of becoming tangled in, or tripping over a longer cord. If a longer cord is necessary, an approved extension cord may be used. The electrical rating of the extension cord must be equal to or greater than the rating of this appliance.

Care must be taken to arrange the extension cord so that it will not drape over the countertop or tabletop where it can be pulled on by children or tripped over.

To avoid an electrical circuit overload, do not use any high wattage appliance on the same circuit as this appliance.

 **WARNING!** 

SHOCK HAZARD

ONLY FOR USE WITH 110V AC OUTLET.

DO NOT USE ADAPTER.

FAILURE TO FOLLOW THESE INSTRUCTIONS CAN RESULT IN DEATH, FIRE OR ELECTRICAL SHOCK.

 This symbol alerts you to important operating and service instructions.



WARNING!
RISK OF FIRE OR ELECTRIC SHOCK
DO NOT OPEN



WARNING, TO REDUCE THE RISK OF FIRE OR ELECTRIC SHOCK,
DO NOT REMOVE COVER (OR BACK)

NO USER-SERVICEABLE PARTS INSIDE

REPAIR SHOULD BE DONE BY AUTHORIZED SERVICE PERSONNEL ONLY

 This symbol alerts you to the risk of fire or electric shock in the accompanying message.

Before We Begin

1. Remove and recycle or discard all stickers, descriptive labels, cable ties and packing materials, including static stickers and hangtags with ties.

2. Wipe body of Kettle with a soft, damp cloth. Rinse inside and dry thoroughly.

 **CAUTION:** Do not use abrasive pads, harsh chemicals or spray cleaner chemicals to clean. These may damage the surface of the appliance.

3. Fill your Kettle with cold water to the “MAX” level, complete one boiling cycle, and then discard water.

Quick Start Guide

1. Press button at top of handle to open lid, then fill Kettle with water. Press lid closed.

2. Place Kettle securely on base.

3. Plug power cord into 110V outlet.

4. Turn Kettle on by pressing down on the switch at the bottom of the handle. The switch will illuminate.

5. To learn more about how to use your Kettle, check out “The Particulars of Boiling Water” on pg. 9.

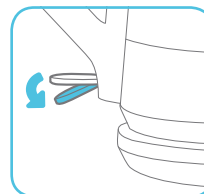
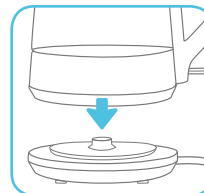

See pg. 10 to learn how to descale your Kettle, as well as other use and care information. (Descaling is a simple process required for all kettles to maintain long-term heating efficiency.)



REMOVABLE FILTER

Reusable, perforated stainless steel filter strains water while you pour and is removable for easy cleaning



LARGE CAPACITY

Kettle boils up to 1.75 L of water faster than the microwave and safer than the stovetop



BOROSILICATE GLASS

Durable, BPA-free borosilicate glass for thermal shock protection and a pure, clean taste



MEASUREMENT MARKINGS

Convenient ounce and milliliter markings allow for precise measuring



AUTOMATIC SAFETY SHUT-OFF

Kettle automatically turns off when water has reached a rolling boil

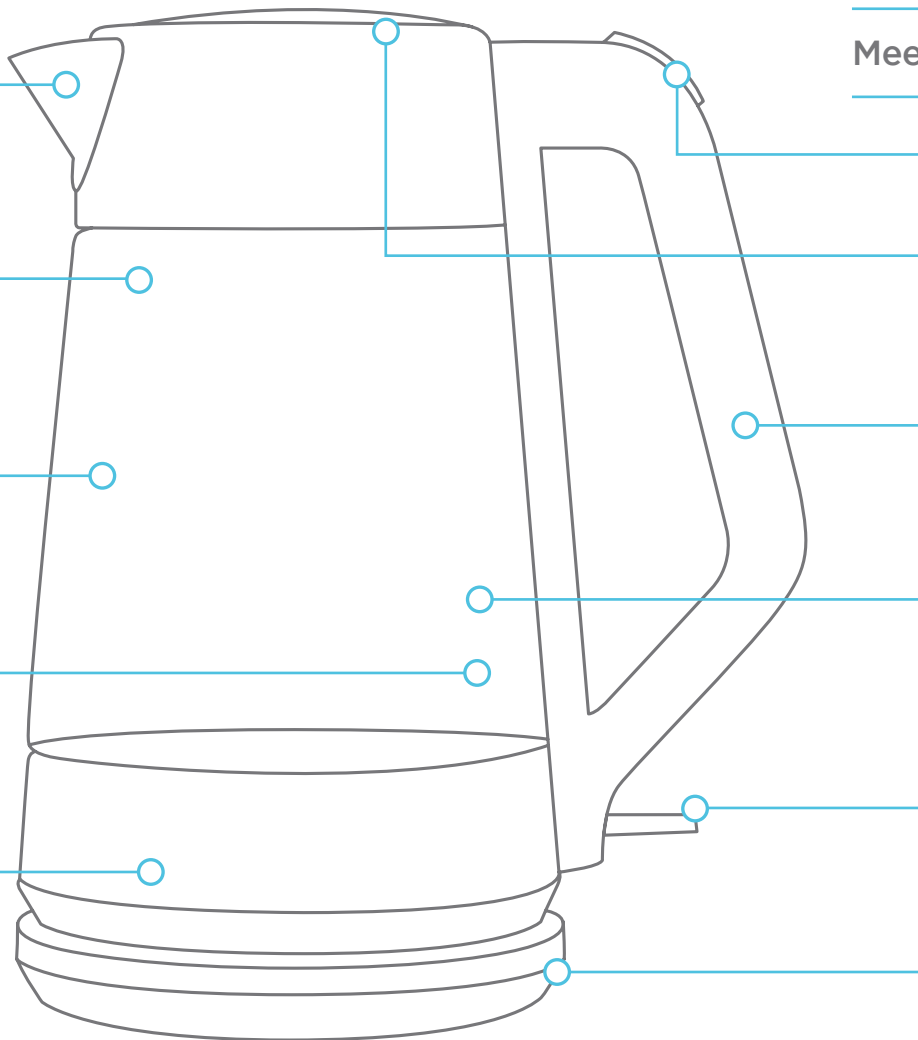

Meet Your Kettle

LID-RELEASE BUTTON



SOFT-OPEN LID

Lid opens slowly to control the release of steam and prevent hot water splatter



STAY-COOL HANDLE

Non-slip, comfortable handle provides a secure grip and remains cool to the touch



CORDLESS KETTLE

Kettle is cord-free when removed from the 360° swivel base and has an insulated bottom for easy transport



ILLUMINATED LED POWER SWITCH

Light illuminates when Kettle is on



CONVENIENT STORAGE

Cord wraps neatly around base for compact, tidy storage

The Particulars of Boiling Water

NOTE: Your Kettle will operate only when it is positioned on the power base with the ON/OFF switch in the ON position. Your Kettle will automatically switch off once the water has boiled.

1. Remove Kettle from base.

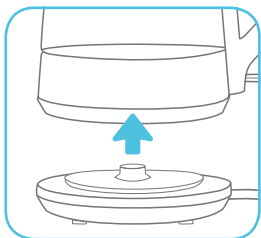

2. Open lid by pressing the lid-release button at top of handle. Verify that the removable perforated stainless steel filter is properly positioned in guides.

3. Fill with water between the "MIN" and "MAX" markings.

CAUTION: Under-filling could result in Kettle switching off before reaching a boil and/or overheating from boiling dry. Over-filling may result in boiling water splashing out of pour spout, and could cause scalding and serious injury. If over-filled, water may leak from the top and collect in the base of the Kettle.

4. Press lid closed and position Kettle on base. Plug power cord into 110V outlet.

5. Turn Kettle on by pressing down on switch at bottom of handle. The switch will illuminate to indicate the Kettle is "on." The Kettle automatically switches "off" once the water boils or when Kettle is removed from base.

NOTE: Kettle will boil for 20-30 seconds before automatically shutting off.

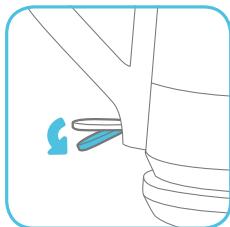

6. When ready, lift Kettle from base and pour water slowly.

NOTE:

- Pouring water too quickly can result in water coming out of the lid.
- The handle and bottom of the Kettle are designed to stay cool after boiling to protect hands and kitchen surfaces from heat.

7. Insulated bottom allows Kettle to be placed on any surface when not on base.

8. Unplug power cord and empty excess water from Kettle when finished. Use cord wrap under base for tidy storage.

NOTE: The Kettle may be stored on base when not in use.

Troubleshooting

You have questions, we have answers. For more information, call OXO Customer Service at 1-800-545-4411.

Question/Problem	Explanation/Solution
Water will not boil	➔ Check to make sure the Kettle is filled past the "MIN" mark.
Kettle is plugged in but will not turn on	➔ If the Kettle is plugged in and turned on without any water in it, it will automatically shut off to prevent overheating. The Kettle will be able to turn on again in a few minutes, after it cools back down to a safe temperature.
Kettle is pouring too slowly	➔ Check the removable filter in the spout for clogging. If necessary, clean the filter with a soft-bristled brush and rinse with warm water.
Kettle is taking longer than usual to boil	➔ Your Kettle might need to be descaled. See below for descaling instructions.

Descaling

YOUR KETTLE WILL NOT WORK PROPERLY IF IT IS NOT DESCALED REGULARLY. The warranty is voided if descaling is not carried out in accordance with these instructions.

Scale is a naturally occurring buildup of mineral deposits. The ideal descaling cycle depends on water hardness. Descal the Kettle every 60 uses. Regular descaling can also increase the service life of the Kettle, allowing it to boil water faster with less energy.

1. Fill Kettle with descaling solution and water to the "MAX" marking.

NOTE: Available where household cleaning products are sold; follow solution's recommended use.

2. Bring solution to a boil.

3. Turn Kettle OFF, unplug from outlet and let stand for at least 30 minutes.

4. Remove mesh spout filter and rinse clean.

5. Empty Kettle and rinse out any remaining solution.

6. Fill Kettle with water to "MAX" marking, boil, and discard water before next use.

Cleaning, Care and Storage

TO CLEAN YOUR KETTLE:

Any service or maintenance other than cleaning should be performed by an authorized service representative. For more information, call OXO Customer Service at 1-800-545-4411.

1. Always unplug power cord from outlet and allow Kettle to cool completely before cleaning.
2. Rinse out Kettle.
3. Carefully remove perforated stainless steel filter by holding lip of filter and pulling straight up. Use caution to avoid finger pinching. Clean with soft bristle brush and rinse with warm water. Dry and replace.
4. Wipe the body of the Kettle with a damp cloth and dry completely with a soft dry cloth.
5. Your Kettle must be descaled every 60 uses. See instructions on pg. 10.



CAUTION:

- To prevent damage to the appliance, do not use alkaline cleaning agents, abrasive pads, harsh chemicals or spray cleaner chemicals when cleaning. Use a soft cloth and mild detergent if desired.
- Do not clean any part of this appliance in the dishwasher.



WARNING: Never immerse the Kettle base, power base, power cord or plug in water, or allow liquid to come in contact with these parts.

STORAGE:

Unplug power cord from outlet and allow Kettle to cool completely before storing. Follow cleaning instructions and store in an upright position. The cord wrap under the Kettle base can be used for tidy cord storage. Do not store anything on top of your Kettle. The Kettle may be stored on base when not in use.



WARNING!



SHOCK HAZARD

ONLY FOR USE WITH 110V AC OUTLET.
DO NOT USE ADAPTER.

FAILURE TO FOLLOW THESE INSTRUCTIONS CAN
RESULT IN DEATH, FIRE OR ELECTRICAL SHOCK.



WARNING!

RISK OF FIRE OR ELECTRIC SHOCK
DO NOT OPEN



WARNING, TO REDUCE THE RISK OF FIRE OR ELECTRIC SHOCK,
DO NOT REMOVE COVER (OR BACK)

NO USER-SERVICEABLE PARTS INSIDE
REPAIR SHOULD BE DONE BY AUTHORIZED SERVICE PERSONNEL ONLY

Our Guarantee

TWO-YEAR WARRANTY:

We guarantee everything we make! Starting from the date of purchase, your OXO On Cordless Glass Electric Kettle is guaranteed by OXO for two years in the case of any manufacturing defects in materials or workmanship. This OXO warranty is only offered on OXO On appliances sold and used in the US and Canada.

The OXO warranty covers all costs related to restoring the proven defective product through the repair or replacement of any defective part and necessary labor so that it conforms to its original specifications. A replacement product may be provided instead of repairing a defective product. OXO's exclusive obligation under this warranty is limited to such repair or replacement.

A receipt indicating the purchase date is required for any claims, so please keep it in a safe place. We recommend that you register your product on our website, www.oxo.com/registration.aspx. Although greatly appreciated, the product registration is not required to activate any warranty and product registration does not eliminate the need for the original proof of purchase.

The warranty does not cover damages resulting from misuse or abuse of the product and/or uses inconsistent with this Use and Care manual, attempts at repair, theft, use with unauthorized attachments or failure to follow the instructions provided with the product.

The warranty becomes void if attempts at repair are made by non-authorized third parties and/or if spare parts, other than those provided by OXO, are used.

You may also arrange for service after the warranty expires at an added cost.

For questions, returns, repairs or warranty claims within the US, please visit www.oxo.com or contact OXO Customer Service at **(800) 545-4411**. We will be glad to assist you.

For customer service, claims or questions on sales in Canada, OXO Customer Service will gladly put you in touch with the appropriate individuals.

This warranty gives you specific legal rights, and you may have other legal rights which vary from state to state, country to country or province to province. The customer may assert any such rights at their sole discretion.

CONTACT INFO:

If you have any trouble with the product during the warranty period, do not attempt to return it to a retail store. Instead, please visit us online at www.oxo.com or contact us at:

OXO U.S. Customer Service

Hours: Monday – Friday, 8:00am – 5:00pm (ET)

Phone: (800) 545-4411 **Fax:** (717) 709-5350

Mail: OXO International, Inc. at 1331 S Seventh St. Ste 4,
Chambersburg, PA 17201-9912

Email: info@oxo.com

Outside the U.S.

Please contact your local distributor or email info@oxo.com

REGISTRATION INFO:

For product registration, please visit us online at www.oxo.com/registration.aspx or call toll free at **1-800-545-4411**.

Please be advised that as part of our privacy policy we never sell or give away your private information.

It's On

For over 25 years, OXO's mission has been to provide innovative consumer products that make everyday living easier.

How do we do it? We study people – lefties and righties, male and female, young and old – interacting with products and we identify opportunities for meaningful improvement. Our “question everything” process and relentless attention to detail allow us to design products that help consumers make short work of everyday tasks.

We've applied the same philosophy to OXO On, our line of intelligent kitchen appliances. Through intuitive interfaces, innovative digital controls and backlit LED displays, our On appliances give you the simplicity, functionality and thoughtfulness you've come to expect from OXO...

...all with the touch of a button.

©2015

OXO International Ltd.

1 Helen of Troy Plaza

El Paso, TX 79912

Printed in China

IB-8710300-00