

**nutri**chef



NCIM30

Frozen Dessert Maker

Electric Soft Serve and Sorbet Machine
(Frozen Yogurt, Ice Cream, Sorbet)

USER MANUAL

For household use only!

To ensure proper operation, please read this Instruction Manual carefully before using this product. Keep this manual in a safe place for future reference.

Table of Contents

Chapter 1 Safety Use Announcement	3
Chapter 2 Components, Operating Guide & Usage	4
Chapter 3 Cleaning and Maintenance	5
Chapter 4 Troubleshooting	6
Chapter 5 Warranty and After-sale Services	6
Chapter 6 Technical Specifications	7

Chapter 1 Safety Use Announcements

When using electric appliances, basic safety precautions should always be followed, including the following:

1. Please read this manual carefully before using.
2. Do not put the body (motor) into water or other liquid, nor can rinse it under water or other liquids to protect against the risk of electrical shock.
Use dry cloth to clean.
3. Avoid placing the unit in direct sunshine. Store the unit in a cool, dry place.
4. Before using, please check the power cord, plug, juicer nets, screws, and other parts carefully. If found damaged, please stop using the product, and contact our customer service department, to avoid danger, do not disassemble and repair.
5. This appliance shall not be used by children. Keep the appliance and its cord out of reach of children.
6. **DO NOT** put fingers into the feeding barrel or the outlet in case of any dangers.
7. **DO NOT** put metal objects near the cord and power plug.
8. **DO NOT** move the product or touch any parts while working.
9. Always unplug from the power outlet when not in use, before assembling and before cleaning.
10. **This product is for making ice cream/sorbet only.**
Do not use the product exceed its permitted usage range. Meat is not allowed for this unit.
11. Make sure the feed chute, pusher bar, screw, outlet cap are well assembled and fixed before using.

Chapter 2 Components, Operating Guide & Usage

Main Components

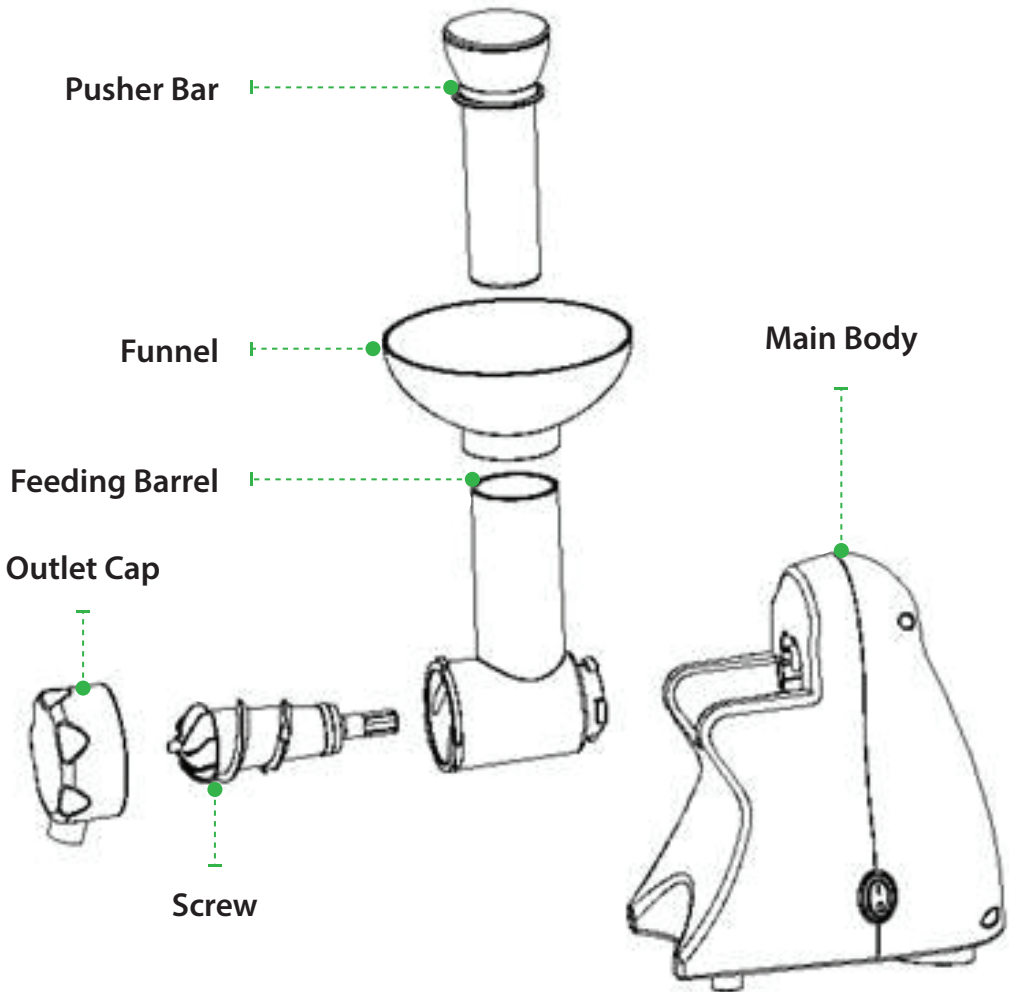

User Guidelines

1. After assembling the screw into the feeding barrel, screw the outlet cap anti-clockwise direction into the snap joint and fix it well.
2. Assemble the feeding barrel into the main body, screw and tighten it up 45 degree anti-clockwise direction.
3. Put the funnel on the top of the feeding barrel and press it tight into it with downward pressure.
4. Prepare a bowl under the outlet, plug the power, and press button to start working.
5. Put frozen peeled fruit into the feeding tube, and press it softly using the pushing bar. (**Tips:** Freeze the cleaned fruit cuts in fridge for 6 hours. Defrost the fruits for 5 mins. before using the unit.)
6. You can add other fruits by exchanging the fruits one by one and press it.
7. This product is not suitable for pressing too hard, more fiber foods, such as ice, coconut, sugar cane, pressing these ingredients easily stuck, blocking residue, resulting in damaged parts, thus affecting the life of the product.
8. Do not use the unit continuously for over 15 minutes. To continue using, please wait five minutes after its motor cools down before re-inserting the gasket.

Chapter 3 Cleaning and Maintenance

Cleaning Tips

1. Always clean the parts like outlet cap, feeding barrel, screw, pusher, funnel in warm, soapy water and with nonabrasive sponge or cloth.
2. **DO NOT** immerse the appliance in water or other liquids.
3. Do not put any of the components into the washing machine.

Maintenance Tips

1. Make sure the machine is clean and dry before using or after continuously using.
2. Reassemble the unit and store in a dry, cool location until next use.
3. Make sure the product is clean and dry before storage.

Chapter 4 Troubleshooting

Fault phenomenon	Fault Analysis	Fault Removal
Push the "Power Switch" and No feedback	Check the Power cord and confirm if properly inserted	Insert the power plug properly
	Check the machine and parts if all are assembled well	Reassemble the unit and parts following the instructions on manual
Sorbet blocking the outlet	It may have block in the feeding barrel	Screw out the outlet cap. Disassemble the screw, try again after cleaning
Leakage at the outlet cap	Check the outlet cap sealing rubber if assembled well.	Check and assemble the sealing rubber correctly
Too soft sorbet	Frozen time is not long enough	Freeze the fruits in fridge for several hours.

Chapter 5 Warranty and After-sale Services

This product has no user-serviceable parts. Do not attempt to examine or repair this product yourself. Only qualified service personnel should perform any servicing. In case of damage, contact our after sales support line for advice on inspection, repair or return of the damaged product.

Chapter 6 Features and Technical Specifications

NCIM30

Frozen Dessert Maker

Electric Soft Serve & Sorbet Machine (Frozen Yogurt, Ice Cream, Sorbet)

Features:

- Frozen Dessert Maker System
- Create Tasty, Natural Frozen Treats for the Whole Family
- Enjoy Home-Made Frozen Yogurt, Soft Serve Sorbet, Ice Cream
- Mix Fun Flavors for Healthy, Low-Fat & Low-Sugar Treats
- Simple Electric Plug-in Design
- Hassle-Free One Button Activation
- Quick & Convenient Fun Frozen Food Prep Ability
- Stain Resistant & Easy-to-Clean Housing
- Lightweight, Compact & Portable
- Safe for Placement on Any Kitchen Table or Countertop
- Perfect for Making Vegan & Dairy-Free Ice Cream Alternatives

What's in the Box:

- Electric Dessert Maker
- Frozen Treats Recipe Book

Questions? Issues?

We are here to help!

Phone: (1) 718-535-1800

Email: support@pyleusa.com

Technical Specs:

- High-Powered Motor: 150 Watt
- Feed Tube Opening Size: 1.5" - inch Diameter
- Power Cable Length: 3 ft.
- Power Supply: 120V
- Total Blender Size (L x W x H): 8.1" x 5.1" x 12.7" -inches



WARNING:

This product can expose you to a chemical or group of chemicals, which may include "Lead (Pb)" which is known in the state of California to cause cancer, birth defects, or other reproductive harm. For more info, go to <https://www.p65warnings.ca.gov/>.



nutr^{ich}ef