

TOP JAMB INSTALLATION CLOSER MOUNTED TOP JAMB ON PUSH SIDE OF DOOR

STANDARD INSTALLATION CLOSER MOUNTED ON PULL SIDE OF DOOR

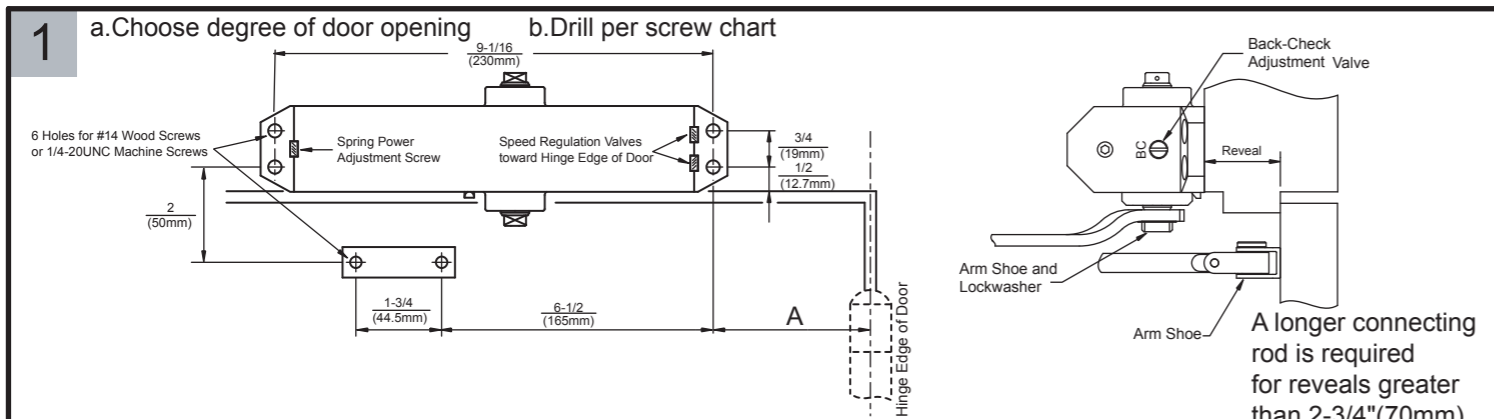

LEFT HAND DOOR ILLUSTRATED

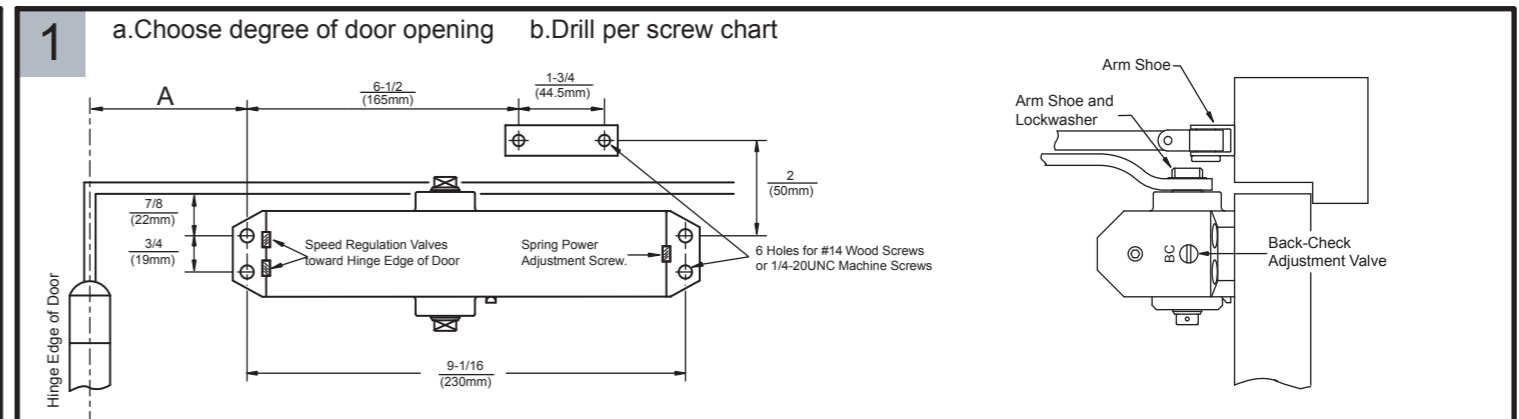

RIGHT HAND DOOR ILLUSTRATED

Inches (mm)	Opening	Dimension
		A
100°~120°	4	5-1/8 (130)
	3	
	2	
Over 180°	3	3-17/32 (90)
	2	

Adjust spring power to match chart

Opening	Closer Size	Clockwise Turns Of Adjustment Screw	
		Stronger +	Weaker -
100°~120°	4	12	12
	3	6	6
	2	0	0
Over 180°	3	12	12
	2	6	6
	1	0	0

Inches (mm)	Opening	Dimension
		A
100°~120°	4	4-23/32 (120)
	3	
	2	
Over 180°	3	3-5/32 (80)
	2	

Adjust spring power to match chart

Opening	Closer Size	Clockwise Turns Of Adjustment Screw	
		Stronger +	Weaker -
100°~120°	4	12	12
	3	6	6
	2	0	0
Over 180°	3	12	12
	2	6	6
	1	0	0

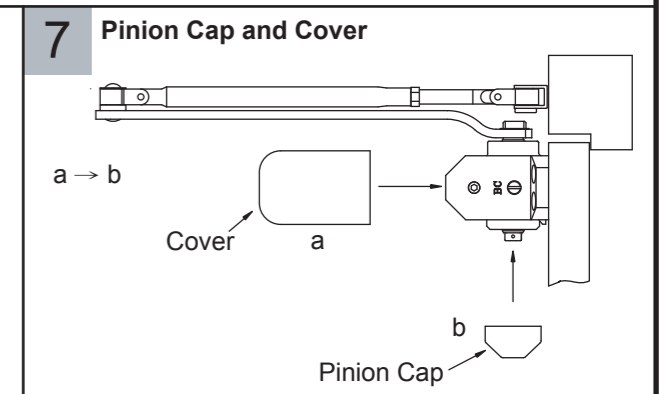
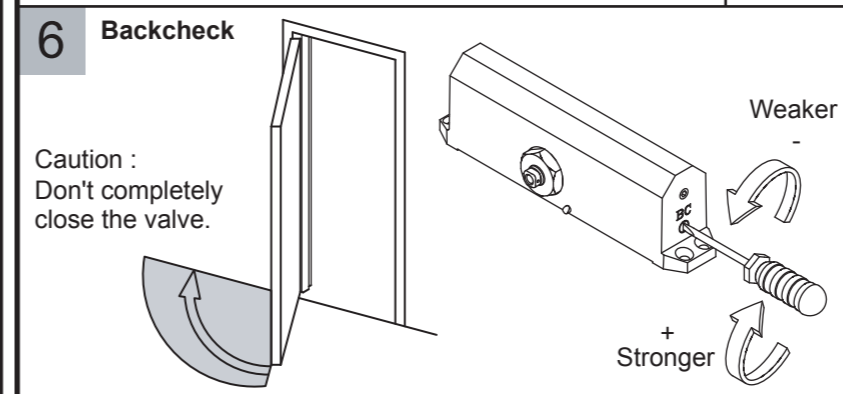
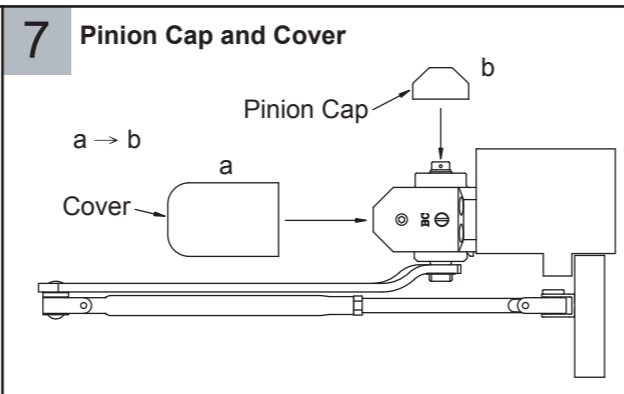
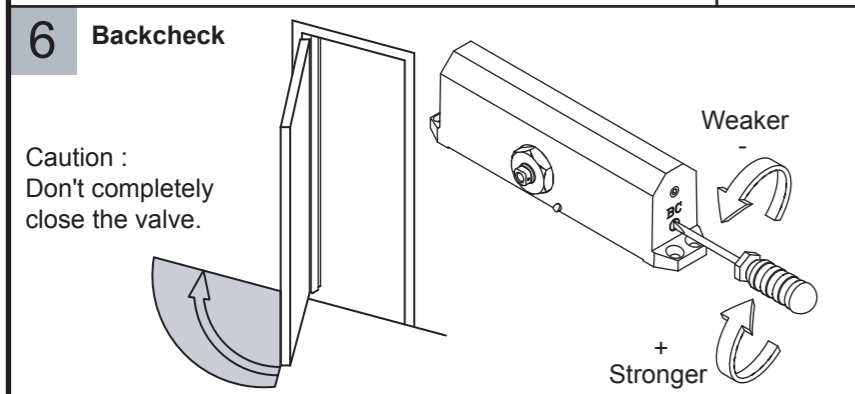
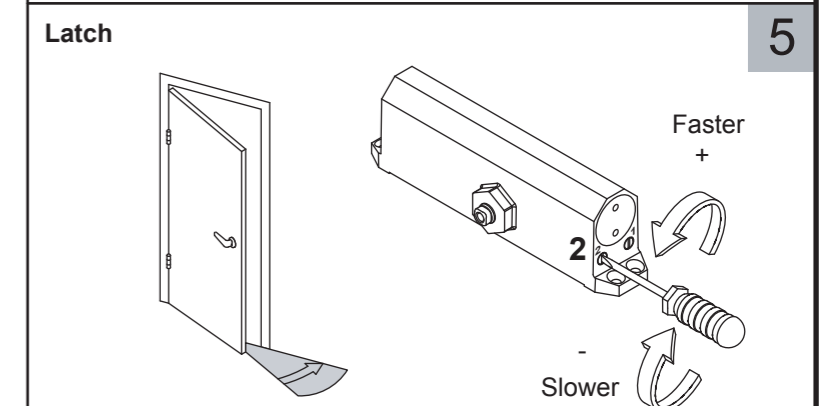
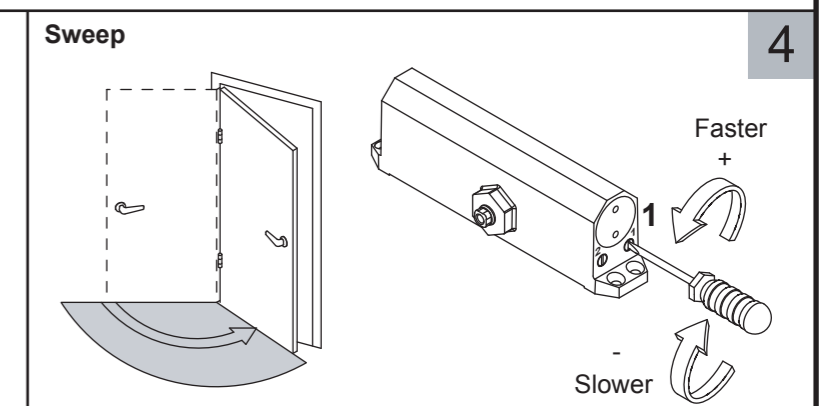
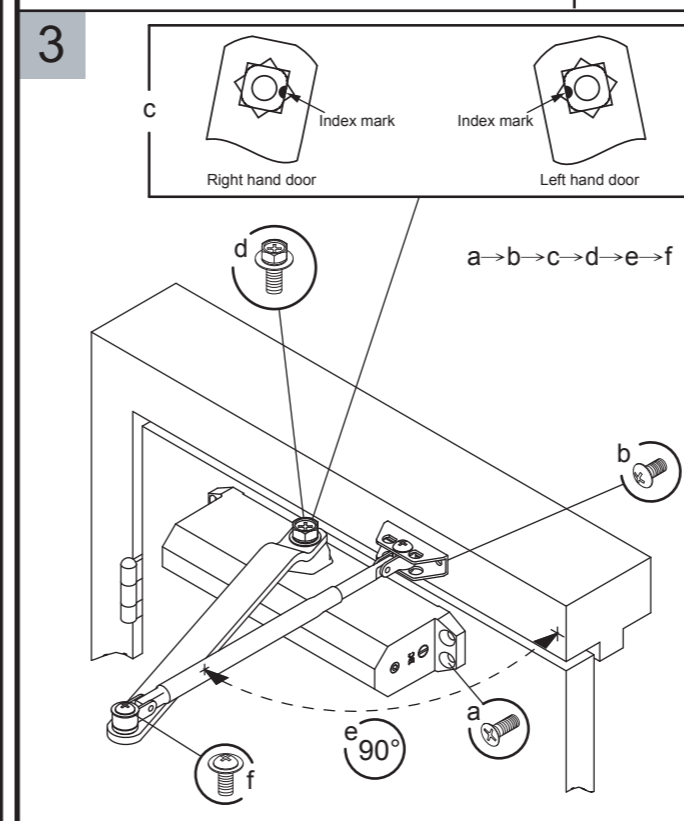
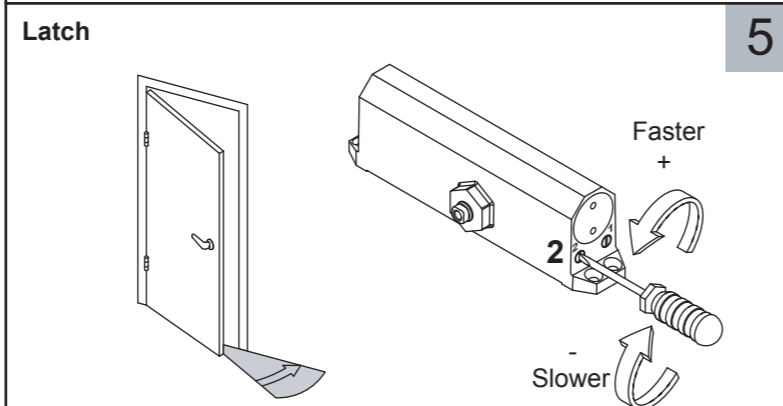
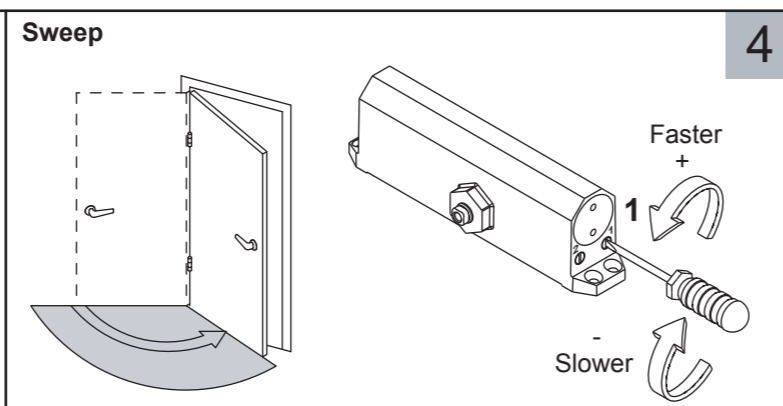
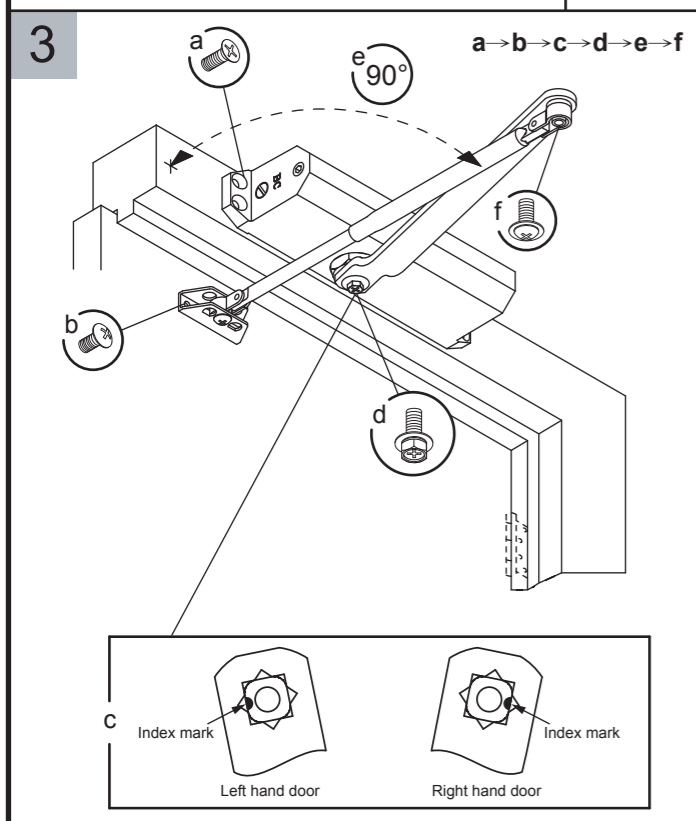

PARALLEL ARM INSTALLATION CLOSER MOUNTED ON PUSH SIDE OF DOOR

1 a. Choose degree of door opening b. Drill per screw chart.

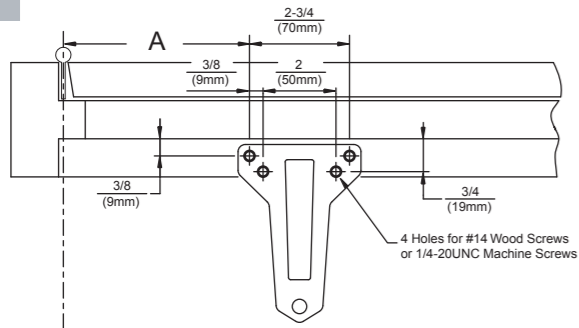

LEFT HAND DOOR ILLUSTRATED

Opening	Dimension	
	A	B
100°	7-7/8 (200)	5-29/32 (150)
Over 180°	6-11/16 (170)	4-23/32 (120)

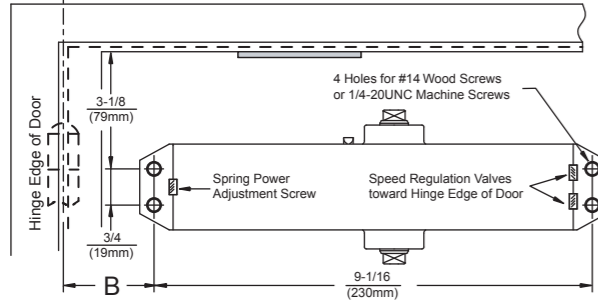

Adjust spring power to match chart.

Opening	Closer Size	Clockwise Turns Of Adjustment Screw	
		Closer Size	Clockwise Turns Of Adjustment Screw
100°~120°	4	12	12
	3	6	6
	2	0	0
Over 180°	4	12	12
	3	6	6
	2	0	0

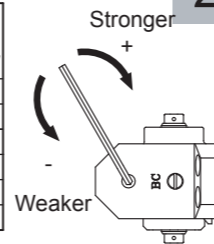

Pull Side Installation

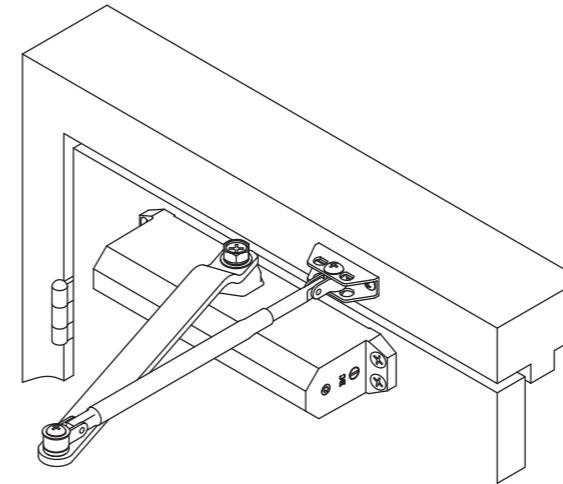

DOOR CLOSER INSTALLATION INSTRUCTION

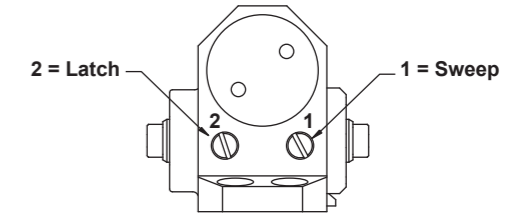

Spring Power Adjustment Screw

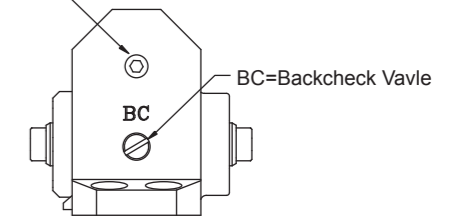

Push Side Installation

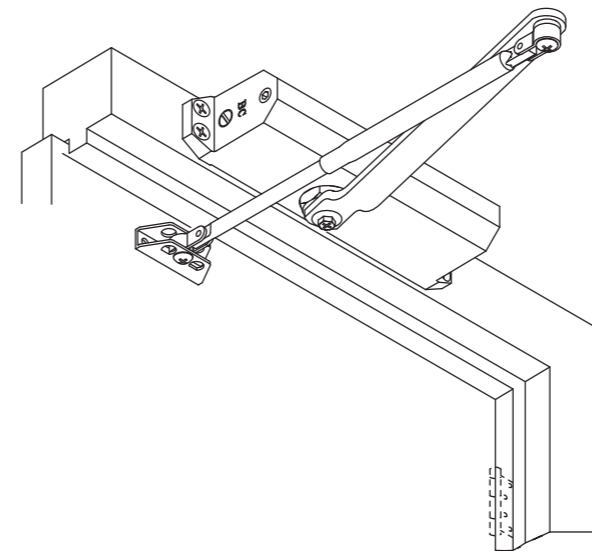

Regular Arm & Top Jamb				
Max. Door Size [Inches (mm)]	30"(762)	36"(914)	42"(1067)	48"(1219)
Door				
Interior	Size 1	Size 2	Size 3	Size 4
Exterior	Size 3	Size 4	Size 5	Size 6

Note: 1. Indicates recommended application of door width for closer size. Determine door width, adjust spring power to match chart.
2. For parallel arm application, it requires to adjust more spring power to meet door width.

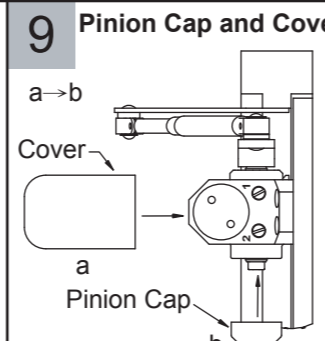
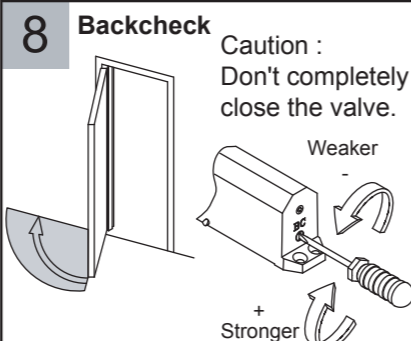
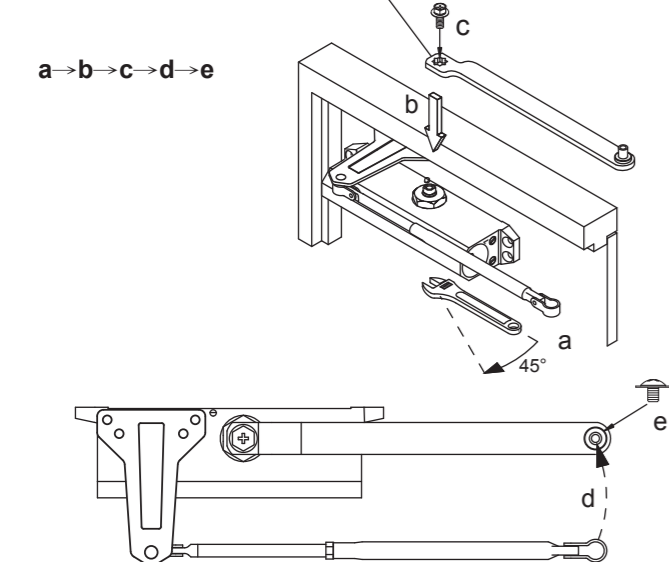
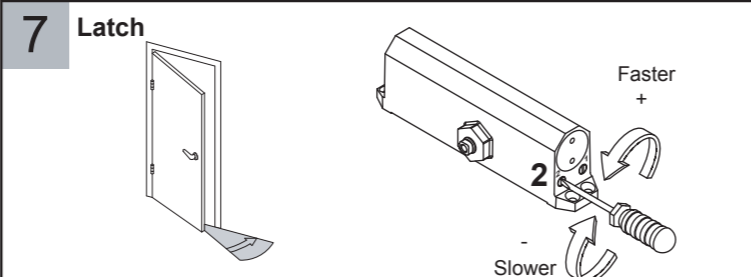
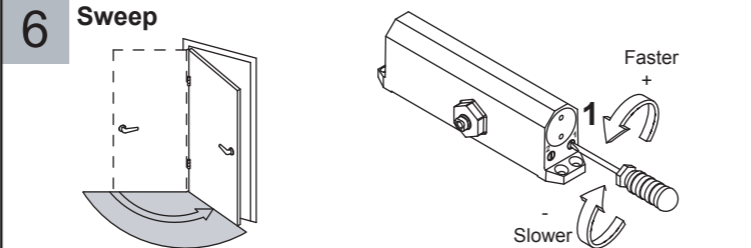
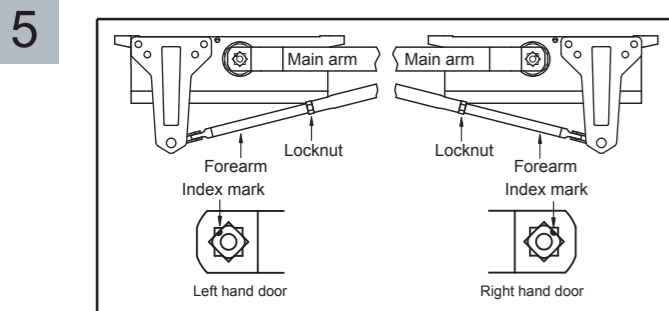
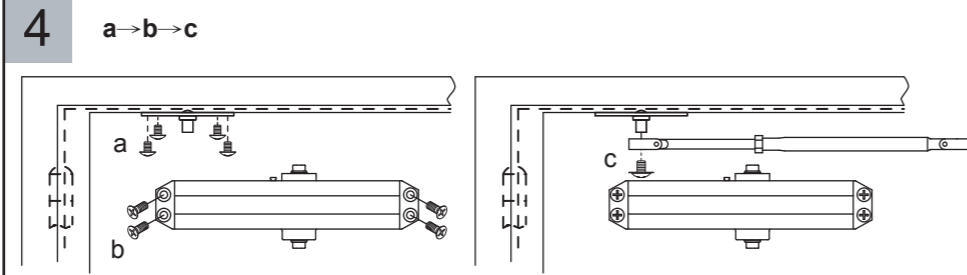
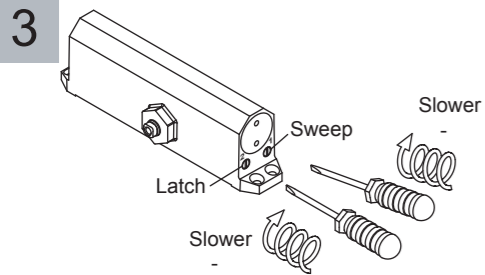

Parallel Arm Installation

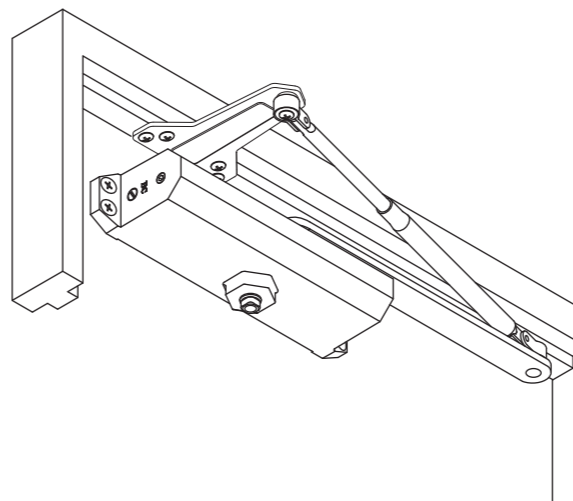

Standard Components

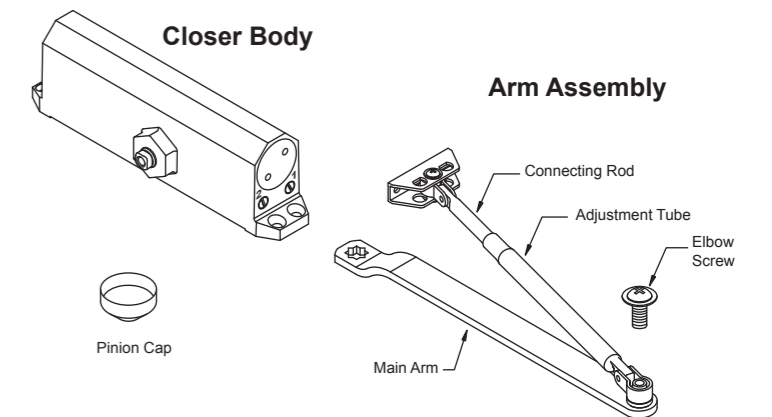

Soffit Plate

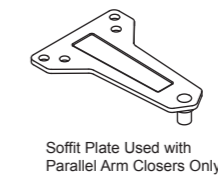

Optional Components

