

## For Residential and Commercial Applications

Job Name		Engineer / Architect	
Job Location		Wholesaler	
Submittal Date		Contractor	

### 1-\*\*KA Copper Faucet Riser – Sweat Nosepiece

**Use:** For use in potable water distribution systems in accessible locations only.

**Design Features:**

- **One-piece construction**
- **Cut-to-Length** for clean, professional installation
- **100% Compliant** to California and Vermont “low-lead” requirements

**Operating Specifications:**

**Temperature:** 40°- 180° F  
**Pressure:** 125 psi maximum

**Tubing Diameter:** 0.38” O.D.



MATERIAL SPECIFICATIONS			
<b>Tube</b>	C12200 copper per ASTM B-68		
PART DIMENSIONS (Inches)			
Model	DIM. A	DIA. B	DIM. C
1-12KA	11.53	3/8	.62
1-15KA	14.53	3/8	.62
1-20KA	19.53	3/8	.62

**Part Listing:**

- 1-12KA C      3/8” ID Sweat x 3/8” OD Tube x 11-1/2” Length, chrome plated
- 1-12KA R      3/8” ID Sweat x 3/8” OD Tube x 11-1/2” Length, rough finish
- 1-12KA RBT    3/8” ID Sweat x 3/8” OD Tube x 11-1/2” Length, rough finish, plain label, bulk
- 1-15KA R      3/8” ID Sweat x 3/8” OD Tube x 14-1/2” Length, rough finish
- 1-20KA C      3/8” ID Sweat x 3/8” OD Tube x 19-1/2” Length, chrome plated
- 1-20KA R      3/8” ID Sweat x 3/8” OD Tube x 19-1/2” Length, rough finish

**Listings & Certifications:**

- IAPMO listed to ASME A112.18.1-2005 / CSA B125.1-2005 (File # 0645)
- CSA approved to California Health & Safety Code 116875 and Vermont Bill S.152 (Project # 2174785)

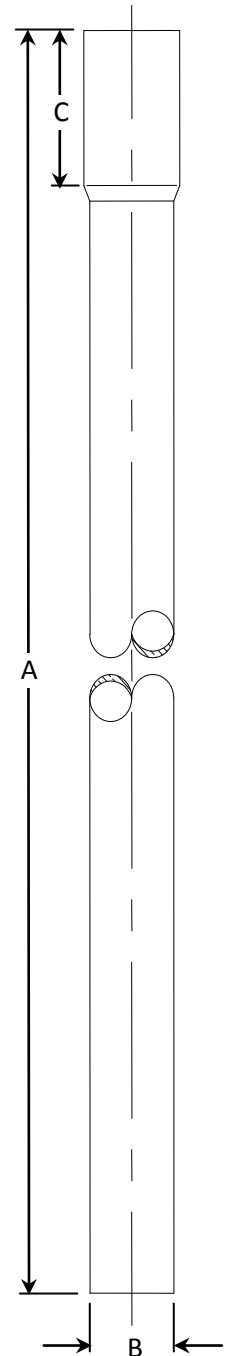

*This specification and all information contained herein is the confidential and exclusive property of BrassCraft Manufacturing, and shall not be disclosed to others without the written consent of BrassCraft. This specification must be returned to BrassCraft if requested.*

