

## Model 007 Cartridge Circulator

The Taco 007 Cartridge Circulator is the most popular hydronic circulator sold today. With its field serviceable cartridge design, the compact 007 provides quiet, efficient operation and unmatched reliability. The self-lubricating, maintenance free design and flow characteristics make it the ideal hydronic circulator for a wide range of applications.



Stainless Steel Model

**NSF® ≤ .25% Lead**

Stainless Steel Model  
Meets California AB 1953  
and Vermont Act 193



# Submittal Data Information Model 007 Cartridge Circulators

Submittal Data # 101-029  
Supersedes: 07/11/07

Effective: 06/01/11

## Features

- Standard High Capacity Output-Compact Design
- Quiet, Efficient Operation
- Direct Drive-Low Power Consumption
- Unique Replaceable Cartridge Design-Field Serviceable
- Self Lubricating
- No Mechanical Seal
- Unmatched Reliability-Maintenance Free
- Universal Flange to Flange Dimensions
- Cast Iron or Stainless Steel Construction

## Materials of Construction

|                   |                              |
|-------------------|------------------------------|
| Casing (Volute):  | Cast Iron or Stainless Steel |
| Stator Housing:   | Steel                        |
| Cartridge:        | Stainless Steel              |
| Impeller:         | Non-Metallic                 |
| Shaft:            | Ceramic                      |
| Bearings:         | Carbon                       |
| O-Ring & Gaskets: | EPDM                         |

## Model Nomenclature

- F - Cast Iron, Flanged
- SF - Stainless Steel, Flanged

### Variations:

- Z - Zoning Circulator
- VDT - Variable Speed Differential Temperature ( $\Delta T$ )
- VR - Variable Speed Outdoor Reset
- VS - Variable Speed Set Point
- VV - Variable Speed Variable Voltage
- J - Bronze Cartridge with Cast Iron Casing

## Performance Data

- Flow Range: 0 - 23 GPM
- Head Range: 0 - 10 Feet
- Minimum Fluid Temperature: 40°F (4°C)
- Maximum Fluid Temperature:  
Cast Iron: 240°F (115°C)  
Stainless Steel: 230°F (110°C)
- Maximum Working Pressure: 125 psi
- Connection Sizes: 3/4", 1", 1-1/4", 1-1/2" Flanged



FOR INDOOR USE ONLY

NSF® ≤ .25% Lead

Complies with California Health and Safety Code Section 116875 / AB1953 and Vermont Act 193

## Application

The Taco 007 is a cartridge style, maintenance free, wet-rotor, in-line, single stage circulator pump. It is designed for quiet operation in Hydronic heating, Radiant heating, Hydro-Air fan coils, Indirect water heaters, Chilled fresh water, and Domestic Water Recirculation systems. Available in Cast Iron or Stainless Steel construction with universal flanged connections. The unique replaceable cartridge contains all of the moving parts and allows the circulator to be easily serviced instead of replacing the entire unit. Ideal for a wide range of applications.

## Pump Dimensions & Weights

| Model    | Casing    | A     |     | B     |     | C      |    | D       |    | F     |     | G     |     | Ship Wt. |     |
|----------|-----------|-------|-----|-------|-----|--------|----|---------|----|-------|-----|-------|-----|----------|-----|
|          |           | in.   | mm  | in.   | mm  | in.    | mm | in.     | mm | in.   | mm  | in.   | mm  | lbs.     | Kg  |
| 007-F5   | Cast Iron | 6-3/8 | 162 | 4-1/2 | 114 | 3-3/16 | 81 | 2-15/16 | 75 | 4-3/4 | 121 | 6-3/8 | 162 | 8.0      | 3.6 |
| 007-F5-5 | Cast Iron | 6     | 152 | 4-1/2 | 114 | 3-3/16 | 81 | 2-15/16 | 75 | 4-3/4 | 121 | 6-3/8 | 162 | 8.0      | 3.6 |
| 007-SF5  | St. Steel | 6-3/8 | 162 | 4-1/2 | 114 | 3-3/16 | 81 | 2-15/16 | 75 | 4-3/4 | 121 | 6-3/8 | 162 | 7.0      | 3.2 |

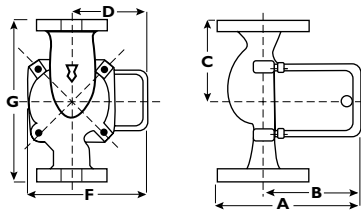

## Mounting Positions

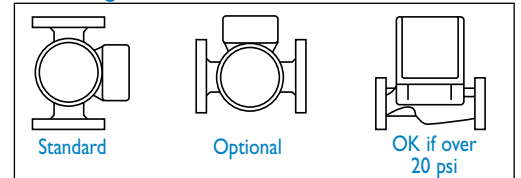

## Electrical Data

| Model         | Volts   | Hz | Ph | Amps | RPM  | HP   |
|---------------|---|----|----|------|------|------|
| 007-F5        | 115   | 60 | 1  | .71  | 3250 | 1/25 |
| 007-SF5       | 115   | 60 | 1  | .76  | 3250 | 1/25 |
| Motor Type    | Permanent Split Capacitor Impedance Protected |    |    |      |      |      |
| Motor Options | 220/50/1, 220/60/1, 230/60/1, 100/110/50/60/1 |    |    |      |      |      |

## Flange Orientation

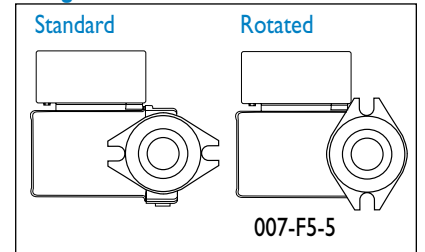

## Performance Field - 60Hz

