

BARN WOOD SHIPLAP INSTALLATION INSTRUCTIONS

Allow the wood to acclimate for several days prior to installation in the room in which it will be installed. Variances in temperature and moisture between the storage and application areas have a negative effect on the finished appearance if the product doesn't adjust to room conditions prior to installation. As wood dries, a slight joint may open up. It is recommended to paint the surface behind the wood a dark color.

Nail directly to the wall framing when installing in a horizontal orientation. For applications where vertical orientation is desired, full-length furring strips must be installed 24 inches on center. *Use standard or painted trim nails (15 or 16 gauge). Fastener length should be long enough for 1 1/4"-1 1/2" of penetration into solid wood.*

Nail through the top flange. A second nail should be placed through the bottom face of the board, approximately 1" from the bottom edge (ensuring not to nail through overlapping pieces).

When installing shiplap over plaster or hardboard, the walls need to be in moderately good condition. Construction adhesive is usually the easiest and fastest way to install wood shiplap over drywall, plaster, hardboard and even old shiplap. When applying adhesive, be sure to follow the manufacturers instructions. To make sure you have a tight joint when applying adhesive, use small nails to tack up and hold the shiplap in place on the drywall or plaster while adhesive sets. Apply tack nails every two or three feet.

DO NOT NAIL THROUGH OVERLAPPING PIECES

Install shiplap horizontally or vertically.
For horizontal applications, start with the bottom course and work up with overlap pointing downward. Do not nail through overlaps. Shiplap siding is tight-fitting, so butt the courses up close.

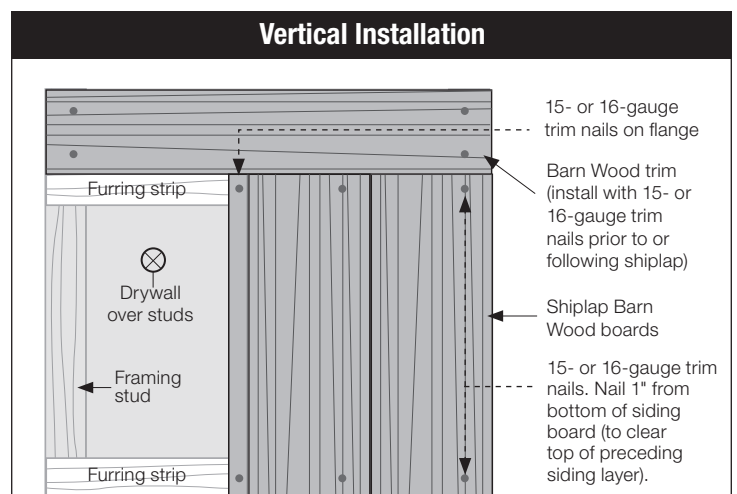
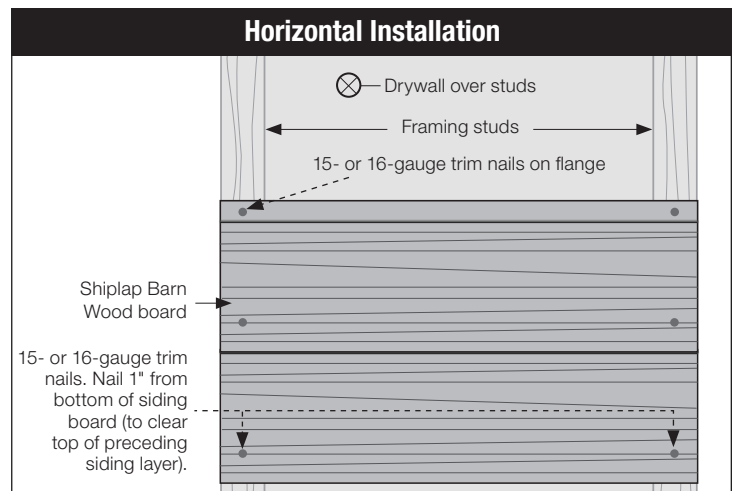

THIS BROCHURE IS FOR ILLUSTRATION PURPOSES ONLY. USE OF THIS PRODUCT MUST BE IN ACCORDANCE WITH ALL LOCAL ZONING AND/OR BUILDING CODES. CONSUMER ASSUMES ALL RISKS AND LIABILITY ASSOCIATED WITH THE USE OF THIS PRODUCT. WARRANTOR DOES NOT PROVIDE ANY WARRANTY, EITHER EXPRESS OR IMPLIED, AND SHALL NOT BE LIABLE FOR ANY DAMAGES, INCLUDING CONSEQUENTIAL DAMAGES.