

Unpacking the Unit

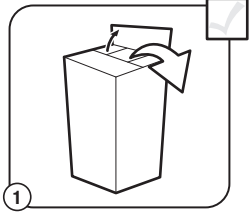

1 Remove all contents from the carton.

Assembling the Unit

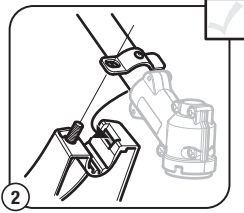

2 Insert the short tab (the one without a hole) on the mount bracket into the slot on the cutting head shield. Rotate the cutting head shield until the bolt on the cutting head shield protrudes through the hole on the mount bracket.

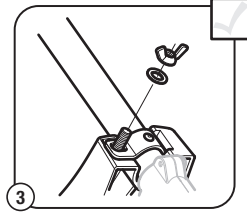

3 Place the washer onto the bolt. Screw the wing nut onto the bolt until the cutting head shield is firmly in place.

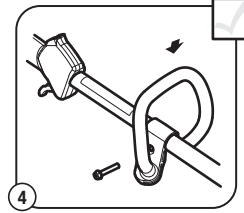

4 Push the handle down onto the upper shaft housing. Make sure the bolt hole faces to the right. Insert the bolt into the bolt hole and push it through. Tighten the bolt with a flat-head screwdriver, but do not tighten the bolt completely.

Assembling the Unit

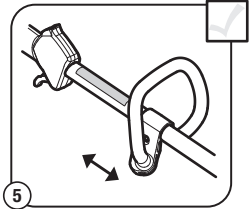

5 Move the handle up or down the upper shaft housing to a comfortable location. Make sure the handle is positioned beyond the end of the safety label. Tighten the bolt with a flat-head screwdriver until the handle is secure.

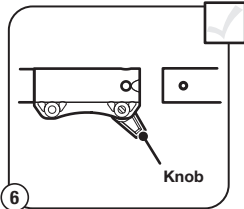

6 Remove the hanger cap from the attachment. If present, remove the gray spacer from the coupler. Turn the knob counterclockwise to loosen the coupler. Push the attachment into the coupler until the release button snaps firmly into the primary hole. Turn the knob clockwise to tighten the coupler.

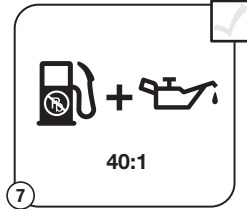

7 Mix thoroughly in a separate fuel can:
 - 3.2 fl. oz. of 2-cycle engine oil
 - 1 gallon of fresh unleaded gasoline (**less than 30 days old**)
NOTE: Do not mix directly in the unit fuel tank.

Starting the Unit

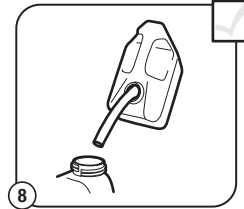

8 Position the unit with the fuel cap facing up. Slowly remove the fuel cap. Fill the fuel tank. Reinstall the fuel cap. Move the unit at least 30 ft. (9.1 m) from the fuel container and the fueling site before starting the engine.

Starting the Unit

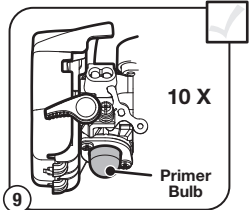

9 Press the primer bulb 10 times.

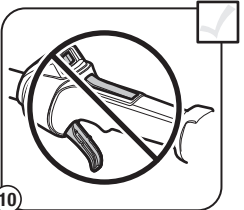

10 **DO NOT** squeeze the throttle control until step 14.

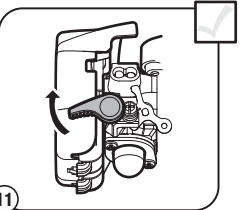

11 Flip the choke lever clockwise until it clicks.



12 Crouch in the starting position.

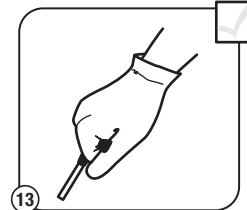

13 Pull the starter rope with a controlled and steady motion until the unit starts.

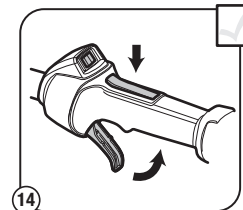

14 **Press and hold** the throttle lockout. **Squeeze** the throttle control as needed for operation.

Idle the engine for 30 seconds.

ASSEMBLY TOOLS REQUIRED

- Flat-head Screwdriver

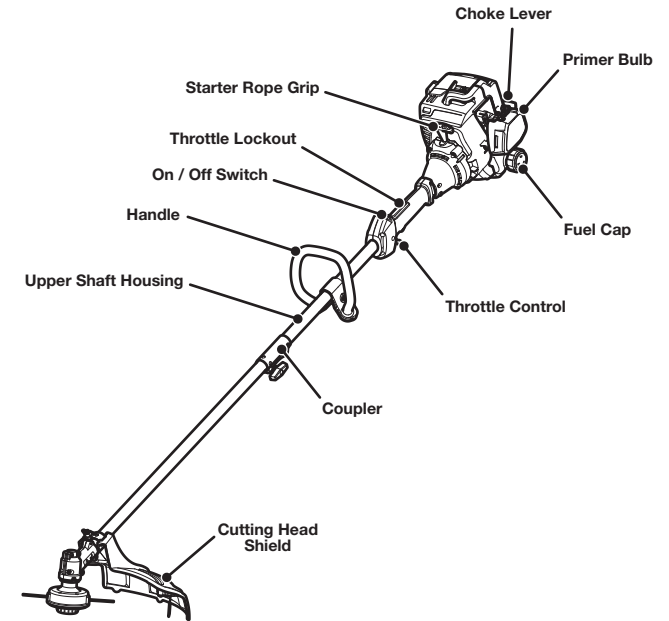

Need Help?
 Call 1-800-828-5500

DIDN'T START?

Repeat the starting instructions.

If the unit still fails to start, refer to the operator's manual for additional starting and troubleshooting information.

