



Item# 1001 412 844/  
1001 412 840  
Model #D12237-DS/  
D12237-DS-B

# USE AND CARE GUIDE

---

## OAK HEIGHTS MOTION DINING CHAIR

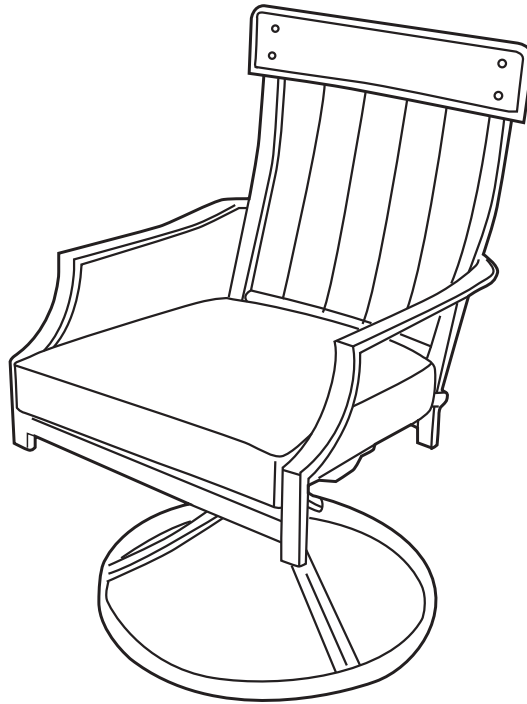

Questions, problems, missing parts? Before returning to the store,  
call Hampton Bay Customer Service  
8 a.m. - 7 p.m., EST, Monday-Friday  
9 a.m. - 6 p.m., EST, Saturday

**1-855-HD-HAMPTON**

**HAMPTONBAY.COM**

---

### **THANK YOU**

*We appreciate the trust and confidence you have placed in Hampton Bay through the purchase of this chair. We strive to continually create quality products designed to enhance your home. Visit us online to see our full line of products available for your home improvement needs. Thank you for choosing Hampton Bay!*

# Table of Contents

|  |   |                                |   |
|--|---|--------------------------------|---|
| <b>Table of Contents</b> .....             | 2 | <b>Assembly</b> .....          | 5 |
| <b>Warranty</b> .....                      | 2 | <b>Care and Cleaning</b> ..... | 6 |
| What is Covered .....                      | 2 |                                |   |
| What is Not Covered .....                  | 2 |                                |   |
| <b>Pre-assembly</b> .....                  | 3 |                                |   |
| Planning Assembly .....                    | 3 |                                |   |
| Hardware Included .....                    | 3 |                                |   |
| Motion Dining Chair Package Contents ..... | 4 |                                |   |

# Warranty

**THIS IS A RESIDENTIAL WARRANTY AND DOES NOT APPLY FOR COMMERCIAL USE.**

## **2 YEAR FRAME AND FABRIC LIMITED WARRANTY**

### **WHAT IS COVERED**

We warrant the frame and fabric to be free of manufacturing defects to the original purchaser for two years.

### **WHAT IS NOT COVERED**

It remains the customer's responsibility for freight and packaging charges to and from our service center.

This warranty does not cover commercial use, hardware, acts of nature, fire, freezing and abusive use.

In addition, purchased parts are not covered under this warranty. We reserve the right to make substitutions with similar merchandise, if the model in question is no longer in production.

For a copy of our full limited warranty, please contact our customer service team below.

Contact the Customer Service Team at 1-855-HD-HAMPTON or visit [www.hamptonbay.com](http://www.hamptonbay.com).

# Pre-assembly

## PLANNING ASSEMBLY

Please read complete instruction manual prior to assembly!

Identify all parts packed in the carton against the parts list. Remove all protective materials and place the parts on a nonabrasive surface to avoid scratching.



**NOTE:** More than one person may be required to complete the assembly of this product.

## HARDWARE INCLUDED



**NOTE:** Tools not shown to actual size.

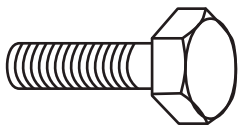

\_\_\_\_\_ AA



\_\_\_\_\_ BB



\_\_\_\_\_ CC

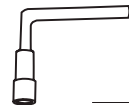

\_\_\_\_\_ DD

| Part | Description     | Quantity |
|------|-----------------|----------|
| AA   | M6*20 Hex bolt  | 8        |
| BB   | M6 Washer       | 8        |
| CC   | M6 Hex bolt cap | 8        |
| DD   | Wrench          | 1        |

# Pre-assembly (continued)

## MOTION DINING CHAIR PACKAGE CONTENTS

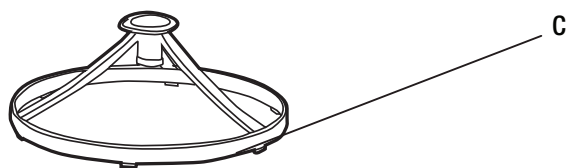
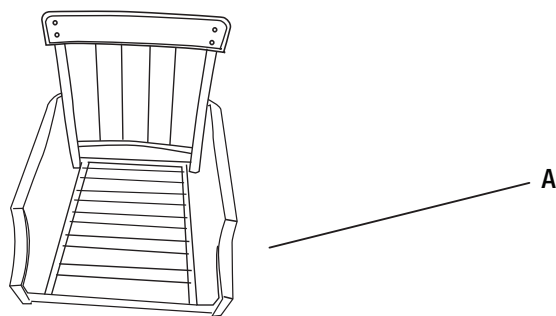
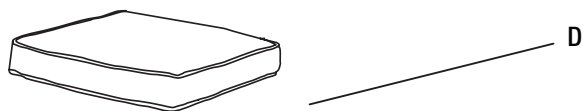

| Part | Description  | Quantity |
|------|--------------|----------|
| A    | Seat frame   | 2        |
| B    | Stem bracket | 2        |
| C    | Base         | 2        |
| D    | Seat cushion | 2        |

## 1 Attaching the arms

- Attach the stem bracket (B) to the seat frame (A) using the washers (BB) and hex bolts (AA).
- Ensure all bolts are aligned and assembled correctly.
- Tighten all hex bolts (AA) with the wrench (DD). Attach the hex bolt caps (CC).

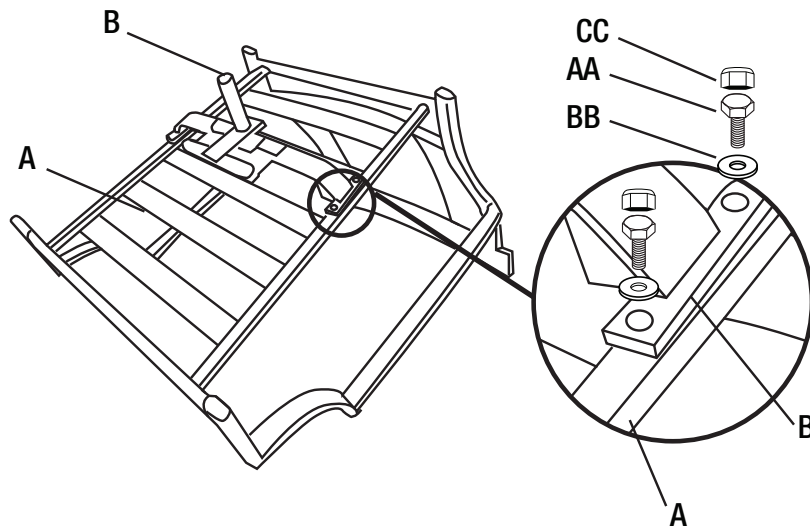

## 2 Connecting the base and seat

- Place the base (C) on a flat surface and align the stem under the seat frame (A) with the hole on the base. Push down firmly to lock the seat frame (A) and base (C) together.

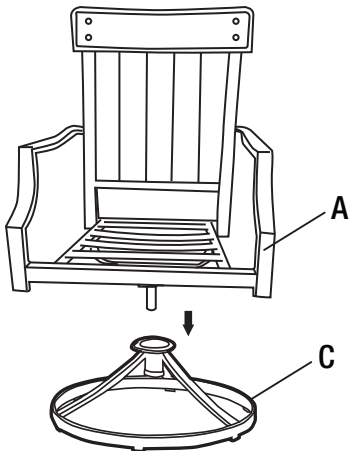

## 3 Adding the cushions

- Place the seat cushion (D) onto the chairs.

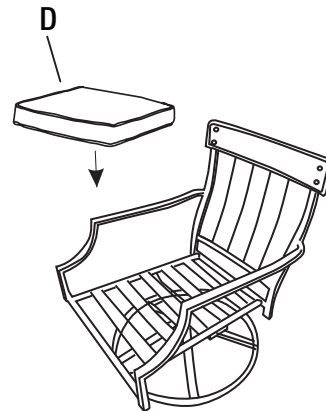

## Care and Cleaning

---

- Do not allow water to build up in frames. This will cause corrosion and possible freezing damage in cold climates.
- Use a mild soap and water for normal cleaning. DO NOT use janitorial or alcohol based cleaners. Some cleaners may be marked as natural, but some ingredients may cause discoloration or have an adverse reaction to your finish.
- Rinse with clean water and dry with a soft, absorbent cloth towel.
- Treat frames with a liquid wax for maximum protection against UV rays and/or salty, damp air.



Questions, problems, missing parts? Before returning to the store,  
call Hampton Bay Customer Service  
8 a.m. - 7 p.m., EST, Monday-Friday  
9 a.m. - 6 p.m., EST, Saturday

**1-855-HD-HAMPTON**

**HAMPTONBAY.COM**

Retain this manual for future use.