

Mitering

Miter your mouldings to join pieces at corners. An end miter is a 45° cut in the ends of two adjoining pieces of moulding so they fit tightly together.

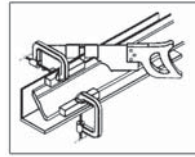

Crown and cove mouldings are cut at the same angle against the back and bottom of the miter box as they will eventually rest against the wall and ceiling.

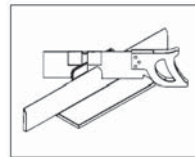

Base mouldings and chair rails are cut with the flat side against the back of the miter box. Door and window casings are mitered with the flat side on the bottom of the box.

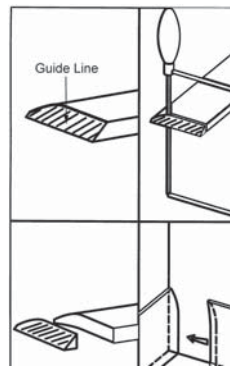
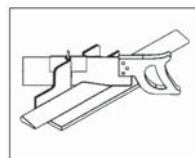

Coping

Use a cope cut for inside corners when installing base or crown.

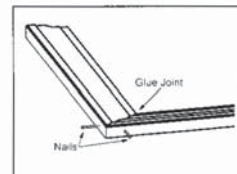

Fastening

A dab of glue and small diameter nails assure tight joints. Set power tools at 100 to 110 pounds per PSI to compensate for MDF's dense surface. Putty holes and paint.

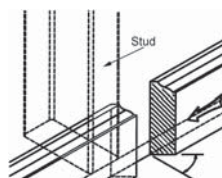

Splicing

When a wall is too long for a single length of moulding, you need to splice two or more moulding pieces together.