



# Refined Engineered Safety

## GRAB BAR FASTENING SYSTEM

PART # - RESGBW35 - Sold in Sets of 2 (Typical Grab Bar)

### The World's Strongest Fastener™

- Meets ADA Guidelines and ALL Building Codes
- Eliminates the need for Blocking - **Watertight**
- Rated up to **600 lbs.** in drywall with tile
- Works with WingIts' Grab Bars



MADE WITH PRIDE IN THE U.S.A.

**OVER TWO MILLION**  
**2,000,826**  
**INSTALLED.**  
 AND STILL COUNTING...

Installs completely **WATERPROOF**  
 — even over grout lines!

AS EASY AS ...

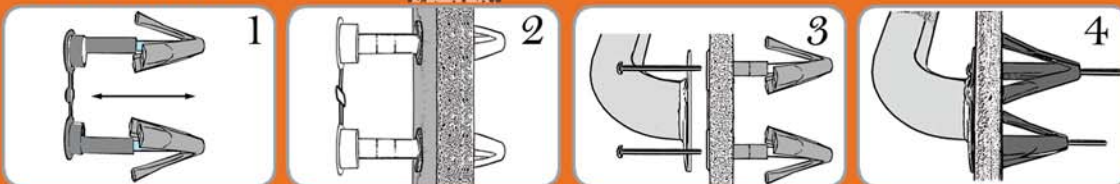

- TOOLS REQUIRED:
- Tape Measure to layout
  - 3/4" Drill
  - Phillips Screwdriver

## DRILL IT. INSTALL IT. MOUNT IT.

RES WINGITS are easily installed with the APACHE200 3/4" DRILL BIT

Call us at 877.894.6448 • Visit us at [www.wingits.com](http://www.wingits.com) • Email us at [sales@wingits.com](mailto:sales@wingits.com)



**REFINED ENGINEERED SAFETY GRAB BAR WINGIT *INSTALLATION GUIDE***

WingIt's Residential Grab Bar Fastening Systems Meet Building Codes for Grab Bars in the Following Wall Substrates:

* 5/8" drywall—painted or wallpapered
* 1/2" or 5/8" drywall with tub surrounds
* 1/2" or 5/8" drywall with tile, marble and all stone
* 1/2" or 5/8" drywall with any panel types including fiberglass, faux marble, acrylic and plastics
* Multiple layers of drywall
* Plaster and lath
* 1/4" acrylic/fiberglass tub surrounds
* Most wall panels
* All masonry type boards, with or without decorative panels

**NEVER INSTALL ANY FASTENER INTO WET OR DETERIORATING WALLS!**

**DO NOT INSTALL WingIts® into BARE 1/2" drywall** when attempting to meet commercial building codes.

**LOCATION:**

To ensure adequate clearance, use a stud finder. Minimum 1" clearance required from centerline of WingIt installation.

**TOOLS REQUIRED:**

\* **Screwdriver & 3/4" Drill** (our APACHE 200 drill bit—rated @ 200 holes in ceramic wall tile)

**GRAB BAR LENGTH**

Before you install Verify the length of the grab bar by measuring from the outside of one flange to the inside of the other.



**Avoid WALL FRAMING (studs)—One inch clearance needed from Center of each WingIt installation.**

**1. PEEL the 1/4" Liner (scored) off the Tape and fold up until properly placed.**

**2. Determine location of the Grab Bar and mark the length on the wall, then place TAPE with the center hole over mark. Stick**

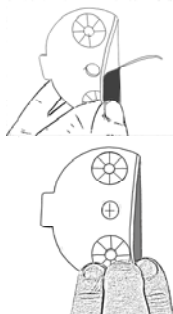

tape to the wall Remove remaining Liner and complete adhesion.

**3. Using the Tape as a template, Drill out two 3/4" holes. For a fast, easy installation, use the Apache200 Drill Bit—rated @ 200 holes in ceramic wall tile.**

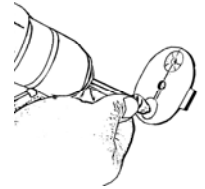

**1. Once the holes are drilled, remove TAPE liner**

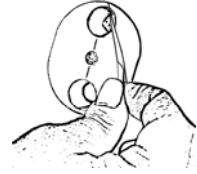

**Install RES Grab Bar WingIt**

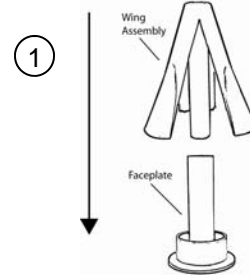

**1. Place the FACEPLATE on the table insert the WINGS into the FACEPLATE (the tubes inter-lock).**

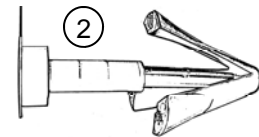

**2. Extend the WingIt.**

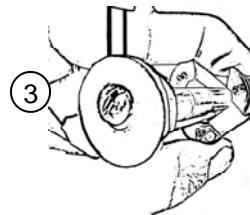

**3. Compress and insert the WINGS into the holes.**

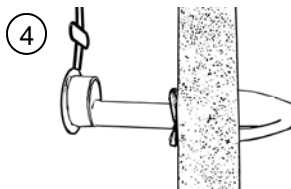

**4. WINGS should be FLUSH with the wall surface.**

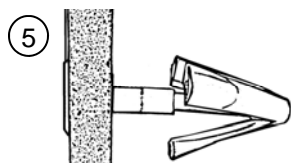

**5. Pop WingIt through the hole by pushing on the Faceplate or thread the screw in and push the Wing through.**

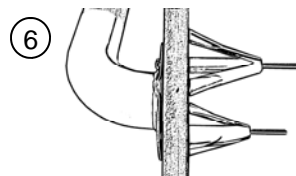

**6. Using the enclosed 3.5" Stainless Steel Screw, Attach the grab bar to the WingIt.**

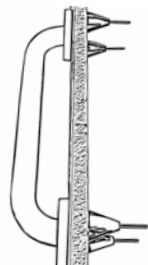

Grab Bar installed with RES Grab Bar WingIts.