

UL Reduced Wall Aluminum Type RW FAC (5600 Series)

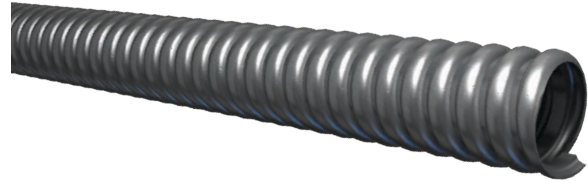

Description

- Lightweight Reduced Wall Aluminum Flexible Conduit
- Premium aluminum alloy
- Interlocking design
- Proprietary lubricant and process providing a non-oil surface and product with extra flexibility
- Trade sizes 1-1/2 through 4 are made with no solder joints

Applications

Suitable for use in:

- Flexible Aluminum Conduit (FAC): A raceway of circular cross-section made of helically wound, interlocked aluminum strip
- Accordance with NEC® Article 348 Flexible Metal Conduit Type FMC
- Exposed and concealed locations
- Utilization equipment per NEC® 348.20(A)(2)(a)
- Part of a listed assembly per NEC® 348.20(A)(2)(b)
- Equipment ground in accordance with NEC® 250.118(5)
- Other Spaces Used for Environmental Air (Plenums) per NEC® 300.22(C)
- Use in Cable Trays per NEC® 392.10(A) and Table 392.10(A)
- Raceway for Tap Conductors for Luminaires per NEC® 348.20(A)(2)(c) and 410.117(C)
- Connection to a motor terminal enclosure per NEC® 430.223
- Class I Division 2 per NEC® 501.10(B)(2)(2)
- Neon Secondary-Circuit Wiring 1000V or Less per NEC® 600.31(A)
- Neon Secondary-Circuit Wiring Over 1000V per NEC® 600.32(A)(1)
- Manufactured Wiring Systems per 604.100(A)(2)
- Elevators, Dumbwaiters, Escalators, Moving walks, Platform and Stairway Chairlifts per NEC® 620.21
- Under Raised Floors per NEC® 645.5(E)(1)(b)(10)
- Solar Photovoltaic (PV) Systems per NEC® 690.31(A)
- Fuel Cell Systems per NEC® 692.31
- Wind Electric Systems per NEC® 694.30(A)
- Critical Operations Power Systems (COPS) where flexibility is required per NEC® 708.10(C)(1)(3)(b)
- Optical Fiber Cables for installation within buildings per NEC® 770.110(A)(1)
- Communications Circuit Wires and Cables for installation within buildings per NEC® 800.110(A)(1)
- Community Antenna Television and Radio Coaxial Cables for installation within buildings per NEC® 820.110(A)(1)
- Low and Medium Power Network-Powered Broadband Cables for installation within buildings per NEC® 830.110(A)(1)

Ratings

- NFPA 70 National Electric Code (NEC®) Articles 348, 250, 300, 392, 410, 423, 430, 501, 600, 604, 620, 645, 690, 692, 694, 708, 770, 800, 820 and 830
- UL 1 Standard for Flexible Metal Conduit UL File Number E11831
Federal Specification WW-C-566C
superseded by UL 1
- UL 1479 Fire Tests of Through-Penetration Firestops UL File Number R14141
UL Classified Through-Penetrating Product
for Use in Through-Penetration
Firestop Systems
- NEMA RV 3 Application and Installation Guidelines for Flexible and Liquidtight Flexible Metal Conduits
- C22.2 No. 56 CSA Standard for Flexible Metal Conduit and Liquid-Tight Flexible Metal Conduit
The 3/8 Trade Size is the only Type RW FMC that is CSA Certified
City of Los Angeles Electrical Testing Laboratory Research Report
Number 93227
Permits the use of 1/2 and 3/4 Trade Sizes of Type RW Flexible
Aluminum Conduit in long lengths per the Report
- RR 93227

ORDERING INFORMATION						PRODUCT DIMENSIONS/BEND RADIUS		
Product Code	Trade Size (inches)	Trade Size (mm)	Coil Length (feet)	Reel Length (feet)	Approx. Weight/100 feet (pounds)	Internal Diameter (min/max) inches	External Diameter (min/max) inches	Bend Radius inches
5601-22-00*	3/8	12	25	—	6	0.375/0.393	0.560/0.610	2
5601-24-00*	3/8	12	50	—	6	0.375/0.393	0.560/0.610	2
5601-30-00*	3/8	12	100	—	6	0.375/0.393	0.560/0.610	2
5601-42-00*	3/8	12	250	—	6	0.375/0.393	0.560/0.610	2
5601-45-00*	3/8	12	—	500	6	0.375/0.393	0.560/0.610	2
5601-60-00*	3/8	12	—	1000	6	0.375/0.393	0.560/0.610	2
5602-22-00	1/2	16	25	—	10	0.625/0.645	0.860/0.920	3
5602-24-00	1/2	16	50	—	10	0.625/0.645	0.860/0.920	3
5602-30-00	1/2	16	100	—	10	0.625/0.645	0.860/0.920	3
5602-45-00	1/2	16	—	500	10	0.625/0.645	0.860/0.920	3
5602-60-00	1/2	16	—	1000	10	0.625/0.645	0.860/0.920	3
5603-22-00	3/4	21	25	—	12	0.812/0.835	1.045/1.105	4
5603-24-00	3/4	21	50	—	12	0.812/0.835	1.045/1.105	4
5603-30-00	3/4	21	100	—	12	0.812/0.835	1.045/1.105	4
5603-45-00	3/4	21	—	500	12	0.812/0.835	1.045/1.105	4
5603-60-00	3/4	21	—	1000	12	0.812/0.835	1.045/1.105	4
5604-24-00	1	27	50	—	18	1.000/1.040	1.300/1.380	5
5604-80-00	1	27	—	300	18	1.000/1.040	1.300/1.380	5
5605-24-00	1-1/4	35	50	—	22	1.250/1.300	1.550/1.630	6.25
5605-40-00	1-1/4	35	—	200	22	1.250/1.300	1.550/1.630	6.25
5606-22-00	1-1/2	41	25	—	26	1.500/1.575	1.850/1.950	7.50
5606-35-00	1-1/2	41	—	150	26	1.500/1.575	1.850/1.950	7.50
5606-80-00	1-1/2	41	—	300	26	1.500/1.575	1.850/1.950	7.50
5607-22-00	2	53	25	—	35	2.000/2.080	2.350/2.450	10
5607-30-00	2	53	—	100	35	2.000/2.080	2.350/2.450	10
5607-35-00	2	53	—	150	35	2.000/2.080	2.350/2.450	10
5608-22-00	2-1/2	63	25	—	57	2.500/—	2.860/3.060	12.50
5608-35-00	2-1/2	63	—	150	57	2.500/—	2.860/3.060	12.50
5609-22-00	3	78	25	—	68	3.000/—	3.360/3.560	15
5609-30-00	3	78	—	100	68	3.000/—	3.360/3.560	15
5610-22-00	3-1/2	91	25	—	80	3.500/—	3.860/4.060	17.50
5610-30-00	3-1/2	91	—	100	80	3.500/—	3.860/4.060	17.50
5611-22-00	4	103	25	—	91	4.000/—	4.360/4.560	20
5611-30-00	4	103	—	100	90	4.000/—	4.360/4.560	20

NOTE: All dimensions and weights are subject to normal manufacturing tolerances. *CSA certified. Review NEC® 348.60 and 250.118(5) for grounding requirements. Review NEC® 348.60 and 250.118(5) for grounding requirements.