

10x12 CONCRETE SLAB

CONCRETE FOUNDATION FOR 10x12 TRICO AND FLORA SHEDS

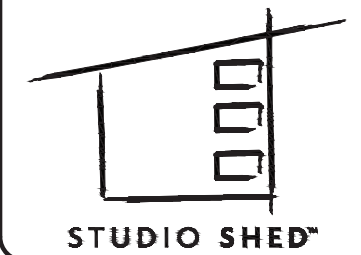

STUDIO SHED™
 1500 CHERRY STREET
 LOUISVILLE, CO 80027
 Ph: **888.900.3933**
 WWW.STUDIO-SHED.COM

10x12 CONCRETE SLAB

1.0

CONCRETE SLAB GENERAL NOTES:
 FOUNDATIONS ARE DESIGNED WITHOUT AN ENGINEER'S SOIL INVESTIGATION. THE DESIGN CRITERIA IS ASSUMED FOR PURPOSES OF FOUNDATION DESIGN.

FOOTINGS:
 DESIGN OF FOOTINGS IS BASED ON MAXIMUM ALLOWABLE BEARING PRESSURE 1500 PSF BEAR ON THE NATURAL UNDISTURBED SOIL OR COMPACTED STRUCTURAL FILL.

REINFORCED CONCRETE:
 DESIGN IS BASED ON ACI 318 "BUILDING CODE REQUIREMENTS FOR STRUCTURAL CONCRETE" AND ACI 332 "REQUIREMENTS FOR RESIDENTIAL CONCRETE CONSTRUCTION." CONCRETE WORK SHALL CONFORM TO ACI 301 "STANDARD SPECIFICATIONS FOR STRUCTURAL CONCRETE."

STRUCTURAL CONCRETE SHALL HAVE THE FOLLOWING PROPERTIES:

	F'C, PSI	MAX W/C RATIO	MAXIMUM AGGREGATE	SLUMP, INCHES (+/- 1")	ENTRAINED AIR, PERCENT (+/- 1.5%)	CEMENT TYPE	ADMIXTURES, COMMENTS
INTENDED USE	28 DAY						
SLAB ON GRADE	4,000	0.45	3/4" STONE	4	3	I/II	

DETAILING, FABRICATION, AND PLACEMENT OF REINFORCING STEEL SHALL BE IN ACCORDANCE WITH ACI 315-5 "DETAILS AND DETAILING OF CONCRETE REINFORCEMENT."
 REINFORCING BARS SHALL CONFORM TO ASTM A615-04A, GRADE 60, EXCEPT TIES OR BARS SHOWN TO BE FIELD-BENT, WHICH SHALL BE GRADE 40.
 BARS TO BE WELDED SHALL CONFORM TO ASTM 706-04A.
 EXCEPT AS NOTED ON THE DRAWINGS, CONCRETE PROTECTION FOR REINFORCEMENT IN CAST-IN-PLACE CONCRETE SHALL BE AS FOLLOWS:
 CAST AGAINST AND PERMANENTLY EXPOSED TO EARTH: 3"
 EXPOSED TO EARTH OR WEATHER:
 #6 THROUGH #18 BARS: 2"
 #5 BAR, W31 OR D31 WIRE, AND SMALLER: 1-1/2"
 NOT EXPOSED TO WEATHER OR IN CONTACT WITH GROUND:
 SLABS, WALLS, JOISTS: #11 BARS AND SMALLER: 3/4"

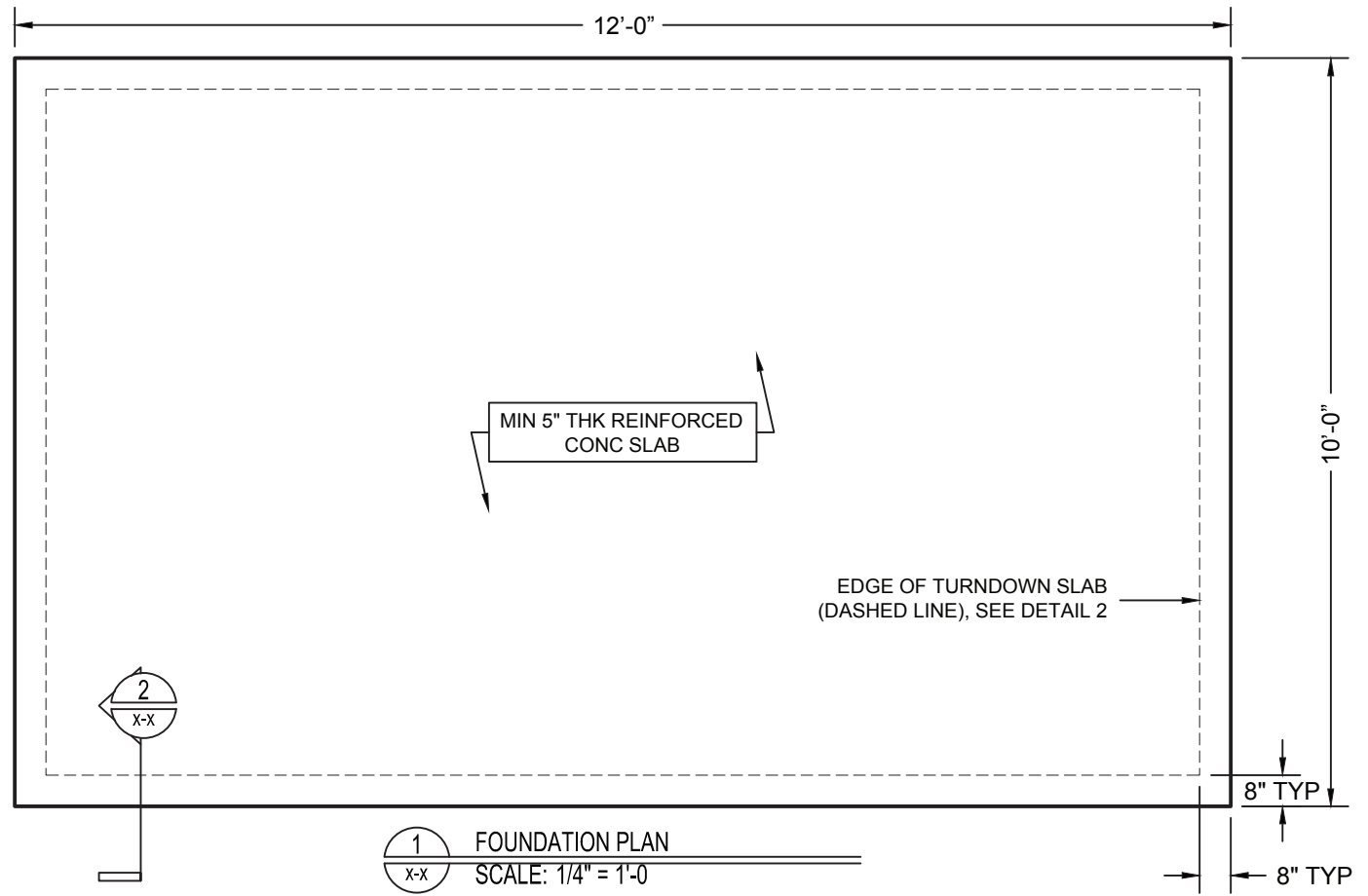

1 FOUNDATION PLAN
 SCALE: 1/4" = 1'-0"

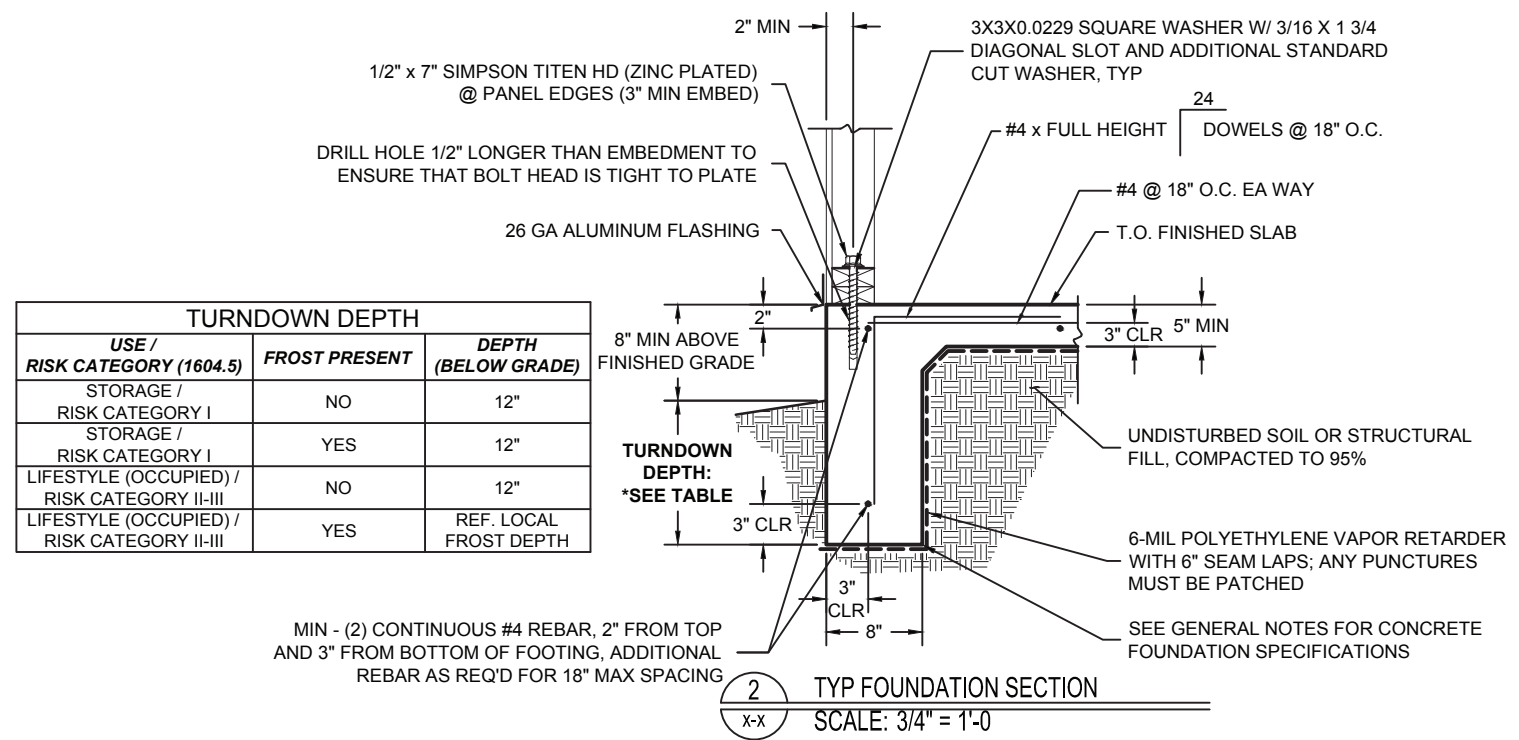

2 TYP FOUNDATION SECTION
 SCALE: 3/4" = 1'-0"

TURNDOWN DEPTH		
USE / RISK CATEGORY (1604.5)	FROST PRESENT	DEPTH (BELOW GRADE)
STORAGE / RISK CATEGORY I	NO	12"
STORAGE / RISK CATEGORY I	YES	12"
LIFESTYLE (OCCUPIED) / RISK CATEGORY II-III	NO	12"
LIFESTYLE (OCCUPIED) / RISK CATEGORY II-III	YES	REF. LOCAL FROST DEPTH

FOUNDATION NOTES:

- HOLD-DOWN CONNECTER BOLTS INTO WOOD FRAMING REQUIRE APPROVED PLATE WASHERS; AND HOLD-DOWNS SHALL BE FINGER TIGHT AND 1/2 WRENCH TURN JUST PRIOR TO COVERING THE WALL FRAMING. CONNECTOR BOLTS INTO WOOD FRAMING REQUIRE STEEL PLATE WASHERS ON THE POST ON THE OPPOSITE SIDE OF THE ANCHORAGE DEVICE. PLATE SIZE SHALL BE A MINIMUM OF 0.299 INCH BY 3 INCHES BY 3 INCHES. (2305.5)
- HOLD-DOWN HARDWARE MUST BE SECURED IN PLACE PRIOR TO FOUNDATION INSPECTION.
- ALL BOLT HOLES SHALL BE DRILLED 1/32" TO 1/16" OVERSIZED. (11.1.2.2, 2012 NDS)