

3.3.14 Metal Hit Anchor

- 3.3.14.1 Product Description
- 3.3.14.2 Material Specifications
- 3.3.14.3 Technical Data
- 3.3.14.4 Installation Instructions
- 3.3.14.5 Ordering Information

3.3.14.1 Product Description

The Hilti Metal Hit Anchor is a drive-in type expansion anchor consisting of a zinc plated or stainless steel drive pin and an alloy expanding body for light duty fastenings in concrete and masonry.

Product Features

- Quick and easy fastening for maximum speed and installation
- Low profile mushroom head style provides a clean, tamper proof fastening
- Anchor design allows easy through-type fastenings even in bottomless holes
- Consistent load values provide light duty fastenings in concrete and masonry
- Choice of stainless steel or carbon steel finish allows outdoor or indoor use



3.3.14.2 Material Specifications

Body material: Aluminum/Zinc Alloy

Drive Pin: Zinc plated carbon steel conforming to AISI 1018. Type 304 Stainless Steel (Stainless Steel Version)

3.3.14.3 Technical Data

Metal Hit Allowable Loads in Normal Weight Concrete

Anchor Size in.	Embed. Depth in. (mm)		Concrete						Hollow Concrete block				Red Clay block			
			Tension lb (kN)			Shear lb (kN)			Tension lb (kN)		Shear lb (kN)		Tension lb (kN)		Shear lb (kN)	
			2000psi		4000psi	2000psi										
3/16	5/8	(16)	-	-	-	-	-	180	(0.8)	180	(0.8)	-	-	-	-	
1/4	3/4	(19)	135	(0.6)	210	(0.9)	280	(1.2)	255	(1.1)	320	(1.4)	180	(0.8)	280	(1.2)
1/4	1	(25)	160	(0.7)	240	(1.1)	315	(1.4)	310	(1.4)	320	(1.4)	245	(1.1)	290	(1.3)

For overhead application reduce the allowable load values by a factor of 2.

3.3.14.4 Installation Instructions

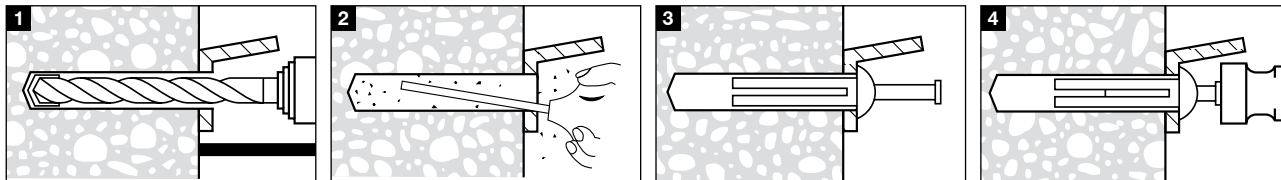

1. Drill hole at least 1/4" deeper than anchor.
2. Clean hole.
3. Install anchor through fixture.
4. Hammer in nail until nail head is flush with anchor body. Do not overdrive.

3.3.14.5 Ordering Information

Description	Carbon Item No.	Stainless Item No.	Bolt Diameter ¹ In.	Box Qty
Metal Hit 3/16" x 7/8"	66137	N/A	3/16	100
Metal Hit 1/4" x 3/4"	15538	N/A	1/4	100
Metal Hit 1/4" x 1"	66138	230567	1/4	100
Metal Hit 1/4" x 1-1/4"	66139	230568	1/4	100
Metal Hit 1/4" x 1-1/2"	66140	230569	1/4	100
Metal Hit 1/4" x 2"	45453	230570	1/4	100