

# KEYHOLE BRACKET INSTALLATION

## Tools Needed

You will need the following tools for the bracket installation: a pencil, a level, a Phillips screwdriver, a tape measure and a drill.

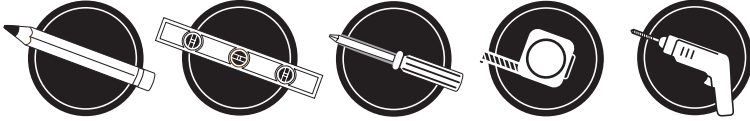

## Choose Wall Fasteners

(Hardware not included.)

You will also need to choose the proper type of wall fastener/anchor for your needs...for example-wood, masonry or drywall. Whenever possible it is always a good idea to locate and utilize wall studs.

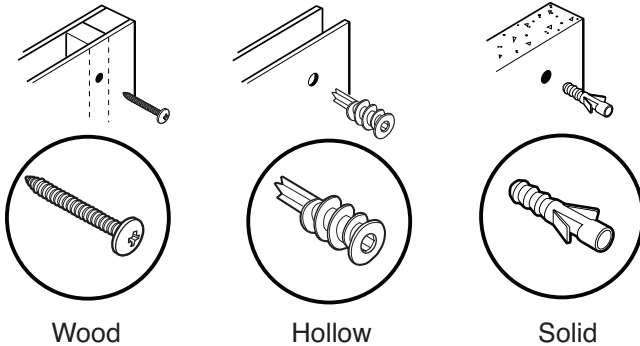

## Step 1

First, determine the location you would like the shelf on the wall by measuring up from the floor and lightly mark the desired location on the wall with your pencil.

## Step 2

Using a pencil, make a light marking on the top of the shelf above the two keyholes (**Fig. 1**) or where you want to install your 2 keyhole brackets.

## Step 3

Position the shelf against the wall and level. Once the shelf is level, mark the wall in the same place where you marked the shelf (**Fig. 2A**) or brackets (**Fig. 2B**) above the keyholes.

## Step 4

Using the drill and a 7/32 bit, make two holes in wall and insert the proper hardware.

## Step 5

Make sure to leave approximately 0.25" overhang when inserting the screws (do not fully insert) **Fig. 3**

**Step 6** Place shelf or brackets securely onto screws. **Fig. 4**

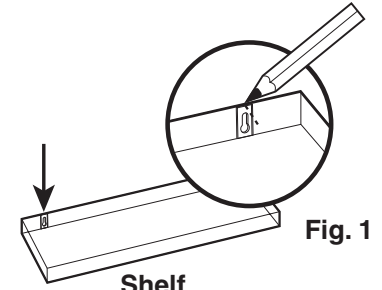

Shelf  
or  
Brackets

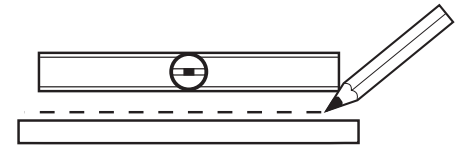
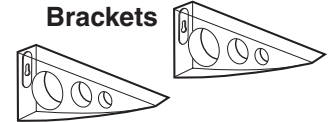

Fig. 2A

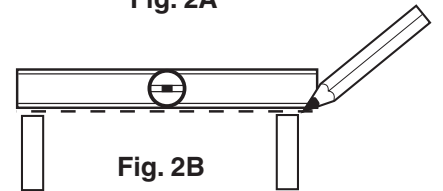

Fig. 2B

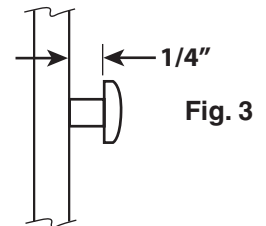

Fig. 3

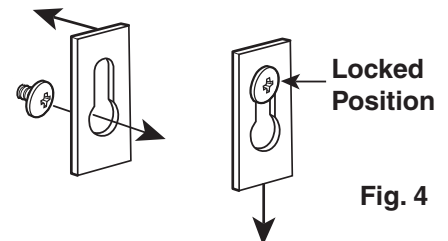

Fig. 4