

RF23M8070SR

SAMSUNG

Samsung Counter-Depth, 4-Door Refrigerator

23 cu. ft. Capacity



Signature Features

FlexZone™

- Versatile, mid drawer fridge compartment with 4 Temperature Control Settings and Smart Divider.

Auto Fill Water Pitcher

- Easily create delicious, refreshing flavored water right from your refrigerator.

Built-In Look

- Sleek, built-in design.

Available Colors



Stainless Steel (shown)



Black Stainless Steel



FlexZone™ Drawer



Auto Fill Water Pitcher

Features

- 4-Door Counter-Depth Design
- 4-Step FlexZone™ Drawer
- Large Capacity – 23 cu. ft.
- Twin Cooling Plus®
- Wi-Fi Ready
- External Filtered Water and Ice Dispenser
- Touch Button Display
- High-Efficiency LED Lighting
- ENERGY STAR® Compliant
- Tempered Glass Spill-Proof Shelves
- Gallon Door Bins
- Two Crispers

Convenience

- Door Alarm
- Water Filter Indicator
- Dispenser Lock
- Energy Saver
- Sabbath Mode

Rating



ENERGY STAR®-rated:
CEE Tier 1
633 kWh/yr

RF23M8070SR

SAMSUNG

Samsung Counter-Depth, 4-Door Refrigerator

23 cu. ft. Capacity

Installation Specifications

1. Measure the height, width and depth of the opening, making sure to include baseboards, molding tile, countertop overhang, etc. Check to be sure there is enough room to open the door (consider walls, islands or other obstacles when measuring).
2. Refer to illustration below to determine dimensions.
3. Allow 2.5" of clearance on hinge side of refrigerator when installing next to a wall where handle may make contact.
4. Allow 1" minimum clearance at rear for proper air circulation and water/electrical connections. Allow a 3/8" minimum clearance at sides and top for ease of installation.
5. Ensure each door and entryway in the home is wide enough for the refrigerator to be moved through easily.

For optimal usage and to be able to open refrigerator doors completely, do not install next to a wall.

Please note: The following dimension and cutout information is for planning purposes only. For complete installation details, consult manual packed with product, or download manual online at samsung.com.

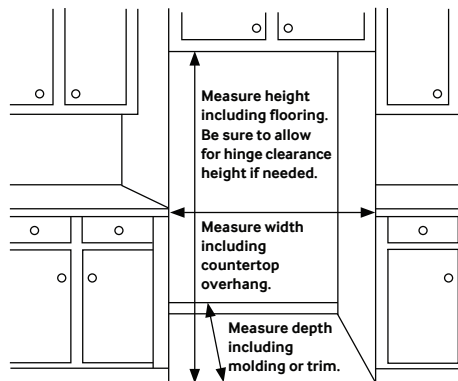

Dimensions

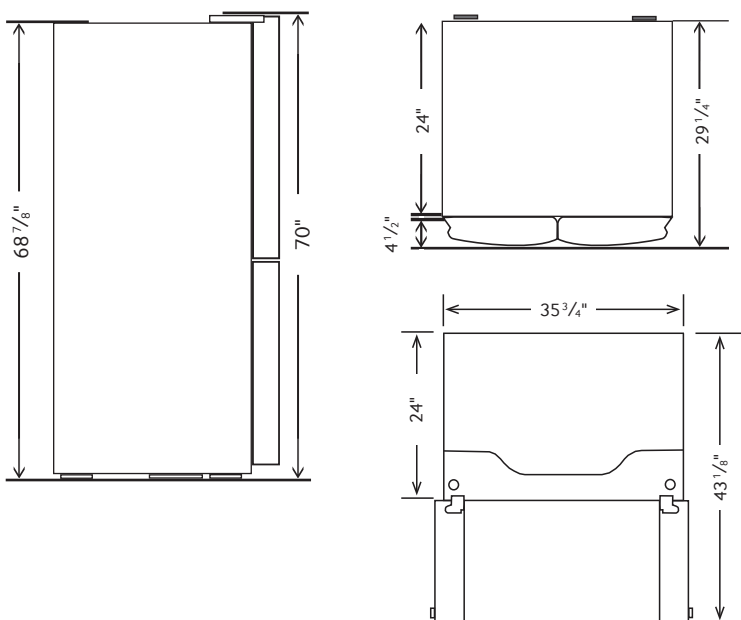

Total Capacity: 22.60 cu. ft.

Refrigerator: 12.9 cu. ft.

- Premium External Filtered Water and Ice Dispenser (Crushed or Cubed Ice)
- High-Efficiency LED Lighting
- 2 Crispers
- 5 Tempered Glass Spill-Proof Shelves
 - 1 Slide-In
 - 1 Foldable Half
 - 2 Fixed
 - 1 Full Width Glass Shelf on Crisper
- 7 Door Bins
 - Right Door: 3 Gallon Bins
 - Left Door: 4 Regular Bins

FlexZone™ Drawer: 3.1 cu. ft.

- 4 Temperature Zones with Smart Divider:
 - Meat/Fish (29°F)
 - Cold Drinks (33°F)
 - Deli/Snacks (37°F)
 - Wine/Party Dishes (42°F)

Freezer: 6.6 cu. ft.

- 1 Drawer Divider
- High-Efficiency LED Lighting

Warranty

One (1) Year Parts and Labor on Refrigerator

Five (5) Years Parts and Labor on Sealed Refrigeration System Only*

Ten (10) Years Parts and Five (5) Years Labor on Digital Inverter Compressor

*Compressor, evaporator, condenser, drier and connecting tubing.

Product Dimensions & Weight

Dimensions (WxHxD with hinges, handles and doors):
35³/₄" x 70" x 29¹/₄"

Dimensions (WxHxD without hinges and door):
35³/₄" x 68⁷/₈" x 24"

Dimensions (WxHxD with hinge and door, no handle):
35³/₄" x 70" x 29¹/₄"

Weight: 341.7 lbs.

Shipping Dimensions & Weight (WxHxD)

Dimensions: 38¹/₄" x 75³/₄" x 31¹/₄"

Weight: 366 lbs.

Color	Model #	UPC Code
Stainless Steel	RF23M8070SR	887276192604
Black Stainless Steel	RF23M8070SG	887276192598

Actual color may vary. Design, specifications, and color availability are subject to change without notice. Non-metric weights and measurements are approximate.

©2018 Samsung Electronics America, Inc. 85 Challenger Road, Ridgefield Park, NJ 07660. Tel: 800-SAMSUNG. samsung.com. Samsung is a registered trademark of Samsung Electronics Co., Ltd.