



*Elizabethan
Classics*

Assembly Instructions for HSKIT10

CAUTION: DO NOT OVER TIGHTEN NUTS AND SCREWS- THIS CAN LEAD TO STRIPPING OR CRACKING AND WILL VOID YOUR WARRANTY.

NOTE: TO BE INSTALLED ONLY BY QUALIFIED, LICENSED PLUMBER

NOTE: USE TEFLON TAPE ON ALL THREADED CONNECTIONS

1. Place the round rubber washer in the riser joint and attach the adapter & shower arm to the rise joint.
2. Place the cone washer around the end of the shower riser that you will fit into the adapter & shower arm diverter. Slide the brass nut onto the other end of the shower riser and slide it down so that it sits on top of the cone washer. Place this end of the shower riser into the top of the adapter & shower arm diverter and tighten the brass nut.
3. Slide the cradle onto the shower riser and secure it in the desired location by tightening the allen screw.
4. Attach the hose to the shower arm diverter and the hand shower. Place the hand shower on the cradle.

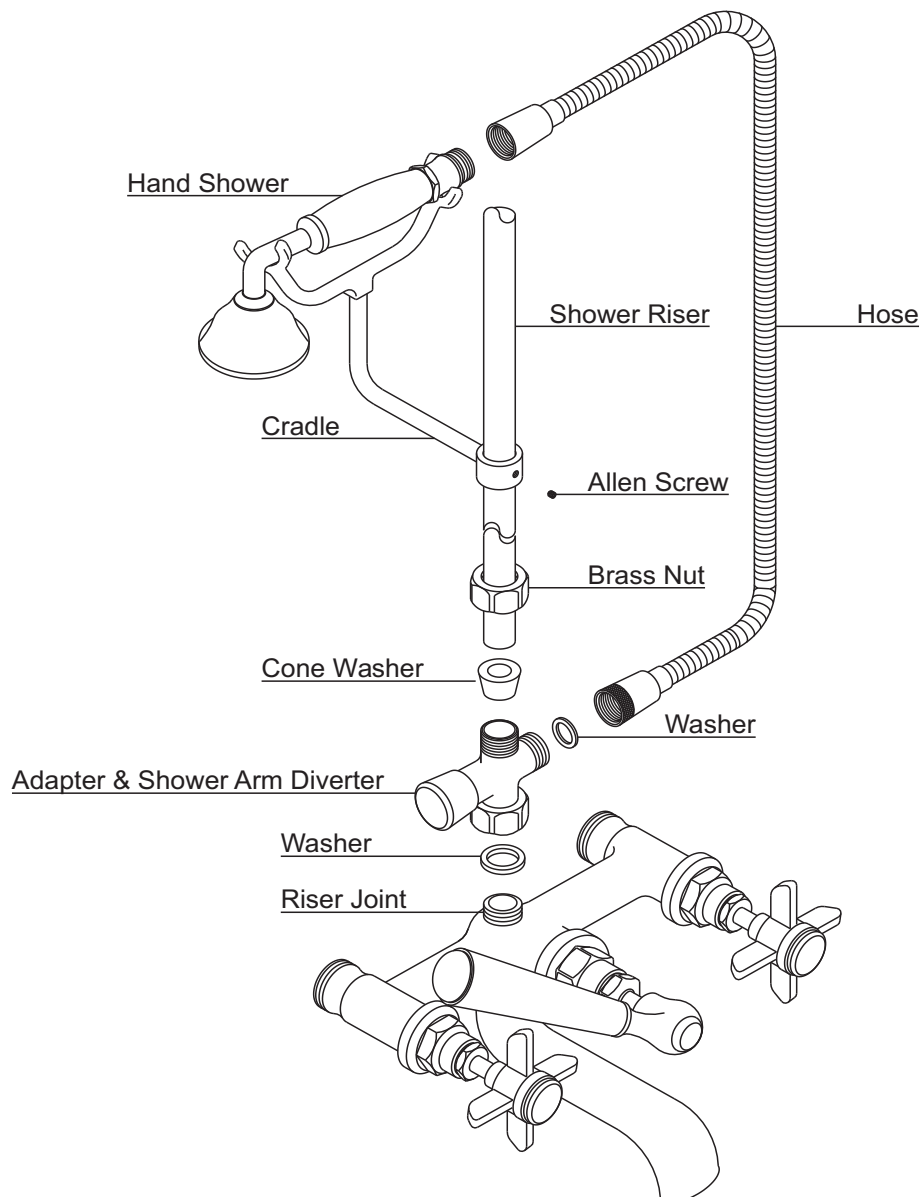

Rev.D