

**UPDATED & REVISED**



**MURPHY DOOR™**  
CREATIVE DOOR SOLUTIONS

# FLUSH MOUNT UNASSEMBLED KIT ASSEMBLY INSTRUCTIONS



# Parts List

## BOOKCASE

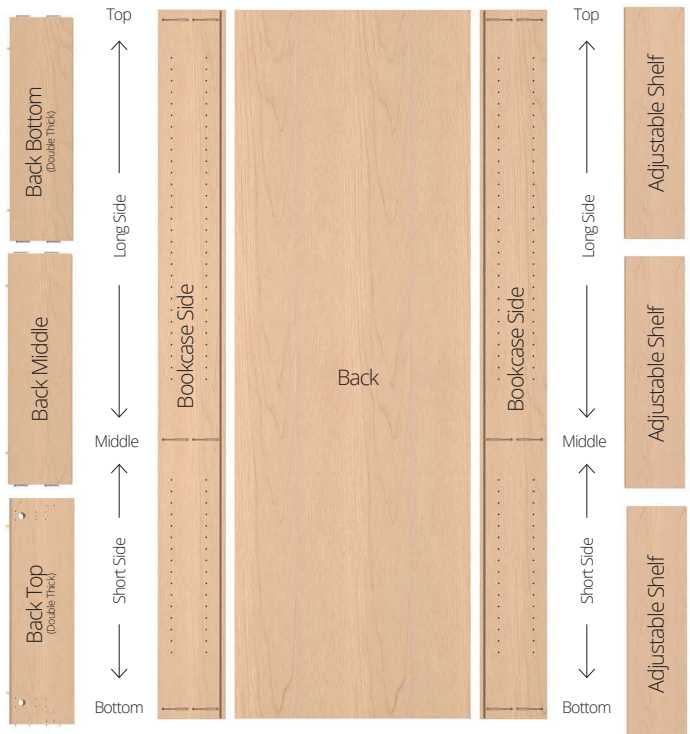

## JAMB

## FACE FRAME

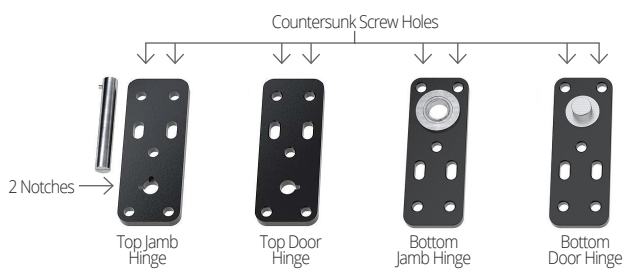
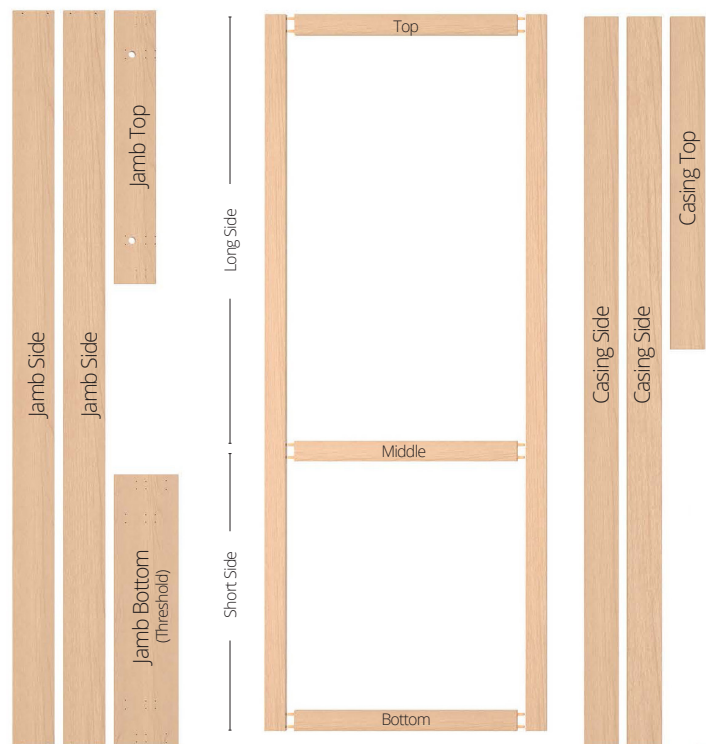

# PLEASE READ INSTRUCTIONS FULLY BEFORE YOU BEGIN ASSEMBLY

## 1 Assemble Face Frame

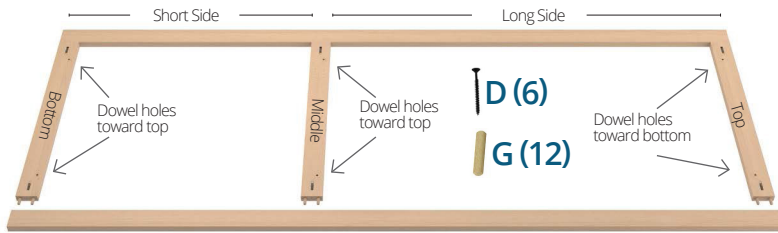

NOTE: Please verify dowel orientation to ensure that they are not installed upside down.

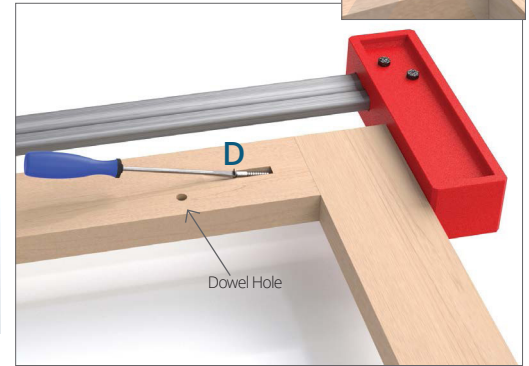
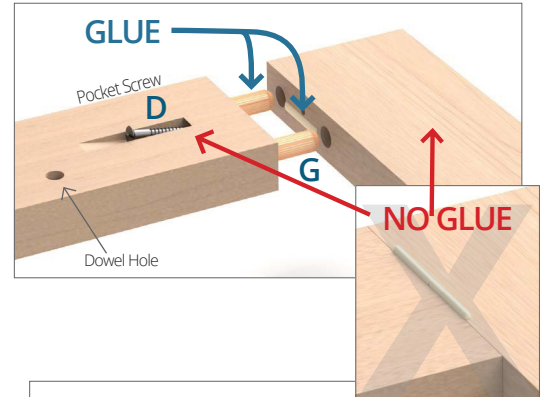

## 2 Assemble Bookcase

NOTE: The top and bottom bookshelf pieces are double thick and the middle piece is just a standard single thickness.

The dowel holes where you will attach the face frame are on the front side of each piece. Make sure that they are all facing outward towards the front of the door when assembling.



(Enlarged View)



Top shelf will have pre-drilled hole where you will drop the hinge pin through. The bottom shelf does not.

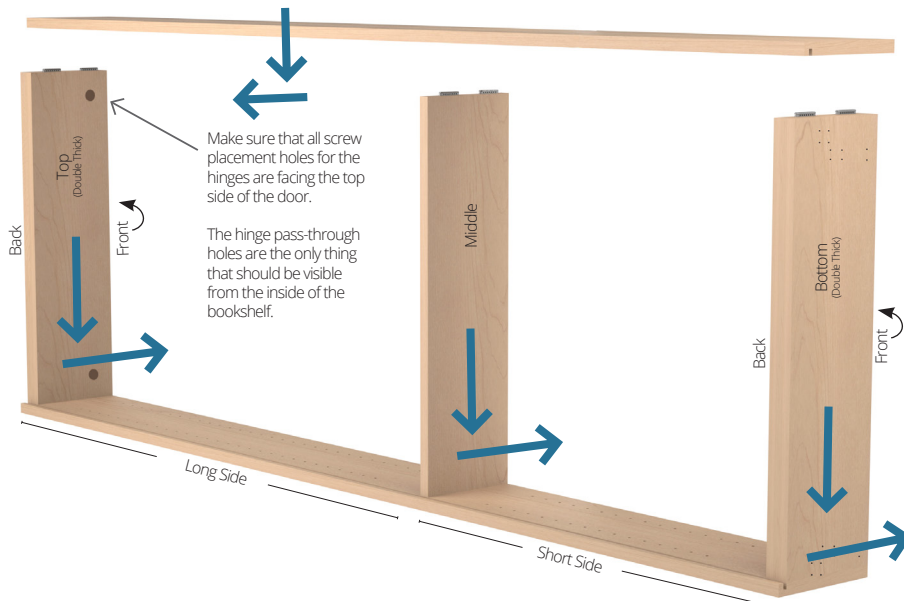

Make sure that all screw placement holes for the hinges are facing the top side of the door.

The hinge pass-through holes are the only thing that should be visible from the inside of the bookshelf.

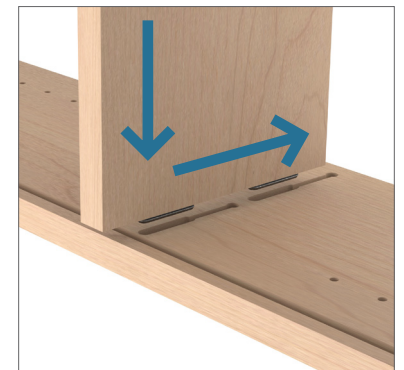



### 3 Set Shelves

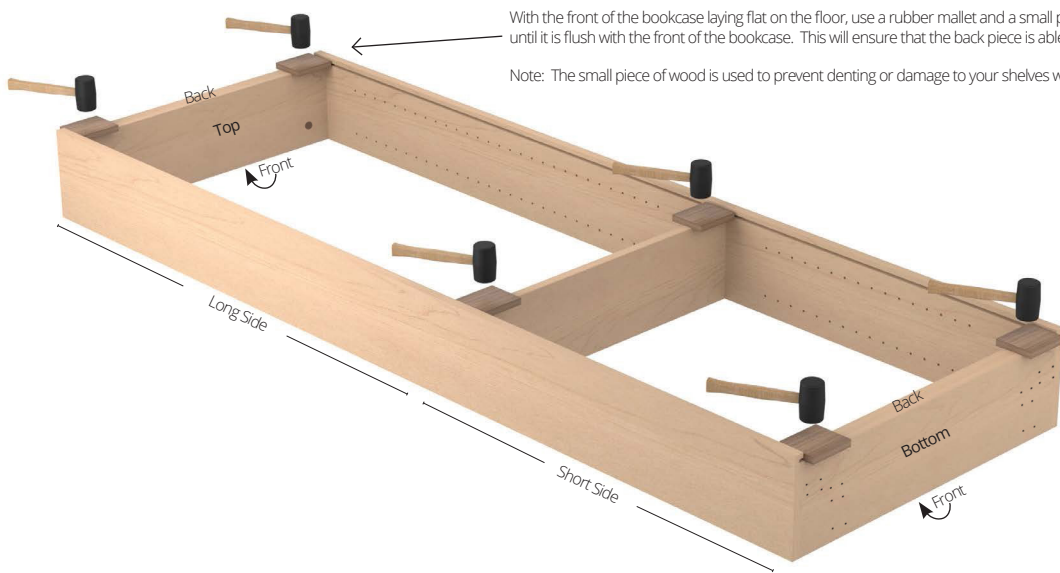

With the front of the bookcase laying flat on the floor, use a rubber mallet and a small piece of wood to tap on each side until it is flush with the front of the bookcase. This will ensure that the back piece is able to slide completely into place.

Note: The small piece of wood is used to prevent denting or damage to your shelves when setting in place.

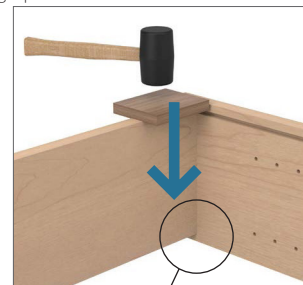

The shelves should be flush with the front of the bookcase when set properly.

### 4 Place Back



It is recommended that you use two people when placing the back to ensure that it slides in straight to prevent it from getting wedged from sliding in crooked.

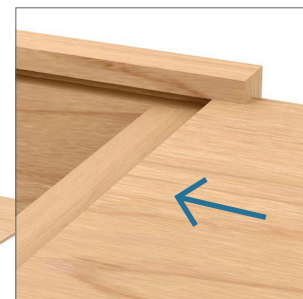

Gently push on bookcase frame to square before fastening the back with screws. Make sure that the back is flush all the way across the top and bottom.

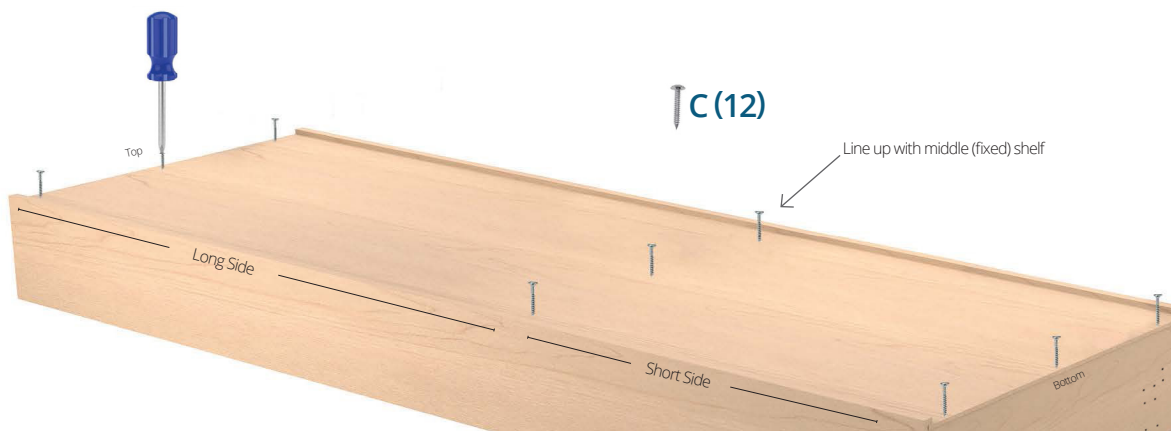

## 6 Fastening Face Frame

Make sure that all dowel holes are facing the front of the door.

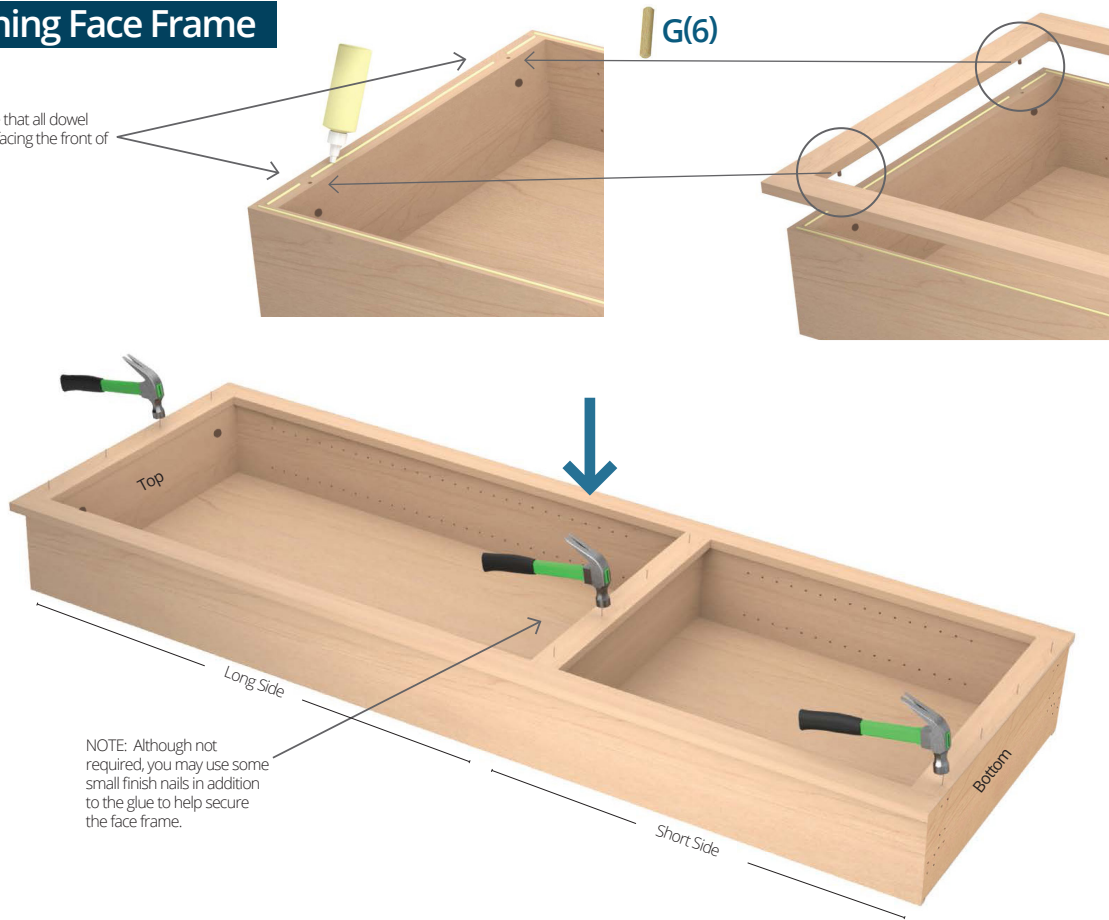

## 7 Assemble Jamb

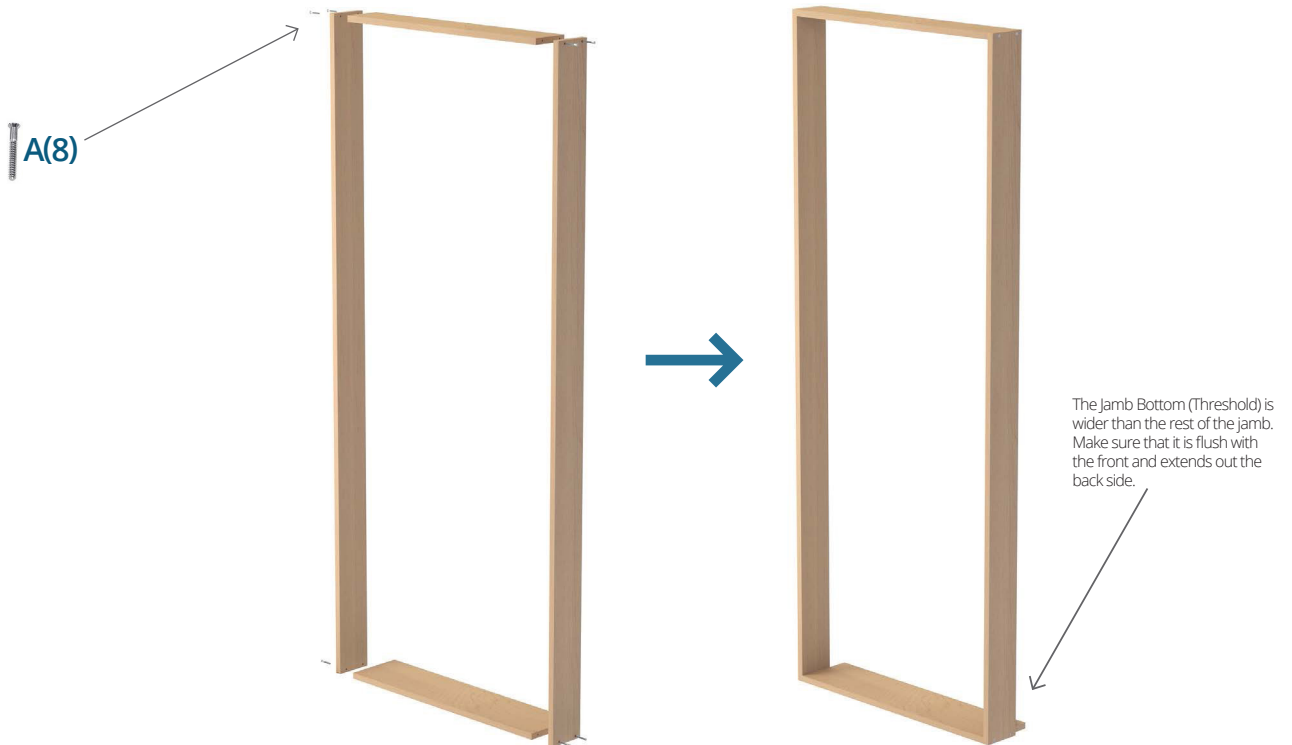

# 8 Out-Swing Hinges

## LEFT HINGE OUT-SWING

## RIGHT HINGE OUT-SWING

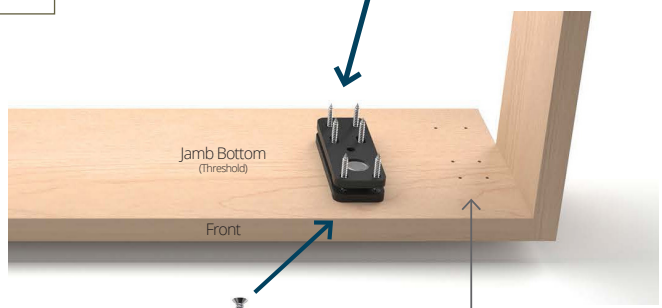
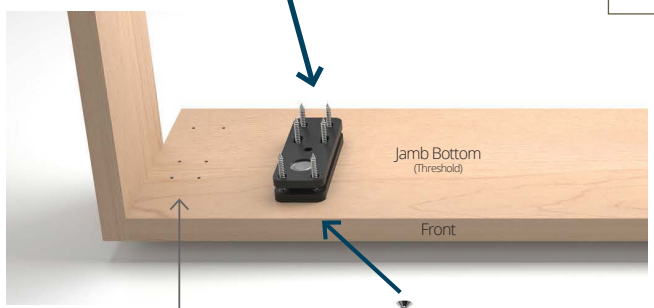
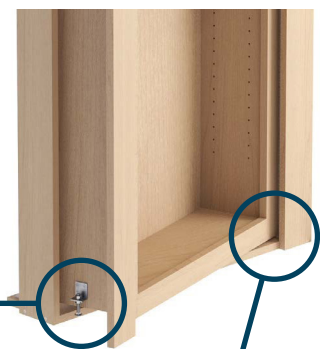
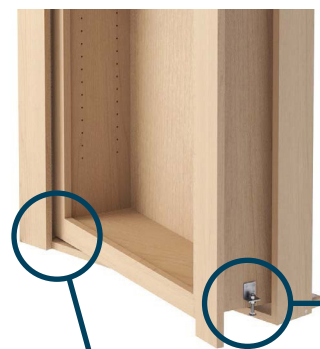
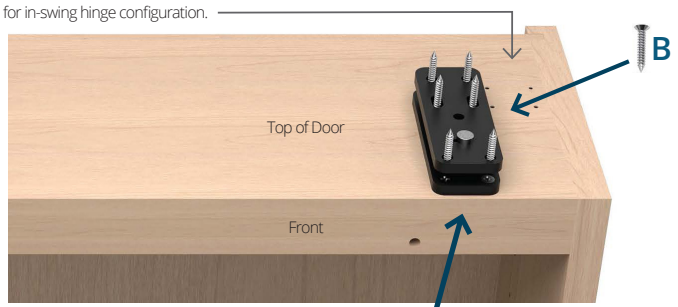
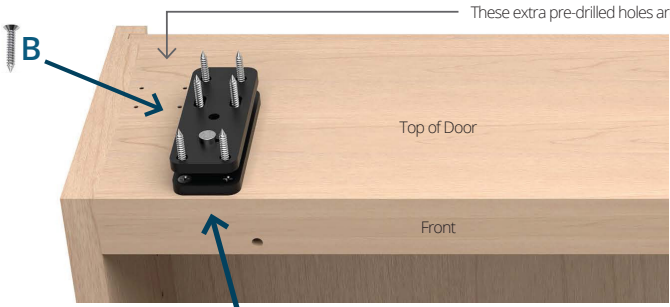

# 8 In-Swing Hinges

## LEFT HINGE IN-SWING

## RIGHT HINGE IN-SWING

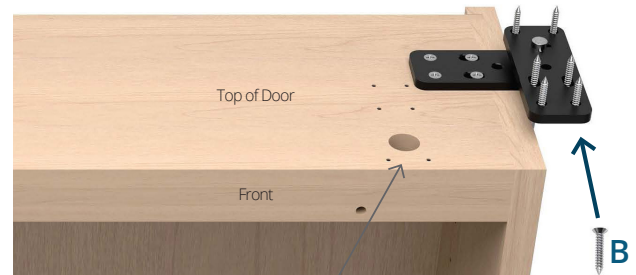
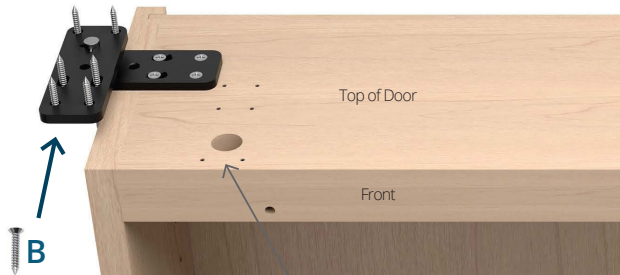

Pre-drilled pattern with hinge pin pass-through hole are only used for out-swing hinge configuration.

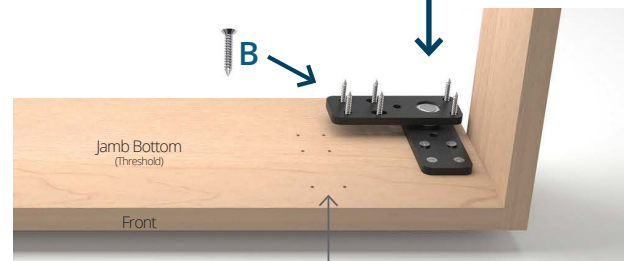
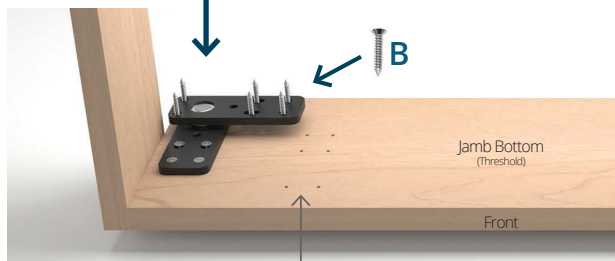
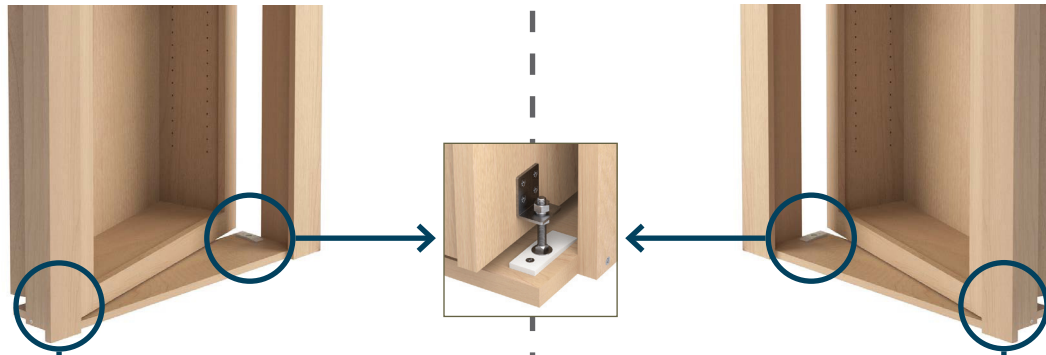

These extra pre-drilled holes are only used for out-swing hinge configuration.

# DOOR BOTTOM LEFT HINGE

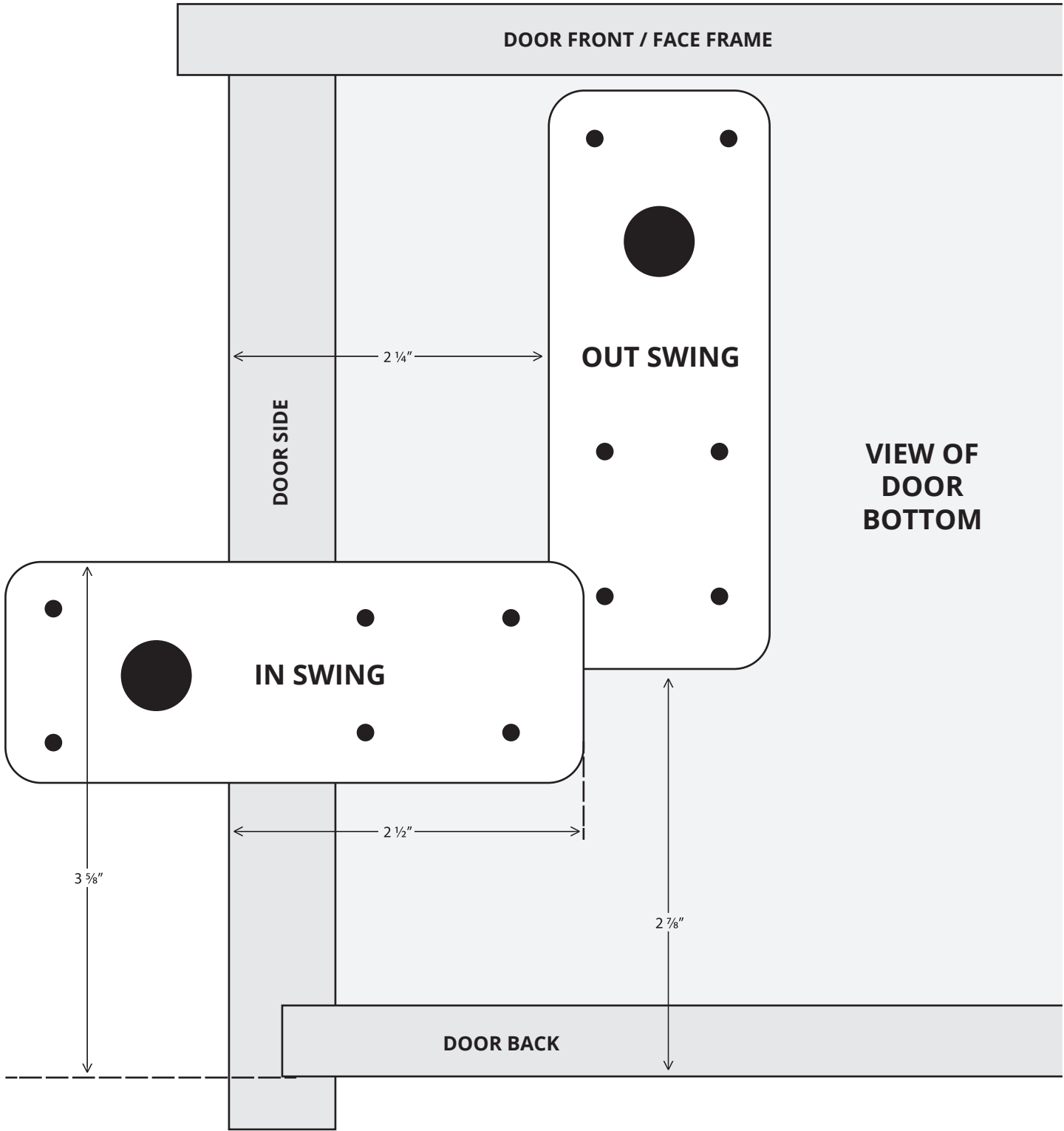



# DOOR BOTTOM RIGHT HINGE

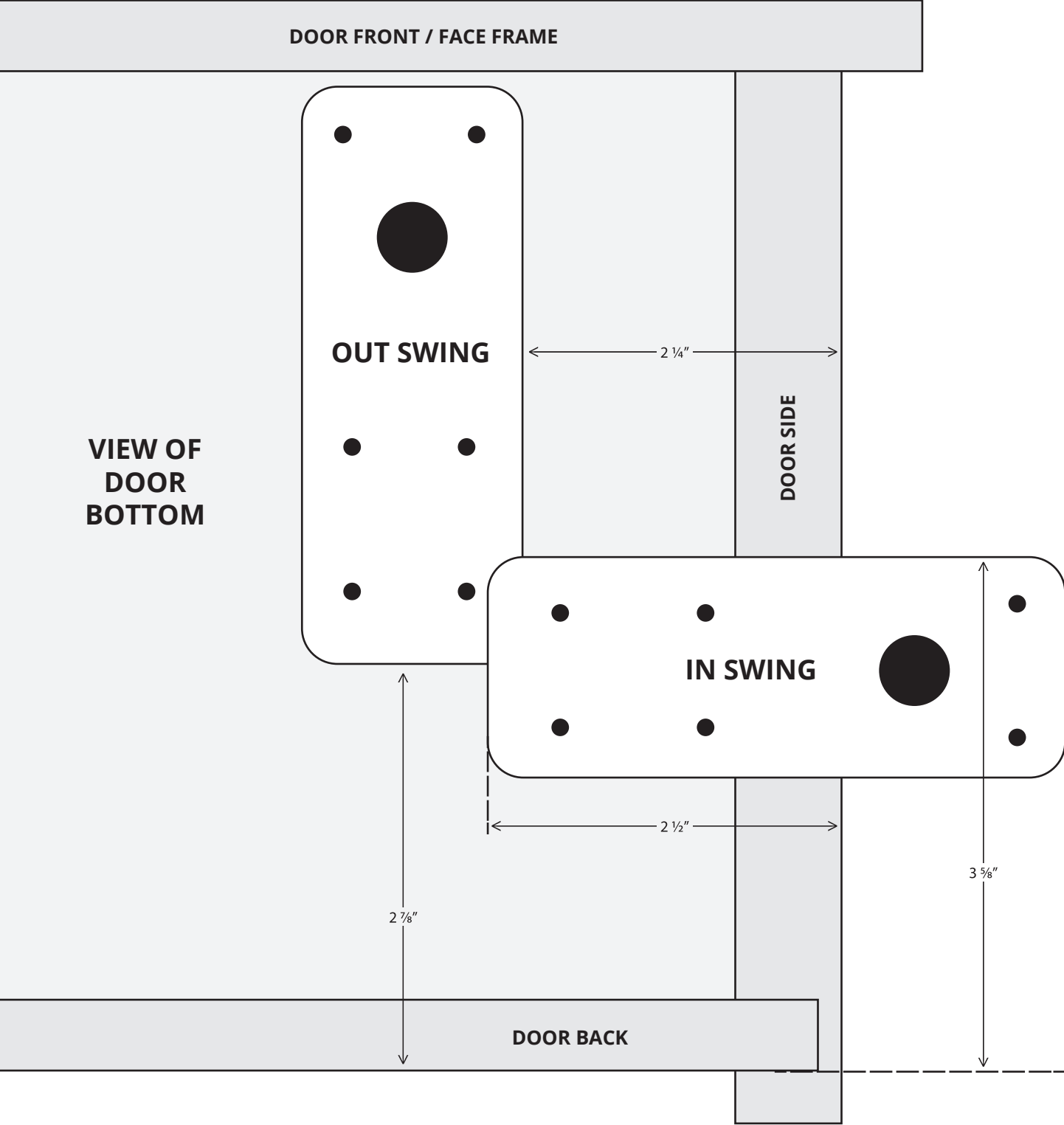

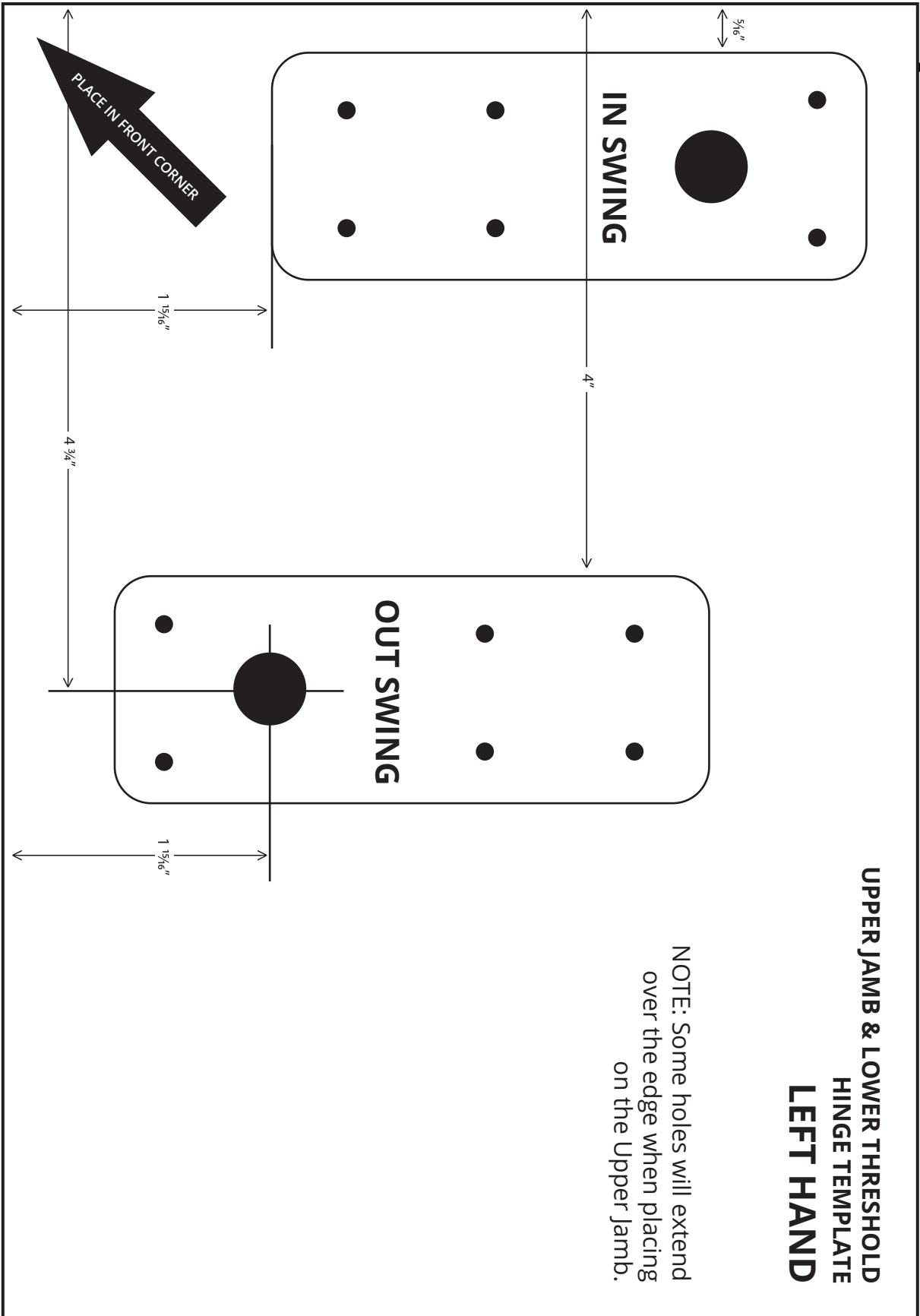

# UPPER JAMB & LOWER THRESHOLD HINGE TEMPLATE RIGHT HAND

NOTE: Some holes will extend over the edge when placing on the Upper Jamb.

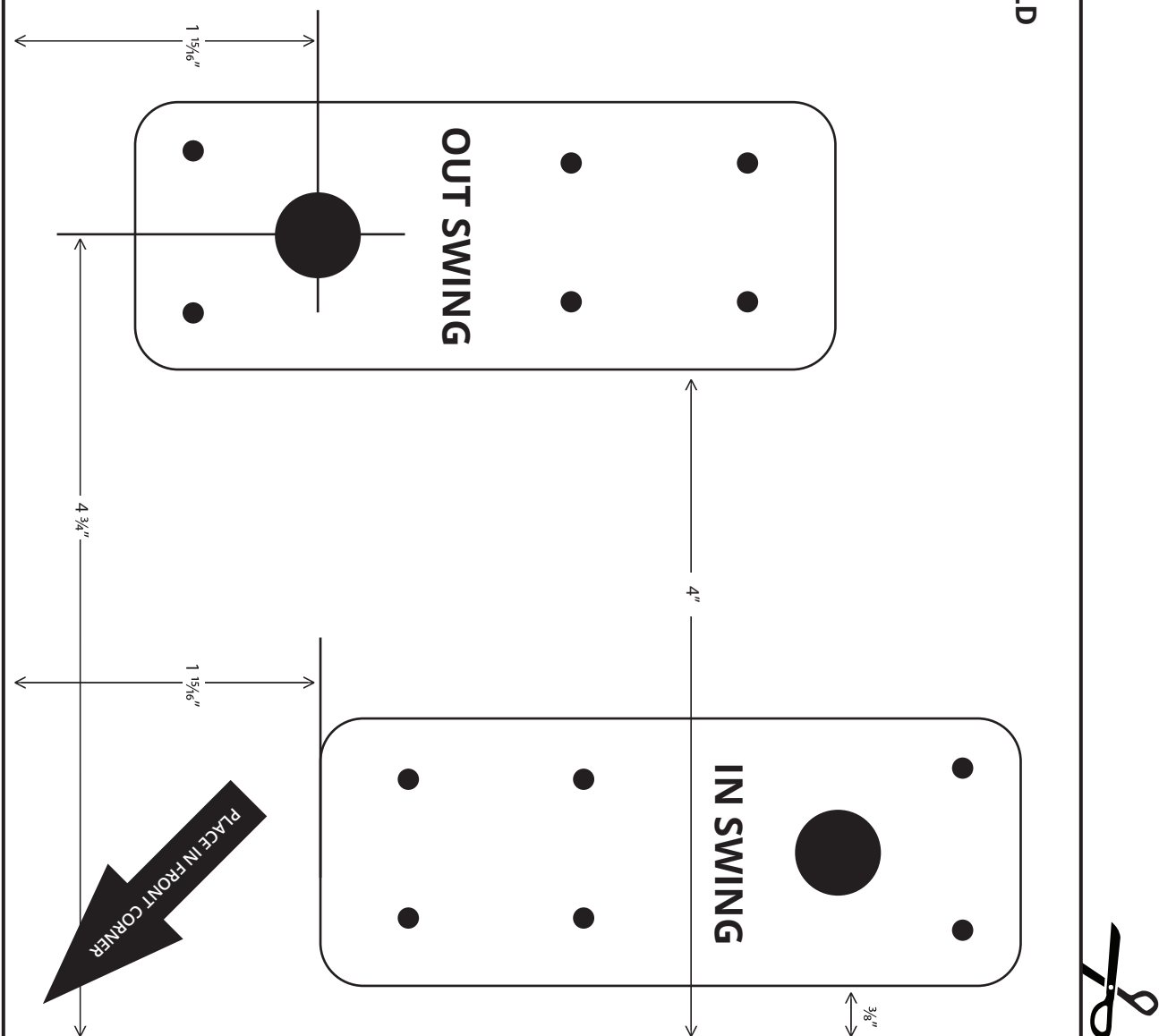



# MURPHY DOOR™

CREATIVE DOOR SOLUTIONS



**Ogden Headquarters**  
3754 Pacific Ave  
Ogden, UT 84405



**Kentucky Distribution  
Center & Showroom**  
2320 Fortune Dr. #180  
Lexington, KY 40509