

88 5558 32
Floral Blossom
 Round Dining Table

IMPORTANT NOTE

Carefully remove all the parts from the carton and put them individually on a soft cloth to prevent scratches or other damages occurring to the wood parts.

We have taken great care in the design of this product and request that you carefully and strictly follow our assembly instructions to ensure a completed product as it was designed.

Home Styles



Part List

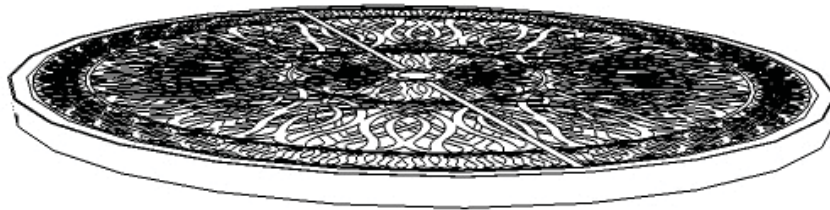

A.
 Top
 1 pc.

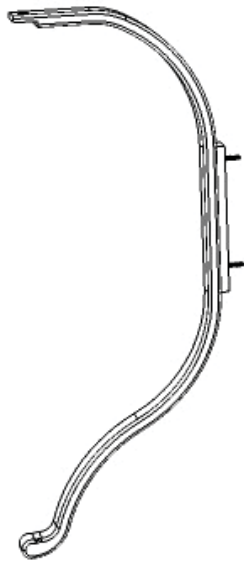

B.
 Leg
 4 pcs.



C.
 Side Frame
 4 pcs.

Hardware List



Key Wrench
 1 pc.



Spring Washer
 12 pcs.(+1 extra)



Nut
 12 pcs.(+1 extra)



Cover
 1 pc.



Bolt
 4 pcs.(+1 extra)



Flat Washer
 12 pcs.(+1 extra)

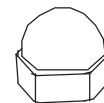

Nut Cap
 12 pcs.(+1 extra)

Tools required for assembly : **Slotted** screwdriver

Tools recommended for assembly : Level

Home Styles Consumer Assistance: www.homestyles-furniture.com,
servicedesk@homestyles-furniture.com, 888-680-7460, 877-831-0319

Assembly Instructions

IMPORTANT

- * Do not tighten up all the screws until each part is properly assembled.
- * You should keep Key Wrench in a safe place as you may need to tighten up the Head Cap Bolts in the future.
- * After assembly, item must be level to work properly. Use the included adjustable levelers to level.

STEP 1

Assemble Side Frames (C) and Legs (B) with Flat Washers, Spring Washers, Nuts and Nut Caps. (See figure 1)

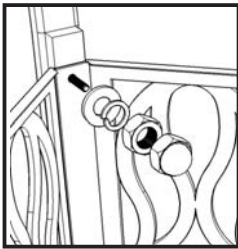

Figure 1

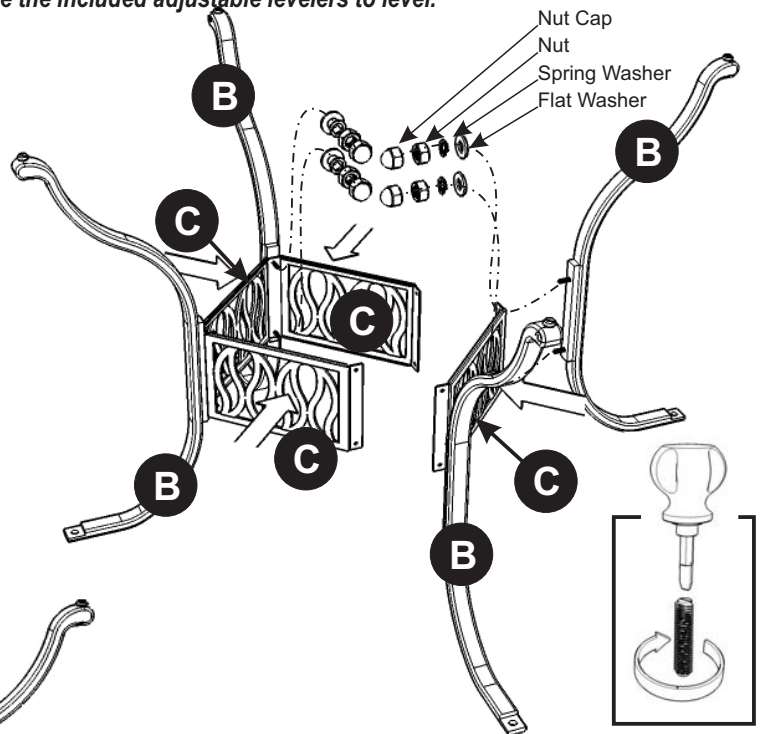
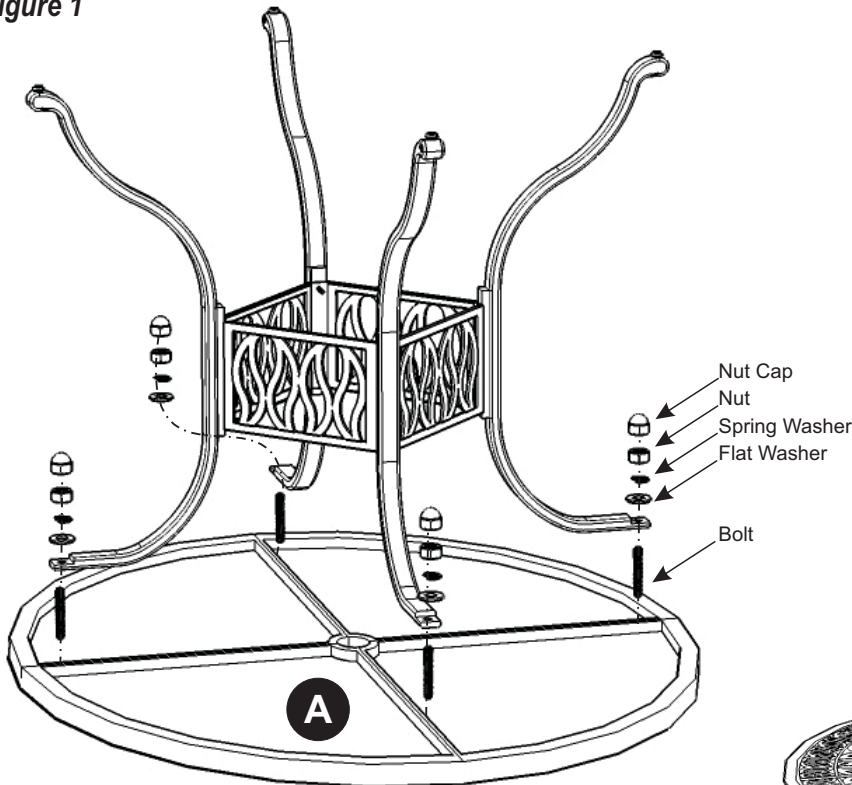

Figure 2

STEP 2

Insert Bolts into the pre-drilled holes of Top (A) by using Slotted Screwdriver. (See Figure 2)

Attach unit of Top (A) with Flat Washers, Spring Washers, Nuts and Nut Caps.



STEP 3

Turn the table to its' upright position.

Cover the umbrella hole with Cover.

To level the table, adjust the adjustable levelers on the bottom of legs. (See Figure 3)

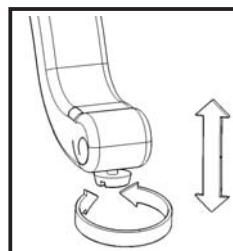

Figure 3

