

Product & Packaging Specs

4x4 Faux Post Base (4x4-FBS-LS)

Item #: 56689

ITEM NO.	QTY.	PART NUMBER	DESCRIPTION
1	4	56689-15	Plate, 4x4 Side Compression
2	0.8	56621	1 1/2" Hex Cap Nut (HCN)
3	0.32	56625	OWT Timber Screw 1-3/4"

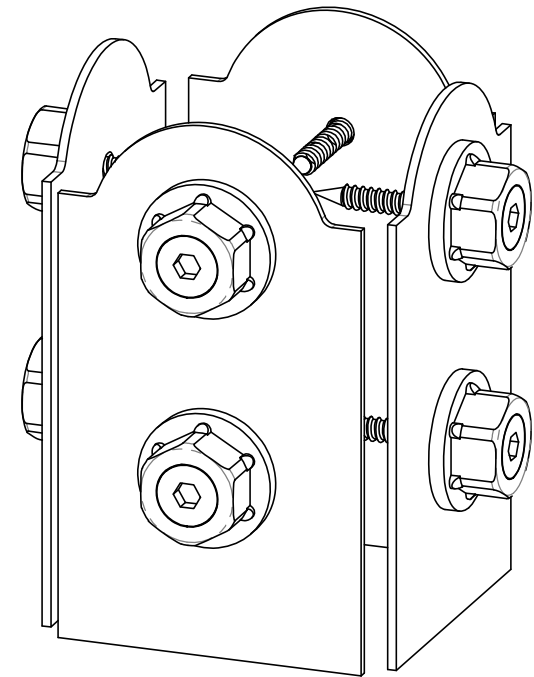
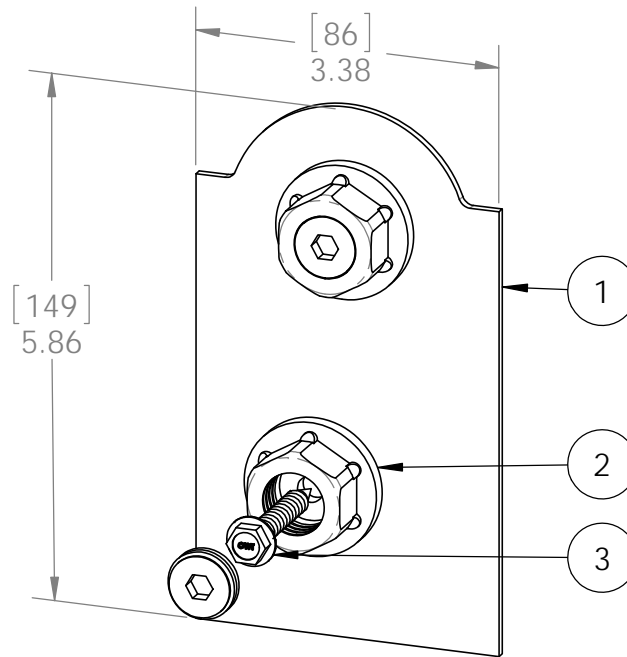
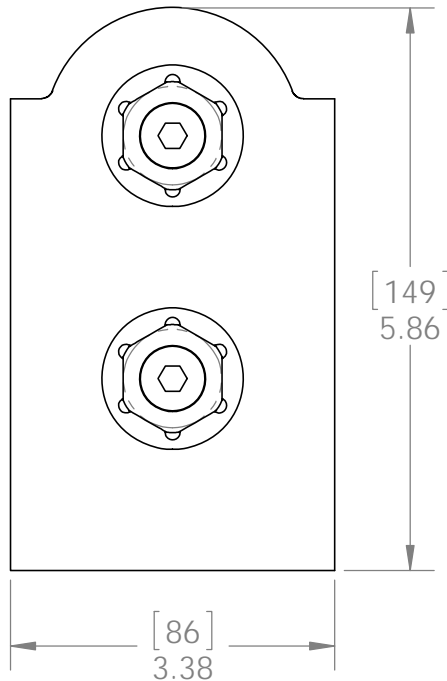
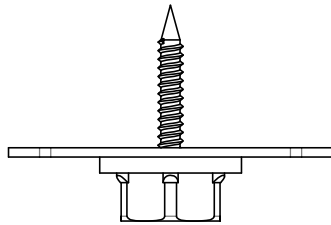

Weight: 0.63 LBS each
Scale: 1:2
Last updated: 10/2/2015

56689

Product & Packaging Specs

4x4 Faux Post Base (4x4-FBS-LS)

Item #: 56689

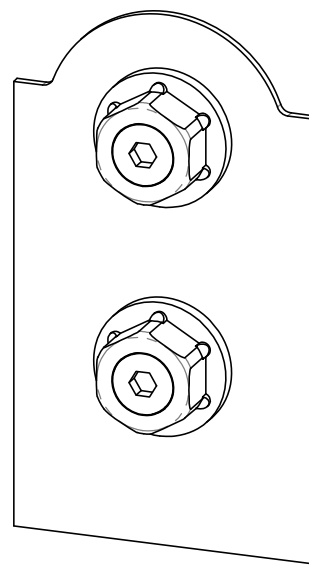
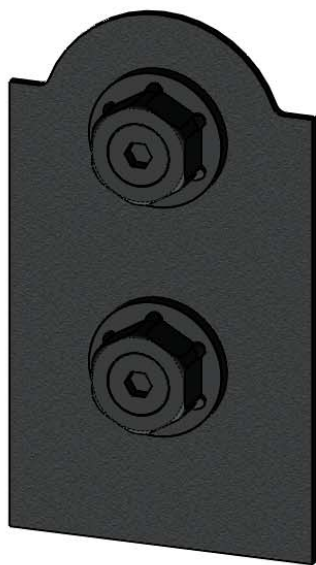

Weight: 0.63 LBS
Scale: 1:2
Last updated: 10/2/2015

56689

Product & Packaging Specs

4x4 Faux Post Base (4x4-FBS-LS)

Item #: Typical Installation & Basic Assembly

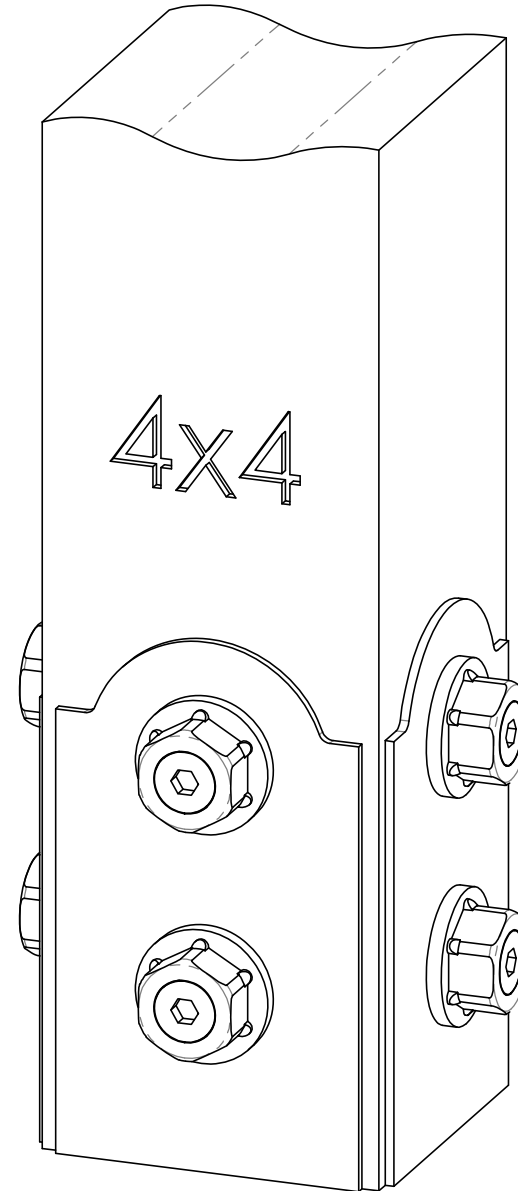

Weight: 0.63 LBS
Scale: 1:2
Last updated: 10/2/2015

56689

Product & Packaging Specs

4x4 Faux Post Base (4x4-FBS-LS)

Item #: Typical Installation & Basic Assembly

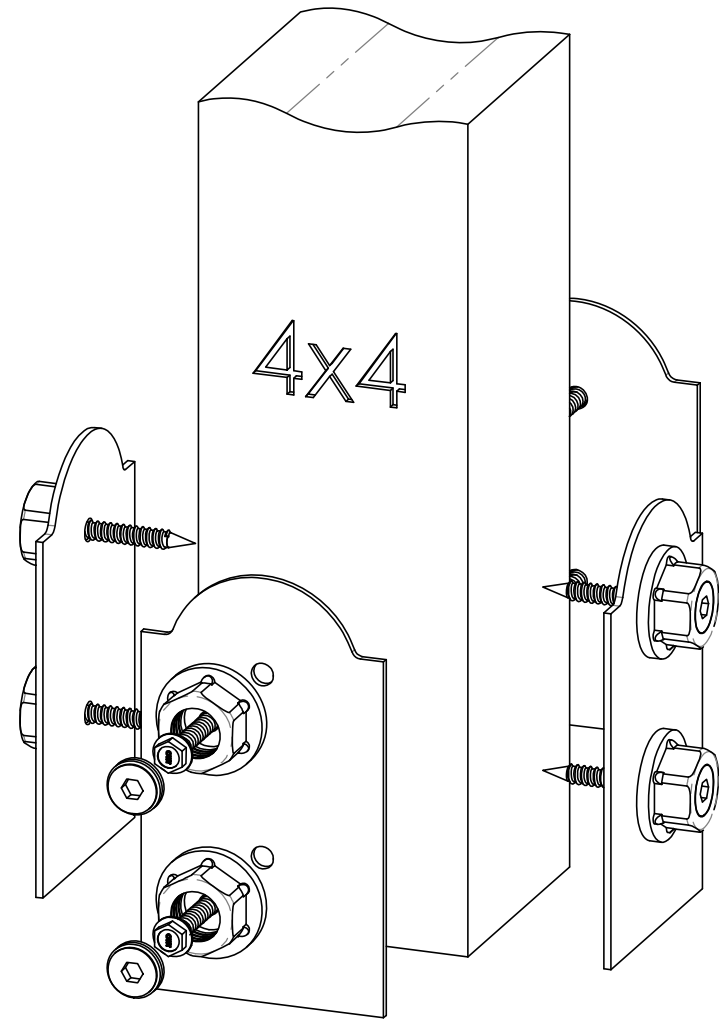

Weight: 0.63 LBS
Scale: 1:2.5
Last updated: 10/2/2015

56689

Product & Packaging Specs

Box, 56689

Item #: Box

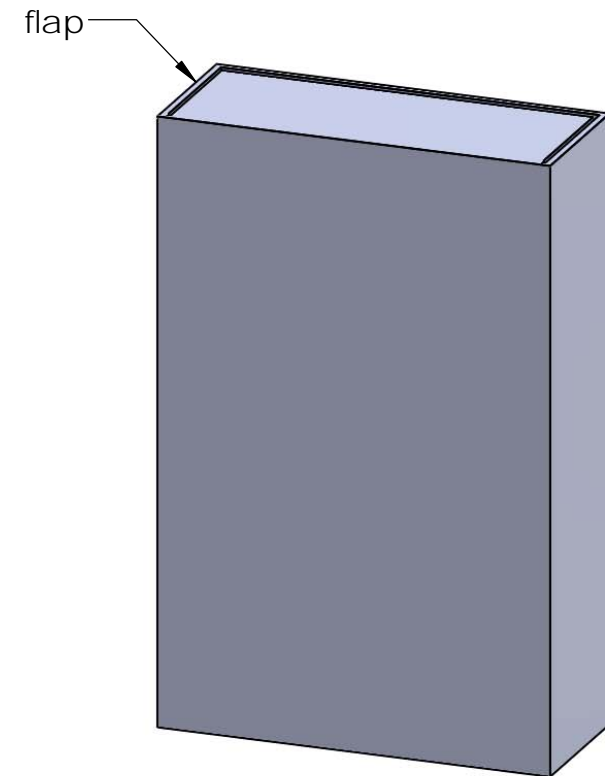
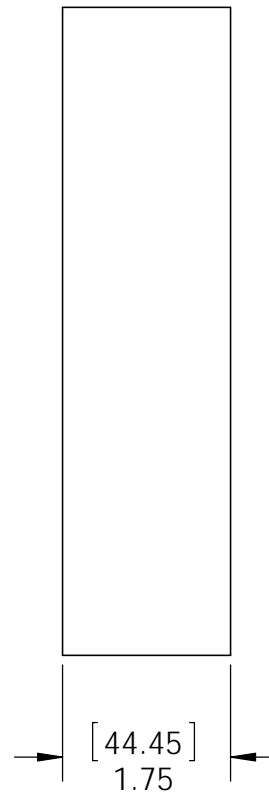
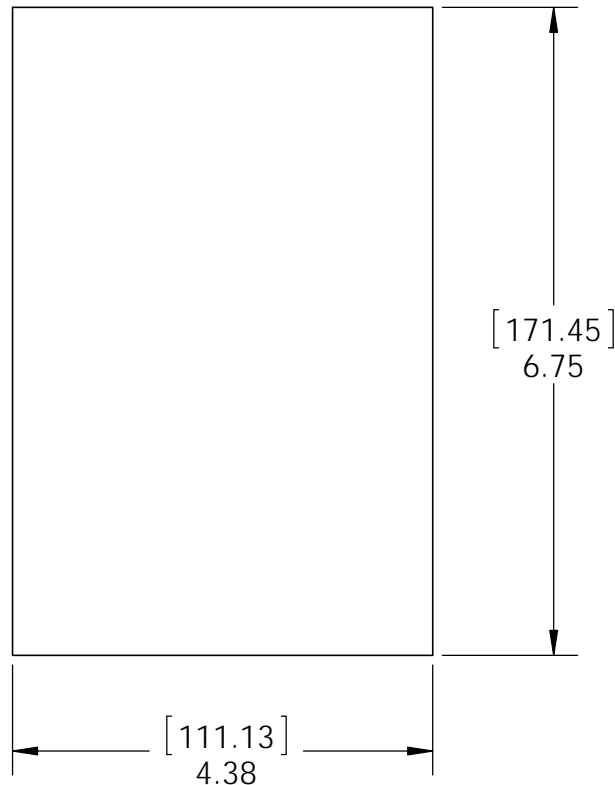

Material: Corrugated Paper
Finish: See artwork
Weight: 0.04 LBS
Scale: 1:2
Last updated: 10/2/2015

56689

Product & Packaging Specs

56689 Packing

Item #: Box packing

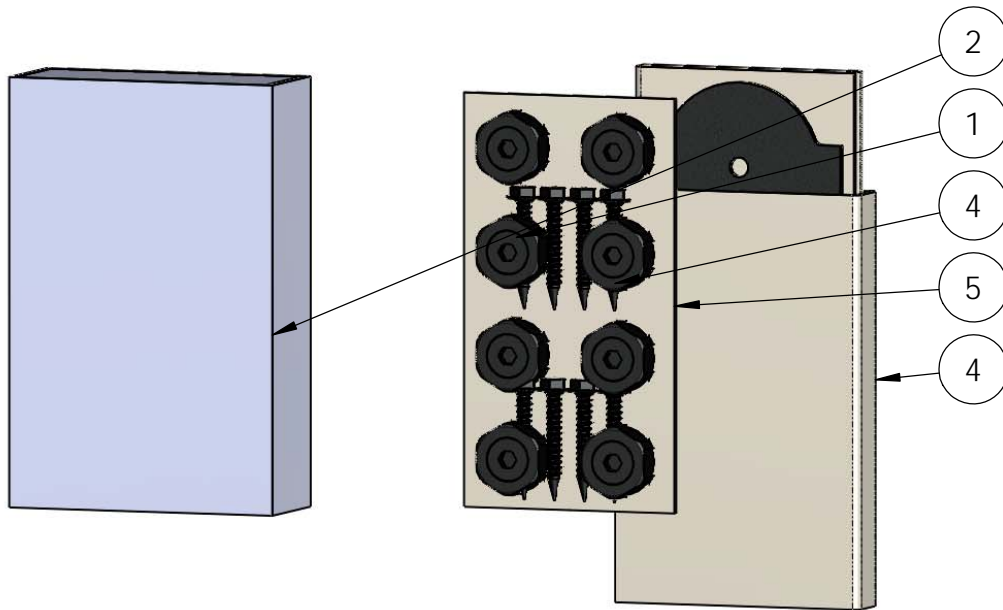

ITEM NO.	Box packing/QTY.	PART NUMBER	DESCRIPTION
1	1	56689	4x4 Faux Post Base (4x4-FBS-LS)
2	1	Box, 56689	Box, 56689
3	1	Sleeve, 56689 Plate	Sleeve, 56689 Plate
4	1	Box, 56689 Plate	Sleeve, 6x6 Faux Post Plate
5	1	Sleeve Insert, 56689 HCN	Insert, 56689 HCN
6	1	Bag, 4x6 packing	Bag, 4x6 Packing

item 6 utilized for screws (not shown)

add foam or other equivalent spacer inside box to consume space and secure product

Weight: 2.64 LBS
Scale: 1:3
Last updated: 10/2/2015

56689

Product & Packaging Specs

Case, 56689

Item #: Case

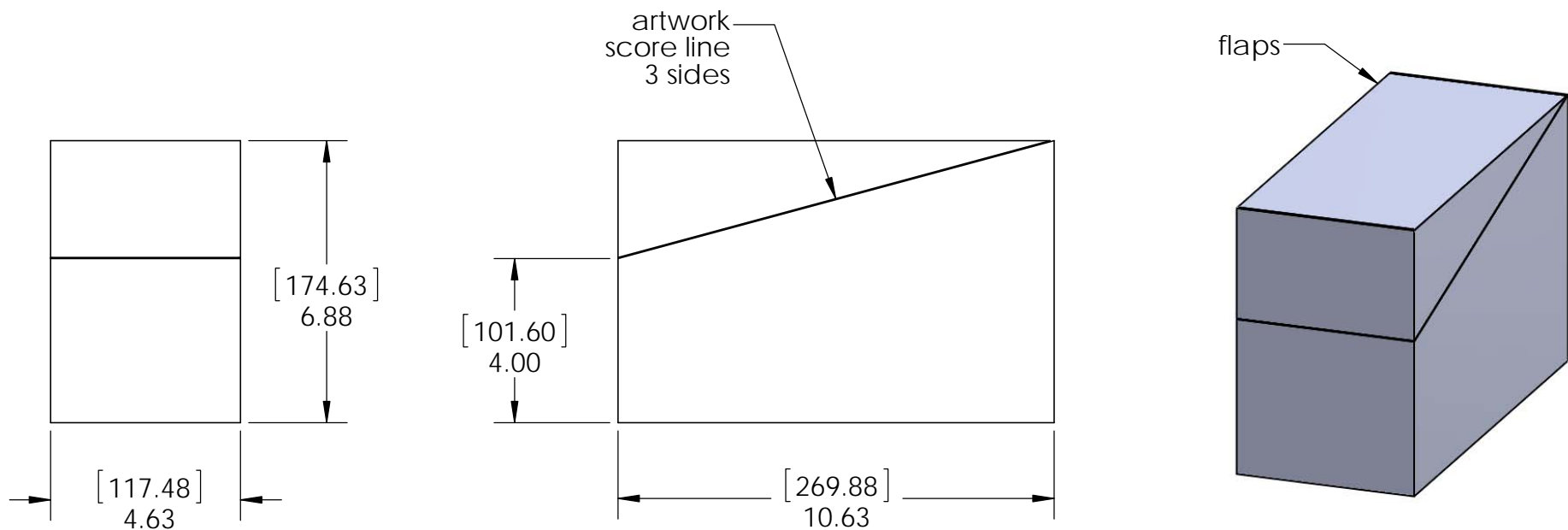

Material: Corrugated Paper
Finish: See artwork
Weight: 0.08 LBS
Scale: 1:4
Last updated: 10/2/2015

56689

Product & Packaging Specs

56689 Packing
Item #: Case packing

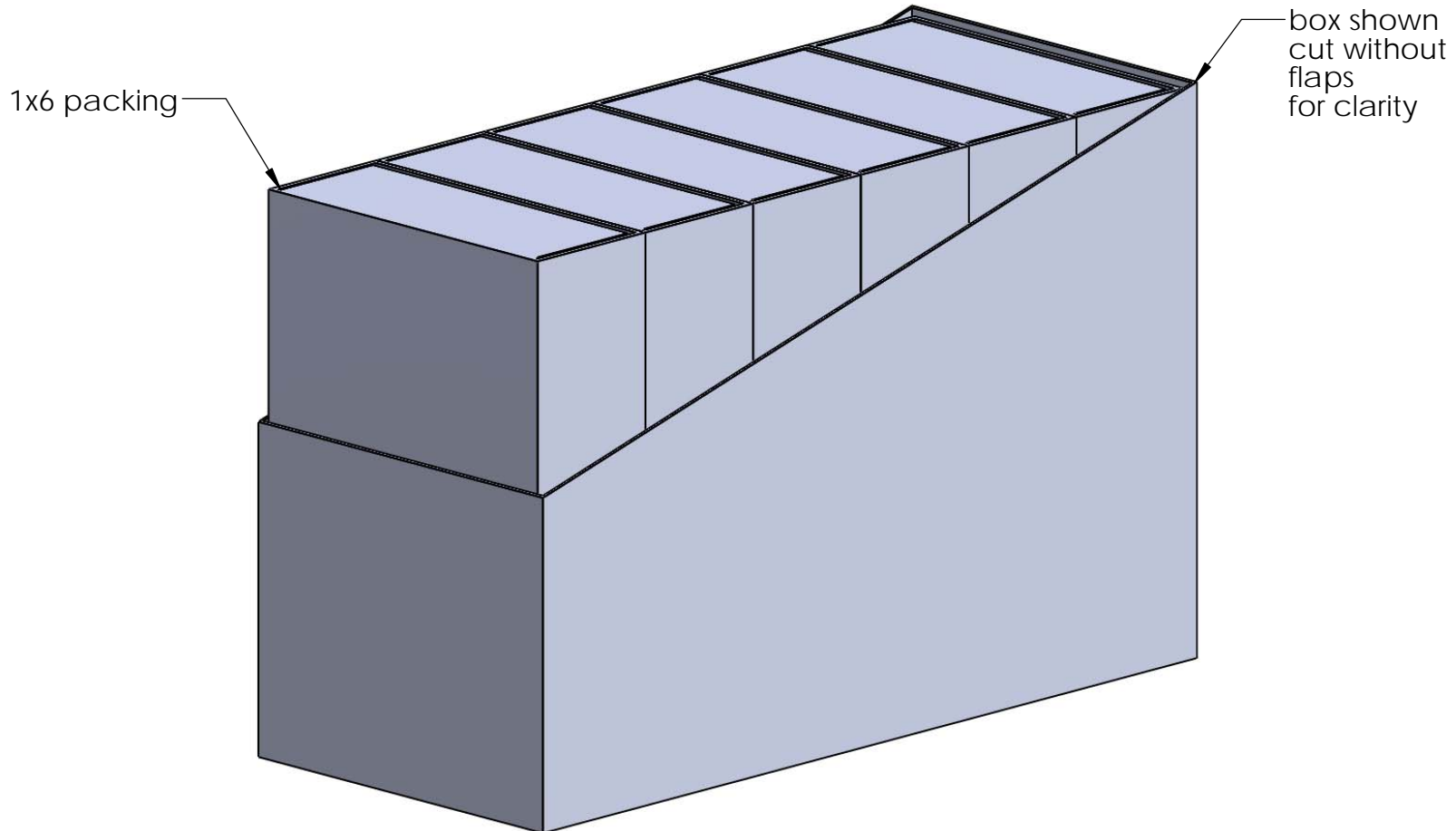

Weight: 16 LBS
Scale: 1:2
Last updated: 10/2/2015

56689

V1.00 - Installation Instructions effective May 1, 2015 and reflects information that available as of April 10, 2014. This information is updated periodically and should not be relied upon after May 1, 2015. Please visit www.OZCOBP.com to get current information

Product & Packaging Specs

56689 Packing
Item #: Pallet packing

ADD NEW PALLET LABEL

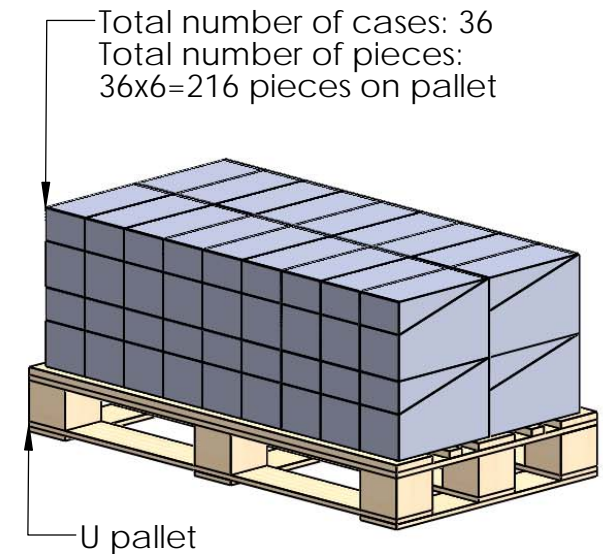
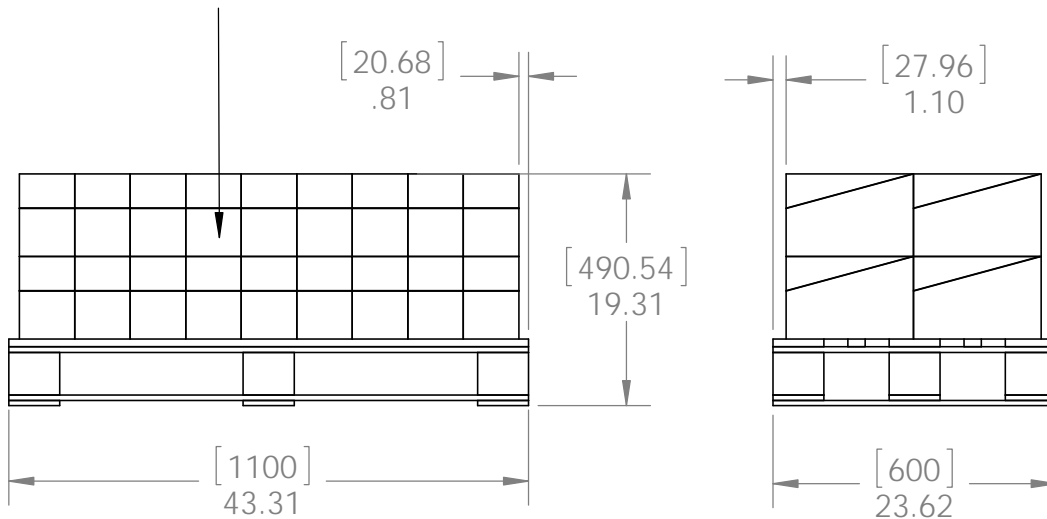

Weight: 620 LBS
Scale: 1:16
Last updated: 10/2/2015

additional pallet packing instructions
plywood on top layer
strap to pallet
clear wrap around boxes

56689