



Adding a Camera to the NVR

Before you get started, you will need:

**Disclaimer: The exact components of your product, images, and quantities may vary depending on your model number.*

Wired IP Camera & Accessories

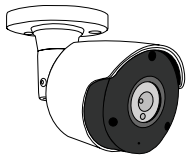

Camera(s)



Dome(s)

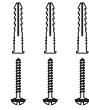

Mounting Hardware



Waterproof Cable Cover(s)

Item Not Included

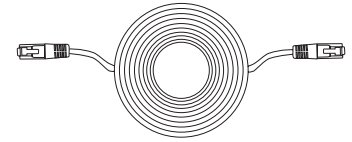

Ethernet Cable(s)

NOTE: Cameras can be powered by Ethernet cables or a power adapter. Camera power adapter not included.



Connect and test all cameras locally (near NVR) before mounting.

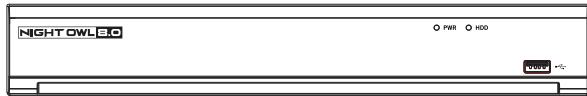
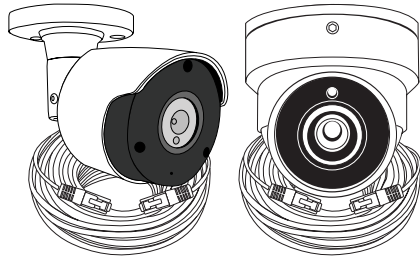

ETHERNET CABLE

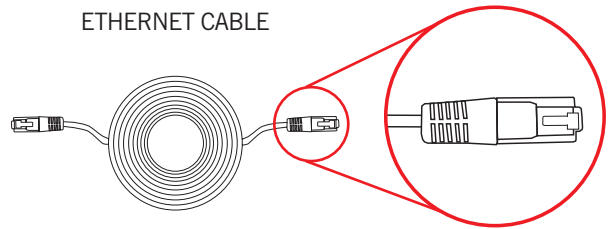

ETHERNET CABLE

WATERPROOF CABLE COVER



- 1** **OPTIONAL STEP:** Insert one end of the Ethernet cable into the cable cover as shown in the image above.

ETHERNET CABLE WITH COVER

CAMERA CABLE

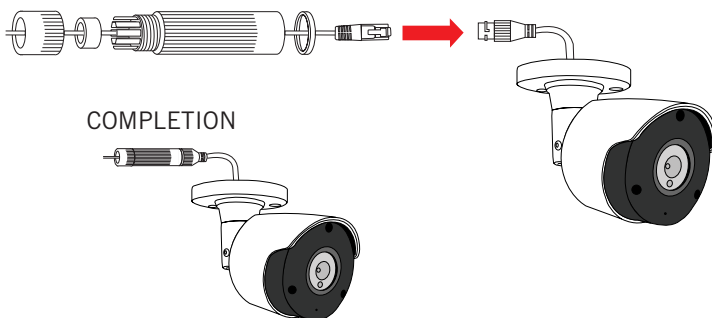

- 2** Connect the covered end of the Ethernet cable to the camera's power cable.

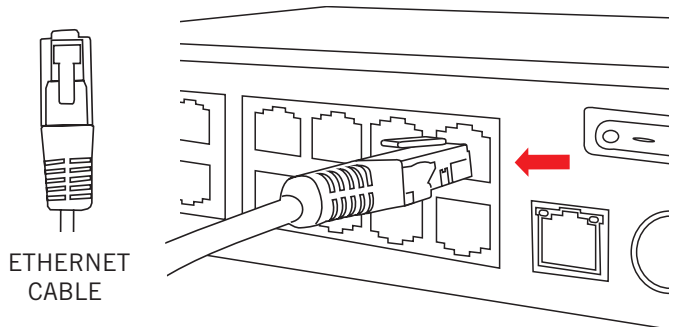

- 3** Input the other end of the Ethernet cable into an open Ethernet port on the back of the NVR.

NOTE: Make sure Ethernet cable is securely connected.



Camera Installation

Before you get started, you will need:

**Disclaimer: The exact components of your product, images, and quantities may vary depending on your model number.*

Cameras & Accessories

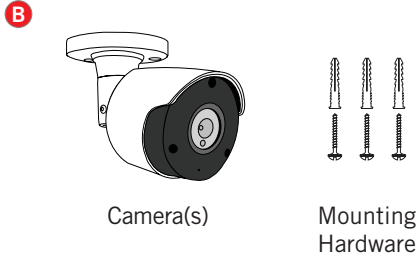
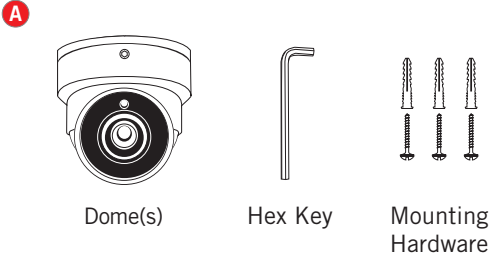

Items Not Included

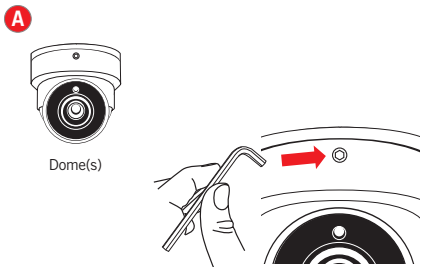
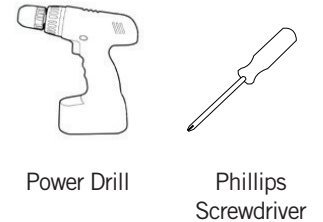

1 ONLY FOR DOME CAMERA: Remove the mounting base using the hex key.

NOTE: Please ensure you mount the camera at least 7 ft. above the ground and angle it slightly down for optimal recording.

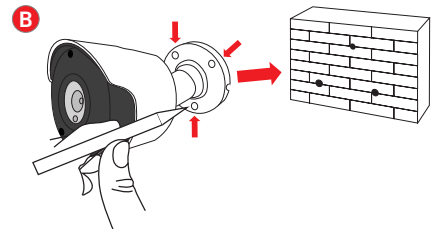
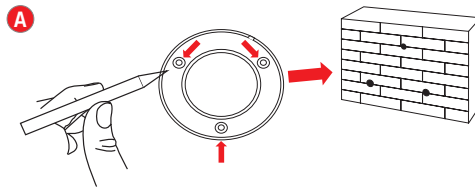

2 Using the holes in the mounting base **A** or the camera's mounting bracket **B**, mark your screw positions on the surface where you plan to mount the camera.

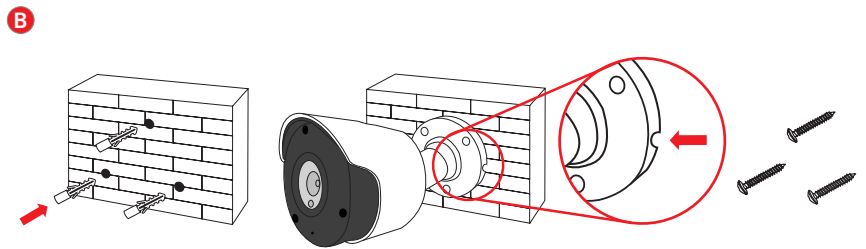
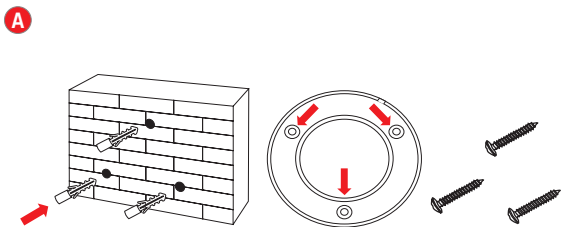

3 Using a drill bit slightly smaller than the included screw anchors, drill into the mounting surface using the guide marks. Insert the screw anchors. Line up the camera base holes with the screw anchors. Holding the mounting base **A** or mounting bracket in place **B**, insert screws and tighten until secure.

NOTE: If your Ethernet cable is not being run through a wall/ceiling, use the cut out on the mounting base/bracket.

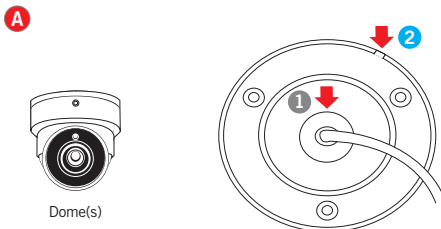

4 ONLY FOR DOME CAMERA: If your Ethernet cable is being run through a wall/ceiling, insert the cable through the center ring **1** of the mounting base before mounting. Cable not being run through a wall/ceiling? Use the cut out **2**.

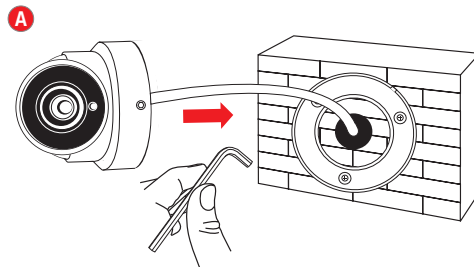

5 ONLY FOR DOME CAMERA: Make sure screws are securely fastened. Attach the dome camera to the mounting base using the hex key.

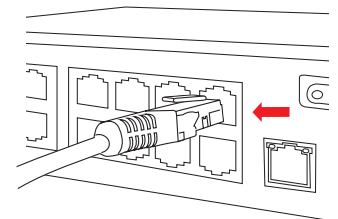

6 Once mounting is complete, connect your camera to the NVR to complete installation.