

EXP

# DECOUPLING, DRAINAGE SEALING, INSULATION

**DURAL**

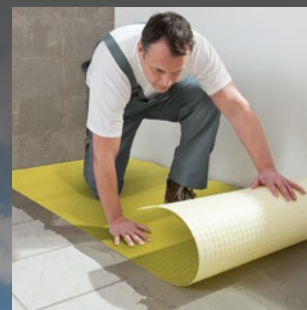
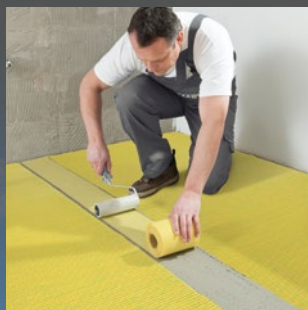
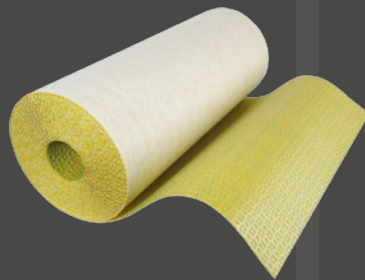
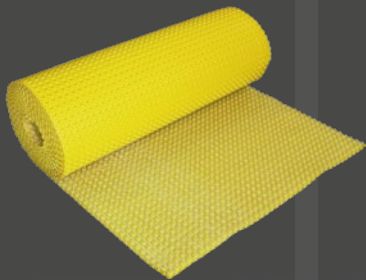

DURABASE CI++

DURABASE WP

DURABASE WP++

DURABASE DD80++

DURABASE DD80

DURABASE SW

PLATON STOP

ACCESSORIES

# DURABASE

Decoupling, drainage, sealing and insulation – four complementary and overlapping areas. A wide range of offers is available on the market, however, these products often simply improve or optimise one aspect. To guarantee a truly effective and permanent safety, all components must be perfectly matched to one another.

Decoupling, drainage, sealing and insulation in a single system.

The DURABASE solutions are the result of many years of experience and the consistent, rigorous further development of components in line with technical progress. Perfectly matched to one another, they simplify installation work and guarantee the secure protection of tiled and natural stone surfaces, as well as parquet, laminate or design flooring.



PRODUCT	APPLICATION	PROPERTIES	APPLICATION AREAS	PAGE
CI++	The matting system for decoupling with a sealing effect for tiled surfaces in indoor and outdoor areas	<ul style="list-style-type: none"> <li>Decoupling of problematic subsurfaces</li> <li>Tiles can be laid over screed as soon as it is possible to walk on the screed without causing damage</li> <li>Prevents the formation of cracks</li> </ul>	Freshly laid installation subsurfaces (reduction in construction times), wooden subsurfaces indoors, cracks in the foundation	4
WP	Compound sealing mat for walls and floors in indoor areas	<ul style="list-style-type: none"> <li>Sealing in areas with extremely high moisture levels</li> <li>High adhesive tensile strength</li> <li>Suitable for the production of flooring that is resistant to chemicals</li> </ul>	For bathrooms and wet rooms in private dwellings and public buildings	6
WP++	The matting system for composite sealing with a decoupling effect in indoor and outdoor areas	<ul style="list-style-type: none"> <li>Compound sealing for high stress</li> <li>Decoupling effect with crack bridging</li> <li>High loading capacity during installation</li> </ul>	Shower facilities and surrounding areas of swimming pools, terraces and balconies (not suitable for installation over used rooms)	8
DD 80++	Drainage mats for highly water-permeable flooring structures in outdoor areas	<ul style="list-style-type: none"> <li>For laying on gravel/grit beds, screed or directly onto the subfloor</li> <li>Extra high drainage capacity</li> <li>Also ideal for large loads</li> </ul>	Terraces, balconies, pavements, swimming pool surrounding areas	10
DD 80	The matting system for the double drainage of ceramic tiled surfaces outdoor areas	<ul style="list-style-type: none"> <li>Double-sided drainage channels (double drainage)</li> <li>Extremely high water drainage capacity</li> <li>Installation below screed/gravel bed</li> </ul>	Terraces, balconies	12
SW	The matting system for footfall noise and thermal insulation in dry indoor areas	<ul style="list-style-type: none"> <li>Extremely high footfall noise insulation</li> <li>High thermal insulation</li> <li>Also suitable for installation over existing old flooring</li> </ul>	Living rooms, offices, stairwells	13
PLATON STOP	The matting system that protects parquet and laminate flooring from damp and provides footfall noise insulation	<ul style="list-style-type: none"> <li>Exceptional protection against damp</li> <li>Extremely high footfall noise insulation</li> <li>Also suitable for installation on freshly laid screed</li> </ul>	Living rooms, bedrooms, offices	14

PRODUCT	CI++	WP	WP++	DD80++	DD80	SW	PLATON STOP
Tiles	+++	+++	+++	+++	+++	+++	-
Natural stone	+++	+	+++	+++	+++	+++	-
Parquet / laminate	-	-	-	-	-	++	+++
Indoor areas	+++	+++	++	-	-	+++	+++
Outdoor areas	+++	+	+++	+++	+++	-	-
Decoupling	+++	-	++	+	+	-	-
Sealing	++	+++	+++	+	+	-	++
Drainage	-	-	-	+++	-	-	-
Crack bridging	+++	+	++	+	+	-	-
Thermal insulation	-	-	-	-	-	++	+
Footfall noise insulation	-	-	-	-	-	+++	+++

# DURABASE CI++

The matting system for decoupling with a composite sealing action for tiled surfaces in indoor and outdoor areas



With its triple-layer construction, the multifunctional DURABASE CI++ matting system offers so much more than simply decoupling. The crack-bridging properties of the mat and its optimised shear force protection enable new tiles to be laid on old and damaged tiled floors, provided that these are still load-bearing.

With freshly laid screed, it is possible to lay tiles on fresh screed as soon as installation is possible even from its fast and simple processing and optimal installation reliability and quality make it ideal for renovation projects and for installation on mineral subsurfaces which have not dried out sufficiently.

- Tiles can be laid once the subsurface can be walked on
- Decoupling of problematic subsurfaces
- Protecting against cracks

## DURABASE CI++

Material: Polypropylene

Colour: Yellow

Width: 100 cm

Height: 3 mm

Roll: 5, 10, 30 m<sup>2</sup>

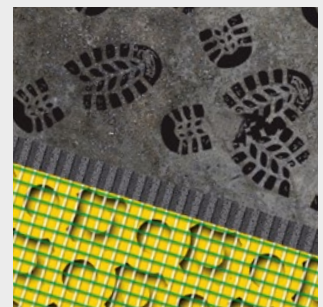
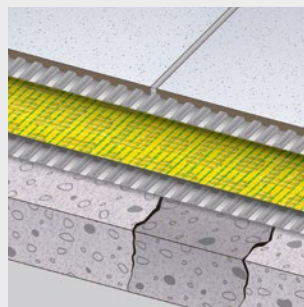
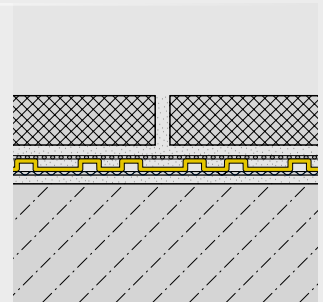

## Application areas

### Cracks in the subfloor

When renovating older floors, cracks can be present in the subfloor, making it impossible to install a safely watertight new tiled surface.

### Damp from the subfloor

When laying onto anhydrite screed, residual moisture from the screed itself can collect under the tiles and cause damage to the adhesive layer.

### Stresses in the subfloor

In the underlying structures below the flooring it is possible for stresses to occur, depending on the structural design and the types of materials employed. These stresses can be transferred to the tiled surface, leading to the formation of cracks.

## Properties

Used in conjunction with tiles, the DURABASE CI++ decoupling mat functions as a stress-reducing intermediate layer, bridges any cracks and has a waterproofing function.

It also facilitates compensation for water vapour pressure if residual moisture is present. DURABASE CI++ decouples the flooring from the foundations. Any small cracks can also be bridged so that they do not affect the tiled surface.

This makes it ideal for renovation work. With DURABASE CI++, tiles can be laid over screed as soon as it is possible to walk on the screed without causing damage (residual humidity approx. 4 %). Calcium sulphate screeds, which are sensitive to humidity, are protected at the surface from the ingress of further moisture. For large format tiles, DURABASE CI++ provides additional protection against stress cracks.

## Triple-layer construction

- **Webbed special polypropylene backing fleece = Higher fleece stability for better bonding with the installation subsurface**
- **Optimised dimple geometry = Lower adhesive consumption**
- **Coextruded mesh fabric = Optimal tensile adhesion strength**

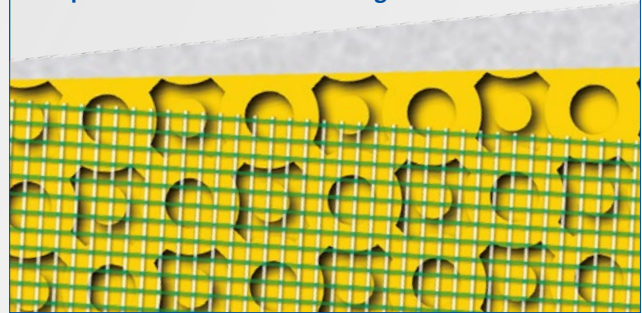

## Shearforce optimisation

Shearforces within a flooring surface usually occur due to differing shear stresses between the subsurface and the tiling. With rigid, shear-resistant tiling, shearforces can cause unsightly cracks to form in the tiled surface.

If a DURABASE CI++ decoupling mat is used as a stress-absorbing intermediate layer, the special three-layer structure of the mat absorbs the damaging shearforces so that the tiling remains permanently crack-free.

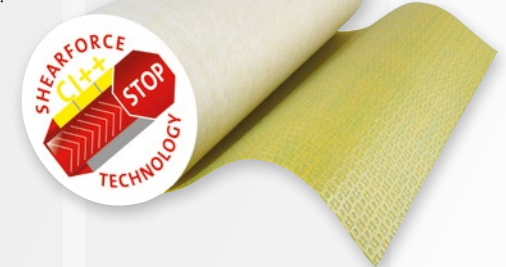

## Installation

Bond the DURABASE CI++ mat (with the fleece fabric face down) to the subsurface using flexible tile adhesive (serrated trowel 4 mm). Cover the mat junctions with sealing tape. Then press the flexible tile adhesive through the mesh fabric across the entire surface of the depressions, then apply the adhesive using the serrated trowel and lay the tiles onto the CI++ mat. Please refer to the installation instructions at [www.dural.com](http://www.dural.com).

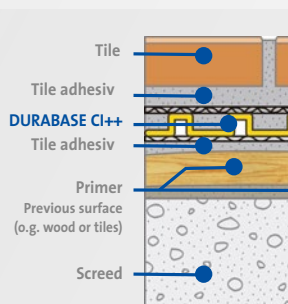

Special polypropylene fleece for improved subsurface adhesion

# DURABASE WP

Compound sealing mat for walls and floors in indoor areas

## DURABASE WP

A tiled floor is not inherently waterproof. In particular, where there are junctions around fittings and at wall connections, water can seep below the tiles and damage the underlying foundation. DURABASE WP is a sealing tape which acts as a water vapour barrier.

- **Secure bonding to the subfloor and tiled surface**
- **Also ideal for chemical-resistant surfaces**

### DURABASE WP

Material: PP/ PE

Colour: Yellow

Width: 100 cm

Roll: 5, 10, 30 m<sup>2</sup>

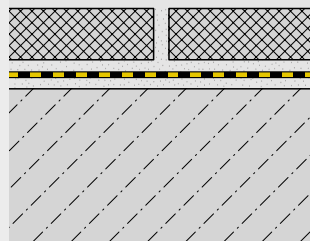

## Sealing of walls and floors

In indoor areas, DURABASE WP can be used as a seal in combination with the tiled surface on walls and floors. Here, DURABASE WP offers secure bonding to the subsurface and easy installation.

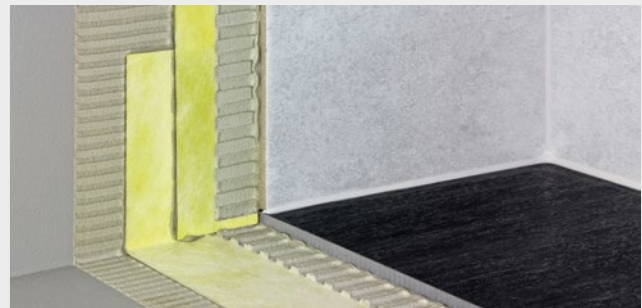

## Sealing in areas with extremely high moisture levels

Even in areas where moisture levels are more likely to be extreme, DURABASE WP can still be used in conjunction with a tiled floor for sealing walls and floor.

## Installation

Bond the DURABASE WP to the subsurface using flexible mortar. Then use flexible mortar to lay the tiles onto the DURABASE WP matting. Seal transitional areas between the wall and floor with WP sealing tape, inward and outward facing corners and pipe connections using the sealing liners. Please refer to the installation instructions at [www.dural.com](http://www.dural.com).

## Production of flooring surfaces that are resistant to chemicals

When used in conjunction with epoxy resin mortar / grout and suitable tiles, DURABASE WP can even be used to produce a floor that is resistant to chemicals, as stipulated for the food industry, for example.

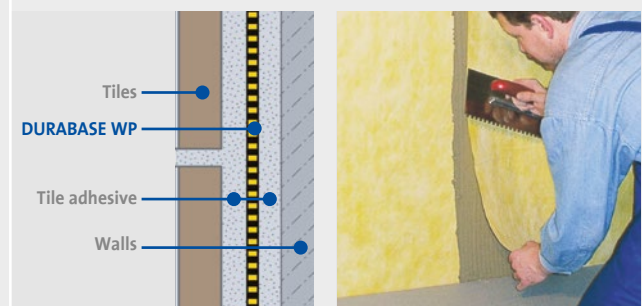

# ACCESSORIES

for DURABASE WP and DURABASE CI++

For the perfect sealing of corners, joints and connections, permanently waterproof accessory parts are available.

- Sealing tape
- Sealing liner
- Corner seals



## DURABASE WP Sealing tape

Material: PP/PE  
Width: 150 mm  
Lengths: 5, 30 m  
  
Width: 120 mm  
Lengths: 5, 10, 30 m



## DURABASE WP Self-adhesive sealing tape

Material: PP/PE  
Width: 150 mm  
Length: 3 m



## DURABASE WP Sealing tape

Material: TPE / Polyester  
backing material  
Width: 120 mm  
Lengths: 5, 10, 30 m

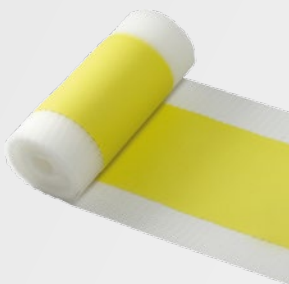

## DURABASE FLEX WPFX, WPFXI

Inward and outward  
facing corners  
Material: PP / TPE  
Web length:  
140 x 140 mm

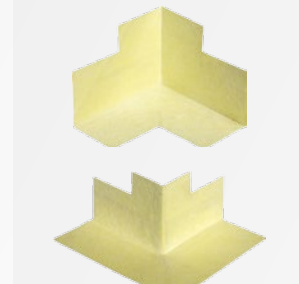

## DURABASE FLEX Sealing liner WPFM 120

Material: PP / TPE  
Colour: Yellow  
Dimensions:  
120 x 120 mm

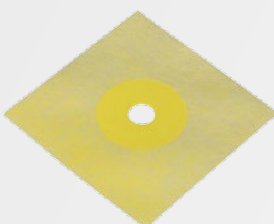

## DURABASE FLEX Sealing liner WPFM 425

Material: PP / TPE  
Colour: Yellow  
Dimensions:  
425 x 425 mm

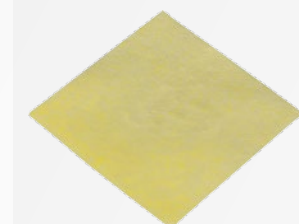

# DURABASE WP++

The matting system for composite sealing with a decoupling effect in indoor and outdoor areas



## DURABASE WP++

DURABASE WP++ is the powerful composite sealing and decoupling system for tiled and natural stone flooring in indoor and outdoor areas.

Special features of DURABASE WP++ are its watertightness, its decoupling effect and vapour barrier, as well as its high tensile bonding strength and exceptional loading capacity during installation. This makes it ideal for use on balconies and terraces, as well as in wet rooms with elevated technical diffusion requirements.

- Sealing tape with a powerful decoupling effect
- Crack-bridging
- High water vapour resistance factor (Sd value)

## DURABASE WP++

Material: Polypropylene

Colour: Yellow-black

Thickness: 1 mm

Roll: 15 m<sup>2</sup>

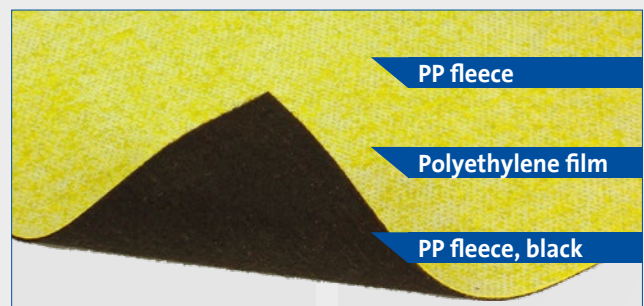
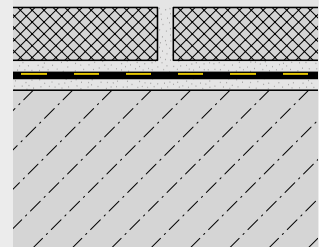



## Properties

Tiled or natural stone floors are not naturally watertight. At joints, at the connection points of installed parts and at wall edges in particular, water can seep below the flooring surface and damage the underlying foundation. Outdoors, this situation is even worse due to the effects of weather and frost. When renovating older surfaces, cracks can also be present in the subfloor, making it impossible to install a new, watertight tiled surface without taking the corresponding correction measures.

The DURABASE WP++ powerful composite sealing and decoupling system helps to resolve these challenges. The special triple-layer construction combines a seal with a powerful decoupling effect and exceptional crack-bridging properties. Thanks to these properties, WP++ is approved for use in indoor areas for stress classification A "High moisture load". The areas of application for WP++ are surfaces under direct and indirect stress, in both public and private buildings, in areas which are very frequently exposed to service or cleaning water, for example surrounding areas of swimming pools and shower facilities. Outdoors, DURABASE WP++ meets the specifications of stress classification B0, which is required in areas under direct and indirect stress, such as balconies and terraces (not over used rooms).



## Installation

Bond the DURABASE WP++ to the subsurface using flexible mortar. Then use flexible mortar to lay the tiles onto the DURABASE WP++ matting. Please refer to the installation instructions at [www.dural.com](http://www.dural.com).

### DURABASE WP++ Sealing tape

Material: PP / PE  
Width: 150 mm  
Lengths: 5, 30 m  
  
Width: 120 mm  
Lengths: 5, 10, 30 m



### DURABASE FLEX WPFX, WPFXI

Inward and outward facing corners  
Material: PP / TPE  
Web length:  
140 x 140 mm



### DURABASE FLEX Sealing liner WPFM 120

Material: PP / TPE  
Colour: Yellow  
Dimensions:  
120 x 120 mm

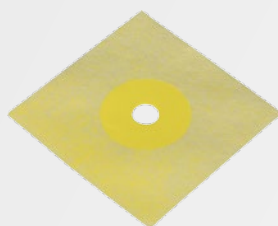

### DURABASE FLEX Sealing liner WPFM 425

Material: PP / TPE  
Colour: Yellow  
Dimensions:  
425 x 425 mm



# DURABASE DD 80++

Drainage mats for highly water-permeable flooring structures in outdoor areas



## DURABASE DD 80++

DURABASE DD 80++ is ideal for use in combination with tiled and natural stone flooring and concrete slabs to create large surface drainage areas. Installation onto a gravel bed / chippings, drainage screed or even directly onto the film is also possible. The special arrangement of the dimples, which have varying heights of 6 and 8 mm, guarantees a sufficiently large and permanent drainage area, even for high water volumes. The spaces between the dimples and the mesh fabric also help the surface construction to dry out quickly. This provides excellent protection of the seal from thermal and mechanical loads.

- For laying on gravel / grit beds, screed or directly onto the subfloor
- Extra high drainage capacity
- Also ideal for large loads

## DURABASE DD 80++

Material: Polypropylene  
Colour: Yellow  
Width: 100 cm  
Height: 8 mm  
Roll: 12.5 m<sup>2</sup>

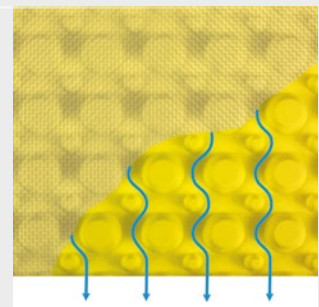

## Application areas

### Accumulation of water

As a result of faults in the sealing gradient, such as increases in the overlapping area or unevenness, water can accumulate below tiled surfaces.

### Frost and heat

When ceramic flooring is laid in outdoor areas, such as balconies or terraces, tiled surfaces are exposed to high thermal loads, which can lead to long-term damage in the surface structure.

### Cracks in the flooring structure

Cracks cause high levels of moisture penetration and eventually even detachment of the tiles, cavities, efflorescence and fracturing of the joint structure.

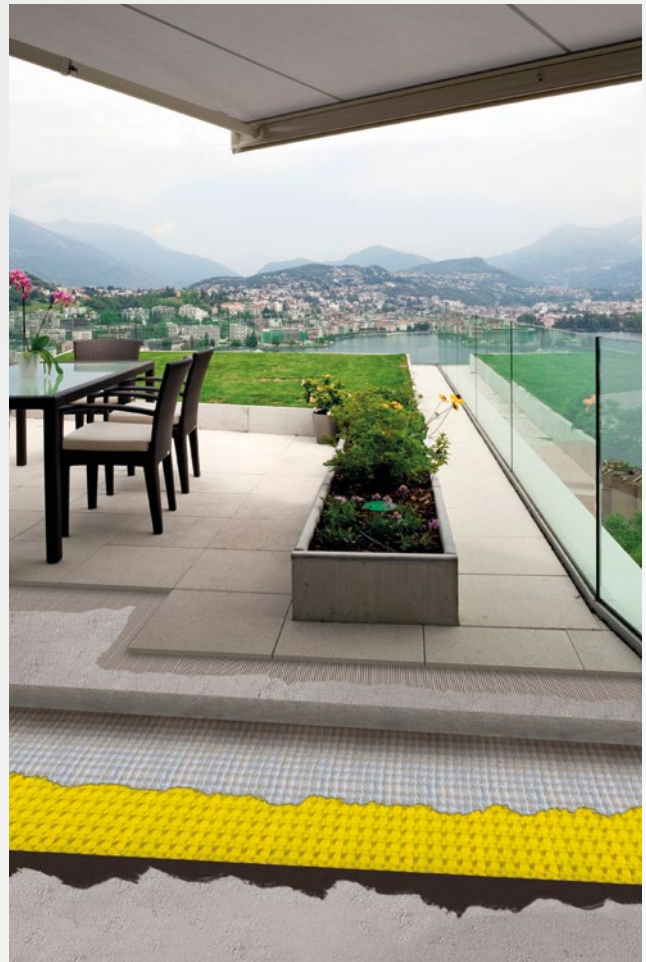

## Properties

DURABASE DD 80++ is an extremely robust, closed polypropylene membrane which is extremely dimensionally stable and has a dimpled structure with a special mesh fabric laminated onto the upper side. The dimpled side with the mesh fabric which supports the tiled structure works as a drain with exceptional drainage capacity. The conical dimples and their varying heights facilitate adequate drainage, even at high volumes. The material is resistant to ageing and rotting and any residue can be disposed of in the normal household waste. DURABASE DD 80++ allows for an extremely flexible choice of flooring or surface construction, thereby offering a high degree of adaptability to the respective building.

## Installation

Lay the DURABASE DD 80++ membrane with the mesh fabric facing down loose onto the structural waterproofing. The desired surface construction can be laid onto the mesh material without further preparatory work.

Please refer to the installation instructions at [www.dural.com](http://www.dural.com).

### Installation below drainage screed

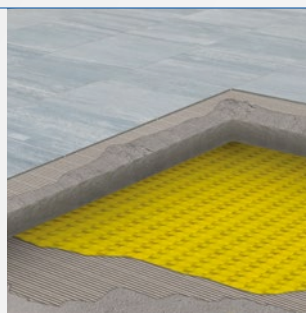
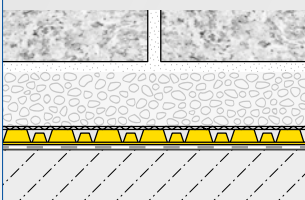

### Installation in gravel / chipping beds

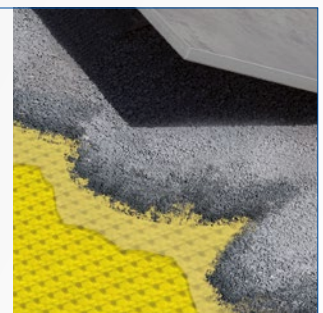
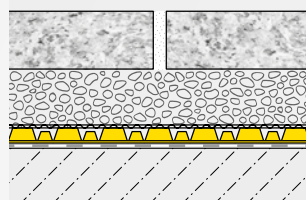

### Installation with stilt bearings

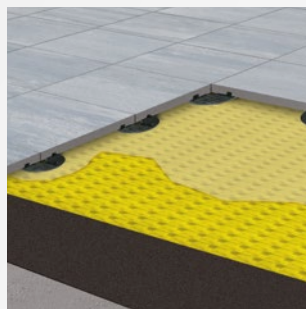
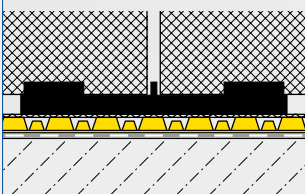

### Direct installation

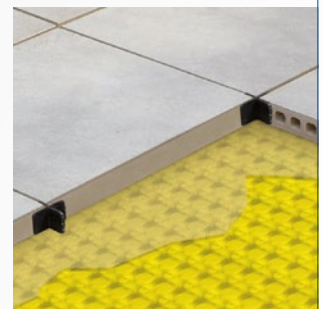
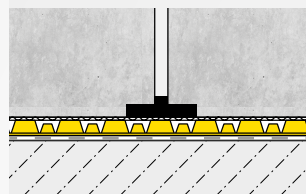

# DURABASE DD 80

The matting system for the double drainage of ceramic tiled surfaces outdoor areas

## DURABASE DD 80

DURABASE DD 80 is ideal for use in combination with tiles and with natural stone and concrete slabs, creating the large surface drainage areas which are essential for balconies and terraces etc. DURABASE DD 80 delivers effective drainage and additional sealing between the structural waterproofing and the surface structure laid over it. Moisture seeping through the surface structure is rapidly drawn away via the drainage surface created by the dimples.

Thanks to the special arrangement of the drainage channels, any water below the matting is also drained away. The space between the dimples and the mesh fabric produces an air pocket, which provides thermal insulation and reduces footfall sound and noise, protecting the waterproofing from thermal stress and also ensuring even load distribution over the seal.

- Double-sided drainage channels
- Installation below the screed / gravel bed
- For outdoor areas



## DURABASE DD 80

Material: Polypropylene  
Colour: Yellow  
Width: 100 cm  
Height: 8 mm  
Roll: 15 m<sup>2</sup>

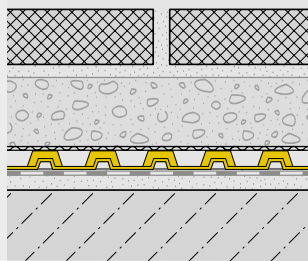

## Installation

Lay the DURABASE DD 80 membrane with the mesh fabric facing down loose onto the structural waterproofing. The floor covering on the mat can be composed very differently. Thus constructions with drainage screed in combination with tiles or slabs as a floor covering, or structures with a gravel bed or chippings or with raised flooring are all possible. Please refer to the installation instructions at [www.dural.com](http://www.dural.com).

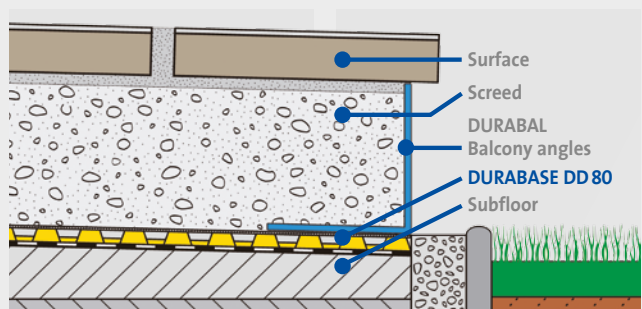
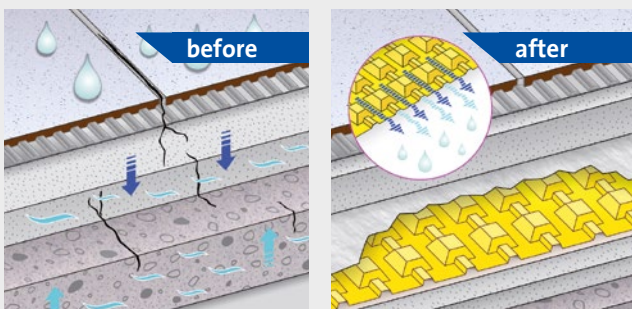

# DURABASE SW

Footfall and thermal insulation matting system for dry indoor areas

## DURABASE SW

DURABASE SW, the “silent flooring” is a matting underlay system measuring just 1.5 mm thick and consisting of 3 layers of polypropylene, with a further plastic-bonded quartz sand layer, which has excellent sound and heat insulation properties. It decouples the tiles from the flooring below, significantly reducing footfall sound. The matting system also markedly insulates tiled floors from cold substructures.

The matting can be used on many floor surfaces, such as screed or wood. It can be laid directly over old, existing flooring, saving time.

- Only 1.5 mm thin
- Suppresses footfall sound and provides thermal insulation
- Bridges minor subsurface cracks

Significant reduction of footfall and lowers ambient



## DURABASE SW

Material: Synthetic fibres

Colour: Grey

Width: 100 cm

Height: 1.5 mm

Roll: 15 m<sup>2</sup>

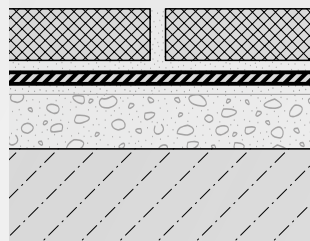

## Installation

Bond the DURABASE SW to the subsurface using flexible mortar. Then use flexible mortar to lay the tiles onto the matting. DURABASE SW is ideal for use in dry areas with tile sizes of 20 x 20 cm and bigger. In damp areas, a seal between the SW matting and the tiled surface is required.

Please refer to the installation instructions at [www.dural.com](http://www.dural.com).

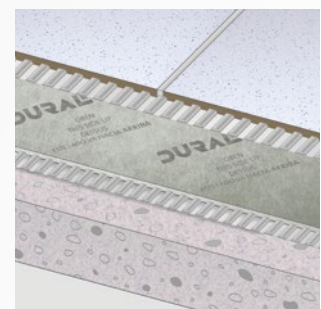
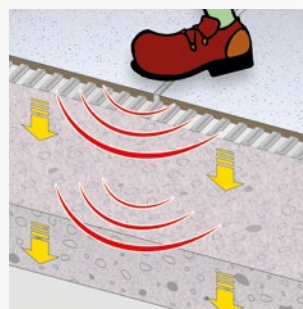

# PLATON STOP

The matting system that protects parquet and laminate flooring from damp and provides footfall noise insulation

## PLATON STOP

PLATON STOP is a matting system measuring around 2.5 mm thick and which is ideal for the floating installation of all parquet and laminate flooring surfaces. It was developed with a dual objective: to counter footfall and ambient noise and to significantly soften the impact of walking on parquet and laminate flooring. The special dimpled structure noticeably absorbs shocks, making it tangibly more comfortable to walk on the flooring. The footfall noise generated is also reduced simultaneously. This matting system, which is practically impermeable to water vapour, facilitates the significantly faster laying of parquet and laminate flooring on fresh screed. With cement screed, it is even possible to commence installation from 5 % CM residual moisture, which can lead to a reduction in construction times by 3–4 weeks.

- Installation even from 5 % CM residual moisture
- As a general rule, 3–4 week reduction in construction times
- Practically impermeable to water vapour

### PLATON STOP

Material: Polypropylene  
Colour: Blue  
Width: 100 cm  
Height: 2 mm  
Roll: 20 m<sup>2</sup>

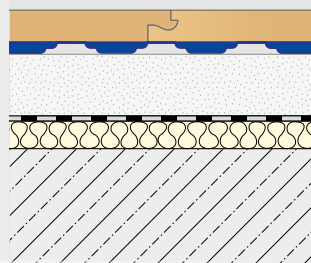

## Installation

Lay the cut-to-size pieces along the length of the roll with an overlap of around 5 cm. Lay mat starting points joint to joint around the roll width. Seal overlaps and roll joints using PSSeal. Then apply the selected surface flooring, taking into account the respective specific requirements. Please refer to the installation instructions at [www.dural.com](http://www.dural.com).

### PSSeal

Special sealing tape  
Material: Polypropylene  
Colour: Blue  
Width: 75 mm  
Length: 18 mm

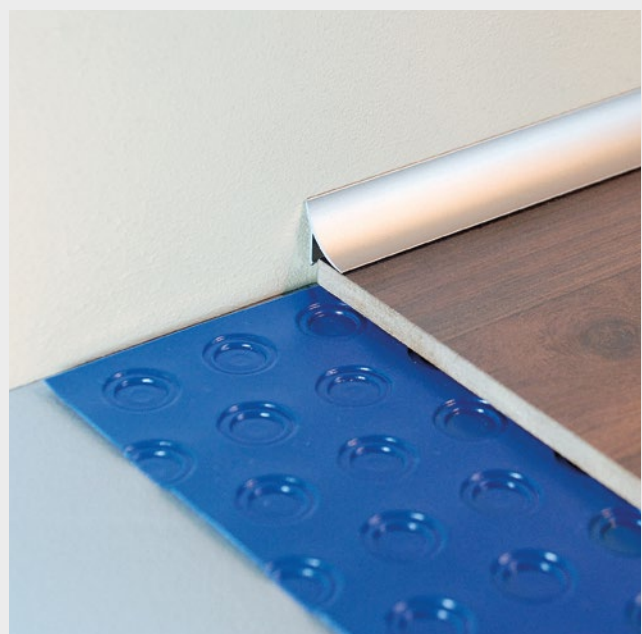

# IDEAL SOLUTIONS FROM A SINGLE SYSTEM.

DURABASE matting systems are the basis for many different requirements. These systems are complemented by comprehensive solutions for flooring, bathrooms, terraces, balconies and driveways.

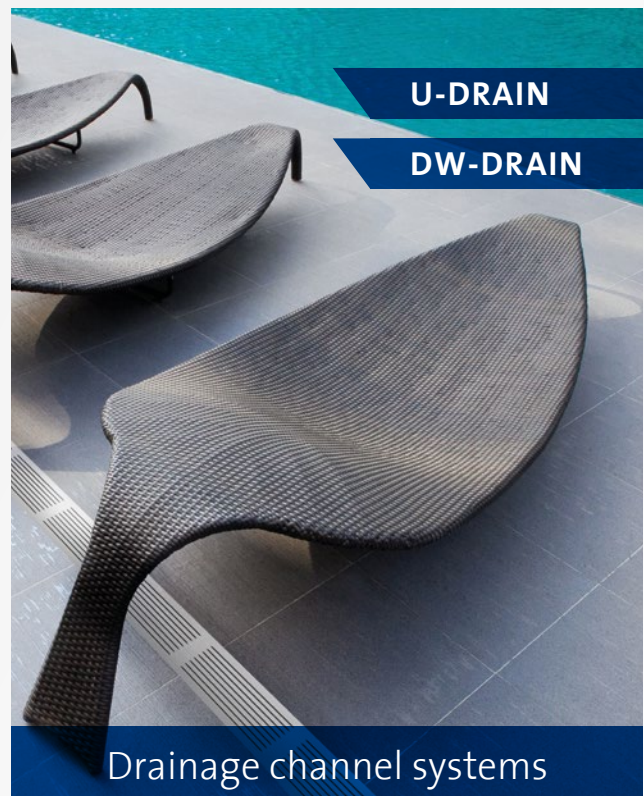

DURAL is a comprehensive provider of floor-level shower systems, profiles and matting systems for walls and floors



Stair nosing profiles

Floor level shower systems

LED profiles and accessories

Skirting

Balconies / Terraces / Entranceways

Tactile orientation aids

Doormat systems

Profile systems for parquet, laminate, carpet and designer flooring

Tile profiles  
Expansion joint profiles  
Z-FLEX

Matting systems for decoupling, drainage, sealing and insulation

Recommended by:

**DURAL GmbH**  
Südring 11  
D-56412 Ruppach-Goldhausen  
Tel. +49[0]2602/9261-0  
Fax +49[0]2602/9261-50  
info@dural.com  
www.dural.com