

PREPARATION

Before beginning assembly of product, make sure all parts are present. Compare parts with package contents list and diagram. If any part is missing or damaged, do not attempt to assemble the product. Contact customer service for replacement parts.

Note: This fan has two different methods of assembly. The steps will differ depending on the assembly you choose.

Estimated assembly time: 30 minutes to 1 hour.

Tools Required for Assembly (not included): Phillips screwdriver, flathead screwdriver, wire strippers, electrical tape, ladder, safety glasses.

ASSEMBLY INSTRUCTIONS

- **WARNING-**To reduce risk of fire, electric shock, or personal injury, mount to outlet box marked “Acceptable for Fan Support of 15.9kg (35lbs) or less” and use mounting screws provided with the outlet box and/or support directly from building structure. Most outlet boxes commonly used for the support of luminaries are not acceptable for fan support and may need to be replaced. Consult a qualified electrician if in doubt.
- **Warning-**Risk of fire, electric shock, or personal injury. Ceiling fans may be either directly supported from a structural framing member of a building and (see examples in figures A & B) or may be mounted to an outlet box marked acceptable for fan support of 31.8 kg (70 lbs) to 15.9kg (35 lbs) (see example in figure C).

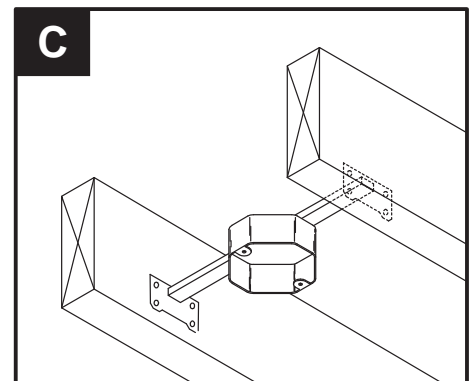
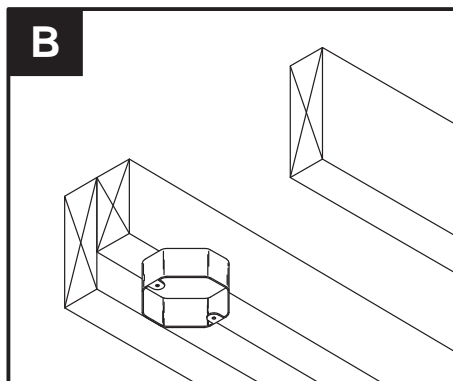
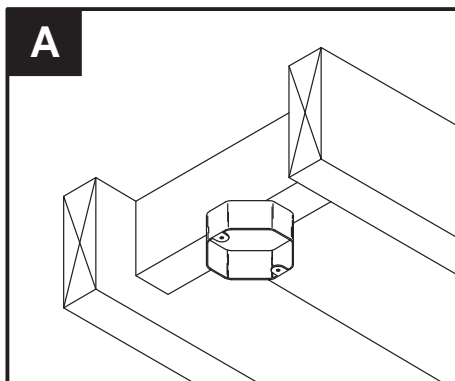

ASSEMBLY INSTRUCTIONS (Flushmount Assembly)

1. Secure the hanger bracket (A) to the ceiling outlet box using hanging bracket screws and hanging bracket washers.

Important: If attaching the fan to a sloped ceiling, make sure open end of mounting bracket is installed facing the roof. Do not install fan on a ceiling with a pitch greater than 20°.

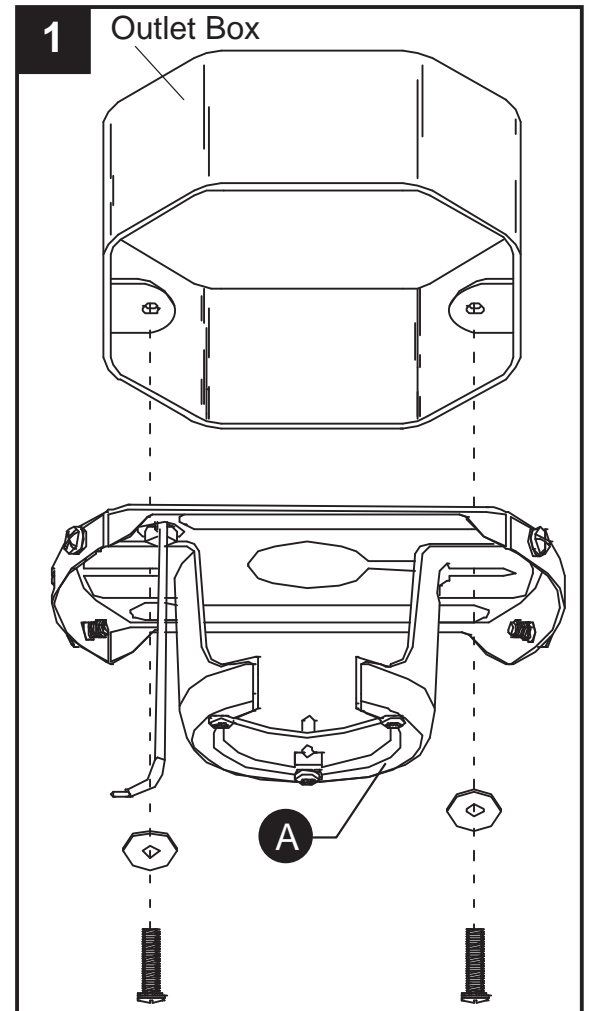

For hugger (flushmount) assembly proceed to page 6. Steps 2 and 3.

For down rod assembly proceed to page 7 and 8. Steps 4 through 7.

ASSEMBLY INSTRUCTIONS (Flushmount Assembly)

FLUSHMOUNT ASSEMBLY ONLY

2. Before starting this step you must remove the canopy hole cover from the canopy (C). Remove three screws from the top of the motor assembly (F) and save them for later use. Lower canopy (C) onto the motor assembly (F) making sure the slots on the canopy (C) line up with the remaining screws on the motor assembly (F). Attach canopy (C) to the motor assembly (F) with the screws you just removed.

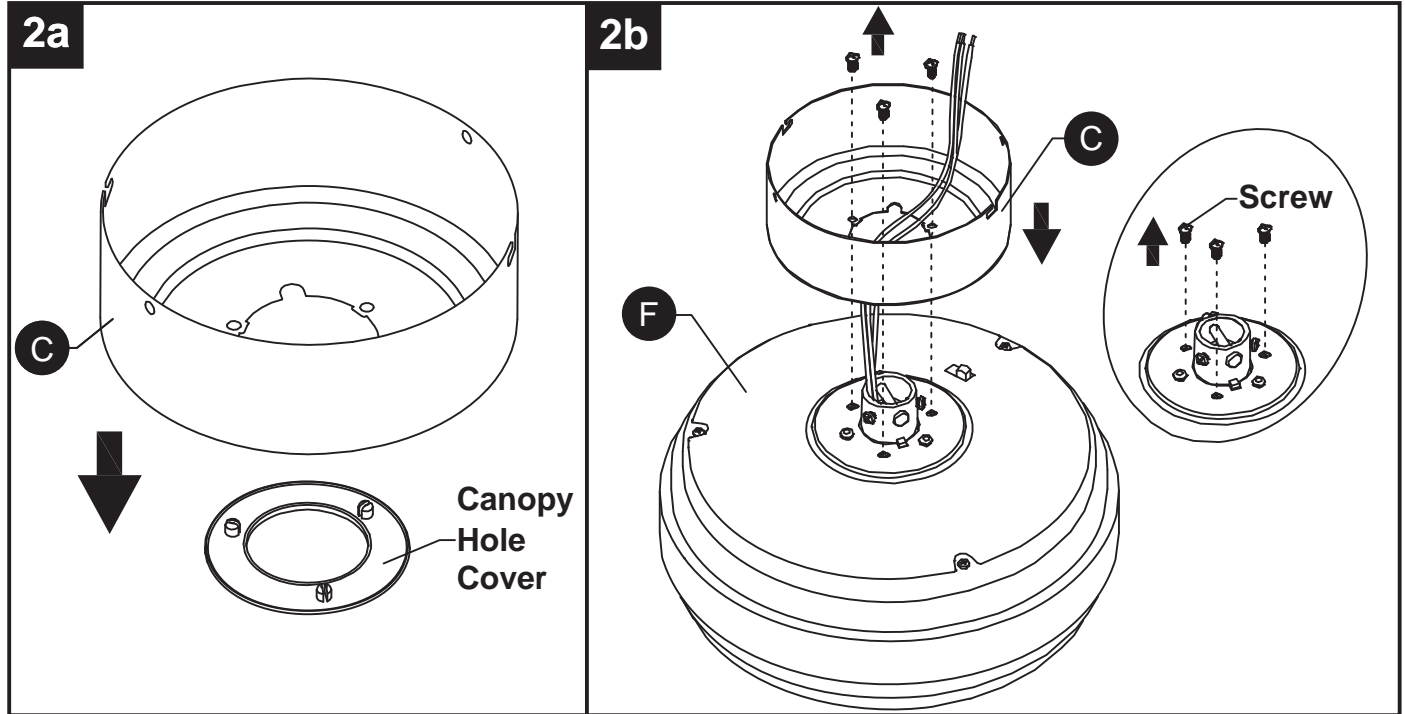

FLUSHMOUNT ASSEMBLY ONLY

3. Temporarily hang motor assembly (F) on the hanging bracket (A) to allow the electrical connections to be made.

Raise motor assembly (F) and place one of the round holes on the canopy (C) onto the tab from the hanging bracket (A). This will allow for hands-free wiring.

Note: Proceed to step 8 after this step.

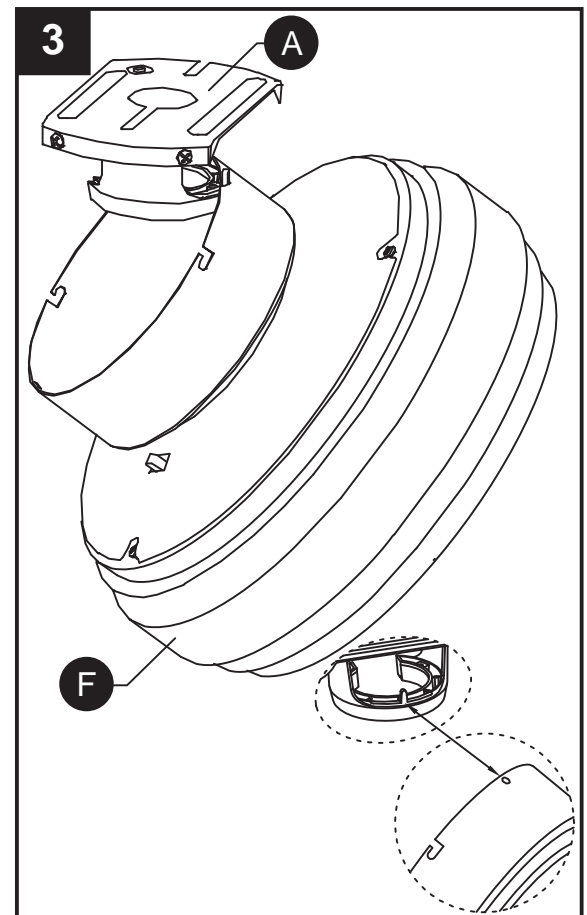

DOWN ROD ASSEMBLY ONLY

- Loosen the set screws found on coupling on top of the motor assembly (F). Then remove the hair and clevis pin that will be used on a later step.

Note: Steps 2 and 3 do not apply to this assembly.

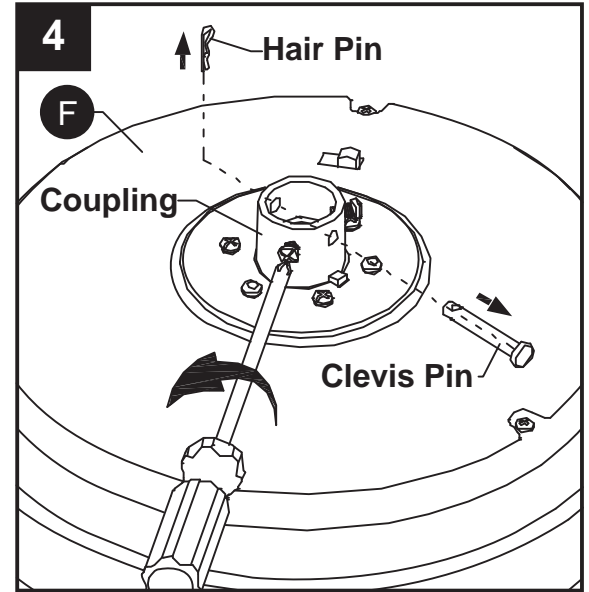

DOWN ROD ASSEMBLY ONLY

- Place motor coupling cover (E), canopy ring (D), and canopy (C) over the coupling found on the top of the motor assembly (F). Feed wires from the motor assembly (F) through the down rod (B), then insert the down rod (B) into the coupling found on top of the motor assembly (F).

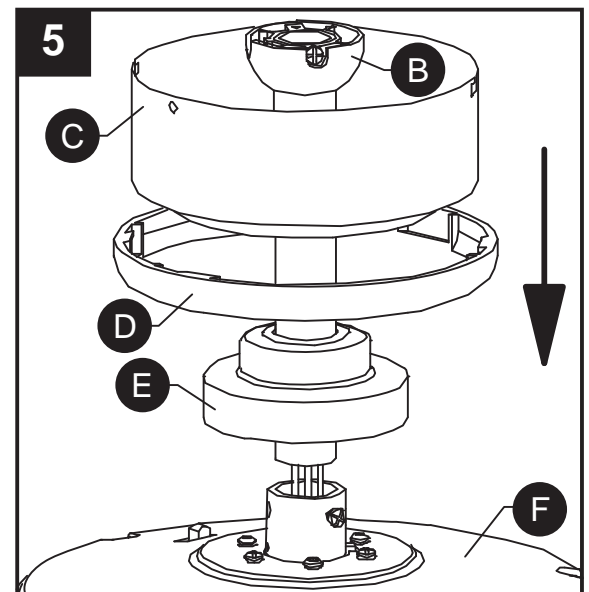

DOWN ROD ASSEMBLY ONLY

6. Pass the clevis pin through the down rod (B) and coupling found on the motor assembly (F) and secure with the hair pin. Tighten set screws found on the coupling on the motor assembly (F).

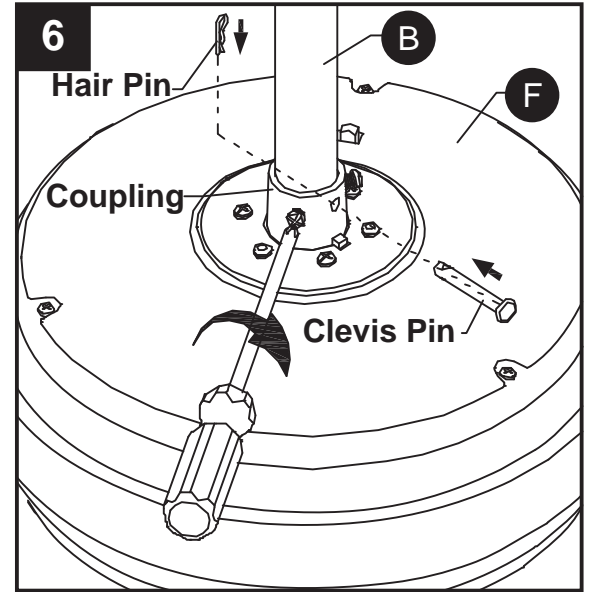

DOWN ROD ASSEMBLY ONLY

7. Carefully lift the fan and seat the downrod (B)/hanger ball assembly on the hanger bracket (A). Be sure the groove in the ball is lined up with the tab on the hanger bracket (A).

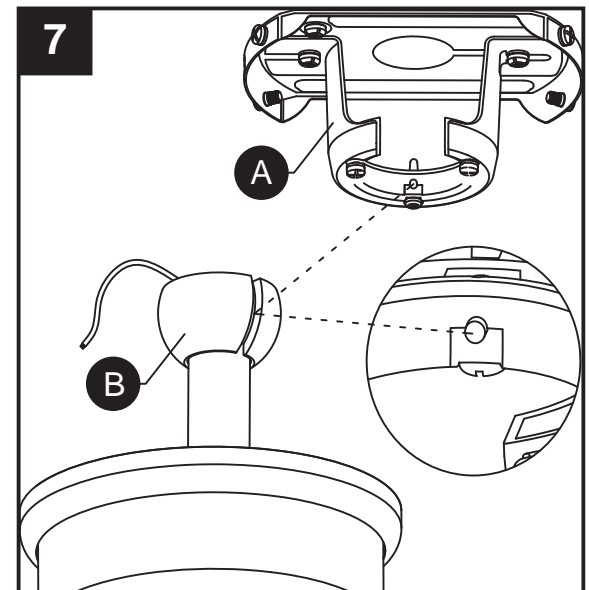

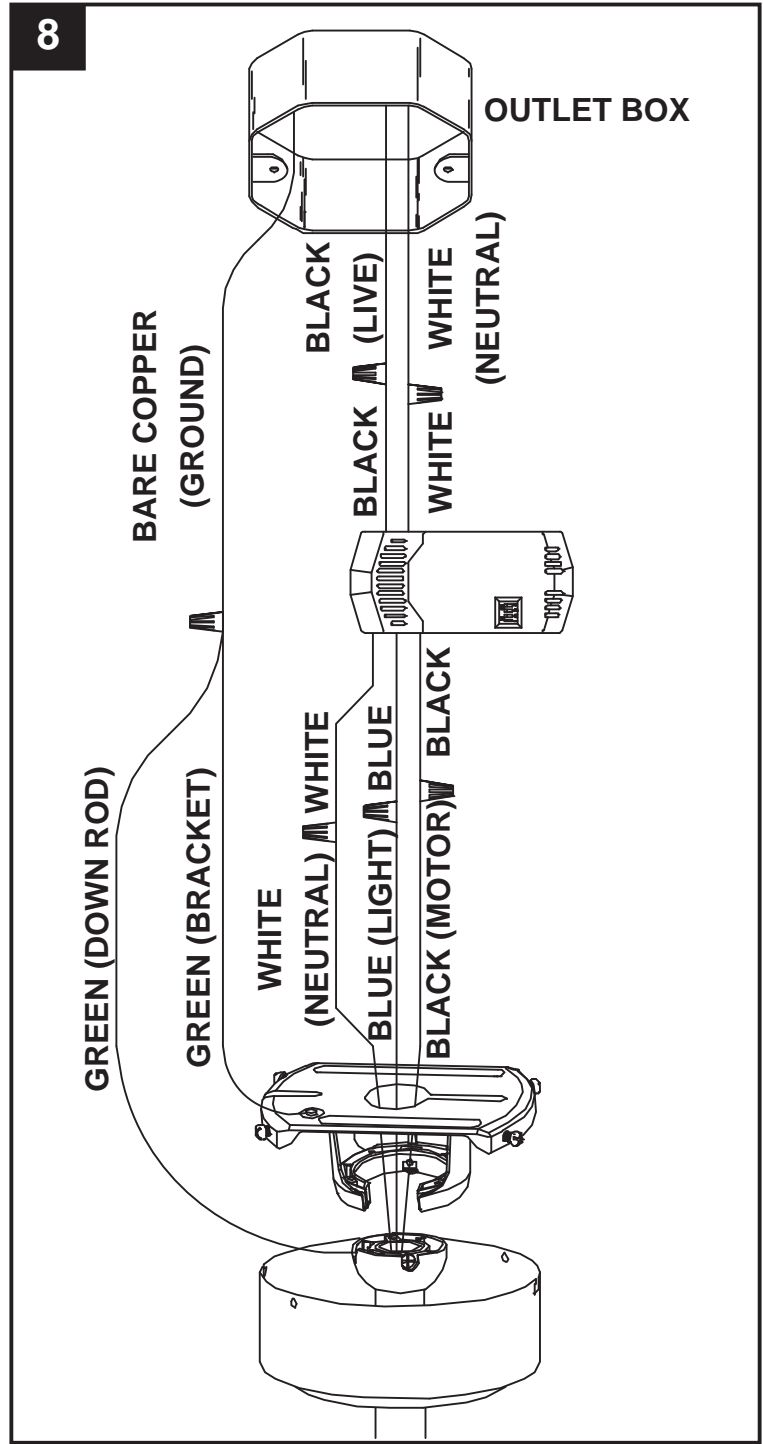

8. Wiring the fan per wiring diagram and securely connect wires with wire connectors:

- Connect WHITE wire from the fan to WHITE wire marked TO MOTOR N from the receiver.
- Connect BLUE wire from the fan to BLUE wire from the receiver.
- Connect BLACK wire from the fan to BLACK wire marked TO MOTOR L from the receiver.
- Connect BLACK wire from the outlet box to BLACK wire marked AC IN L from the receiver.
- Connect WHITE wire from the outlet box to WHITE wire marked AC IN N from the receiver.
- Connect GROUND (GREEN) wires from hanger bracket and downrod ball, to GROUND (GREEN or BARE COPPER) from house.

ASSEMBLY INSTRUCTIONS

9. In order to use the remote control the dip switches must match on both the remote control and the receiver. Make sure they both have the same configuration.

Remove the battery cover from the remote control. Slide dip switches up or down using a small screw driver (not included). Then match the dip switches on the receiver to the same position as the remote control.

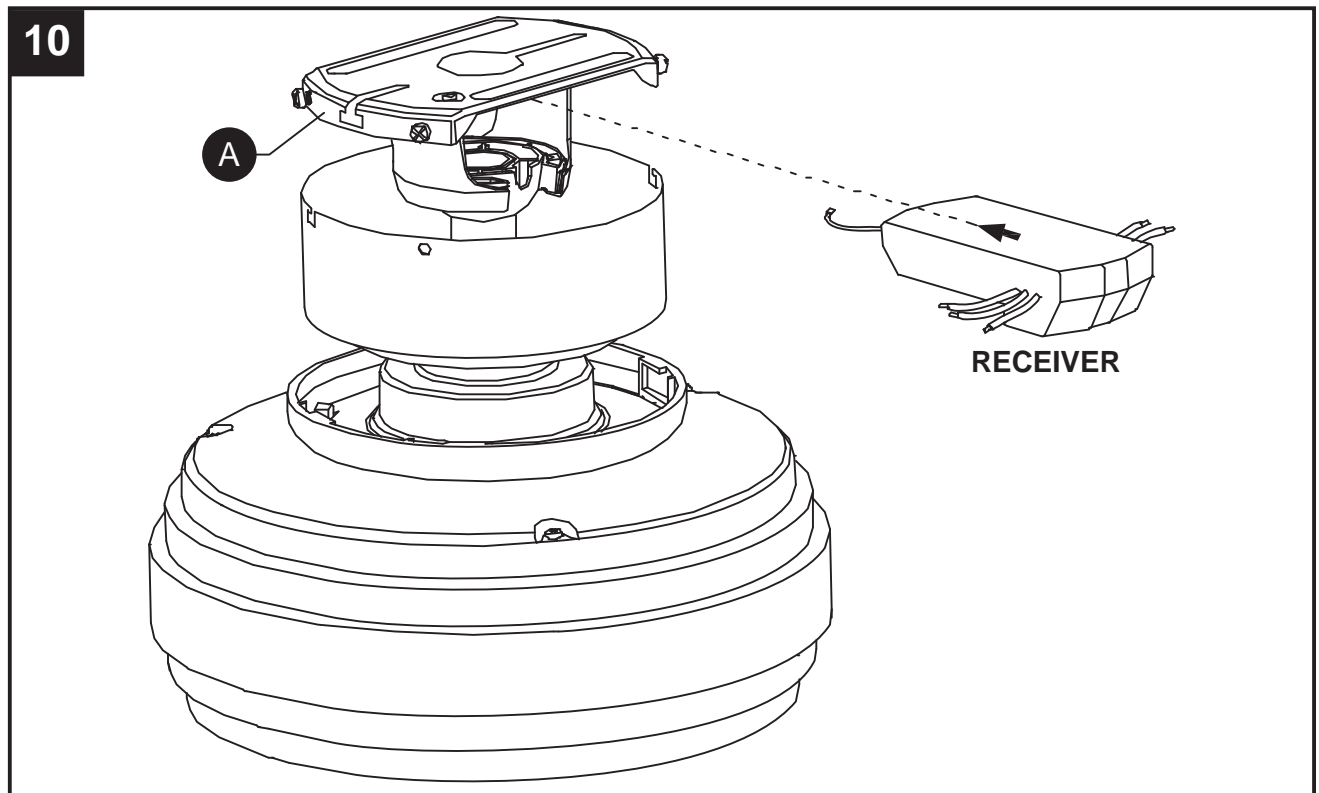
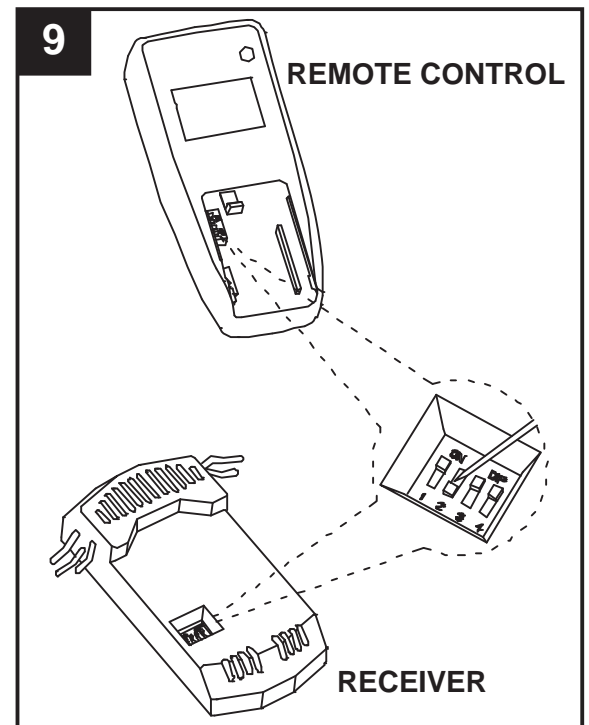

10. Slide the receiver into the open area on the hanging bracket (A) with the flat side of the receiver facing the ceiling.

ASSEMBLY INSTRUCTIONS

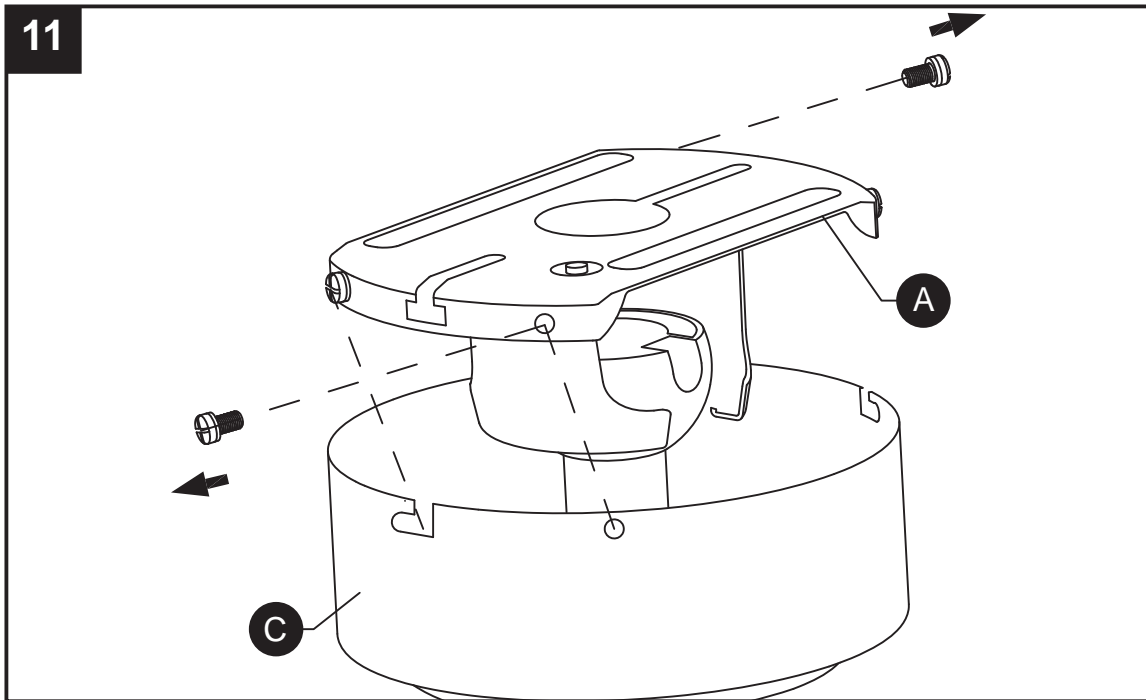

11. Lift canopy (C) to the hanging bracket (A). Remove two canopy screws that align with the round holes on the canopy (C) and loosen the other two canopy screws making sure not to remove them. Raise canopy (C) over the hanging bracket (A) aligning the screws that remained into the canopy (C). Twist canopy (C) clockwise to secure. Reinstall the two screws that were previously removed into the holes on the canopy (C). Tighten all screws.

12. Raise canopy ring (D) over the screws protruding from the canopy (C) and turn counter-clockwise to lock in place.

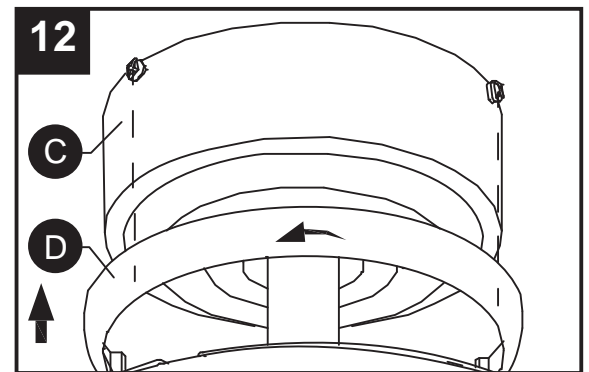

13. Attached blades (H) to the blade brackets (G) with the blade screws found in the hardware bag.

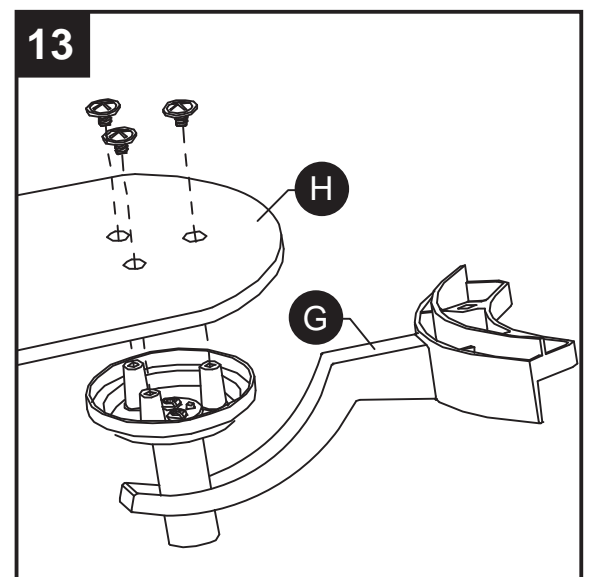

ASSEMBLY INSTRUCTIONS

14. Remove the retaining clips from the motor assembly (F).

Attached blade brackets (G) to the motor assembly (F) using the bracket screws.

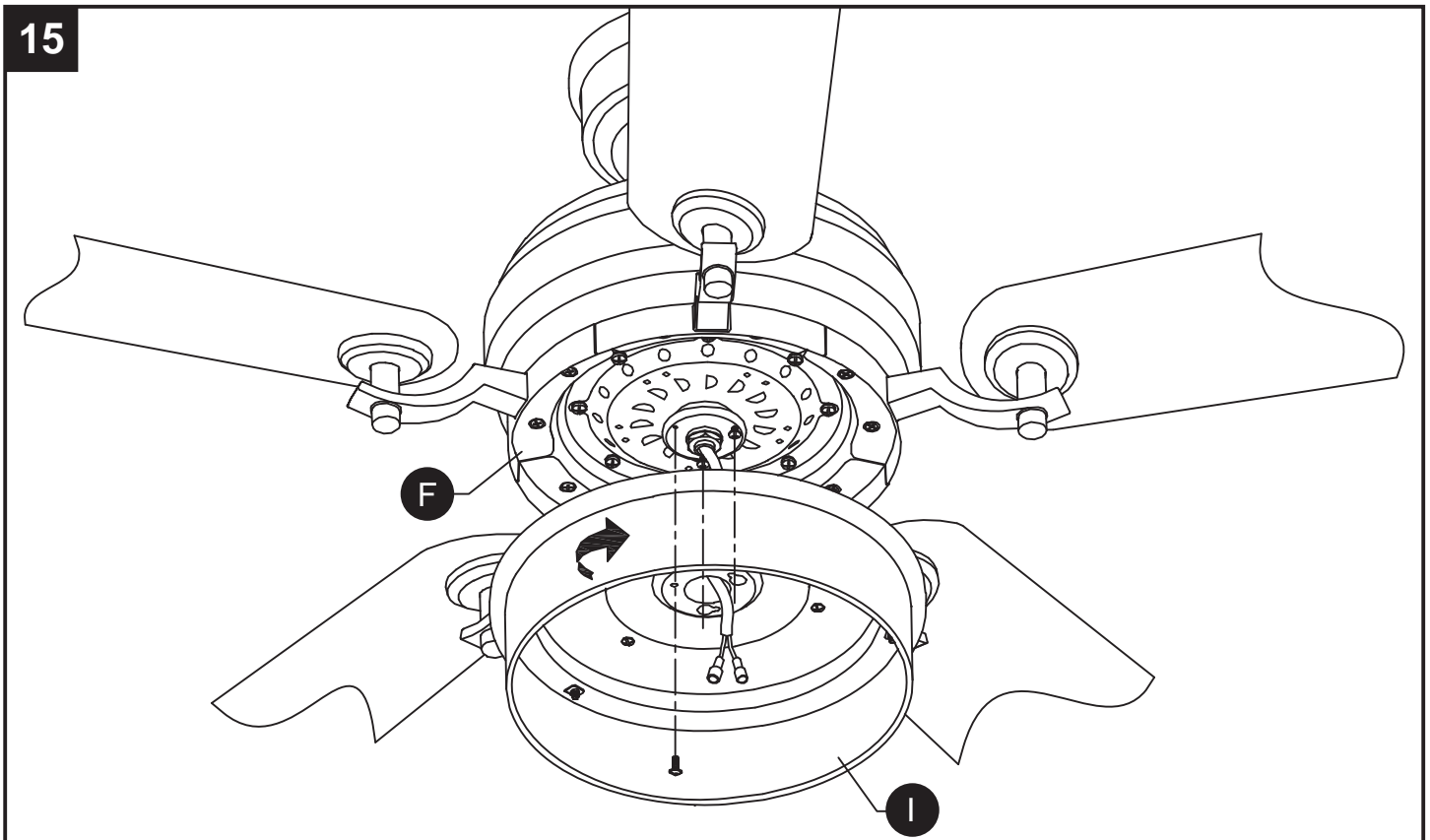
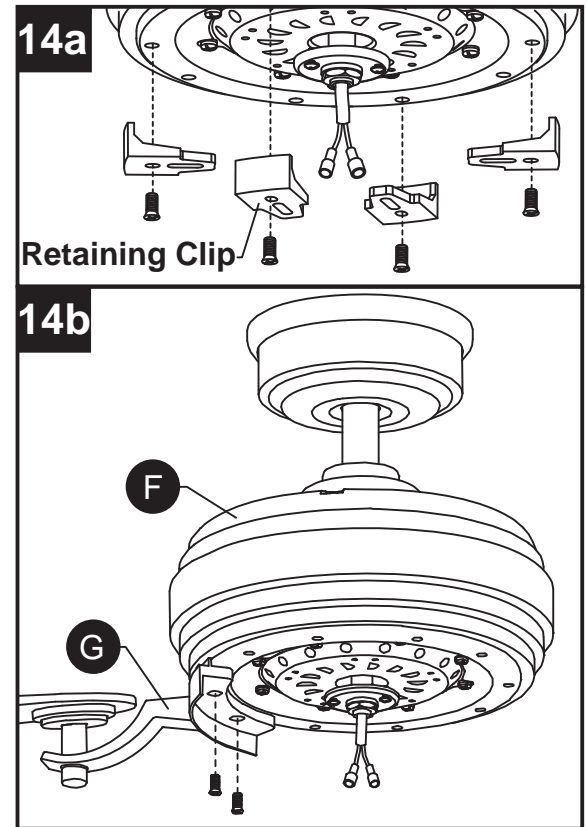

15. Remove 1 of 3 mounting screws from the motor assembly (F). Loosen the remaining screws but do not remove them. Feed the wires from the motor assembly (F) through the hole in the light kit housing (I). Position keyhole slots around the screws and twist clockwise. Insert the screw that you had previously removed. Tighten all screws.

ASSEMBLY INSTRUCTIONS

16. Connect wires from the motor assembly (F) to the light kit (J). Remove 1 of 3 screws from the light kit housing (I) and loosen the other 2. Position keyhole slots around the screws and twist clockwise. Insert the screw that you had previously removed. Tighten all screws.

Note: White wire connects to white wire and black wire connects to black wire.

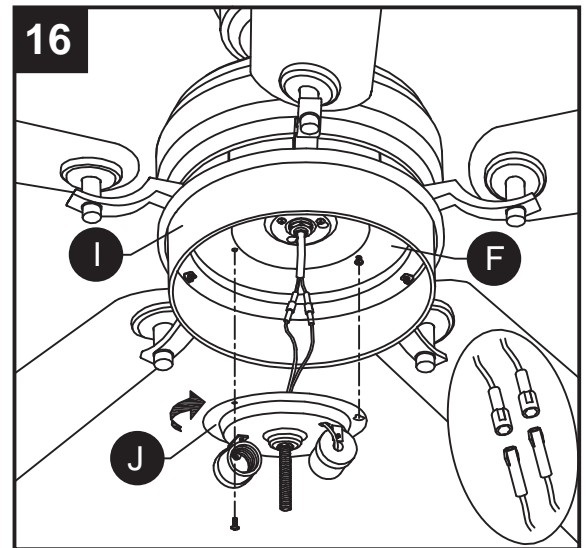

17. Insert two 13-watt medium-base CFL bulbs (K) into sockets found on the light kit (J).

Note: When replacing the bulb be sure to use a bulb with the same wattage.

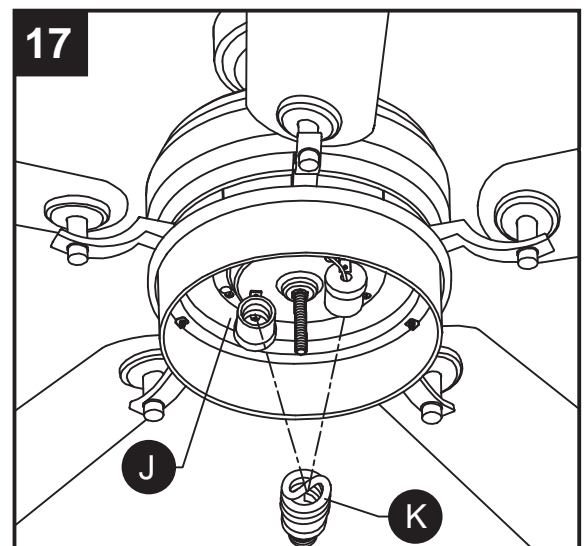

18

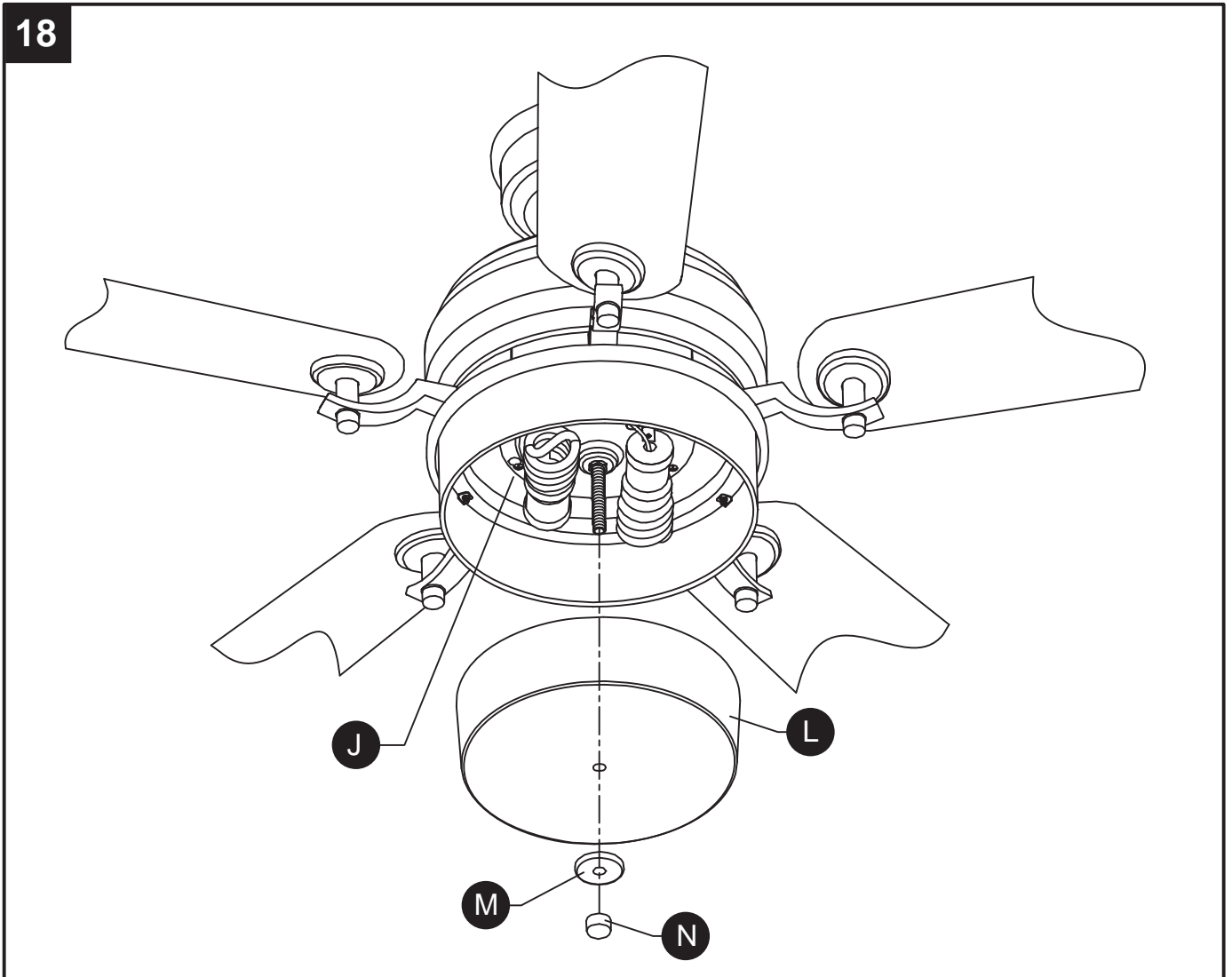

18. Pass shade (L) and finial cap (M) over the threaded nipple protruding from the light kit (J) and secure with finial (N).

STEPS TO BALANCING THE CEILING FAN

- Tighten screws on the mounting bracket, outlet box, the downrod , fan blades to blade holders, and blade holders to the motor housing.
- Measure the distance from the tip of each blade to the ceiling. All blades should have the same vertical distance from the ceiling. Adjust any bent blade holder, by gently pressing up or down on the brackets, until all blades are at an equal distance from the ceiling.

If wobbling persists, you may need a blade balancing kit to stabilize the ceiling fan. A blade balancing kit consists of a plastic clip and two balancing weights.