



## Installation Instructions

Shut off power at source.

Remove outlet cover plate.

Test outlet to assure power has been disconnected.

Remove two (2) screws holding outlet or switch in place.

Measure distance from face of outlet box to outside wall surface.

Select the corresponding thickness ReceptXtender.

Slide ReceptXtender over device and wires.

Make sure inner flange is towards the box.

Replace original screws through the device and the new ReceptXtender.

Longer screws are needed for applications over 1/2".

Tighten screws snugly and assure device is firmly positioned.

Replace cover plate and turn on power.

### Single Gang and Two Gang

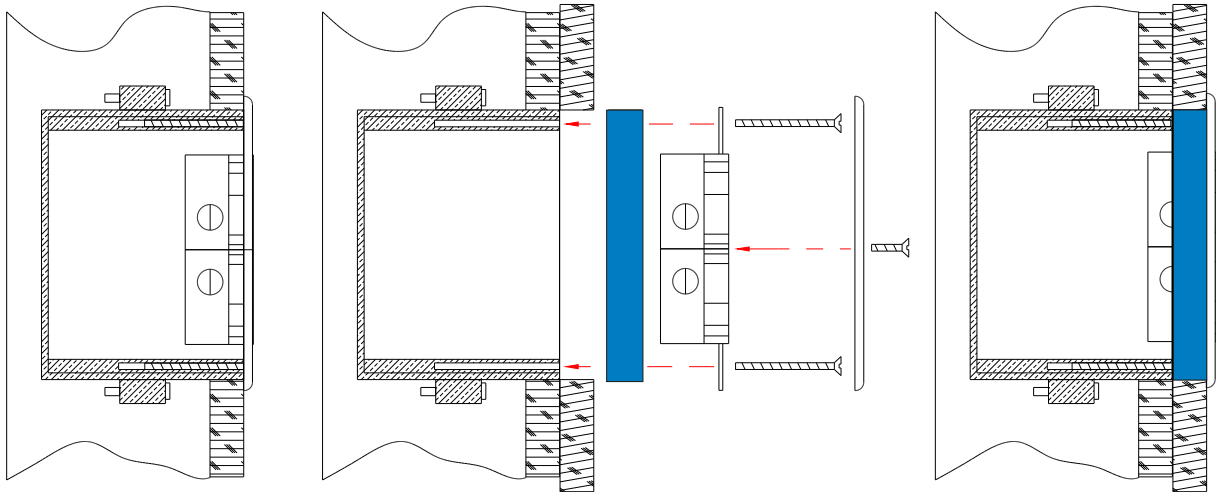

E174133  
EXTENSION RINGS  
(19JA)

Manufactured in the USA by Gadget Mania Inc.  
85 Glendale Meadow Ln. Harrisville, RI 02830  
401-568-9696

