

BEFORE YOU BEGIN

- Observe all local plumbing and building codes.
- Shut off hot and cold water supplies to lavatory faucet.
- Inspect waste and supply tubing; replace if necessary.

REQUIRED TOOLS & MATERIALS

- Putty knife
- Adjustable wrench
- Saber or keyhole saw
- Pipe wrench
- Tubing cutter
- Screwdriver
- Hacksaw
- Ruler
- Pencil
- Drill
- 1/2" drill bit
- Plumber's putty
- New faucet (optional)
- Shut-off valves (optional)

SAFETY EQUIPMENT

- Safety glasses
- Safety shoes

INSTALLATION

1. To remove old lavatory: Turn off water supply by closing the two shut-off valves below the lavatory. If there are no shut-off valves, turn off water at meter. Turn the lavatory faucet on to drain the supply lines. Disconnect and remove water supply tubes from faucet. Disconnect drain assembly and remove trap. **See Fig. #1.**

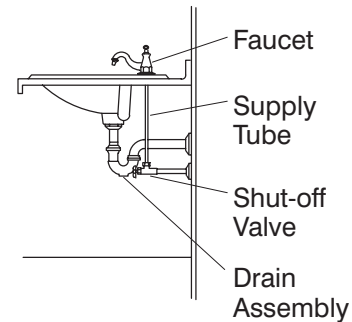

Fig. #1

2. Use the scissors to cut out the template on the specified line shown on template. Trace the template on the counter top using a soft lead pencil. **See Fig. #2.**

NOTE: Centerlines are provided on the template to help you achieve proper alignment of opening.

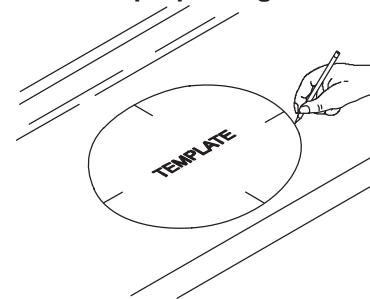

Fig. #2

3. When cutting into a new countertop, drill a pilot hole using a 1/2" drill. Use a saber or keyhole saw to cut out the opening in the counter top by carefully following the pencil line traced from the template. **See Fig. #3.**

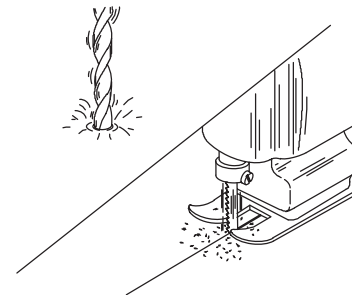

Fig. #3

- Temporarily place lavatory into the opening and adjust for exact position. Trace a pencil line around the outside edge of the lavatory. **See Fig. #4.** This will serve as a guide line for applying adhesive sealant. Remove fixture from countertop.

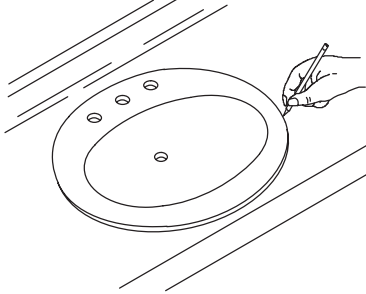

Fig. #4

- Assemble faucet and drain to lavatory following the manufacturer's instructions. **See Fig. #5.**

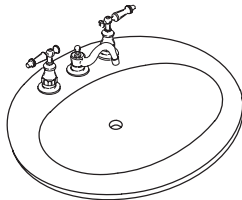

Fig. #5

- Apply one ribbon of sealant on the counter top between the edge of the opening and the guide line that was traced on the outside of the fixture. Spread evenly with a putty knife. **See Fig. #6.**

NOTE: Apply adhesive sealant quickly as it sets up within minutes.

Carefully place the lavatory into the opening in countertop and press down firmly. Use guideline to position properly.

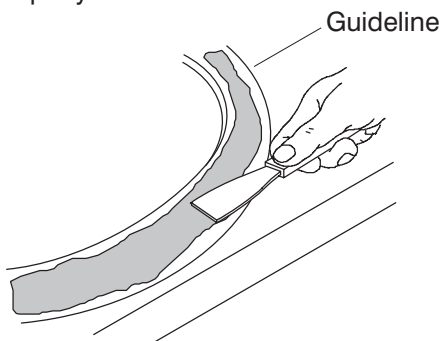

Fig. #6

- Immediately remove excess adhesive sealant with a damp cloth. Fill any voids in the joint where necessary. Allow adhesive sealant to set 30 minutes before connecting supplies and drain. **See Fig. #7.**

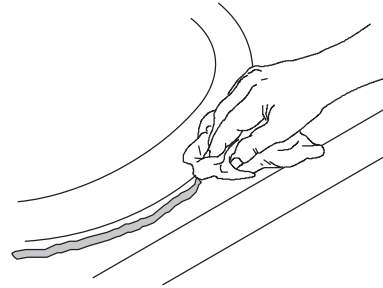

Fig. #7

- Connect supply lines at supply valves and fitting. **See Fig. #8.** Be careful not to move the fixture out of position.

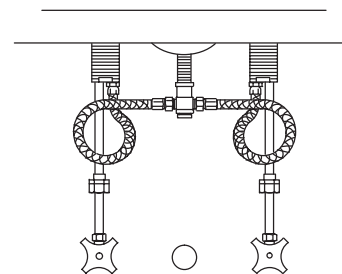

Fig. #8

- Connect drain lines and trap at fixture and wall outlet. Turn tailpiece into drain body. Align trap inlet with tailpiece. Place trap nut and gasket onto tailpiece and insert into trap. Tailpiece must extend 1" to 2" into trap. Tailpiece may have to be cut to fit. **See Fig. #9.**

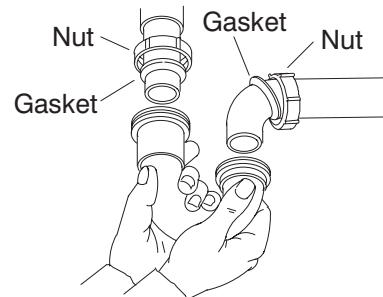

Fig. #9

IMPORTANT CONSUMER INFORMATION

A. CARE AND CLEANING

Water conditions in various parts of the country will determine any extra cleaning attention you give your sink or lavatory. In the meantime, a simple routine of daily care will keep your lavatory fresh and sparkling.

Kohler Co. does not recommend the use of harsh abrasive cleansers on any of its products. Harsh cleansers, used regularly, will scratch fixture surfaces and destroy their finish.

Do not use abrasive cleansers or solvents on Kohler faucets and fittings.

B. REQUESTING SERVICE

Please take a moment to familiarize yourself with the Kohler Warranty, its benefits, and limitations. Kohler Co. and its distributors support you with one of the largest Service Networks of its type. Here's what you need to do if you require service:

- First:** Contact the dealer or contractor who sold and installed the product. They should be able to solve any problems you may have.
- Second:** If your dealer or contractor cannot solve the problem, they will contact or supply you with the name of the local Kohler Distributor and the:
 Kohler Technical Specialist
- Third:** If you are unable to obtain warranty service through either your contractor or Kohler Co. distributor, please write us directly at Kohler Co., Attn: Customer Service Department, 444 Highland Drive, Kohler, WI 53044 U.S.A.
- Fourth:** Include all pertinent information regarding your claim, including a complete description of the product, model numbers, colors, finishes, and the date the product was installed. Include a description of the problem, and a photocopy of your invoice for the products involved. Also give us the name of the contractor and distributor.

C. LIMITED ONE-YEAR WARRANTY

Kohler plumbing fixtures and fittings are warranted free of manufacturing defects.

Kohler Co. will, at its election repair, replace, or make appropriate adjustment where Kohler Co. inspection discloses any such defects occurring in normal usage within one year after installation. Kohler Co. is not responsible for installation costs.

To obtain warranty service, contact Kohler Co. either through your Dealer or Plumbing Contractor or by writing Kohler Co., Attn: Customer Service Department, 444 Highland Drive, Kohler, WI 53044 U.S.A., or by calling **1-800-4-KOHLER** from within the U.S.A.

Implied warranties, including that of merchantability and fitness for a particular purpose, are expressly limited in duration to the duration of this warranty. To the extent permitted by law, Kohler Co. disclaims all implied warranties including merchantability and fitness for a particular purpose. Kohler Co. disclaims any liability for special, incidental, or consequential damages.

Some states do not allow limitations on how long an implied warranty lasts or the exclusion or limitation of incidental or consequential damages, so this limitation and exclusion may not apply to you. This warranty gives you specific legal rights. You may also have rights which vary from state to state.

This is our exclusive written warranty.

Kohler Co., Kohler, Wisconsin 53044