



www.kregtool.com
800.447.8638

Production Stop KMS7800

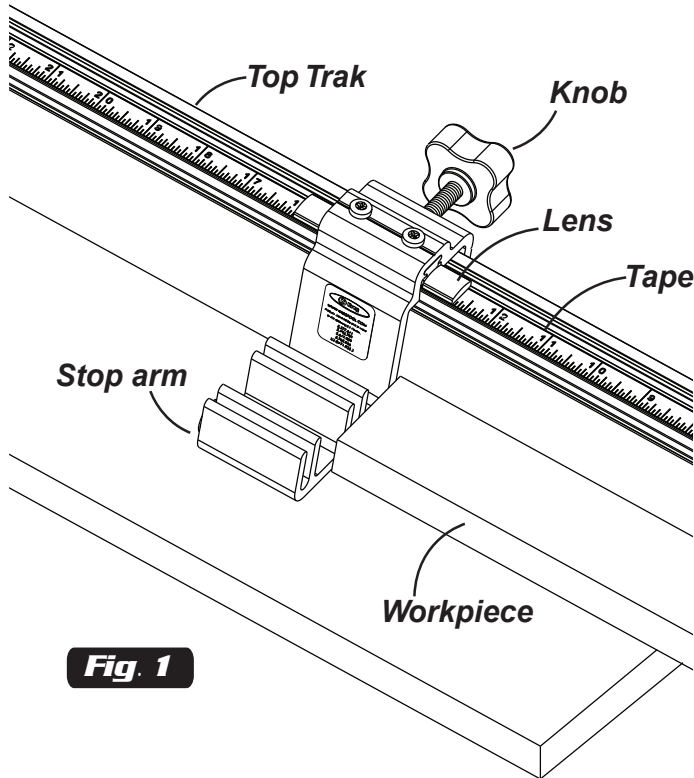

Fig. 1

The Production Stop measures and records the distance between the end of the board and the saw blade, drill bit or router cutter. This allows you to easily cut multiple pieces of stock to the exact same length.

Cutting numerous pieces to the exact length without measuring is easy. Gently press the end of the board opposite the blade against the side of the stop arm as shown in **figure 1**.

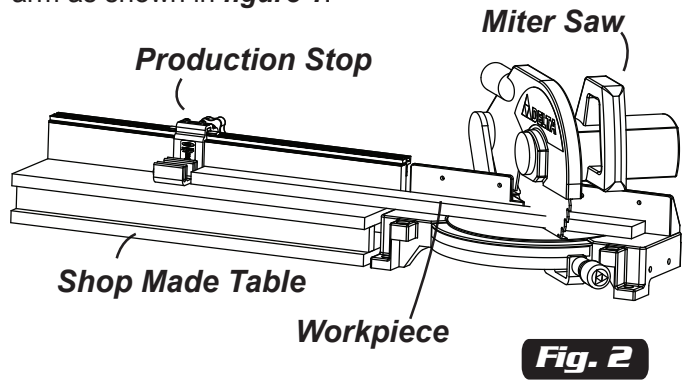

Fig. 2

The Production Stop can be secured anywhere along the trak and can be easily lifted off the top of the trak and repositioned on the opposite side of the blade.

ABOUT THE LENS

Our stops feature two adjustable lens cursors similar to the lens on a quality tablesaw rip fence. The lens is a clear material except for a red line (cursor) on the bottom of the lens as shown in **figure 3**. The lens is adjustable to fine-tune the stop and is secured in place with the Lens Screw. Each lens can be set independently to read accurately off of either side of the blade.

The red line cursor makes it easy to read the tape lines and fine-tune the stop when compensating for blade thickness variations or a tape that is not perfectly positioned.

Please note that when placing the self-adhesive tape onto the track, the tape must be placed 3/8" CLOSER TO the saw blade to allow the Lens to function properly as shown in **figure 4**.

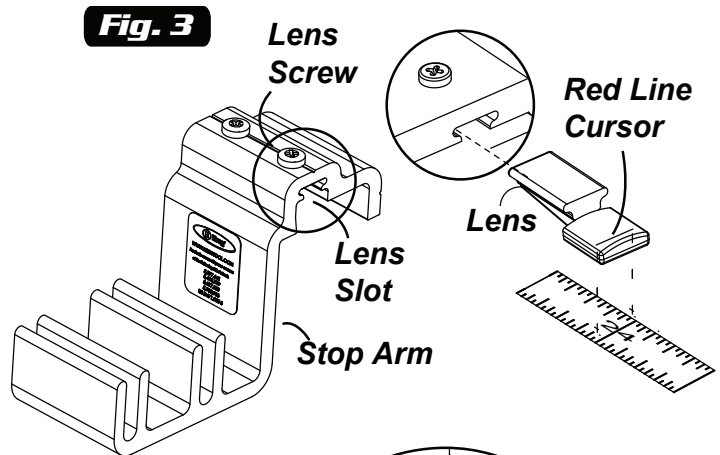

Fig. 3

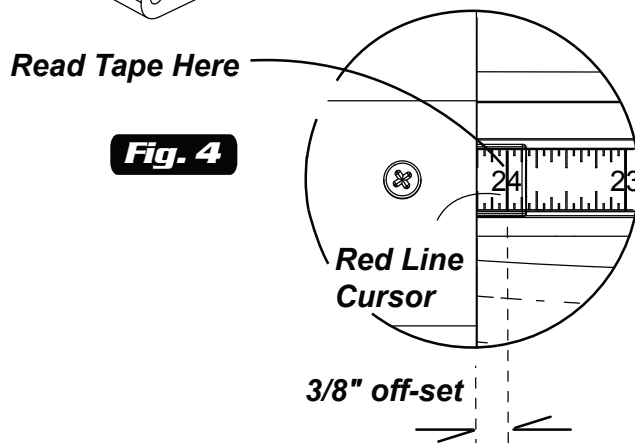

Fig. 4

NOTE: Read these instructions carefully. To correctly use the stop lens, the tape must be positioned 3/8" closer to the blade than the actual distance from the blade.

LOCATING THE MEASURING TAPE

1. Cut a straight 3/4" thick scrap board exactly 24" long by 3" wide as in fig. 5.
2. Locate the board with one end against the teeth of the saw blade.
3. Use a square to place a pencil mark across the top of the fence 24" from the blade on either side of the indentation for the stick-on tape as shown in fig. 6.
4. Align the 24-3/8" mark of the stick-on tape over the pencil mark and adhere the tape to the 1/2" track indentation along the length of the trak.

IMPORTANT NOTE:

When reading the measurement from the lens cursor the tape is off-set 3/8" closer to the blade as shown in figure 7. To set correctly, locate the tape so that the 24-3/8" mark is aligned with the 24" pencil mark on the trak.

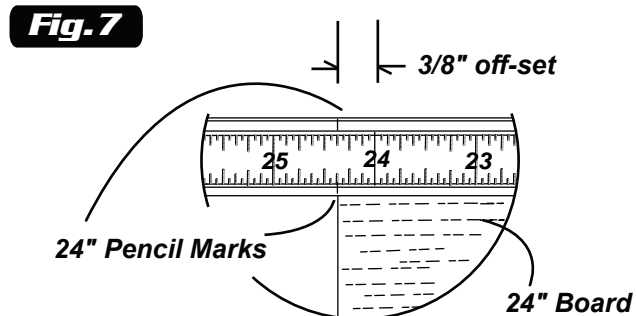
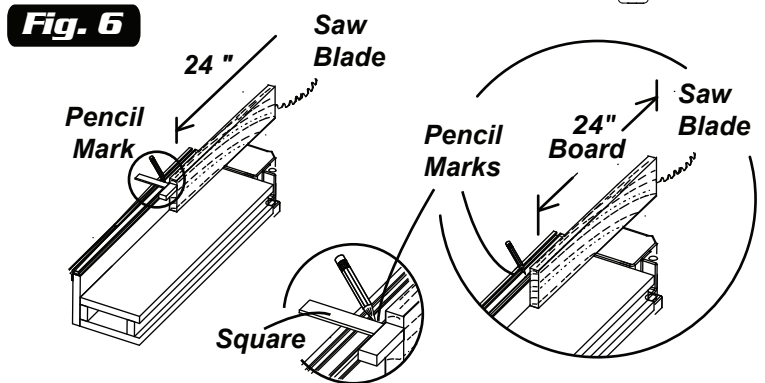
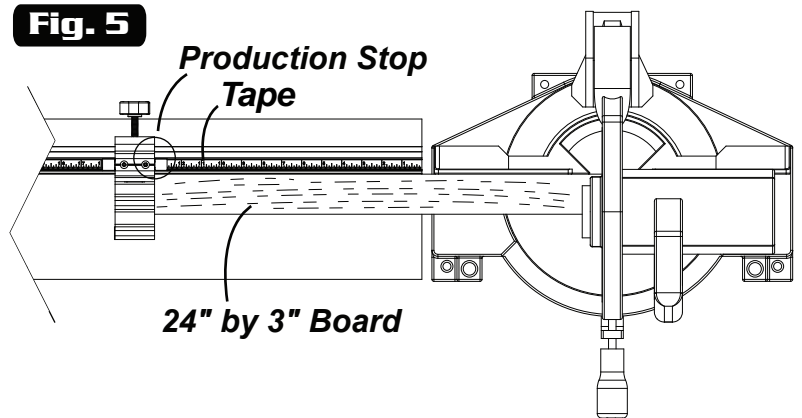

ASSEMBLING THE STOP

Refer to the exploded diagram (Figure 8) for parts identification.

1. Screw the threaded knob through the back of the stop base. Place the stop base onto the top of the trak and tighten the threaded knob so the stop seats into the dovetail on the front edge of the trak.
2. Secondly, insert both the lens into the lens slot on either side of the stop. Again place the 3" x 24" board against the saw blade, Slide the edge of the stop arm into the edge of the board and adjust the lens cursor to be located EXACTLY over the 24" mark on the tape. Cut a test piece and check length with a tape measure. Adjust lens accordingly. Set second lens for opposite side of the blade if applicable.

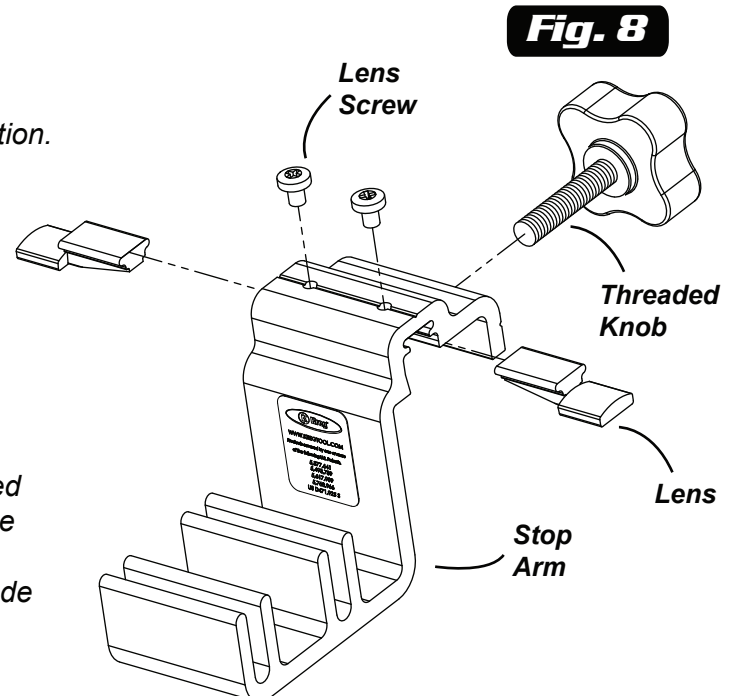

Any questions, call 800-447-8638 for technical support.