

CHEFMAN™

INSTRUCTION BOOKLET



READ ALL INSTRUCTIONS BEFORE USE.

ULTIMATE PERSONAL BLENDER

RJ18 Series

For your safety and continued enjoyment of this product, always read the instruction manual before using.

IMPORTANT SAFEGUARDS



- FOR HOUSEHOLD USE ONLY -

WARNING: When using electrical appliances especially when children are present, basic safety precautions should always be followed to reduce the risk of fire, electric shock, and/or injury to persons, including the following:

1. To protect against electrical shock, do not place cord, plug or motor base in water or other liquids.
2. This appliance should not be used by children, and close supervision is necessary when any appliance is used near children.
3. Do not leave blender unattended while in use.
4. Unplug the blender from outlet when not in use, before putting on or taking off parts, and before cleaning.
5. Avoid contact with moving parts. Keep hand and utensils out of sport bottle while blending to prevent personal injury or damage to the blender.
6. The blade is sharp, handle with care.
7. To reduce the risk of injury, never place cutter-assembly blades on the base without sport bottle properly attached.
8. Do not attempt to bypass the interlock system that powers the unit on.
- 9. Do not blend hot liquids in the blender.**
10. Always operate on a flat surface.
11. Do not operate this appliance with a damaged cord or plug or after appliance malfunctions or has been dropped or damaged in any manner. Return appliance to nearest authorized service facility for examination, repair or adjustment.
12. Do not use outdoors or for commercial purposes.
13. Do not let cord hang over edge of table or counter, or touch hot surfaces including stove.
14. Do not place blender on or near a hot gas or electric burner, or in a heated oven or microwave.
15. Use this appliance for its intended use. The use of attachments not made by the manufacturer, including canning or ordinary jar and processing assembly part, is not recommended by CHEFMAN, and may cause a risk to persons.

SAVE THESE INSTRUCTIONS

This appliance is for HOUSEHOLD USE ONLY. It may be plugged into an AC electrical outlet (ordinary household current). Do not use any other electrical outlet.



WARNING: This appliance has a polarized plug (one blade is wider than the other). To reduce the risk of electric shock, this plug is intended to fit into a polarized outlet only one way. If the plug does not fit fully into the outlet, reverse the plug. If it still does not fit, contact a qualified electrician. Do not attempt to modify the plug in any way.

SHORT CORD INSTRUCTIONS

A short power supply cord is provided to reduce the hazards resulting from entanglement or tripping over a longer cord. Longer detachable power-supply cords or extension cords are available and may be used if care is exercised in their use. If a longer detachable power-supply extension cord is used:

- 1) The marked electrical rating of the cord set or extension cord should be at least as great as the electrical rating of the appliance, and:
- 2) The cord should be arranged so that it will not drape over the countertop or tabletop where it can be pulled on by children or tripped over unintentionally.

If the appliance is grounded, the extension cord should be a 3-wire grounding-type cord.

LINE CORD SAFETY TIPS

1. Never pull or yank on cord or the appliance.
2. To insert plug, grasp it firmly and guide it into outlet.
3. To disconnect appliance, grasp plug and remove it from outlet.
4. Before each use, inspect the line cord for cuts and/or abrasion marks. If any are found, this indicates that the appliance should be serviced and the line cord replaced. Please return it to an authorized service representative.
5. Never wrap the cord tightly around the appliance, as this could place undue stress on the cord where it enters the appliance and cause it to fray and break.

DO NOT OPERATE APPLIANCE IF THE LINE CORD SHOWS ANY DAMAGE OR IF APPLIANCE WORKS INTERMITTENTLY OR STOPS WORKING ENTIRELY.

IMPORTANT

During the first few minutes of initial use, you may notice smoke and/or a slight odor. This is normal and should quickly disappear. It will not recur after appliance has been used a few more times.

This appliance is not intended for use by persons (including children) with reduced physical, sensory or mental capabilities, or lack of experience and knowledge, unless they have been given supervision or instruction concerning use of the appliance by a person responsible for their safety.

GETTING TO KNOW YOUR PERSONAL BLENDER

PRODUCT MAY VARY SLIGHTLY FROM ILLUSTRATIONS

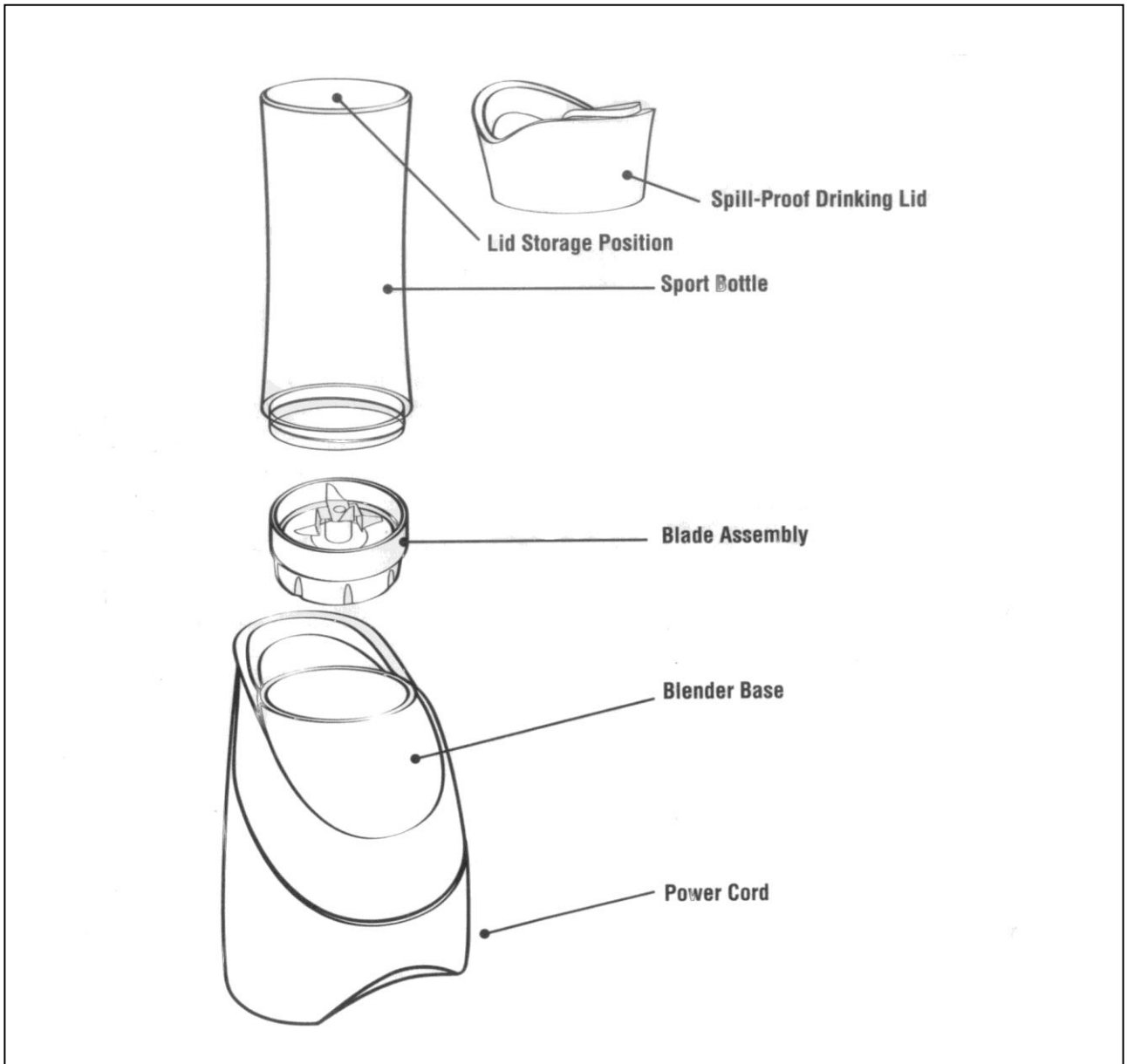

OPERATING INSTRUCTIONS

USING YOUR BLENDER FOR THE FIRST TIME

Place the sport bottle on a flat surface with the open end facing up. Fill the sport bottle with your favorite ingredients. Be sure not to fill ingredients past the 20 oz marking.

Do not blend hot liquids in the sport bottle.



Fasten the blade assembly on the open end of the sport bottle. Turn the sport bottle upside down. Turn the bottle to the closed position to lock the sport bottle in the base for hands-free operation.



To lock the bottle, make sure the bulge point on the side of blade assembly slides to the right of the fillister on the blender base.

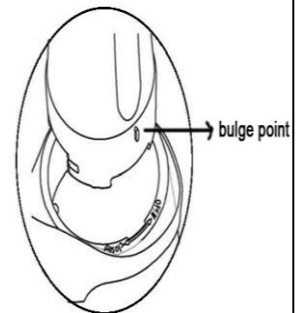

Once the bottle is locked on the base, plug the appliance in an electrical outlet, it will start to work automatically. It takes about 1-2 minutes to finish blending, unplug the appliance after the food is finished blending. Slide and turn the sport bottle over, place it on a flat surface. Replace the blade assembly with the drinking lid.



TIP: After you have consumed your blended beverage, wash out the sport bottle and reuse it throughout the day for water or other cold liquids. **Please note that the sports bottle is not suitable for making hot drinks, and is NOT dishwasher safe.**

Note: For optimal performance, place desired ingredients in the sport bottle according to the following order: Liquid then fresh ingredients, frozen fruit or ice cream.

Blending Tips

- Put liquids in the cup first, unless a recipe states otherwise.
- Cut all fruits and vegetables into pieces no larger than $\frac{3}{4}$ inches to 1 inch
- Don't overload sport bottle. If the motor stalls, turn the blender off immediately, unplug the unit and let it cool for at least 15 minutes. Then remove a portion of the food and continue.
- This blender will not mash potatoes, whip eggs whites or substitute dairy toppings, mix stiff dough or grind raw meat.

USER MAINTENANCE INSTRUCTIONS

This appliance requires little maintenance. It contains no user serviceable parts. Do not try to repair it yourself. Refer it to qualified personnel if servicing is needed.

CLEANING YOUR PERSONAL BLENDER

IMPOTANT: UNPLUG BEFORE CLEANING. DO NOT IMMERSE THE BLENDER BASE IN WATER OR ANY OTHER LIQUID. THE SPORT BOTTLE IS **NOT DISHWASHER SAFE.**

Use a damp, soft sponge with mild detergent to clean the outside of the blender base. You can also wash the parts, in warm soapy water. Rinse well and dry.

STORING YOUR PERSONAL BLENDER

After cleaning, reassemble blade assembly to the open end of the sport bottle and then place in the blender base. Snap the drinking lid on the other end of the sport bottle.

WARRANTY TERMS AND CONDITIONS

CHEFMAN LLC warrants, subject to the conditions stated below, that from the date of purchase, this product will be free from mechanical defects for a period of THREE (3) years. CHEFMAN LLC, at its option, will repair or replace this product found to be defective during the warranty period. Should this product become defective by reason of improper workmanship or material defect during the specified warranty period, CHEFMAN LLC will repair or replace the same effecting all necessary parts replacements for a period of three years from the date of purchase. Transportation charges on parts, or products in whole, submitted for repair or replacement, under this warranty, must be borne by the purchaser.

CONDITIONS: This warranty is valid for the original retail purchaser from the date of initial retail purchase and is not transferable. Keep the original sales receipt. Proof of purchase is required to obtain warranty service or replacement. Dealers, service centers, or retail stores do not have the right to alter, modify or in any way, change the terms and conditions of this warranty. Warranty registration is not necessary to obtain warranty on CHEFMAN LLC Products. Save your proof of purchase receipt.

ABOUT YOUR PRODUCT WARRANTY: Most warranty repairs are handled routinely, but sometimes requests for warranty service may not be appropriate. For example, warranty service would NOT apply if the product damage occurred because of misuse, lack of routine maintenance, shipping, handling, warehousing or improper installation. Similarly, the warranty is void if the manufacturing date or the serial number on the product has been removed or the equipment has been altered or modified. During the warranty period, the authorized service dealer, at its option, will repair or replace any part that, upon examination, is found to be defective under normal use and service.

NORMAL WEAR: This warranty does not cover normal wear of parts or damage resulting from any of the following: Negligent use or misuse of the product; Improper voltage or current; Use contrary to the operation instructions; Deviation from instructions regarding storage and transportation; Repair or alteration by anyone other than CHEFMAN LLC or an authorized service center. Further, the warranty does not cover Acts of God, such as fire, flood, hurricanes and tornadoes. CHEFMAN LLC shall not be liable for any incidental or consequential damages caused by the breach of any express or implied warranty. Except to the extent prohibited by applicable law, any implied warranty of merchantability or fitness for a particular purpose is limited in duration to the duration of the above warranty. Some states, provinces or jurisdictions do not allow the exclusion or limitation of incidental or consequential damages or limitations on how long an implied warranty lasts, so the above limitations or exclusion may not apply to you. This warranty gives you specific legal rights, and you may also have other rights that vary from state to state or province to province.

HOW TO OBTAIN WARRANTY SERVICE: You must contact CHEFMAN LLC. Customer Service at 888-315-8407 Ext: 400. A Customer Service representative will attempt to resolve warranty issues over the phone. If telephone resolution is not possible, the Customer Service representative will require your assistance in performing routine diagnostic procedures. This warranty is effective for the time periods listed above and subject to the conditions provided for in this policy

CHEFMAN is a registered trademark of PLUS ITS CHEAP, LLC. 10952