

### Step 3

## Install Drip Emitters

#### Components needed

Bag 2



Loose in the pack



Using your scissors, cut the Micro Tubing where you intend to run a Micro Dropper to a pot or planter. Run the Micro Tubing up to your pot or planter and use the installation tool to twist and push the Micro Dropper into the end of the Micro Tubing.

Then, snap on the stake, and place into pot or planter.

Repeat as needed using Bags 2 & 3.

**Option A** Once you are done installing Micro Drippers, you can then push the end plug onto the T-Joint Connector to stop the water flow.

**Warning** - Installation tool has a functional sharp point. Contact may result in injury. Handle with care.

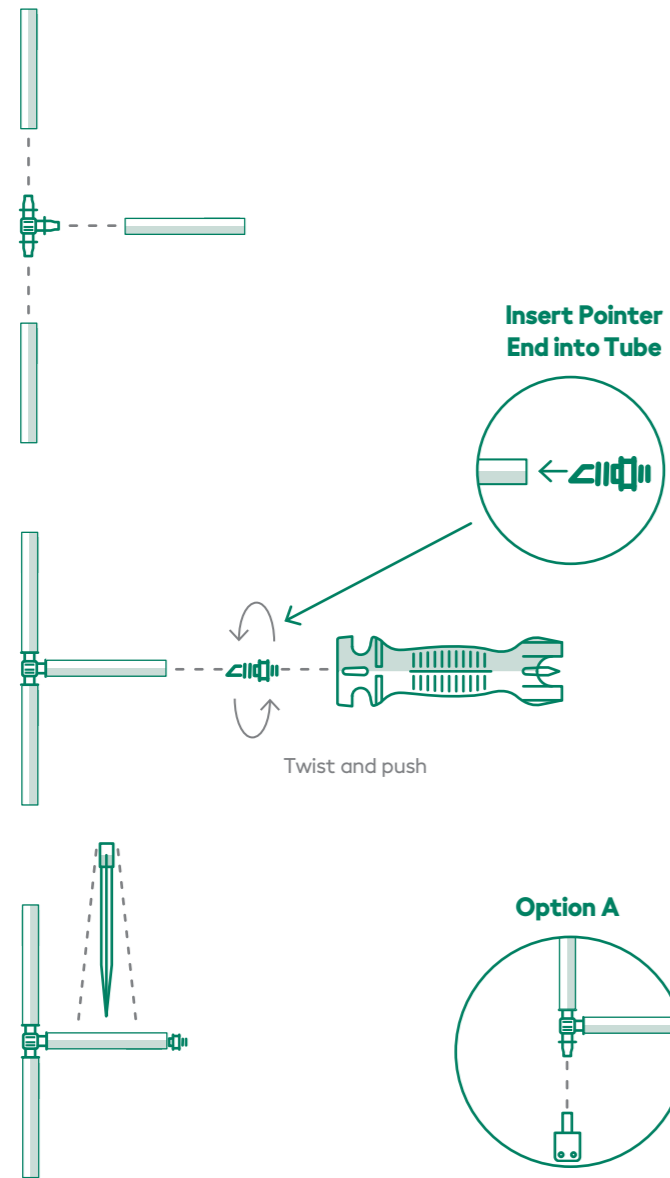

### Welcome to Gro™.

The Gro™ ecosystem is a new way for you to manage all things that grow. Gro™ smart devices replace guesswork with data by using sensors, controllers, and pulling weather analytics. Gro™ also offers you more ways to save time and reduce waste with precision watering kits and nutrient delivery systems. All this is pulled together in a family of beautifully simple apps allowing you to control from anywhere.

Gro™. Bringing you more joy, fewer chores.

© 2017 The Scotts Company LLC.  
World rights reserved.

### Want to add on to your kit? Or access helpful videos and FAQs?

Go to [mygro.com/drip](http://mygro.com/drip)

### Care and Maintenance

To maintain system serviceability winterization is recommended. Disconnect from the spigot, remove hose connectors, and protect from frost and freezing conditions.

### Have additional questions?

Call: 1-855-377-7292

Email: [mygro-support@scotts.com](mailto:mygro-support@scotts.com)



MS3072

gro™

Scotts®



**Potted Drip Kit**  
Instructions for Use

Lay out Micro Tubing—put it in the sun for a few minutes to help soften it up.

Gather additional tools: scissors.

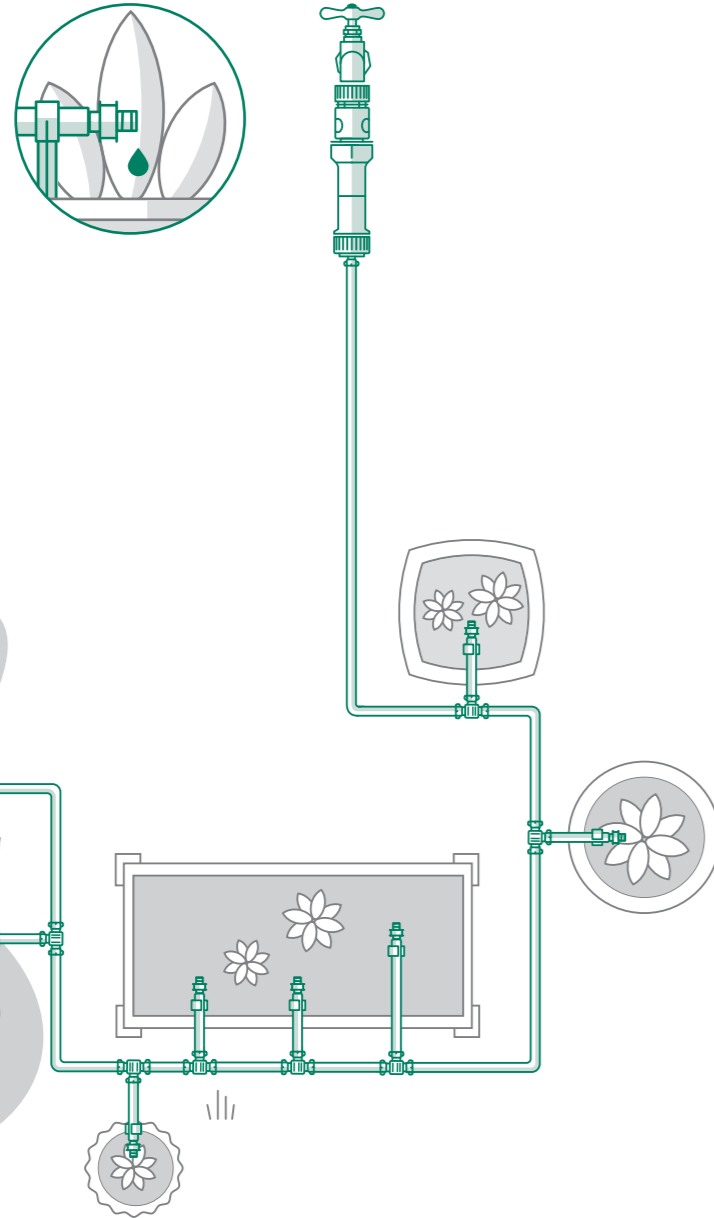
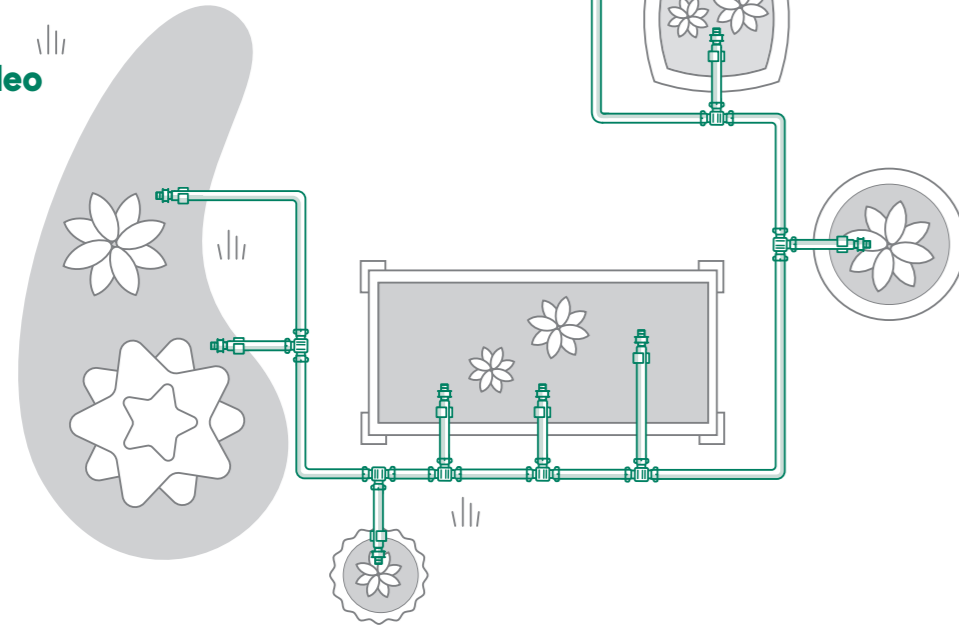

Bag 1



Quick Connect  
Hose/Spigot Connector



Water Flow  
Reducer & Filter x 1

Bag 2



Micro  
Dripper x 4



T-Joint  
Connector x 4



Micro  
Tubing Stake x 4



End Plug x 1

Bag 3



Micro  
Dripper x 4



T-Joint  
Connector x 4



Micro  
Tubing Stake x 4



End Plug x 1

Loose in  
the pack





Micro  
Tubing x 1  
50 ft (15 m)



Installation  
Tool x 1

### Components needed

Bag 1



Loose in the pack

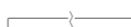

**Option A** If you are planning to use a timer to control your system, attach it first to your spigot or hose, and then attach the Quick Connect Hose/Spigot Connector to your timer.

**Option B** If you plan to use your existing hose, attach your hose to your spigot, and then attach the Quick Connect Hose/Spigot Connector to your hose.

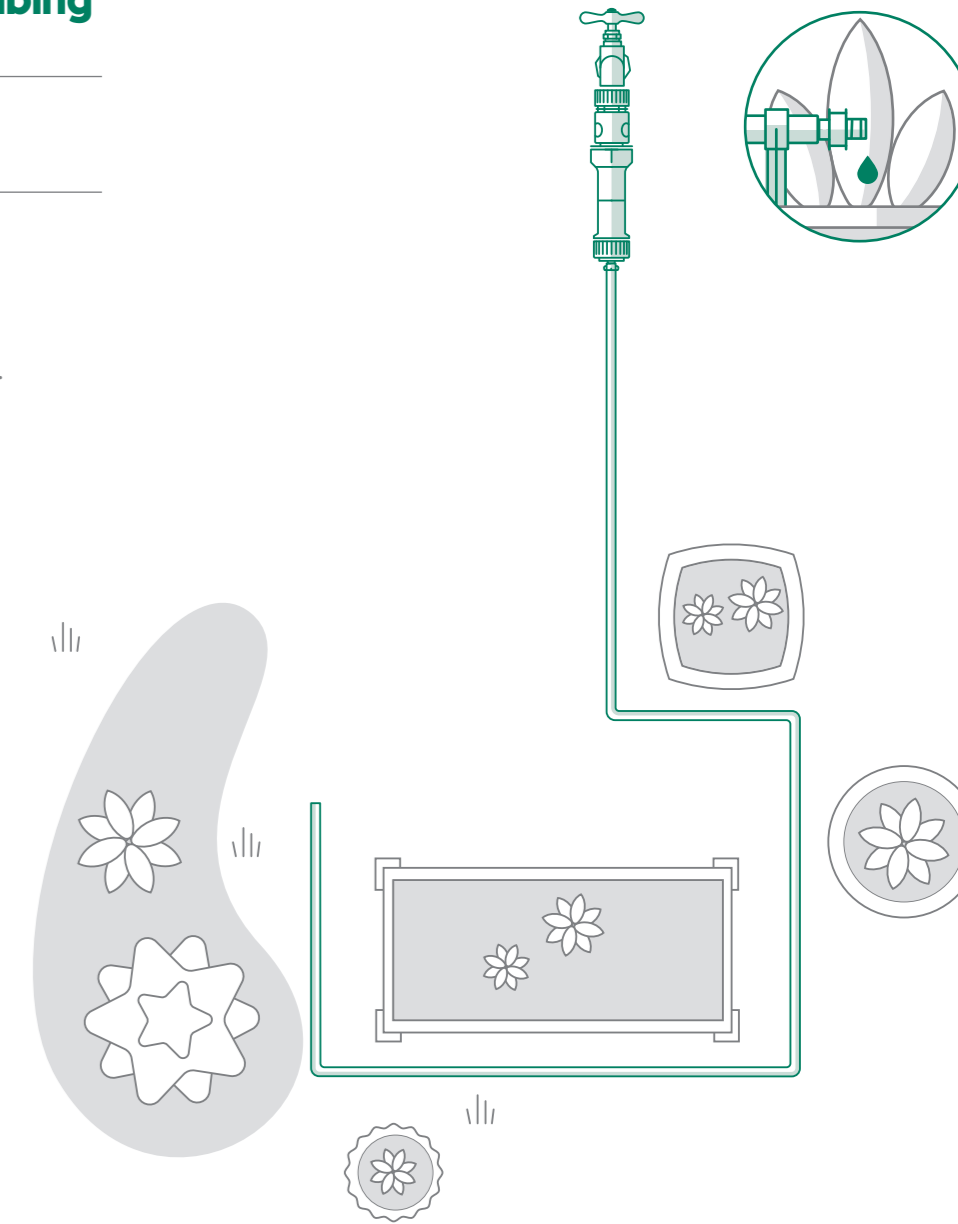

**Components needed**

---

Loose in the pack



---

**Tip:** Lay your Micro Tubing out in the sun for a few minutes to soften it up before assembling.