

Package Contents

- HD Bullet Security Camera
- Mounting Kit*
- 60ft (18m) BNC / Power Extension Cable*
- Power Adapter**

* Per camera in multi-camera packs.

** A multi-camera power adapter that provides power to multiple cameras or individual power adapters may be provided depending on product configuration.

ATTENTION:

A REGULATED UL / CSA APPROVED power supply is REQUIRED for use with this camera (included). Use of a non-regulated, non-conforming power supply can damage this product and voids the warranty.

Safety Precautions

- Read this guide carefully and keep it for future reference.
- Follow all instructions for safe use of the product and handle with care.
- Use the camera within given temperature, humidity and voltage levels noted in the camera's specifications.
- Do not disassemble the camera.
- Do not point the camera directly towards the sun or a source of intense light.
- Use only the supplied regulated power supply provided with the product. Use of a non-regulated, non-conforming power supply can damage the product and void the warranty.
- Periodic cleaning may be required. Use a damp cloth only. Do not use any harsh, chemical-based cleaners.
- The supplied cable is rated for surface mounting only. Cables for in-wall and floor-to-floor installations are sold separately (CMR type). These and other cables are available at lorextechnology.com

Installation Tips

- Point the camera where there is the least amount of obstructions (i.e., tree branches).
- Install the camera where vandals cannot easily reach.
- Secure cabling so that it is not exposed or easily cut.
- This camera is rated for outdoor use. Installation in a sheltered location is recommended.

Disclaimers

- For a full list of compatible recorders, visit lorextechnology.com/compatibility
- Not intended for submersion in water. Installation in a sheltered location recommended.

Resources

Need Help?

Visit us online for up-to-date software and complete instruction manuals



1

Visit lorextechnology.com

2

Search for the model number of your product

3

Click on your product in the search results

4

Click on the **Downloads** tab

Dimensions

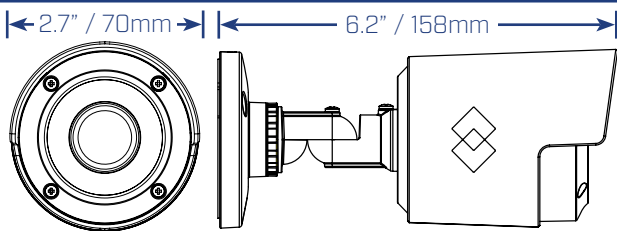

LOREX[®]
BY **FLIR**[®]

HD Bullet Security Camera

Quick Start Guide
English Version 1.0



Copyright © 2017 Lorex Corporation
As our products are subject to continuous improvement, Lorex reserves the right to modify product design, specifications and prices, without notice and without incurring any obligation. E&OE. All rights reserved.

LAB223_LAB243_QSG_EN_R2

LAB223 / LAB243 SERIES

www.lorextechnology.com

Installing the Camera

ATTENTION:

Test your camera prior to selecting a permanent mounting location by temporarily connecting the camera and cable to your DVR.

Before Installing the Camera

- Decide whether to run the cables through the wall / ceiling (drilling required) or along the wall / ceiling.

- If you run the cables along the wall / ceiling, you must run the cable through the **able notch** on the base. This will keep the camera base flush to the surface when mounted.

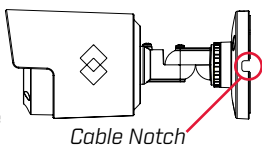

To install your camera:

- Set the camera in the desired mounting position and mark holes for screws through the camera base.
- Drill the holes, then feed the cable through the mounting surface or cable notch.

NOTE: Insert the included drywall anchors if you are mounting the camera onto drywall.

- Mount the camera stand to the mounting surface using the provided screws. Make sure all screws are fastened tightly.

- Adjust the camera as shown below:

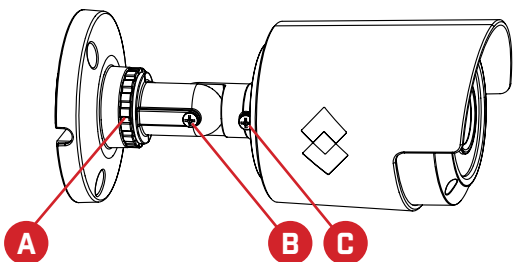

A. ROTATING THE ARM: Loosen the adjustment ring by turning it counter-clockwise. Rotate the arm of the camera up to 360°, then tighten the adjustment ring against the base.

B. BENDING THE ARM: Use a Phillips head screwdriver (not included) to loosen the adjustment screw closest to the camera base. Bend the arm of the camera up to 90°, then tighten the screw.

C. LEVELING THE CAMERA: Use the screwdriver to loosen the adjustment screw furthest from the camera base. Rotate the camera until it is level with the viewing area, then tighten the screw.

ATTENTION:

This camera includes an Auto Mechanical IR Cut Filter. When the camera changes between Day/Night viewing modes, an audible clicking noise may be heard from the camera. This clicking is normal, and indicates that the camera filter is working.

Connecting the Camera



Camera

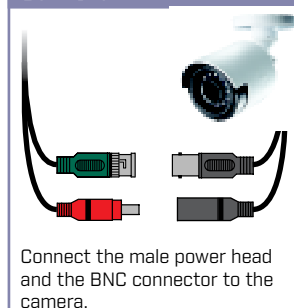

Connect the male power head and the BNC connector to the camera.

DVR

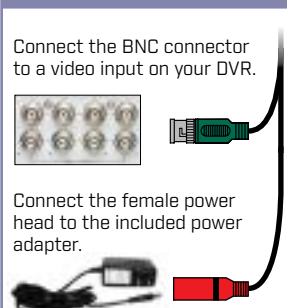

Connect the BNC connector to a video input on your DVR.

Connect the female power head to the included power adapter.

Power Adapter Types

A multi-camera power adapter that provides power to multiple cameras or individual power adapters may be provided, depending on product configuration.

Individual Power Adapter*



Multi-Camera Power Adapter*



* Images for representation only

Setup Diagram

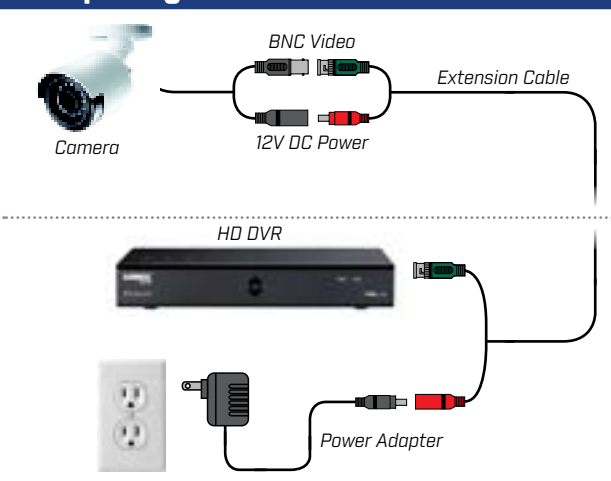

Cable Extension Options

Extend the cable run for your camera depending on the cable type used. Additional extension cables sold separately. See table below:

Option	Cable Type	Max Cable Run Distance
1	Lorex model MCBL-60BNC4 BNC Cable (included with camera)	60ft (18m)
2	'RG59' or 'Coax' or 'Coaxial BNC' Siamese (Video and Power)	200ft (60m)
3	'RG59' or 'Coax' or 'Coaxial BNC' (Video Only) ²	500ft (150m)

Notes:

- The extension cable must be a single stretch of cable between the DVR and camera. You cannot connect multiple extension cables to each other.
- For cable runs above 200ft (60m), you must connect the power adapter directly to the camera, rather than at the end of the extension cable.
- Baluns are not supported for LAB223.
- Indicators that your cable run may be too long:
 - Video is permanently black & white (even during day time)
 - Video is unclear, soft, or distorted
- For more information on extension cables, visit lorextechnology.com

Troubleshooting

Problem	Solution
No picture / signal	<ul style="list-style-type: none"> The cameras are only compatible with certain Lorex HD DVRs. For the full list of compatible recorders, visit lorextechnology.com/compatibility Ensure your TV or monitor is on the correct input channel. Common terms for input channels: INPUT, AV CHANNEL, LINE1, LINE2, AUX. Ensure your DVR is properly connected to your TV or monitor. Ensure connections are properly connected. Ensure the camera power supply is plugged in.
Picture is too bright	<ul style="list-style-type: none"> Ensure your camera isn't pointed directly at a source of light (e.g., sun or spot light). Check the brightness settings of the DVR and monitor. Move your camera to a different location.
Picture is too dark	<ul style="list-style-type: none"> Check the brightness and contrast settings of the DVR and monitor.
Night vision is not working	<ul style="list-style-type: none"> The night vision activates when light levels drop. The area may have too much light.
Picture is not clear	<ul style="list-style-type: none"> Check the camera lens for dirt, dust, spiderwebs. Clean the lens with a soft, clean cloth. Make sure that the cable run is within the limitations specified in the section 'Cable Extension Options'.
Bright spot in video when viewing camera at night	<ul style="list-style-type: none"> Night vision reflects when pointing a camera through a window. Move the camera to a different location.