

UNPACKING

After removing all parts and hardware pack from the top of the shipping box, and when the only part showing is the grill head, use a box cutting knife to slice down the sides of the box. Be careful of staples along shipping box edges.

Remove the steel and cardboard corner supports from the box and the styrofoam side pieces from the grill head. Open grill lid and remove all packaged parts and packing material. Allow grill head to rest on cardboard until placing grill head on cart in Step 9.

WARNING: Assemble the grill on a flat level surface. Compare the parts and hardware with the list and diagrams. Do not attempt assembly if any part is missing or damaged.

1. Attach the locking casters (Q) and the casters (R) to the bottom panel (P) using 12 screws (AA). When this process is completed, turn the bottom panel over. The two locking casters (Q) should be at the back of the grill.

Hardware Used

AA 3/16-24 x 1/2 in. Screw X 12

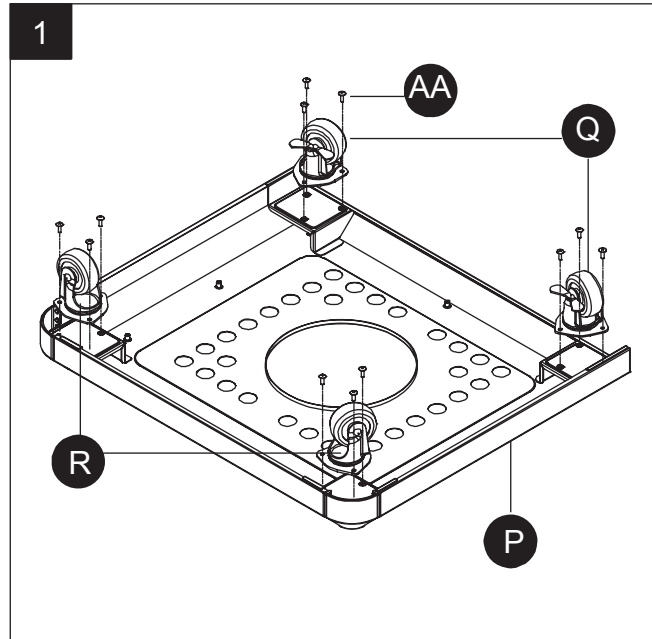

2. Align the holes in the rear panel (L) with the holes in the bottom panel (P) and insert screws (AA) into the aligned holes.

Hardware Used

AA 3/16-24 x 1/2 in. Screw X 3

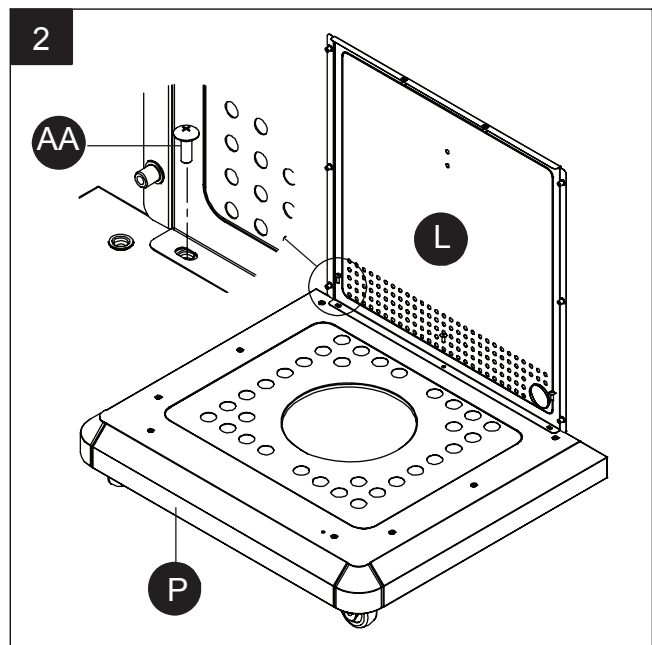

Note: Do not tighten the screws completely. Leave at least one full turn on each. After all the screws have been installed, go back and tighten them fully.

3. Attach the left panel (T) and right panel (N) to the bottom panel (P). For both the left and right panels, there are three screws for the rear panel (L) and four for the bottom panel. Insert the four bottom panel screws first.

Hardware Used

AA 3/16-24 x 1/2 in. Screw X 14

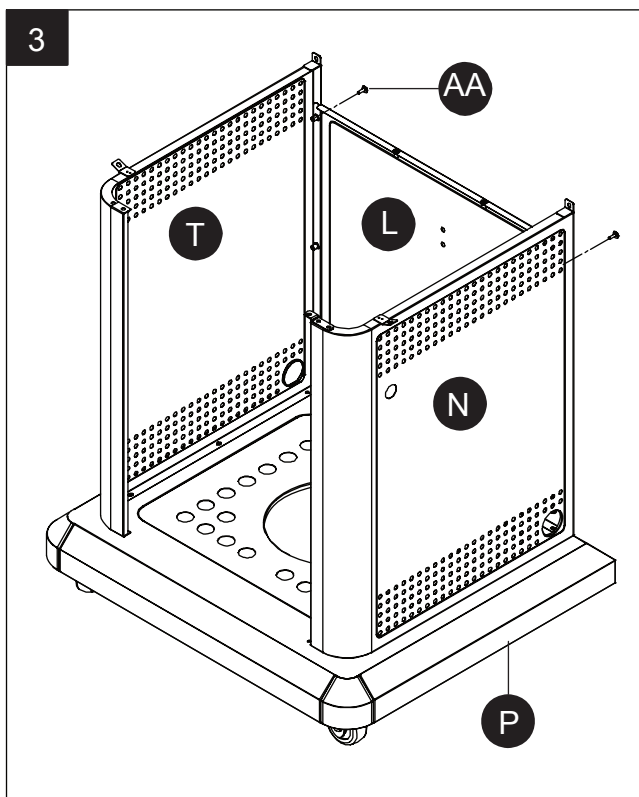

4. Attach the front beam (U) to the left panel (T) and the right panel (N) with 2 screws (AA) on each side as shown.

Hardware Used

AA 3/16-24 x 1/2 in. Screw X 4

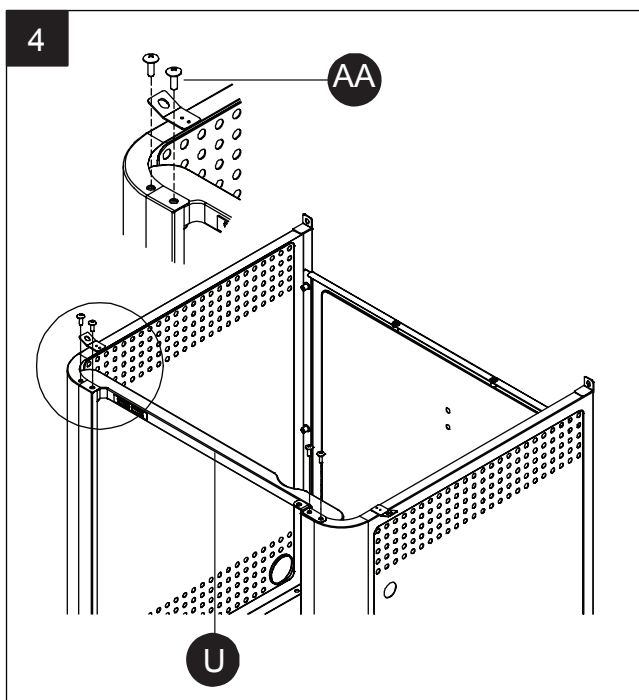

- Slide the tank ring bracket (K) onto the end of the safety tank ring (J) as shown. Attach the tank ring bracket to the rear panel (L) with 2 screws (BB) as shown.

Hardware Used

- | | | | |
|-----------|---------------------------|---|-----|
| BB | 1/4-20 x 5/8 in.
Screw |  | X 2 |
|-----------|---------------------------|---|-----|

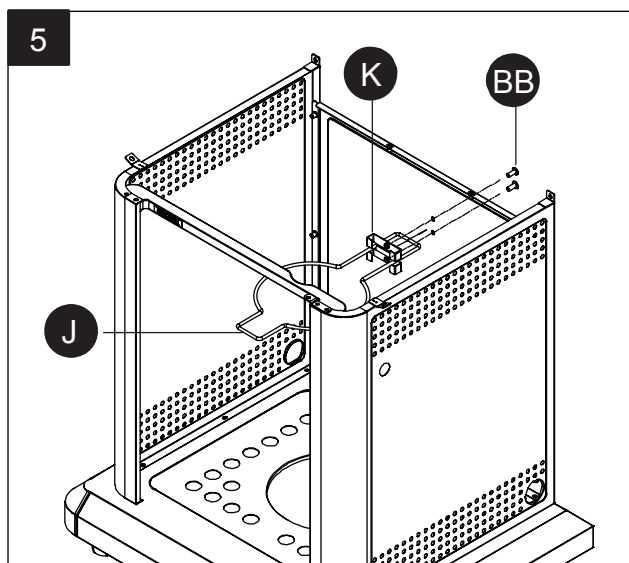

- Attach the drip tray support (I) to the front beam (U) and rear panel (L) with 4 screws (AA) as shown.

Hardware Used

- | | | | |
|-----------|----------------------------|--|-----|
| AA | 3/16-24 x 1/2 in.
Screw |  | X 4 |
|-----------|----------------------------|--|-----|

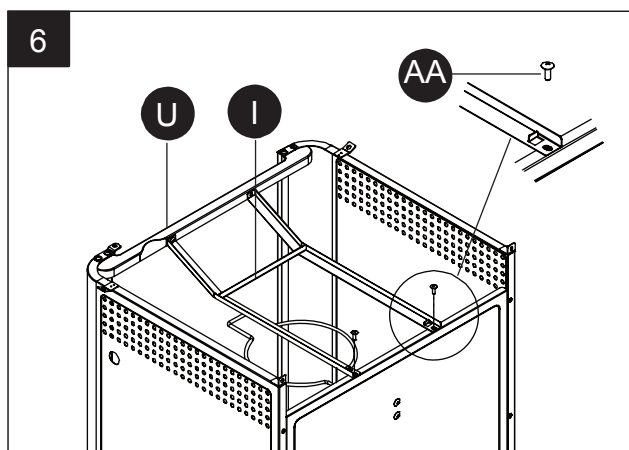

- Remove the cap and the nut from the igniter (M). Secure the igniter to the right panel (N) with the nut. Then, reassemble the cap to the igniter.

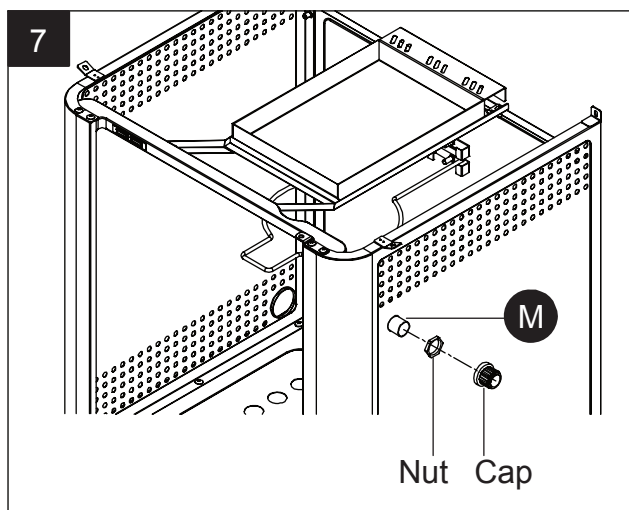

- For the door (S), insert bottom hinge pin into hole on bottom panel (P). Push top hinge pin in the corner of the door to insert into hole in top corner of the right panel (N). Then, put the drip tray (O) onto the drip tray support (I).

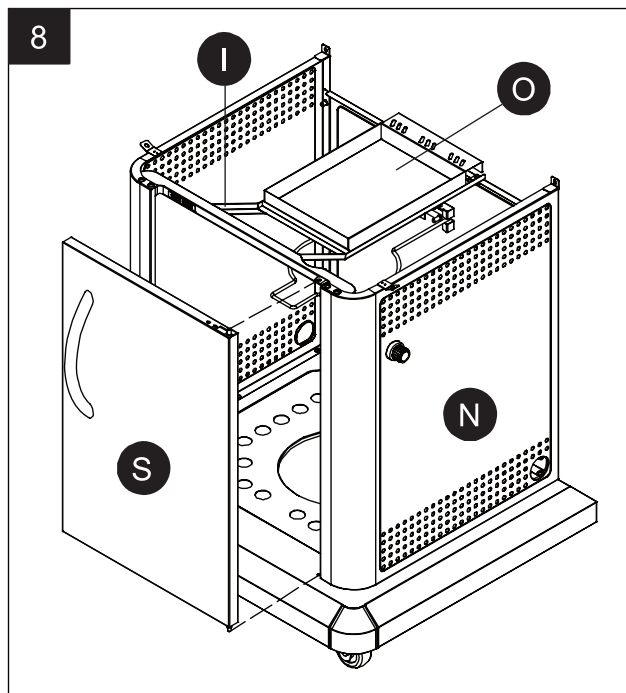

- Take the pressure regulator out from under the burner box (A). Lift the burner box (A) onto the cabinet, making sure that the gas pressure regulator is in the cabinet, then position burner box on the cabinet by aligning the four tabs on top of the cabinet with the holes in the burner box. Fasten the burner box to the cabinet with 4 screws (AA).

Hardware Used

- AA 3/16-24 x 1/2 in. Screw X 4
- 

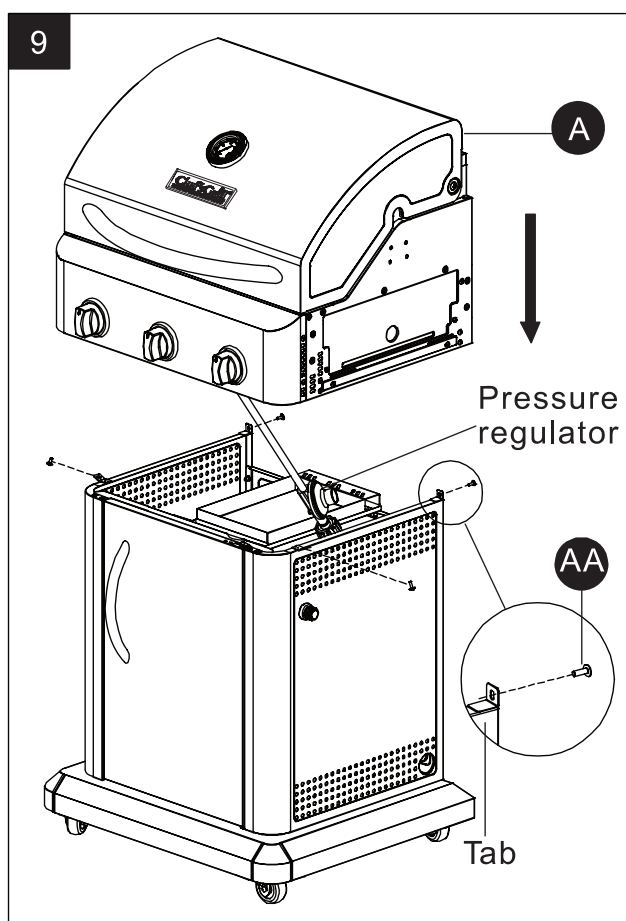

10. Attach the left side shelf bracket (H) to the left of the burner box (A) and the right side shelf bracket (E) to the right of the burner box with 2 screws (AA) on each bracket.

Hardware Used

- AA 3/16-24 x 1/2 in. Screw X 8

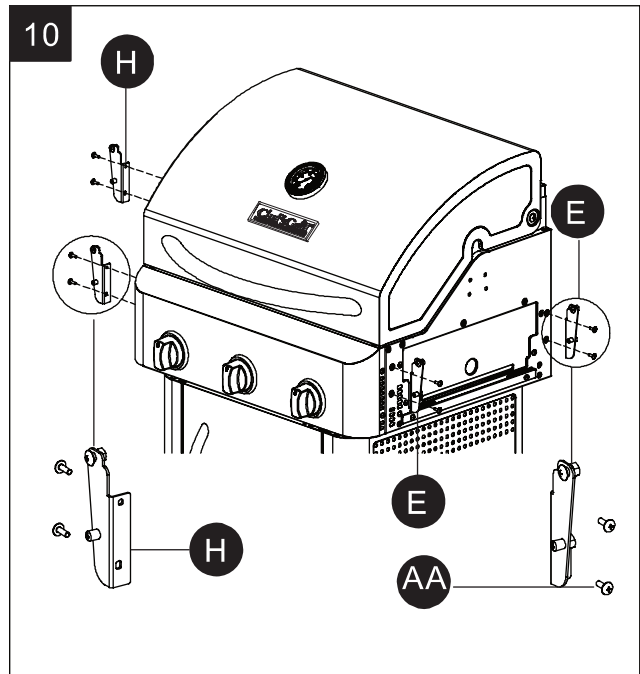

Follow steps 11 - 13 for installing or removing the side shelves (G and F).

11. To install the shelves:
Hold the shelf at its fold-down position (vertical). Align the large holes on the shelf to the mounting screw on the side shelf bracket. Move the side shelf from front to back, making sure the screws fit inside the holes on the side shelf, then slide into the slot.

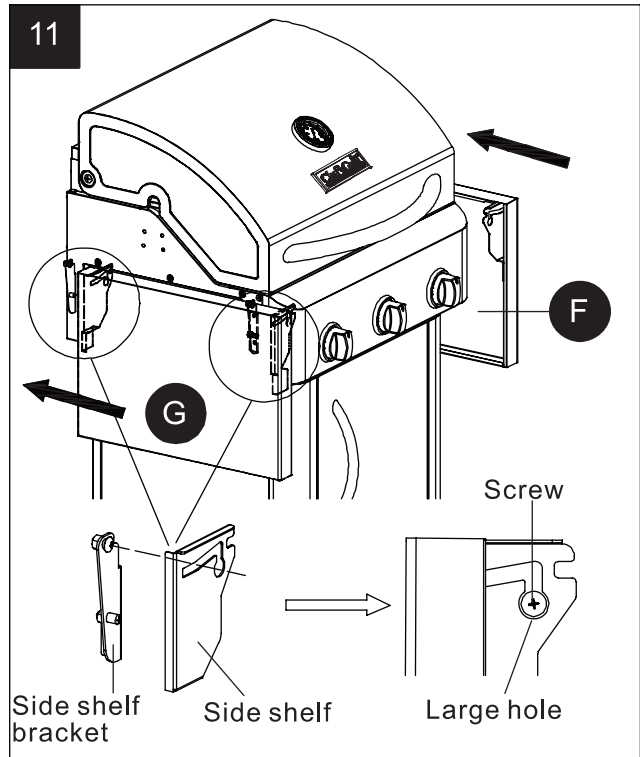

12. To fold up the shelves:
Make sure the screws are in the slot as shown, then slowly rotate the side shelf up.
When folding up to level position, press down the hinge area to lock the shelf. Adjust the side shelves to align it with the control box.

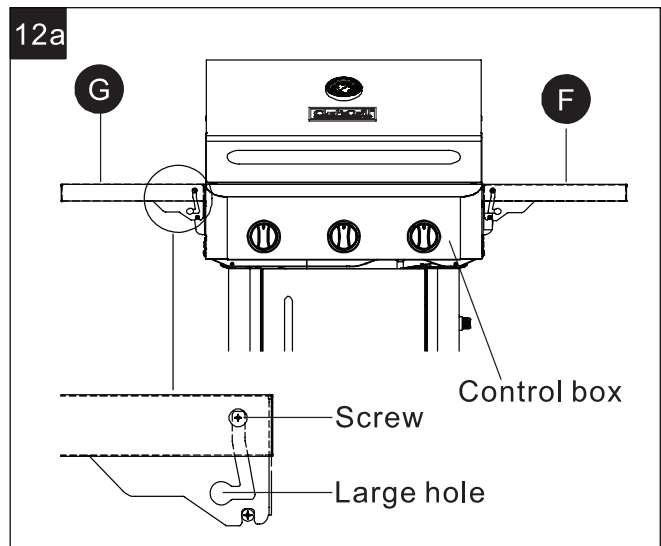
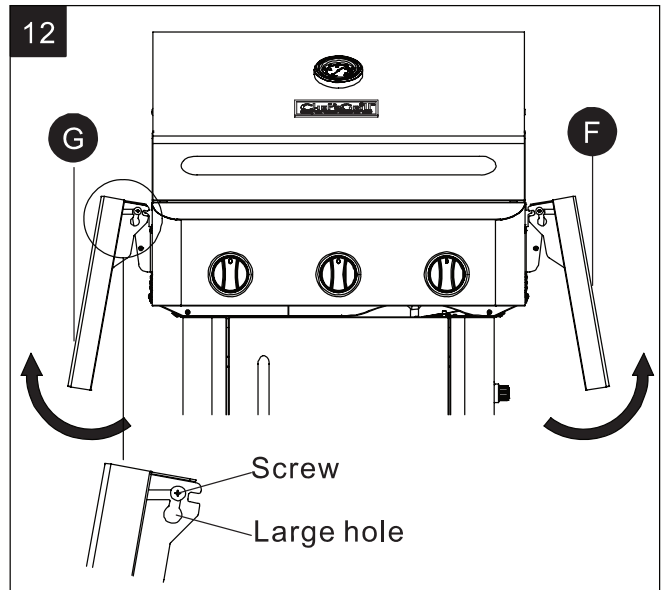

13. To remove the shelves:
Lift up the shelf, position the shelf at its fold-down position (vertical).
Align the screws with the holes on the shelf, move the shelf from back to front until the side shelf disconnect from the screw on the bracket.

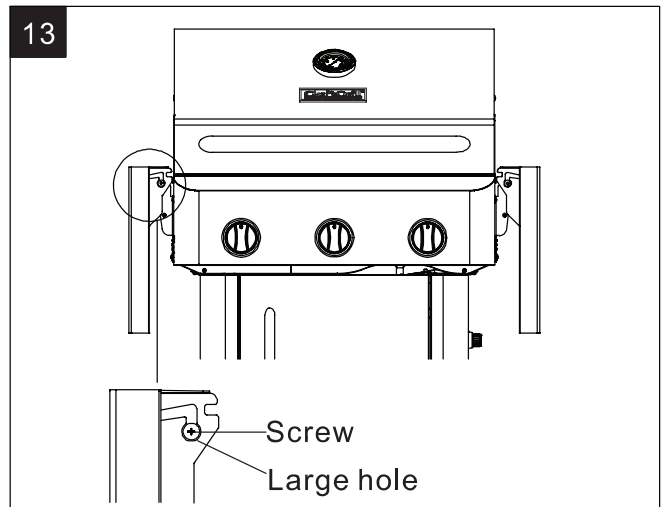

14. Plug the main burner igniter wires into the sockets in the igniter.

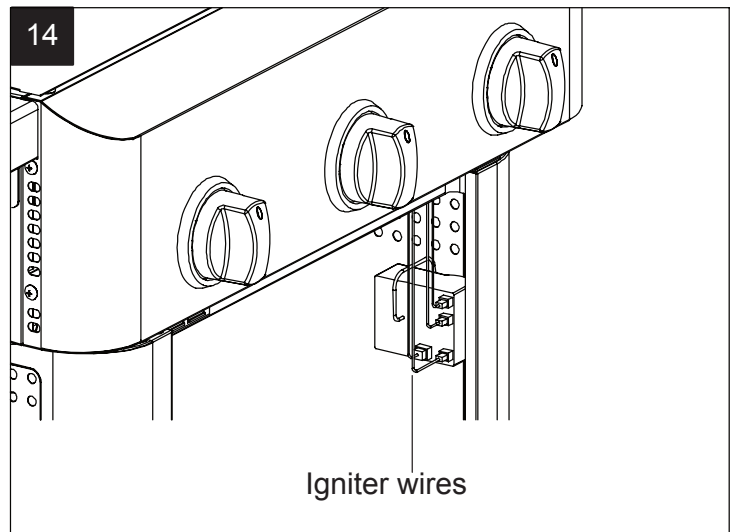

15. Place the heat tents (B), main grids(C) and warming rack (D) into the burner box (A). Remove the battery cap on the igniter (M) and insert a AA battery (CC) with the positive end facing outward. Replace the cap.

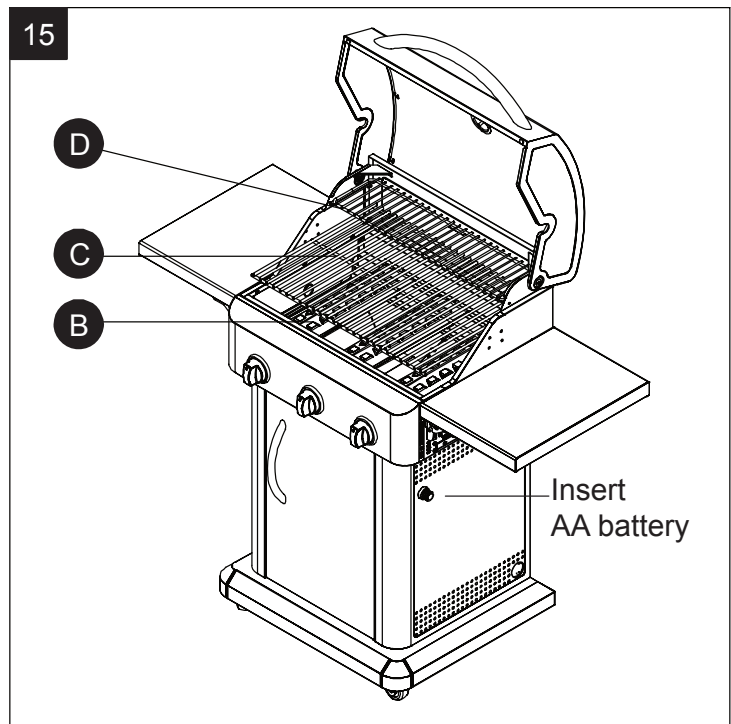

ASSEMBLED GRILL DIMENSION (INCHES):
46 (HEIGHT) x 51.2 (WIDTH) x 22.3 (DEPTH) (SIDE SHELF FOLDED OUT)
46 (HEIGHT) x 32 (WIDTH) x 22.3 (DEPTH) (SIDE SHELF FOLDED DOWN)
WARMING RACK AREA (SQUARE INCHES): 142
THE UL LABEL IS ON THE BACK OF THE DOOR.