

Model: 63662432, 63663632, 63664832, 63666028

FEATURES

- Elegant Rounded Corner Design
- Energy Efficient and Long Lasting LED Lighting
- Frosted pattern on four sides
- Mirror Front IR Sensor Switch
- Built-in 5.5" Dia. LED Lit Magnifier with 3x Magnification
- Durable Aluminum Frame with Steel Back Panel
- Can be Hung in Portrait or Landscape (for 63662432 and 63663632 ONLY)

LIGHTING

- LED (Light-Emitting Diode)
- Average Bulb Life of 50,000 hours
- Color Temperature: 6000K (Daylight)
- Brightness: see page 2
- Power Consumption: see page 2

SAFETY

- Safety Backed Mirror
- IP44 Rated

OVERVIEW

Innoci-usa does not cut corners and only uses the highest quality components and bulbs to make sure that the mirror will be maintenance free and function like the day you purchased for average 50,000 hours of use. Innoci-usa prides itself on providing unmatched price vs quality for all of our products. All mirrors come with a 5-year limited warranty.

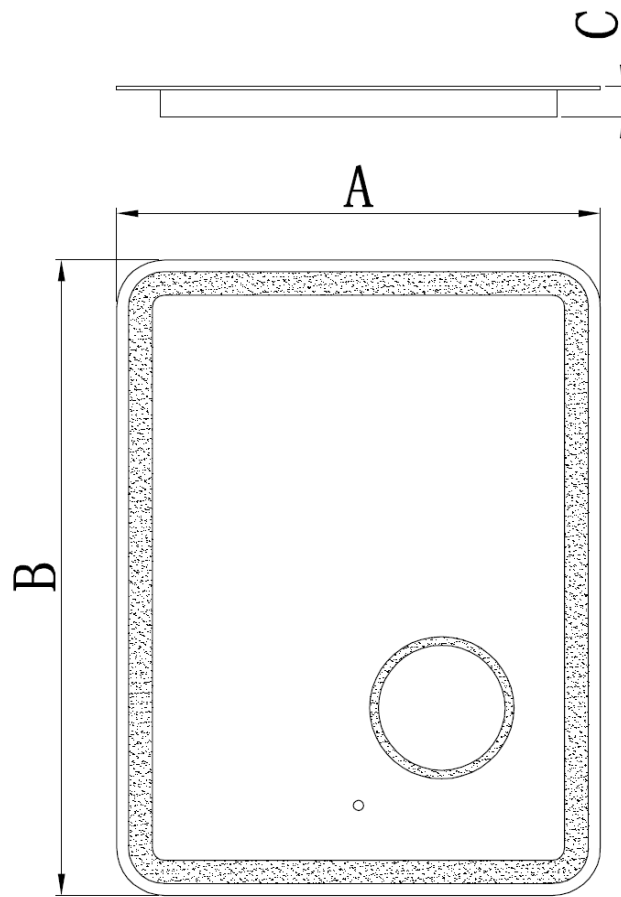

| Model # | A | B | C | Brightness (Lumen) | Power Consumption (Watt) |
|----------|----|----|-------|--------------------|--------------------------|
| 63662432 | 24 | 32 | 1 5/8 | 1800 | 29 |
| 63663632 | 36 | 32 | 1 5/8 | 2190 | 35 |
| 63664832 | 48 | 32 | 1 5/8 | 2550 | 41 |
| 63666028 | 60 | 28 | 1 5/8 | 2790 | 45 |

Innoci-USA INC
Newport Beach, CA 92660

www.innoci-usa.com
(866) 479-8076

customerservice@innoci-usa.com

innociusa
LIFESTYLE