

SURFACE WIRING

NONMETALLIC RACEWAY

On-Wall Wiring

Add or extend power, phone, or data lines.

Wiremold Nonmetallic Raceway features a sleek profile and easy to install design, making this a perfect solution for do-it-yourself installations. Great for adding power or communications to rec rooms or home offices. Paintable.

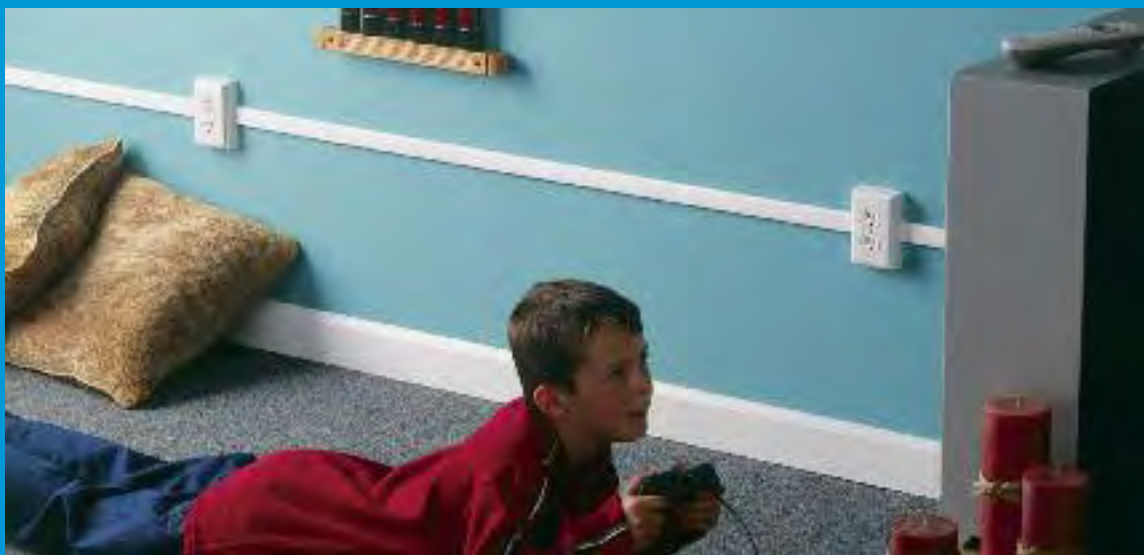

NMW1

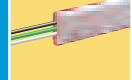

60" L x 1 5/16" W x 7/16" H

1524mm L x 33mm W x 11.1mm H

TOOLS YOU'LL NEED:

- Standard and long-nose pliers
- Standard and Phillips head screwdrivers
- PVC cutter or fine tooth hacksaw
- Tape measure • Wire snips • Utility knife

NONMETALLIC RACEWAY parts checklist:



Wire Channel

Carries wire from starter box to downstream outlet boxes, switches, and fixtures.
NMW1 White, NM1 Ivory



Circular Fixture Box

For bringing power to a light fixture, ceiling fan,* smoke detector, or other round based fixtures.
NMW4 White, NM4 Ivory



T-Fitting

For installations requiring 3-way branching including 90° angle.
NMW11 White, NM11 Ivory



Starter Box

Fits over existing single-gang outlet to feed power as the starting point for your system (1" deep).
NMW2 White, NM2 Ivory



Flat Elbow

(2 per card) For making a left or right 90° turn on a flat surface.
NMW6 White, NM6 Ivory



Conduit Connector

For transitioning from nonmetallic raceway to conduit.
NMW17 White, NM17 Ivory



Deep Outlet Box

Accommodates most commercial grade wiring devices (1 3/8" deep).
NMW3 White
NM3 Ivory



Inside Elbow

For making a 90° turn around an inside corner from wall-to-wall or wall-to-ceiling.
NMW7 White, NM7 Ivory

*Not a mounting bracket. Ceiling fans and fixtures over 10 lbs. must be mounted independently from circular fixture box.



2-Gang Outlet Box

Expanded capacity for extra outlets or outlet/switch combinations (1 3/8" deep).
NMW3-2 White, NM3-2 Ivory



Outside Elbow

For making a 90° turn around an outside corner.
NMW8 White, NM8 Ivory



Extra Deep Outlet Box

For oversized wiring devices such as fan speed controls, dimmer switches and GFCIs (1 3/4" deep).
NMW35 White, NM35 Ivory



Accessory Pack

Mounting components for NM1 wire channel, including screws and anchors, wire clips, and joint cover.
NMW910 White
NM910 Ivory

Easy to install:

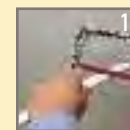

1
Cut nonmetallic raceway to size.

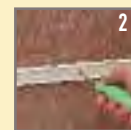

2
Mount base to wall.

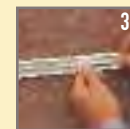

3
Insert wire.



4
Snap on cover.