



Assembly Instruction

Furinno Compact Computer Desk

MODEL : 11181

00:30

Approx. 30 minutes



Recomm. 1 Person

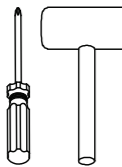

Tools Required

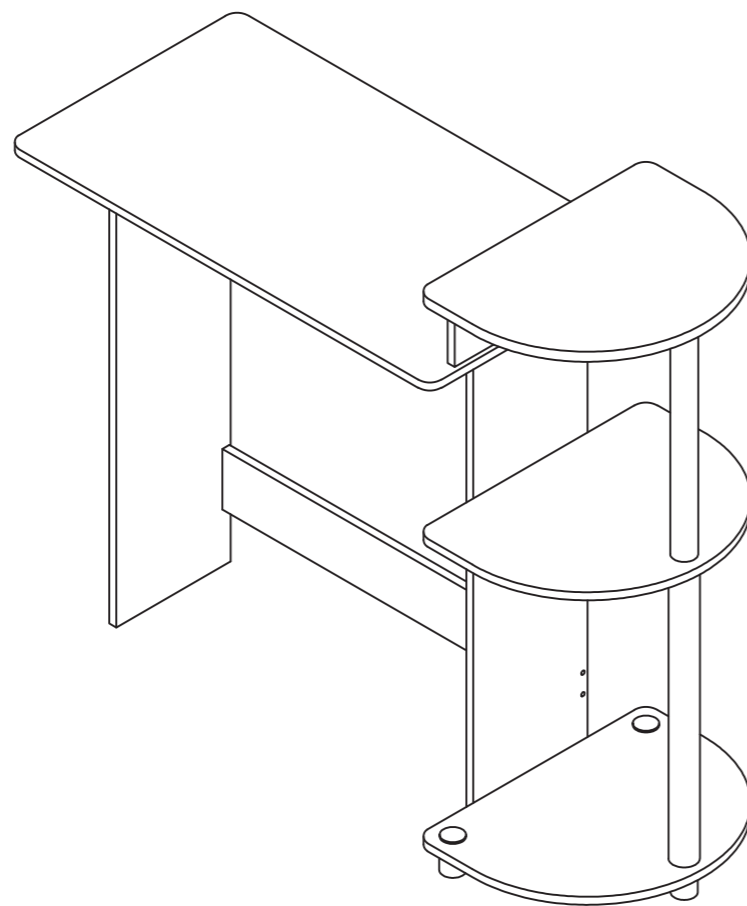

Customer Support

NEED HELP? For replacement requests or product inquiries, please contact our Customer Service Team by emailing us at support@furinno.com. Thank you for selecting Furinno!

www.furinno.com



EXPLODED VIEW

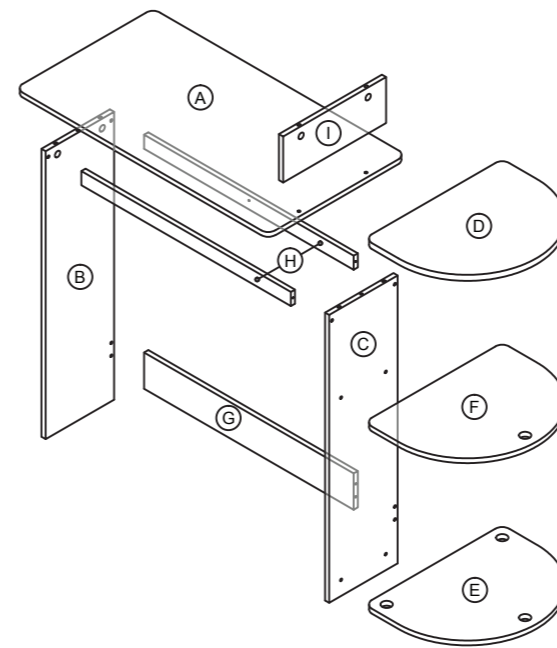

USEFUL HINTS BEFORE YOU START:

1. Read each step carefully before starting.
2. It is important that each step is performed in correct order to avoid difficulties.
3. Identify, soft and count the parts before assembly.
4. Assemble your furniture on packaging cardboard to prevent scratch or damage.
5. Clean the product with mild cleanser using soft dampened cloth. Do not use harsh or abrasive cleanser.
6. Using incompatible hardware might cause damage to product.

PARTS LIST

A TOP PANEL 1 PC	B LEFT SIDE PANEL 1 PC	C RIGHT SIDE PANEL 1 PC
D UPPER TOP PANEL 1 PC	E BOTTOM PANEL 1 PC	F SHELF PANEL 1 PC
G BOTTOM CROSS BAR 1 PC	H SKIRT PANEL 2 PCS	I APRON PANEL 1 PC

HARDWARE LIST

1 LONG SCREW 14 PCS	2 SHORT SCREW 4 PCS	3 DOWEL 4 PCS
4 L-BRACKET 2 PCS	5 NAIL LEG 4 PCS	6 LONG POLE 1 PC
7 SHORT POLE 1 PC	8 TOP CAP 2 PCS	9 LEG 3 PCS
10 CAM-LOCK SCREW 6 PCS	11 CAM-LOCK NUT 6 PCS	

STEP 1

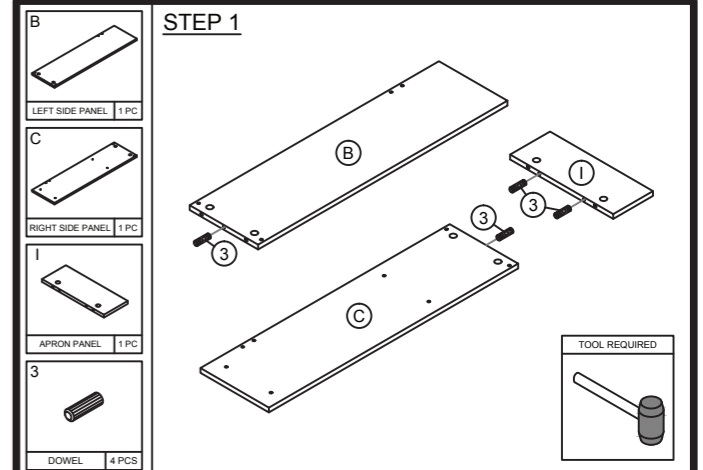

STEP 2

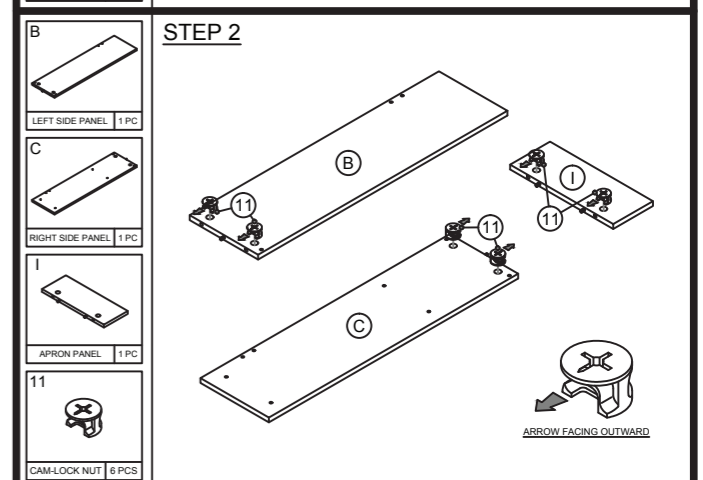

STEP 3

H
SKIRT PANEL 2 PCS

4
L-BRACKET 2 PCS

2
SHORT SCREW 2 PCS

UNFINISHED SURFACE

UNFINISHED SURFACE

TOOL REQUIRED

STEP 4

A
TOP PANEL 1 PC

D
UPPER TOP PANEL 1 PC

10
CAM-LOCK SCREW 6 PCS

UNFINISHED SURFACE

TOOL REQUIRED

STEP 7

ASSEMBLED UNIT

2
SHORT SCREW 2 PCS

TOOL REQUIRED

STEP 8

ASSEMBLED UNIT

G
BOTTOM CROSS BAR 1 PC

1
LONG SCREW 4 PCS

UNFINISHED SURFACE & EDGE

TOOL REQUIRED

STEP 5

A
TOP PANEL 1 PC

B
LEFT SIDE PANEL 1 PC

C
RIGHT SIDE PANEL 1 PC

UNFINISHED EDGE

TURN 180°

TOOL REQUIRED

STEP 6

ASSEMBLED UNIT

H
SKIRT PANEL 2 PCS

1
LONG SCREW 4 PCS

UNFINISHED SURFACE

FINISHED SURFACE

TOOL REQUIRED

STEP 9

ASSEMBLED UNIT

5
NAIL LEG 4 PCS

TOOL REQUIRED

STEP 10

ASSEMBLED UNIT

TURN 180°

TOOL REQUIRED

STEP 11

ASSEMBLED UNIT

I
APRON PANEL 1 PC

1
LONG SCREW 2 PCS

TOOL REQUIRED

STEP 12

E
BOTTOM PANEL 1 PC

8
TOP CAP 2 PCS

9
LEG 2 PCS

FINISHED SURFACE

TOOL REQUIRED

STEP 15

ASSEMBLED UNIT

ASSEMBLED UNIT

TURN 180°

TOOL REQUIRED

STEP 16

ASSEMBLED UNIT

1
LONG SCREW 4 PCS

TOOL REQUIRED

STEP 13

D
UPPER TOP PANEL 1 PC

F
SHELF PANEL 1 PC

6
LONG POLE 1 PC

7
SHORT POLE 1 PC

UNFINISHED SURFACE

TOOL REQUIRED

STEP 14

ASSEMBLED UNIT

E
BOTTOM PANEL 1 PC

9
LEG 1 PC

UNFINISHED SURFACE

TOOL REQUIRED

Recommended Maximum Weight

*Unit in Pound(lbs.)

15

10

10

10

WARNING:

>This unit has been designed to support the maximum loads shown. Exceeding these load limits could cause sagging, instability, product collapse, and/or serious injury.

>DO NOT allow children to climb on unit.

> Put heavier items on lower shelves.