

# Assembly Instruction

Item# 316-8X

C - Table

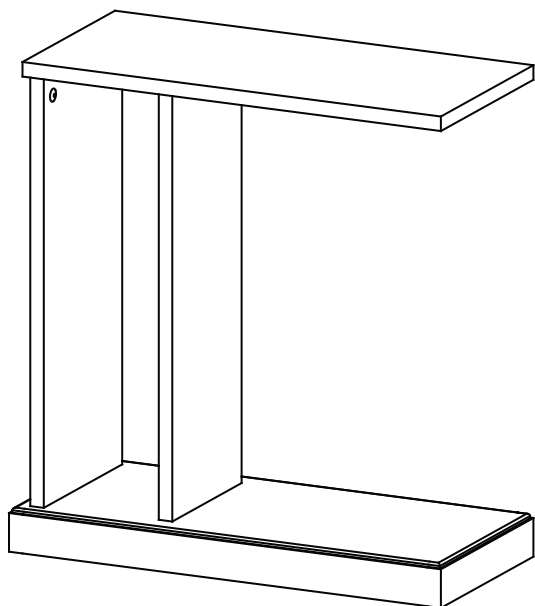

# Parts List

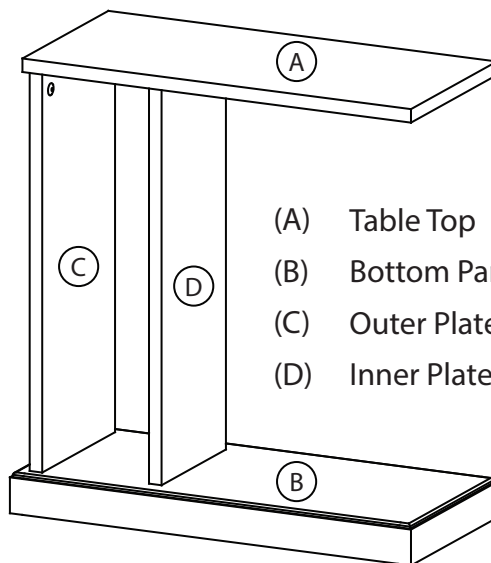

- |     |              |       |
|-----|--------------|-------|
| (A) | Table Top    | 1 Pc. |
| (B) | Bottom Panel | 1 Pc. |
| (C) | Outer Plate  | 1 Pc. |
| (D) | Inner Plate  | 1 Pc. |

## Hardware

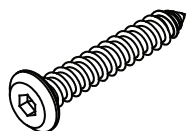

RF10020  
Screw JCA 1/4" x 38  
4 pcs.

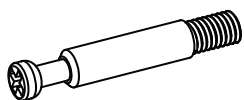

RF40084  
Connector Bolt  
4 pcs.

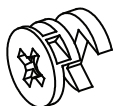

RF40083  
Connector  
4 pcs.

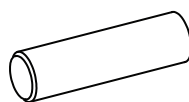

RF40018  
Wood Dowel  
4 pcs.



RF40081  
Plastic Cap  
4 pcs.



RF40103  
Allen Wrench  
4 pcs.

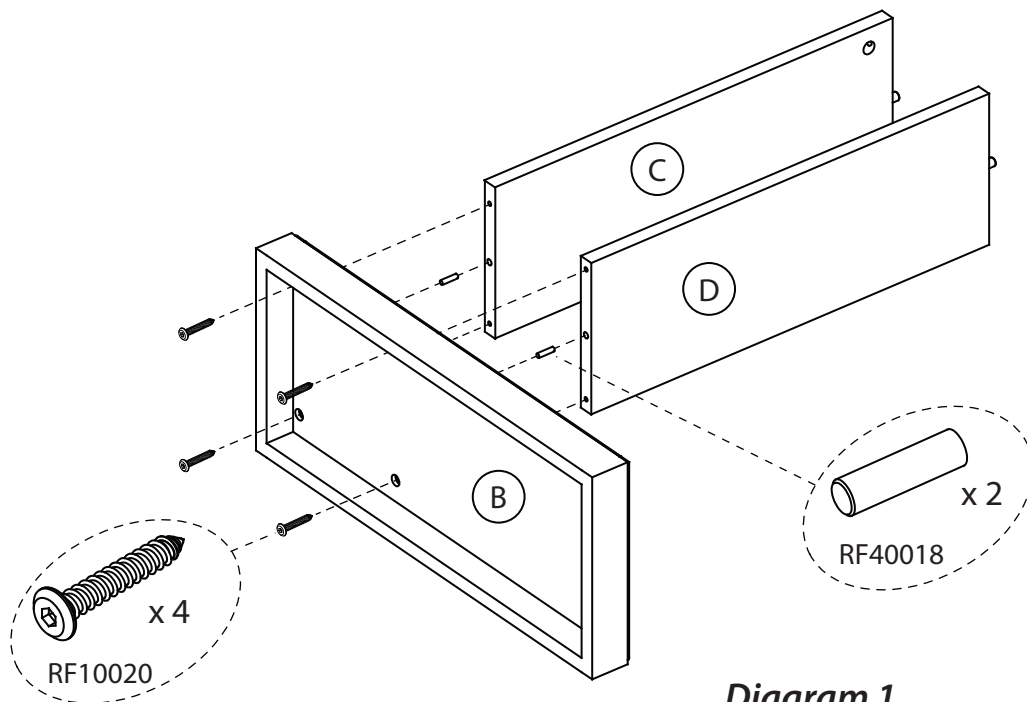

Diagram 1.

### Step 1:

Attach Outer Plate (C) and Inner Plate (D) into the Bottom Frame (B) using 4 Screw (RF10020) as per diag.1.

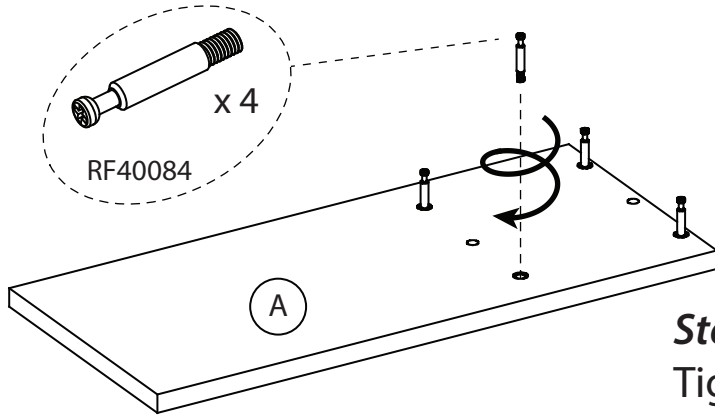

Diagram 2.

**Step 2:**  
Tighten Connector Bolt (RF40084)  
into the Table Top as per diag.2.

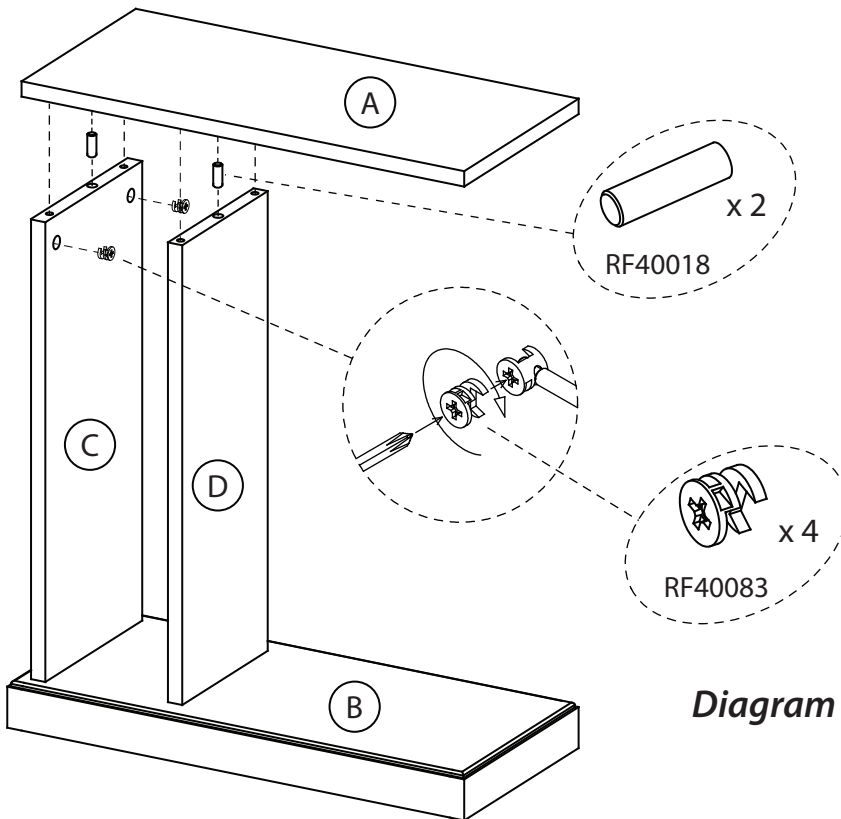

Diagram 3.

**Step 3:**  
Attach the Table Top (A) onto  
the unit using Connector (RF40083)  
as per diag.3.

**Step 4:**  
Cover the screw with Plastic Caps (RF40081)  
as per diag.4.

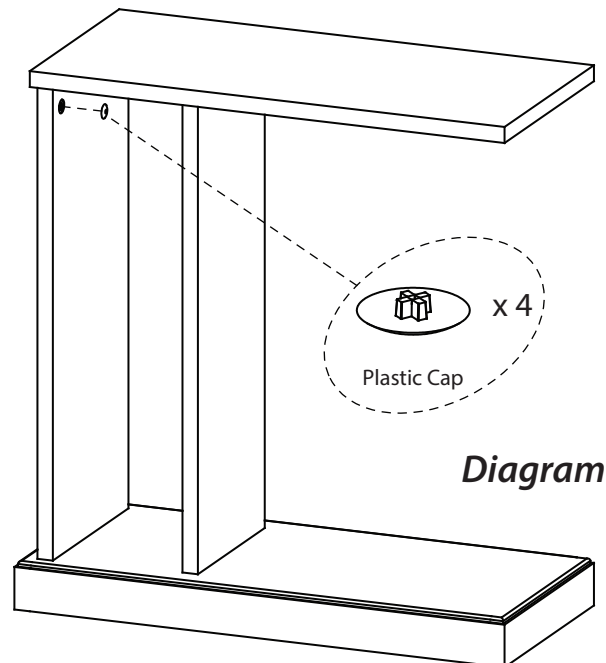

Diagram 4.