



WG4 SERIES

QUICK SETUP GUIDE

Home
& Business

SECURITY SYSTEMS

What's in the Box

Package Contents

**DISCLAIMER: The exact components of your product, images and quantities may vary depending on your model number.*

Wireless Gateway Model # WG-20W-4



1 x Gateway

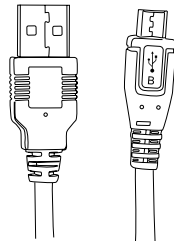

1 x 9.8 ft.
Gateway Power Cord

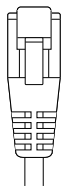

1 x 6 ft. RJ-45
Cable (Ethernet)



*1 x microSD Card
(May not be included)
***DISCLAIMER: User MUST
format the SD card if the
Gateway was purchased
without a pre-installed card.**

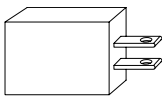

1 x Gateway
Power Supply



Bracket Mounting
Hardware

* Wireless IP Indoor Camera Model # WCM-SD2PIN

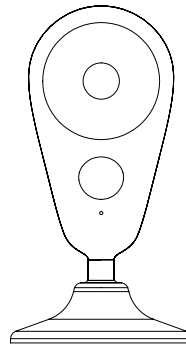

Camera

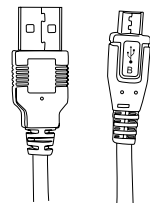

9.8 ft. Camera Power
Cord (1 per Camera)

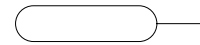

Reset Pin
(1 per Camera)

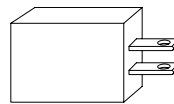

Camera Power Supply
(1 per Camera)

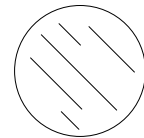

Adhesive Mounting
Tape (1 per Camera)

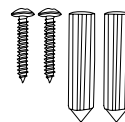

Bracket Mounting
Hardware (1 per Camera)

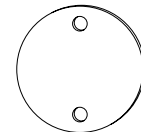

Magnetic Mounting
Bracket (1 per Camera)

* Wireless IP Indoor/Outdoor Camera Model # WCM-SD2POU-BU

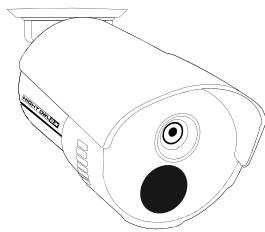

Camera



Camera Antenna
(1 per camera)

* If included, screw onto Camera



16.4 ft. Camera
Power Supply
(1 per Camera)

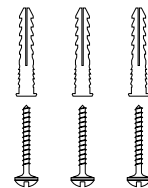

Bracket Mounting
Hardware
(1 per Camera)

Status Light Keys

Gateway Status Light Key

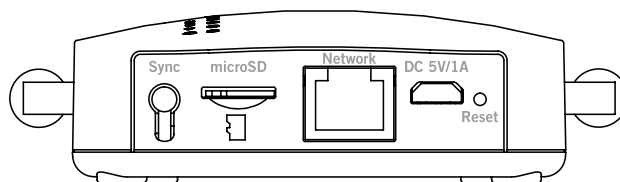
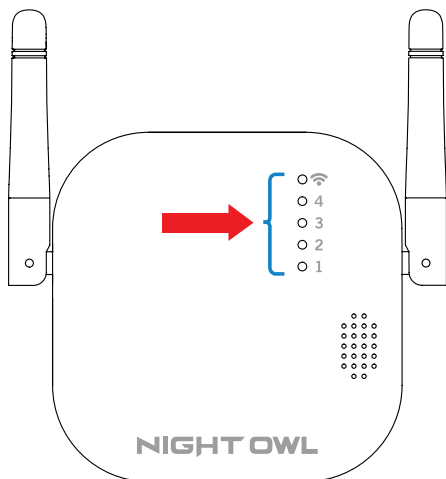

Check out my Rear

Channel LED Light is Solid – Camera is paired to a channel

Channel LED Light is Flashing – Camera is not paired to a channel

Wireless LED Light is Solid – Gateway is connected to the internet

Wireless LED Light is Flashing – Gateway is not connected to internet

Camera Status Light Key

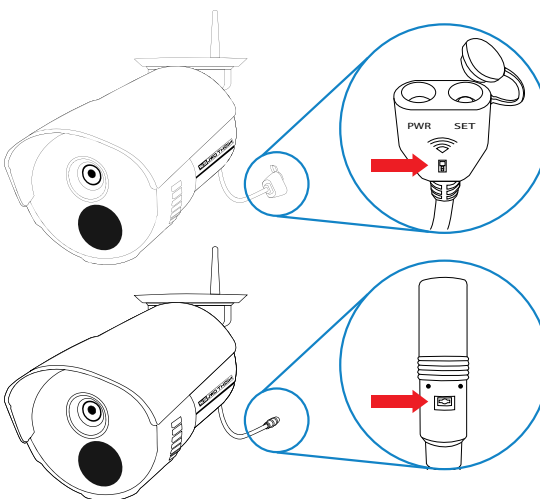
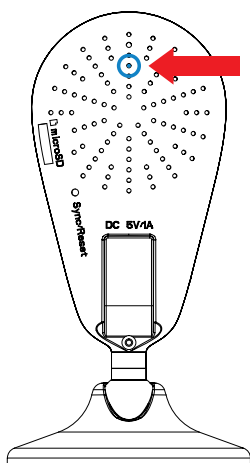

NOTE: Status Light location depends on camera version. Allow up to 2 minutes for the cameras to initiate. This is a perfect time to download the app!

Quickly Flashing – Pairing Mode (Default)

Slowly Flashing – Camera is not connected to the Gateway or Wi-Fi network

Solid Light – Camera is connected and functional

Connecting Your System

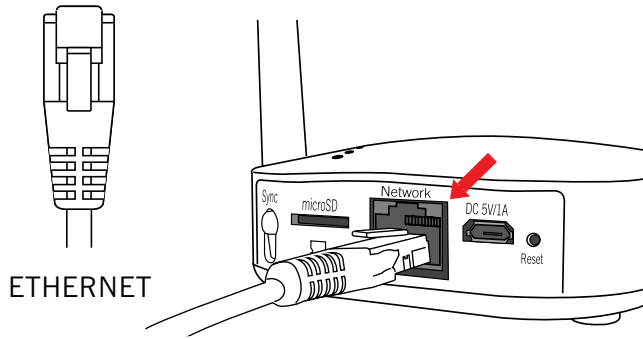

- 1 Plug one end of the included Ethernet cable into the Network port on the back of the Gateway.

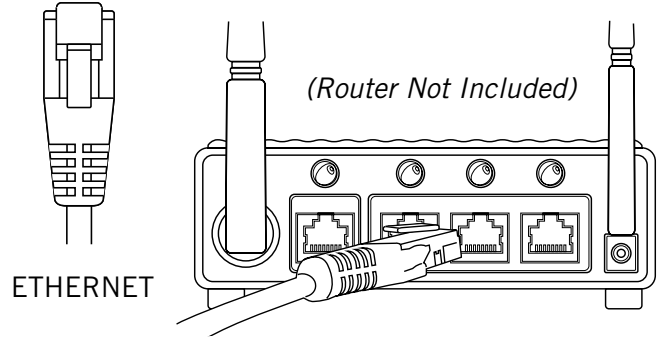

- 2 Plug the other end of the Ethernet cable into a port on the back of your router.

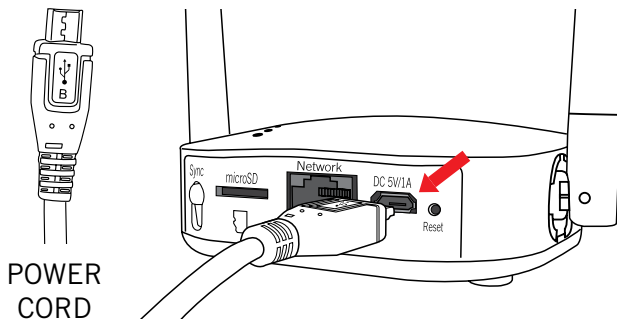

- 3 Connect the Gateway power cord to the Power Input on the rear of the Gateway.

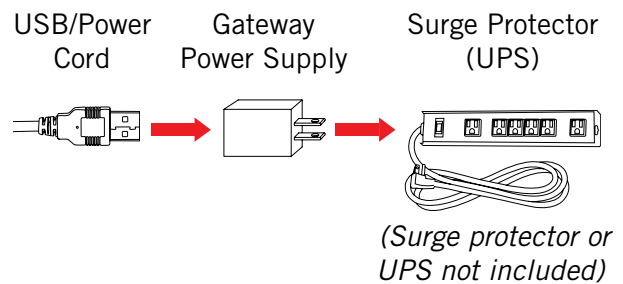

- 4 Plug the USB end of the Gateway power cord into the Gateway power supply. Plug the Gateway power supply into a surge protector or Uninterruptible Power Supply (UPS).

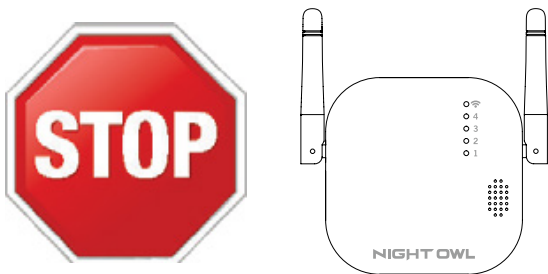

- 5 Relax for a moment as the Gateway initiates. Once the Gateway is connected to the internet and ready to be synced, move to step 6.

*** DISCLAIMER:** May not be included depending on the model # purchased.

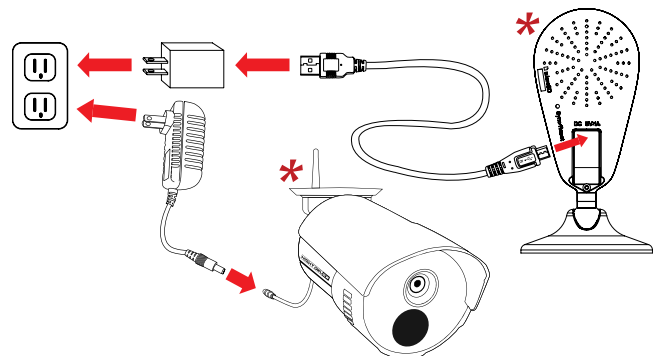

- 6 Power on each camera with its own power cord/supply.

NOTE: Allow up to 2 minutes for the cameras to initiate. This is the perfect time to download the app!

Using Night Owl Connect

Download and Install Application

- 1 Download the app from the *App Store* or *Google Play Store* and install the application on your device.

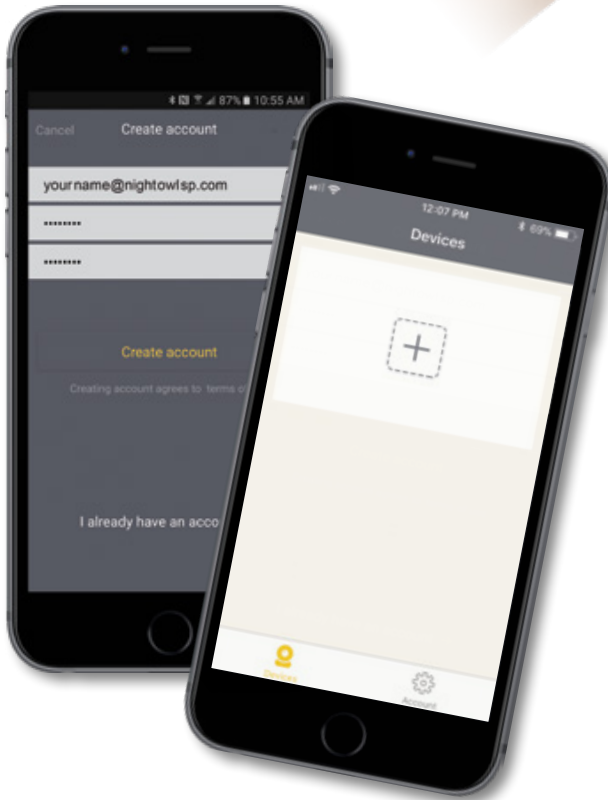
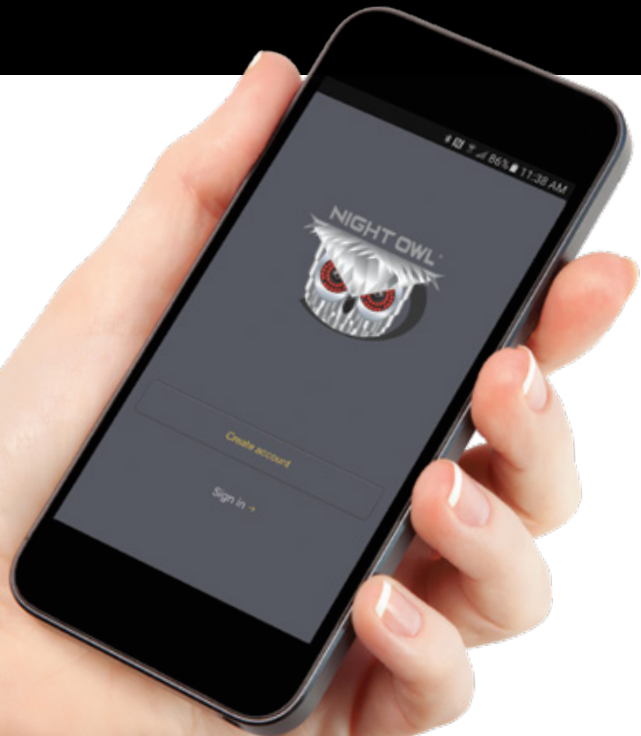

NOTE: Setup is the same for Smartphone and Tablet.

- 2 Create an account using an email address for the username and a password between 6–20 characters.
- 3 After completing the account setup and verification process, sign into the app and tap the "+" symbol to add a device.

The Night Owl Application will lead you through the rest of the setup process.

Quick Tips

Positioning Your Gateway

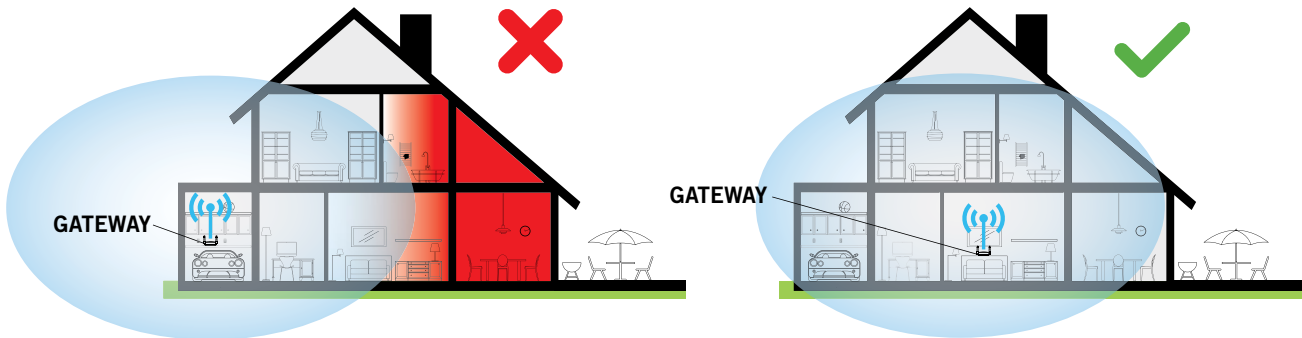

Proper placement of the Gateway ensures maximum coverage for your property.

- Place in a central location
- Mount cameras within 300 Ft of the Gateway
- Keep it close to your Router, if possible

Installing and Formatting Gateway SD Card

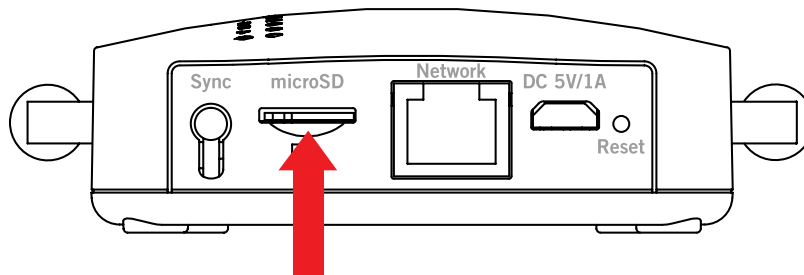

- 1 Insert microSD card into the Gateway's SD card slot.
(May not be included).
- 2 Open the app.
- 3 Open the live view.
- 4 Tap the settings icon.
- 5 Tap **"Format SD Card"**.

Troubleshooting

Camera(s) failed to pair to Gateway?

Insert the reset pin into the Sync/Reset hole **A** or press and hold the reset button **B** until you hear the camera say *“Please be patient. Camera is resetting.”* Once the camera resets, you will hear *“Camera is in pairing mode”* and the Status light will flash quickly.

NOTE: Reset one camera at a time.

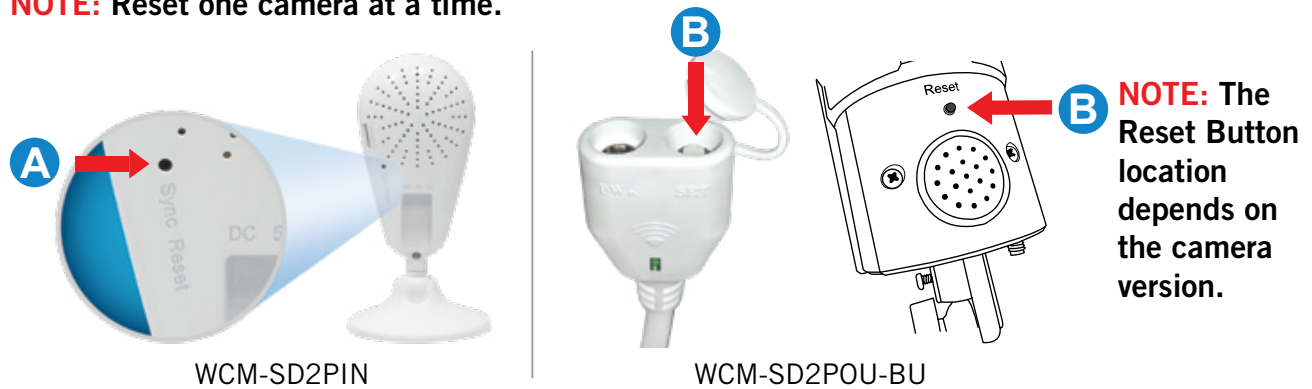

Once the Camera is in Pairing Mode, Press the Sync Button on the Gateway.

Sync to other Night Owl Devices

To sync the Gateway to a device, press and hold the sync button until the voice prompt says, *“I am pairing to the Night Owl device, please be patient.”* If the synchronization fails, make sure the Night Owl device the Gateway is searching for is in pairing mode and try again.

NOTE: The Gateway and the Night Owl device **MUST** be on the same Network. Before pairing, we recommend that you put the Night Owl device within 9ft from the Gateway.

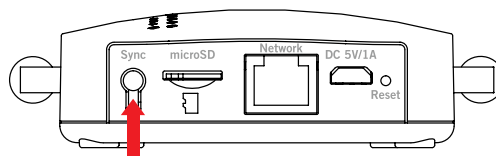

Resetting the Gateway

To reset the Gateway to the factory default settings, insert the reset pin into the reset hole for 10 seconds.

CAUTION!



Resetting the Gateway to its factory default settings removes all connected devices from the Gateway. Seriously, this should be a last resort.

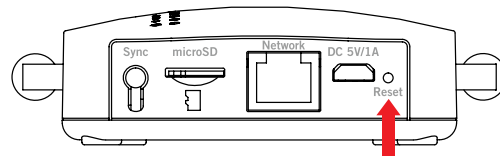



CONTACT US

PHONE (English, Spanish & French)

Sales/Technical Support

1.866.390.1303

Live Chat 24/7, 365 days a year

EMAIL

Sales Support

Sales@NightOwlISP.com

Technical Support

Support@NightOwlISP.com

WEBSITE

24/7 Product Support

- How-To Videos
- Manuals

Need Help?

For system manuals, troubleshooting guides, FAQs, video tutorials and more:

Please refer to the sticker located on the bottom of the device for steps on how to access your product's support material.

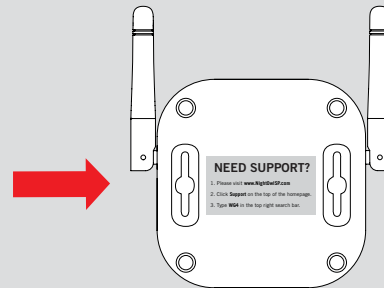

www.NightOwlISP.com



YouTube

iPhone, iPad, Mac and Mac OS X are registered trademarks of Apple Inc. Windows, Windows XP, Windows Vista, Windows 7, Windows 8 and Windows 10 are registered trademarks of Microsoft Corporation in the United States and/or other countries.

FCC RADIATION NORM

FCC

This device complies with Part 15 of the FCC Rules. Operation is subject to the following two conditions: (1) this device may not cause harmful interference, and (2) this device must accept any interference received, including interference that may cause undesired operation.

FCC Compliance Statement

These limits are designed to provide reasonable protection against frequency interference in residential installation. This equipment generates, uses, and can radiate radio frequency energy, and if not installed or used in accordance with the instructions, may cause harmful interference to radio communication. However, there is no guarantee that interference will not occur in television reception, which can be determined by turning the equipment off and on. The user is encouraged to try and correct the interference by one or more of the following measures:

- Reorient or relocate the receiving antenna.
- Increase the separation between the equipment and the receiver.
- Connect the equipment into an outlet on a circuit different from that to which the receiver is connected.
- Consult the dealer or an experienced radio/TV technician for help.

CAUTION!

The Federal Communications Commission warns the user that changes or modifications to the unit not expressly approved by the party responsible for compliance could void the user's authority to operate the equipment.

This equipment should be installed and operated with a minimum distance of 8 inches between the radiator and your body.

Rev 180403