

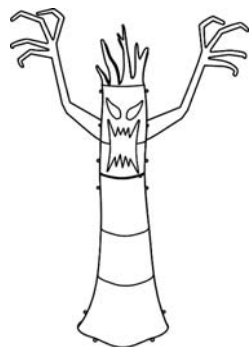

SKU # 1002 369 900
YOW SKU # 760 927
Model # TY116-1724-1

USE AND CARE GUIDE

72 in 120 Light LED Animated Tinsel Ghost Tree



THANK YOU

We appreciate the trust and confidence you have placed in Home Accents through the purchase of this 72 in 120 Light LED Animated Tinsel Ghost Tree. We strive to continually create quality products designed to enhance your home. Visit us online to see our full line of products available for your home improvement needs. Thank you for choosing Home Accents!

Guarantee

What is Covered

The product is intended for residential seasonal use for approximately 90 days per year. This product is covered by a 90 days limited guarantee due to defects in material and workmanship. Return the product with purchase receipts to the location of purchase for refund within 90 days of purchase

What is Not Covered

This warranty does not cover commercial use, normal wear and tear, products not used in accordance with directions provided on or with the product, burn out of bulbs or LEDs, batteries, products that have been subjected to unauthorized repair and/or modification and damage caused by shipping and improper handling, alterations, misuse or accidents. Questions, problems, missing parts? Before returning to the store, call Home Accents Holiday Customer Service 8 a.m.-6 p.m., EST, Monday-Friday

1-877-527-0313

HOMEACCENTSHOLIDAY.COM

Pre-Assembly

PLANNING ASSEMBLY

Carefully remove all the parts from the box and read the entire manual prior to assembly and identify all the parts in the package against the parts list. Many parts are connected to each other by the lighting string. Take care when handling. If any parts are missing or damaged do not attempt assembly. Contact our customer service center or return to place of purchase with purchase receipt. Assembly of this product may require more than one person.

PACKAGE CONTENTS

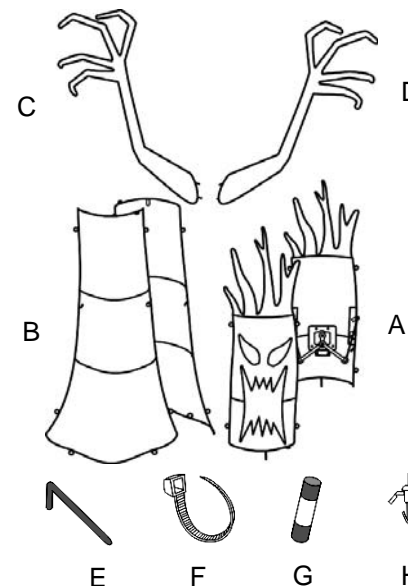

Package Contents/Parts List		
Part	Description	Quantity
A	Upper section Halves of Tree	2
B	Lower section Halves of Tree	2
C	Left Arm/Hand	1

Package Contents/Parts List		
Part	Description	Quantity
D	Right Arm/Hand	1
E	Ground Stakes	4
F	Plastic Ties	10
G	Spare Fuse	1
H	Spare Bulb	3

Assembly

Assembling the Tinsel Ghost Tree

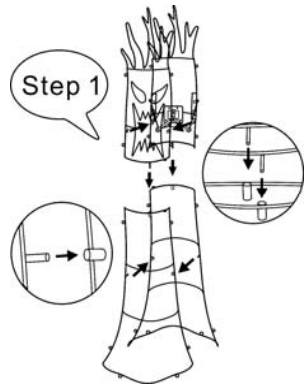

FIG.1

Step 1. Insert the the connecting rods on one half of the Upper Section of Tree (A) and Lower Section of Tree (B) into the matching holes in the other half then fasten together with the Plastic Ties (F). (FIG.1)

Step 2. Insert the rods at the bottom of the Upper Section (A) into the holes at the top of the Lower Section (B) of Tree and fasten with Plastic Ties (F). (FIG.2)

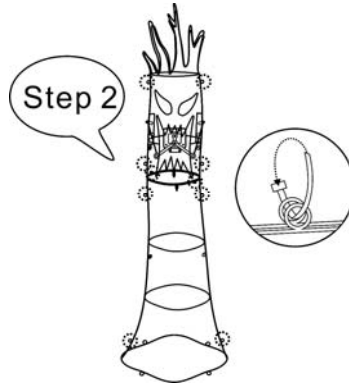

FIG.2

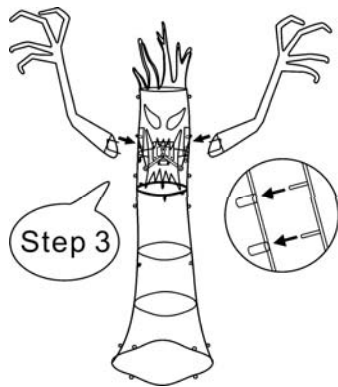

FIG.3

Step 3. Insert the the connecting rods on each Arm/Hand (C.D) into the Upper Section of Tree (A). (FIG.3)

Step 4. Secure the Ghost Tree to the ground by inserting the Ground Stakes (E) at base. (FIG.4)

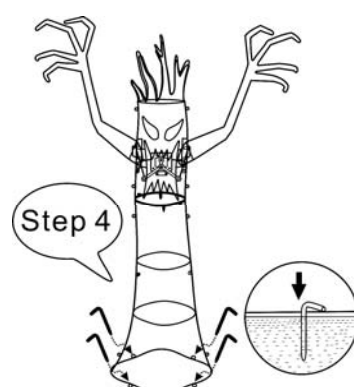

FIG.4

Pre-Operation

CAUTION: Grasp the plug to insert or remove from the power source. Do not unplug by pulling on cord.

CAUTION: The lighting string on this product is rated at 12 Watts (0.1Amps). Do not overload. Do not connect to another lighting string, decorative outfit or other electrical product. Before you use or re-use this product inspect it carefully. Return to place of purchase with purchase receipt. if the product has cuts, damage, frayed wire insulation on cords, cracks in the socket enclosures, loose connections or exposed copper wire.

Care and Cleaning

- Carefully remove the product from wherever it is placed. This helps to avoid any undue strain or stress on the product conductors, connections, and wires. If the product is placed somewhere other than the ground it should be well secured and stable.
- Wipe the product with a damp cloth and allow the product to dry before storing.
- Store the product neatly in a cool, dry location protected from sunlight.

FOR INDOOR AND OUTDOOR USE