



Furniture of America®

Assembly Instructions

For more information contact our team: service.ec@foagroup.com

CM3139MC-2PK

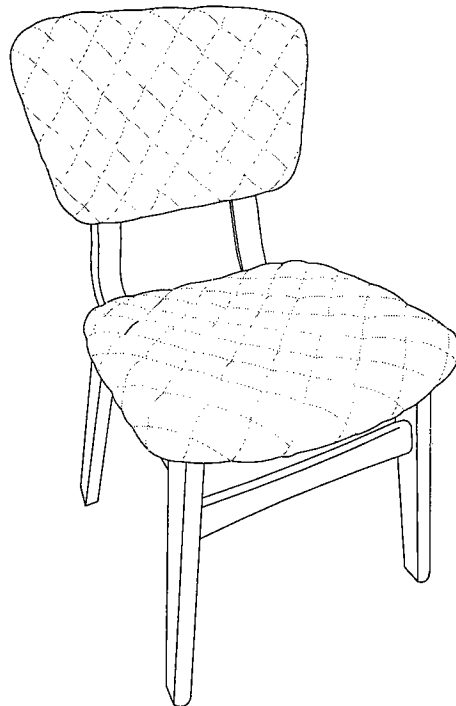

ASSEMBLY RATING

The Assembly Rating is a 5-point system that shows the degree of effort needed in assembling a specific product (with 1 being easy and 5 being difficult). For some products, two persons are recommended.

EASY



DIFFICULT

Tools Required For Assembly:

Allen Wrench

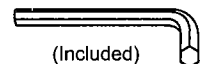

(Included)

Phillips Screwdriver



(Not Included)

Rubber Mallet



(Not Included)



2 PERSONS RECOMMENDED

ASSEMBLY & CARE ADVICE

FOR YOUR FURNITURE TO LAST, CORRECT ASSEMBLY AND PROPER MAINTENANCE ARE NECESSARY.
PLEASE FOLLOW THE INFORMATION PROVIDED BELOW TO FULLY ENJOY YOUR FURNITURE.

BASIC ASSEMBLY TECHNIQUES

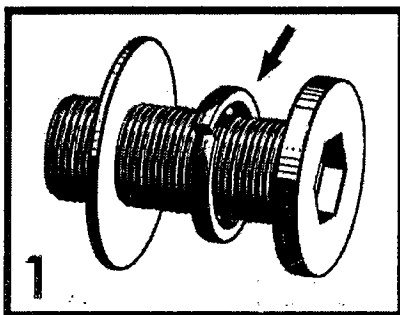

1
When lock or spring washer is used in an assembly, please make sure the lock or spring washer is placed between the larger flat washer and the head of the screw or bolt.

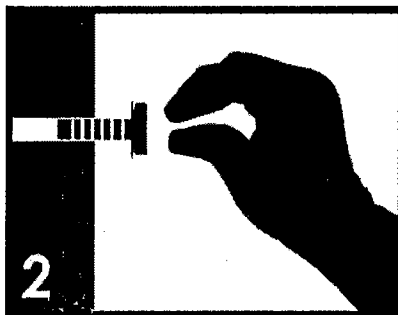

2
Position each part correctly and insert screws or bolts into their respective holes by hand tighten or using the proper hand tool. Only tighten when step is completed or when instructed to do so.

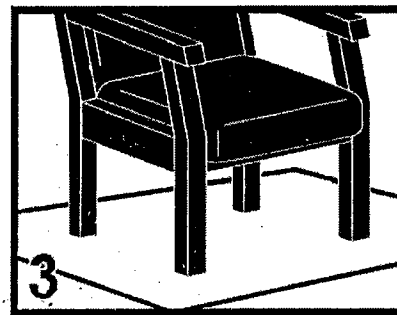

3
Use cardboard or carpet area when assembling furniture to prevent scratches. Make sure the furniture rests on a flat and level surface with each leg evenly touching the floor. No dragging of products/parts.

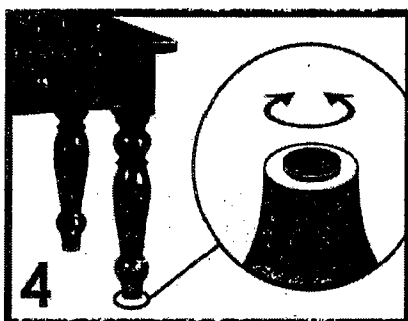

4
Some furniture comes with height adjustment knobs underneath each leg. To lower or to raise each leg, you need to turn clockwise or counterclockwise, respectively.

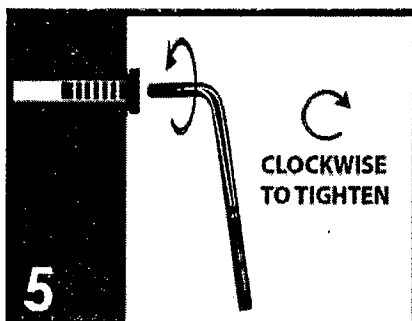

5
Make sure all parts are properly aligned, then use the appropriate hand tool to completely tighten the bolts or screws. Do not use power tools and do not overtighten.

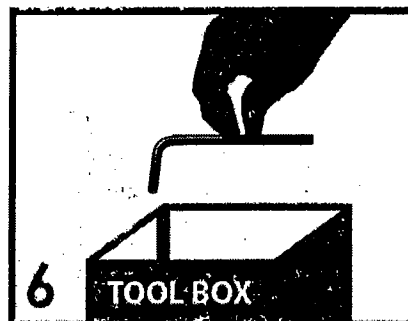

6
Save the instructions and store the Allen wrench or any supplied tool for later maintenance. After two weeks, check and tighten any loose hardware and repeat again every six months thereafter.

IT IS THE USER'S RESPONSIBILITY TO MAINTAIN THE FURNITURE. THE HARDWARE MAY LOOSEN OVER TIME AND MAY CAUSE THE FURNITURE TO BE WOBBLY AND UNABLE TO SUPPORT ITS INTENDED WEIGHT CAPACITY. THIS MAY LEAD TO COLLAPSE AND MAY CAUSE SERIOUS INJURY.



**FAILURE TO FOLLOW THE GUIDELINES ABOVE MAY
RESULT IN INJURY AND/OR PROPERTY DAMAGE.**

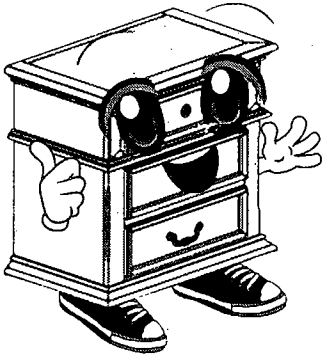

Before you begin, please read Page 2 of "Assembly and Care-Advice".

And remember, do not tighten until each step is completed or instructed.

Parts List

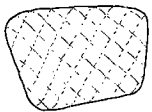

#1 x 1pc
Back Rest



#2 x 1pc
Seater

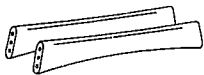

#3 x 2pcs
Rail Support

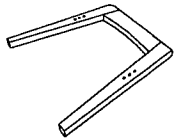

#4 x (L)1pc, (R)1pc
Leg



#5 x 2pcs
Back Support



#J x 10pcs
PVC Dowel M8x30mm



#K x 4pcs
CSK Screw M4 x 25mm



#L x 4pcs
Wood Button

Hardware List



#A x 1pc
Allen Wrench M4

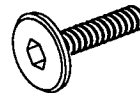

#B x 4pcs
Bolt M6 x 30mm

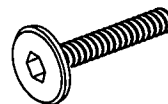

#C x 4pcs
Bolt M6 x 50mm



#D x 4pcs
Lock Washer M6



#E x 4pcs
Nylon Washer M6



#F x 1pc
Allen Wrench M5



#G x 4pcs
Bolt M8 x 35mm



#H x 4pcs
Spring Washer M8



#I x 4pcs
Flat Washer M8



#1

J x 10 pcs

1. Carefully place the leg (#4) onto a protected surface.

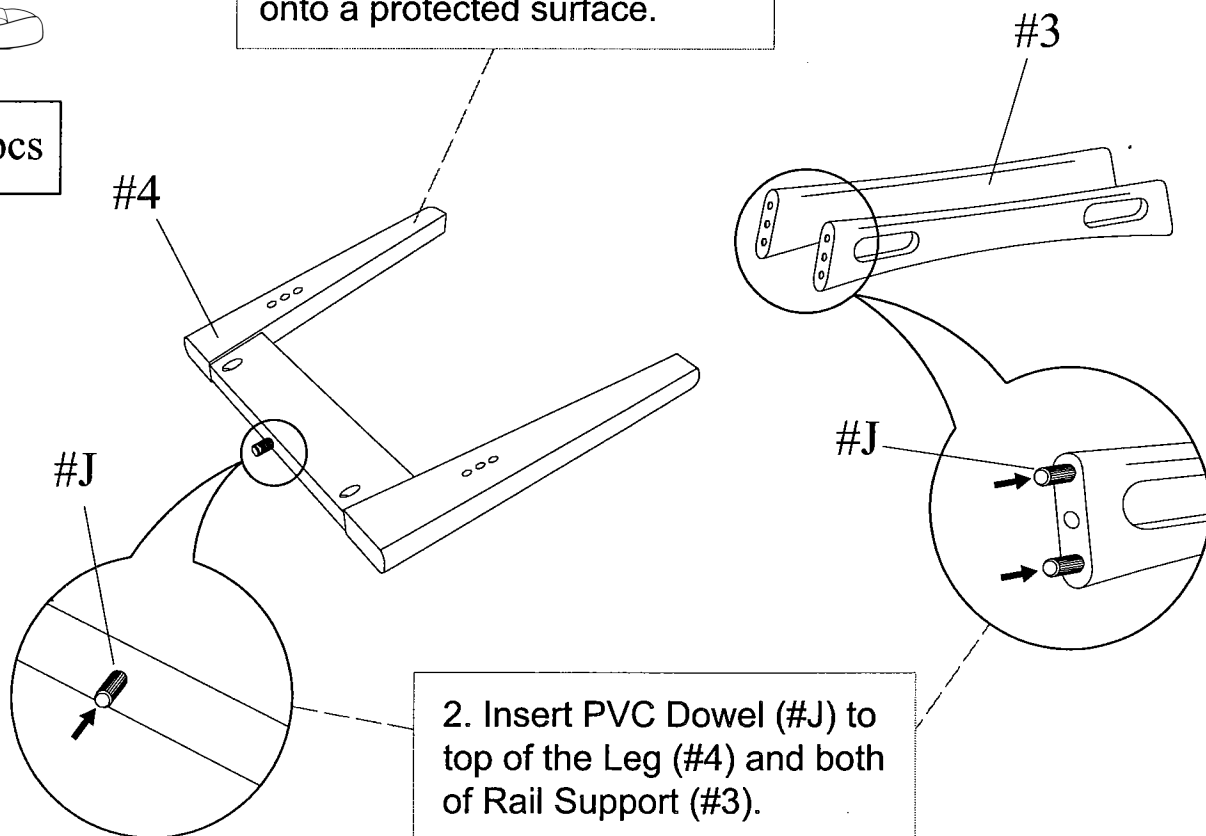

2. Insert PVC Dowel (#J) to top of the Leg (#4) and both of Rail Support (#3).



#2

C x 4 pcs
E x 4 pcs

CAUTION

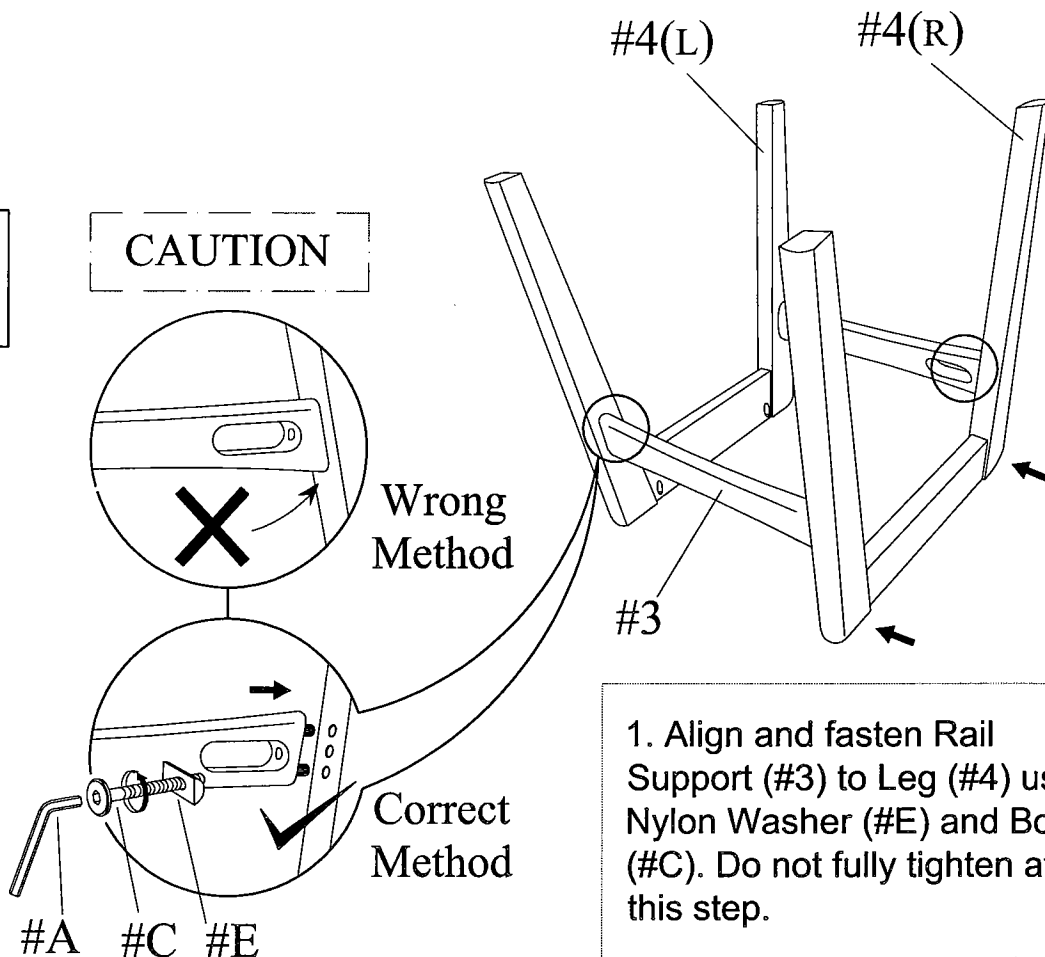

1. Align and fasten Rail Support (#3) to Leg (#4) using Nylon Washer (#E) and Bolt (#C). Do not fully tighten at this step.



#3

K x 4 pcs

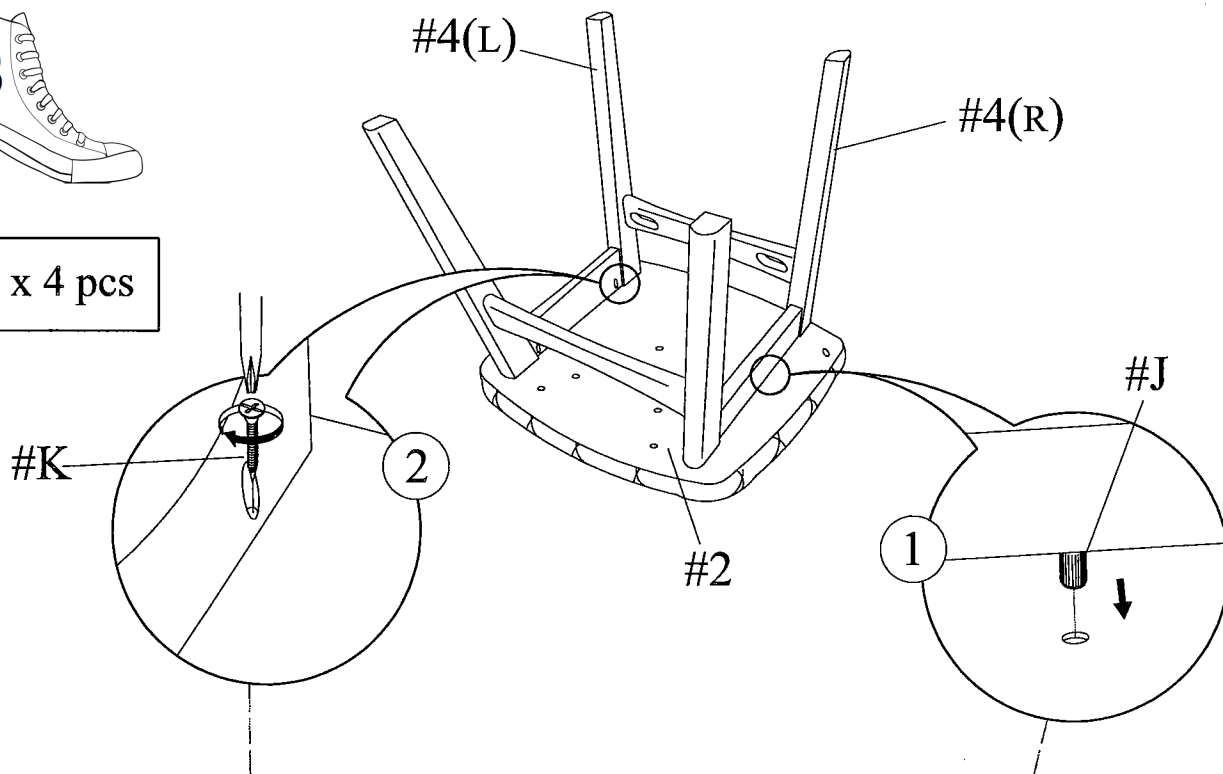

2. Align and fasten the Leg (#4) to Seater (#2) by using the CSK Screw (#K) and fully tighten with screwdriver (NOT INCLUDED)

1. Align and insert PVC Dowel (#J) to bottom of Seater(#2).



#4

G x 4 pcs
H x 4 pcs
I x 4 pcs

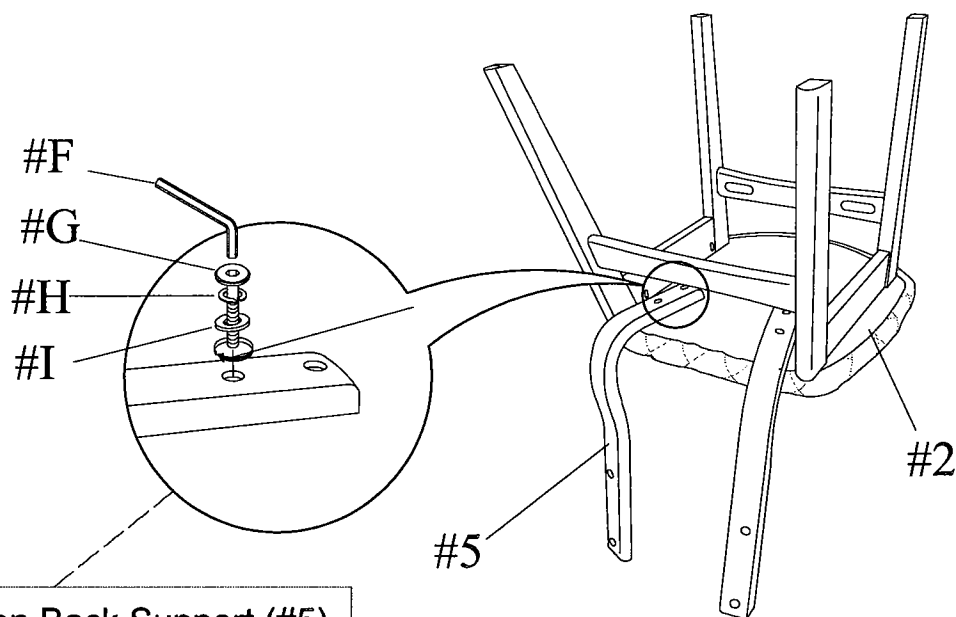

1. Align and fasten Back Support (#5) to Seater (#2) using Bolt (#G) and Lock Washer (#H) and Flat Washer (#I) and do not fully tighten with Allen Wrench (#F).



#5

B x 4 pcs
D x 4 pcs
L x 4 pcs

1. Align and fasten Back Rest (#1) to Back Support (#5) using Bolt (#B) and Lock Washer (#D) and fully tighten with Allen Wrench (#A). Insert Wood Button (#L) to cover the open hole of the Back Support (#5) and light tap with rubber mallet (NOT INCLUDED) .

Fully tighten all the bolt.

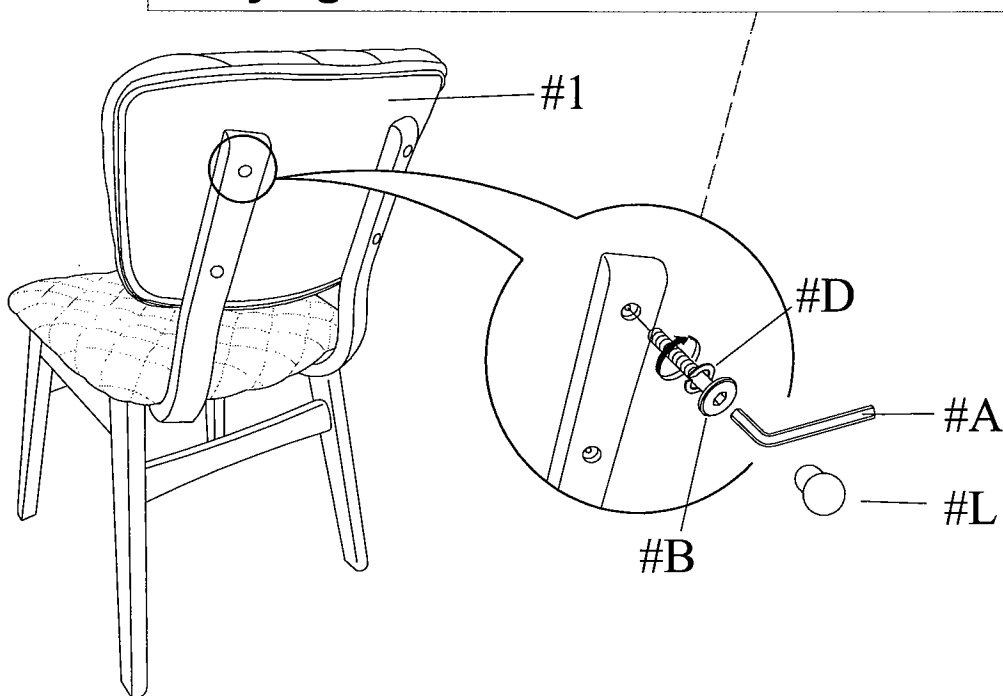

#6

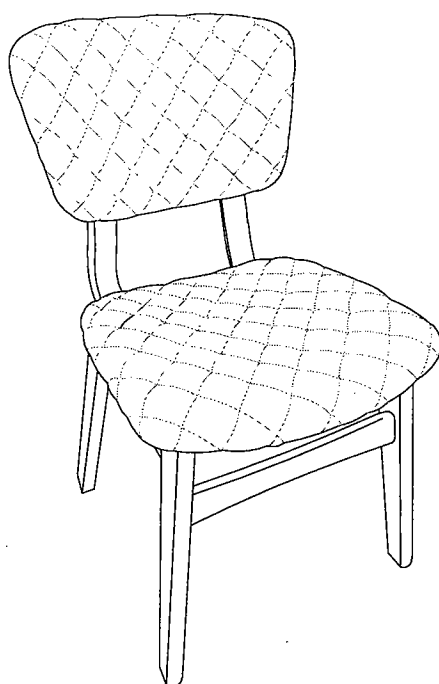

x 2 pcs

ASSEMBLY IS COMPLETED