

### IMPORTANT SAFEGUARDS

When using electrical equipment, basic safety precautions should always be followed including the following:

### READ AND FOLLOW ALL SAFETY INSTRUCTIONS

- DANGER**- Risk of shock- Disconnect power before installation.
- This luminaire must be installed in accordance with the NEC or your local electrical code. If you are not familiar with these codes and requirements, consult a qualified electrician.
- WARNING**: Not intended for use with emergency exit fixtures or emergency exit lights. Not for use where exposed directly to the weather or water. Not for use in totally enclosed recessed fixtures
- WARNING**: Risk of Fire or Electric Shock. Install this product only in the applications that have the construction features and dimensions shown in the photographs and/or drawings.
- DO NOT make or alter any open holes in an enclosure of wiring or electrical components during kit installation.
- To prevent wiring damage or abrasion, do not expose wiring to edges of sheet metal or other sharp objects.
- WARNING**: Risk of Fire or Electric Shock. Install this kit only in luminaires where the input ratings of the kit does not exceed the input ratings of the luminaire.
- CAUTION**: Any changes or modifications not expressly approved by the party responsible for compliance could void the user's authority to operate the equipment.
- CAUTION**: Risk of electrical shock. Do not open. There are no user serviceable parts inside. Turn the power on before inspection, installation, or removal. The lamp is suitable for use in wet locations. Use only on 120 VAC, 60 Hz circuits.
- IMPORTANT**: Each light shall be installed only in its intended manner and orientation. Not all existing recessed cans that meet these requirements will be compatible with the Cree Disk Light.

### INSTALLATION INSTRUCTIONS

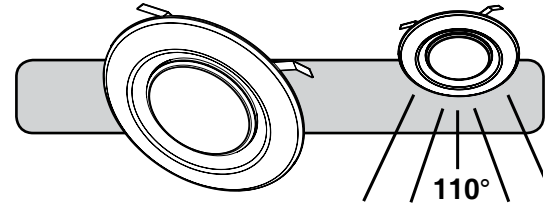

### PACKAGE CONTENTS

- |                              |  |
|------------------------------|--|
| 1- 6 in. or 4 in. disk light | 1- Disk light mounting bracket         |
| 1- Edison socket adapter     | 2- 8-18 x 1/2 in. Thread forming screw |
| 1- Base wire adapter         | 2- 8-32 x 1 in. Machine screw          |
| 1- Flip-clip mount           | 1- Ground clip                         |
| 3- Wire nut                  |  |
| 1- Lens removal tool         |  |

### SAVE THESE INSTRUCTIONS FOR FUTURE REFERENCE

### PRE-INSTALLATION

This 6 in. or 4 in. disk light can be used in general lighting for residential and commercial spaces in ceiling lighting. The LED retrofit is designed to install in either a standard 6 in. or 4 in. recessed can, or surface mounted onto a 4 in. junction box. To prepare for a junction box installation, refer to the chart below to determine if the disk light mounting bracket is required.

Junction Box Type	4 in. Light	6 in. Light
Square	Install bracket	Install bracket
Octagonal	Install bracket	Bracket not required
Round	Bracket not required	Bracket not required

### COMPATIBILITY

#### RECESSED HOUSING AND DIMMER COMPATIBILITY

- The Cree LED Disk Light is designed to install in either a standard 6" or 4" recessed can or surface mounted onto a 4" junction box.
- Compatible with most dimmers when used with multiple fixtures. Consult [www.creebulb.com/dimmers](http://www.creebulb.com/dimmers) for a compatibility chart.

### ELECTRICAL RATINGS

Model	Input Volts (Vac)	Input Frequency (Hz)	Input Watts (W)
TDS4-0602700FH50-12DDWRE-1-11	120	60	9
TDS6-0652700FH50-12DDWRE-1-11	120	60	10.5

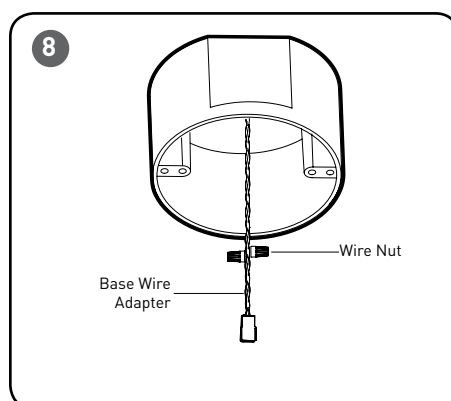
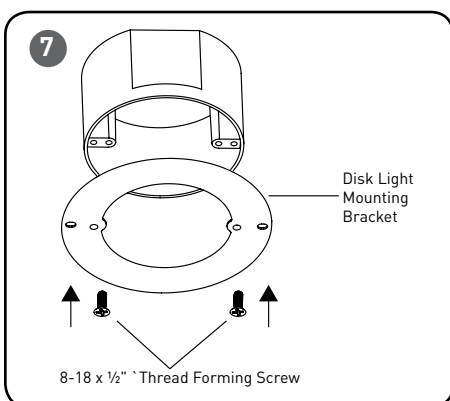
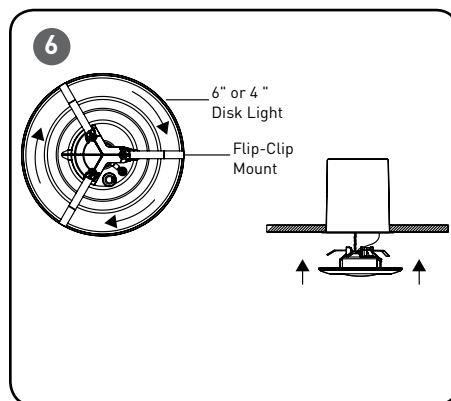
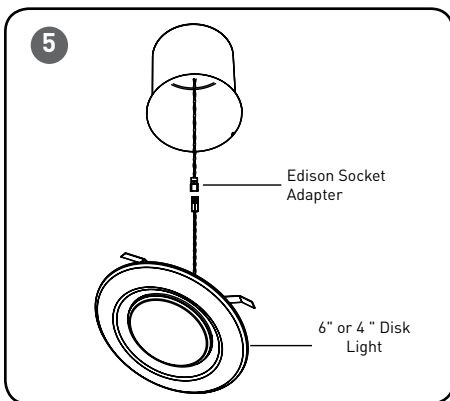
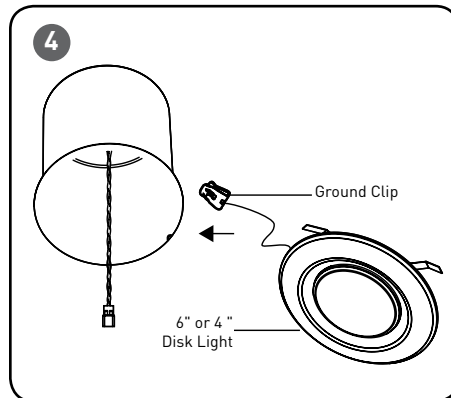
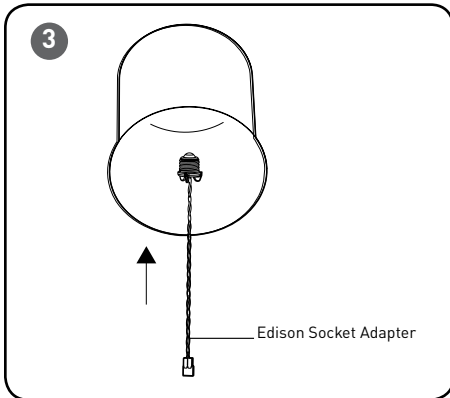
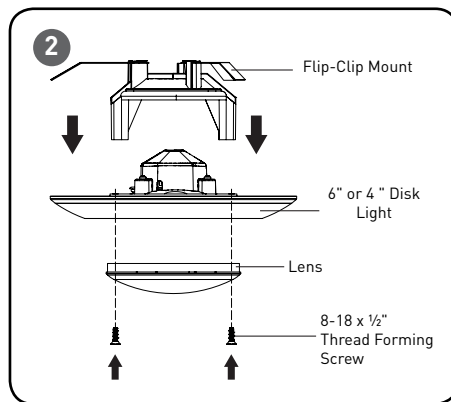
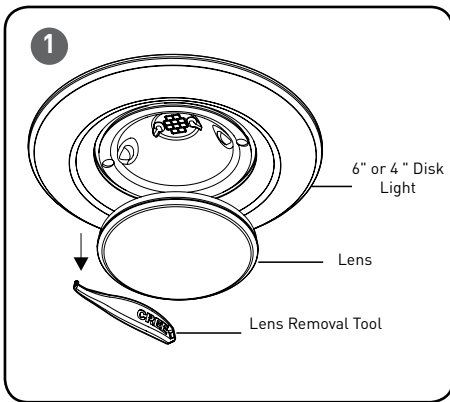

## RECESSED CAN INSTALLATION

### STEP 1:

Remove the lens from the disk light with the lens removal tool, by working the tool around the opening. See **Figure 1**.

### STEP 2:

Firmly attach the flip-clip mount to the disk light by aligning the grooves in the disk light with the flip-clip mount and attach with the two 8-18 x 1/2" thread forming screws. See **Figure 2**.

### STEP 3:

Reattach the lens to the disk light by snapping it back into place. See **Figure 2**.

### STEP 4:

Attaching the socket adapter by reaching inside the existing recessed can, and screw the Edison socket adapter into the female Edison socket. See **Figure 3**.

### STEP 5:

Insert the bare end of the grounding wire coming off of the disk light into the ground clip and attach to the edge of the recessed can. See **Figure 4**.

### STEP 6:

Connecting the light to the socket adapter. Connect the orange female connector from the disk light to the orange male connector that extends from the end of the Edison socket adapter. See **Figure 5**.

### STEP 7:

Install the light into the ceiling by rotating the flip clips on the mount clockwise until the clips are oriented directly away from the fixture. This position is the "installation ready" position. See **Figure 6**.

### STEP 8:

Slide the disk light, with the flip-clips in fully-deployed position, up into the recessed can firmly until the trim ring on the disk light is flush with the ceiling. See **Figure 6**.

## JUNCTION BOX INSTALLATION

### STEP 1:

If required, according to the chart in the Planning Installation section, install the disk light mounting bracket onto the junction box with the two 8-32 x 1" machine screws. See **Figure 7**.

### STEP 2:

On the junction box, you will need to make two pigtail connections. Connect the black junction box wire (hot wire) to the black pigtail wire of the base wire adapter using one of the provided wire nuts. See **Figure 8**.

### STEP 3:

Connect the white junction box wire (neutral wire) to the white pigtail wire of the bare wire adapter using one of the provided wire nuts. See **Figure 8**.

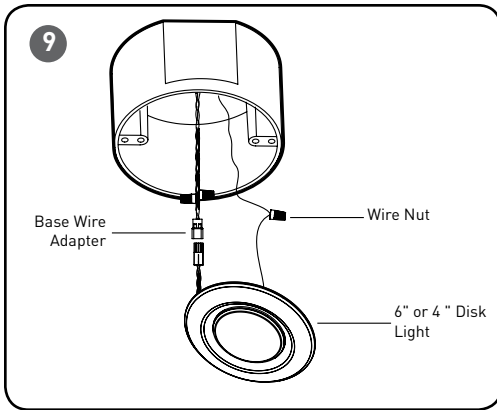

**STEP 4:**

Connect the ground wire from the disk light to the ground wire in the junction box using one of the provided wire nuts.

Connect the orange female connector from the disk light to the orange male connector that extends from the base wire adapter. See **Figure 9**.

**STEP 5:**

Remove the lens from the light by detaching the lens with the lens removal tool. See **Figure 1**.

**STEP 6:**

Using the two 8-18 x 1/2" thread forming screws, attach the disk light to the junction box or to the mounting bracket if you installed one. Ensure the trim ring on the light is flush with the ceiling. See **Figure 10**.

**STEP 7:**

Reattach the lens to the disk light by snapping it back into place.

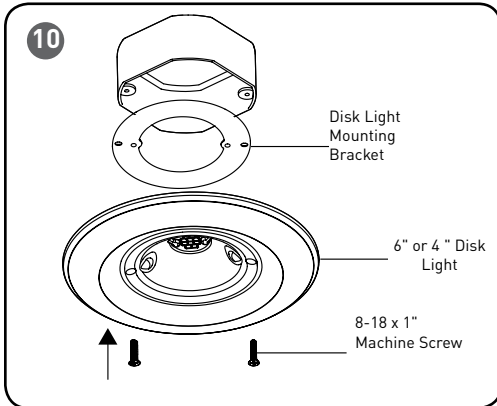

**MAINTENANCE**

**REMOVING THE LED DISK LIGHT FROM A RECESSED CAN**

**STEP 1:**

Grip firmly on the trim ring and rotate 1/4 turn counterclockwise to unlock the clips from the recessed can.

**STEP 2:**

Continue to turn counterclockwise as you pull downward on the disk light. This will disengage the flip-clips allowing the disk light (A) to pull free.

**STEP 3:**

Detach the disk light from the recessed can socket.

**FCC NOTICE**

**CAUTION:** Changes or modifications not expressly approved could void your authority to use this equipment.

This device complies with part 15 of the FCC Rules. Operation is subject to the following two conditions: (1) This device may not cause harmful interference, and (2) this device must accept any interference received, including interference that may cause undesired operation.

Changes or modifications not expressly approved could void your authority to use this equipment.

This equipment has been tested and found to comply with the limits for a Class B digital device, pursuant to part 15 of the FCC Rules. These limits are designed to provide reasonable protection against harmful interference in a residential installation. This equipment generates, uses and can radiate radio frequency energy and, if not installed and used in accordance with the instructions, may cause harmful interference to radio communications. However, there is no guarantee that interference will not occur in a particular installation. If this equipment does cause harmful interference to radio or television reception, which can be determined by turning the equipment off and on, the user is encouraged to try to correct the interference by one or more of the following measures:

- Reorient or relocate the receiving antenna.
- Increase the separation between the equipment and receiver.
- Connect the equipment into an outlet on a circuit different from that to which the receiver is connected.
- Consult the dealer or an experienced radio/TV technician for help.

CAN ICES-005 (B)/NMB-005 (B)

In compliance with CA Proposition 65, note that this product contains a chemical known to the state of California to cause cancer, birth defects or other reproductive harm.

**WARRANTY**

**100% SATISFACTION GUARANTEE:** This product is guaranteed to give 100% performance satisfaction subject to the Cree limited warranty, the terms of which can be found at [creebulb.com/warranty](http://creebulb.com/warranty). If within 10 years from the date of purchase you are not completely satisfied with the performance of this product, please contact Cree for replacement instructions.

© 2018 Cree, Inc. All rights reserved. For informational purposes only. Content is subject to change. See [creebulb.com/warranty](http://creebulb.com/warranty) for warranty and specifications. Cree® is a registered trademark, and the Cree logo is a trademark of Cree, Inc.

