

# Specifications



## Certifications



**VBV-CPV-E3PA**  
**VBV-CPV-E4PA**  
**VBV-CPV-E5PA**  
**VBV-CPV-E3B**  
**VBV-CPV-E4B**  
**VBV-CPV-E5B**

### Physical Characteristics

- Description: Ball Valve – CPVC
- Connection Type: Solvent x Solvent
- Teflon seats and EPDM O-rings
- For use with tubing size pipe
- Handle Color: Yellow
- Max. Temp. Rating: 180° F
- Max. Pressure Rating: 100 PSI
- Meets ANSI/NSF standard 14 for plastic piping system components

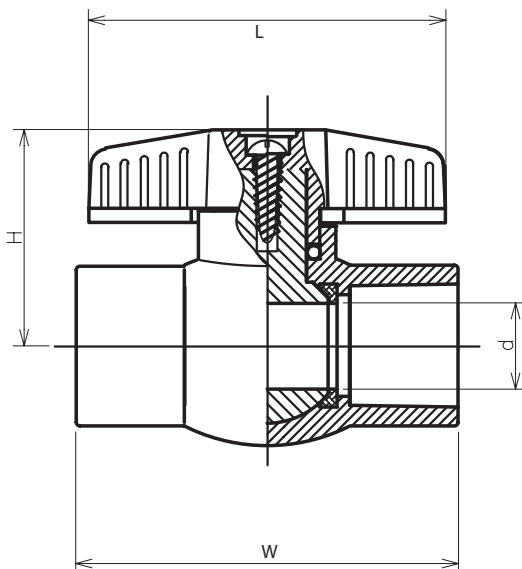

PART NO.	SIZE	H	L	W	D	WEIGHT (LBS)
VBV-CPV-E3PA	1/2"	1.49"	2.67"	2.36"	0.48"	0.125
VBV-CPV-E4PA	3/4"	1.93"	3.27"	2.75"	0.71"	0.231
VBV-CPV-E5PA	1"	2.05"	3.54"	3.11"	0.78"52	0.306

PART NO.	SIZE	H	L	W	D	WEIGHT (LBS)
VBV-CPV-E3B	1/2"	1.49"	2.67"	2.36"	0.48"	0.125
VBV-CPV-E4B	3/4"	1.93"	3.27"	2.75"	0.71"	0.231
VBV-CPV-E5B	1"	2.05"	3.54"	3.11"	0.78"52	0.306