

# Installation Guide for Spring Tension Rod

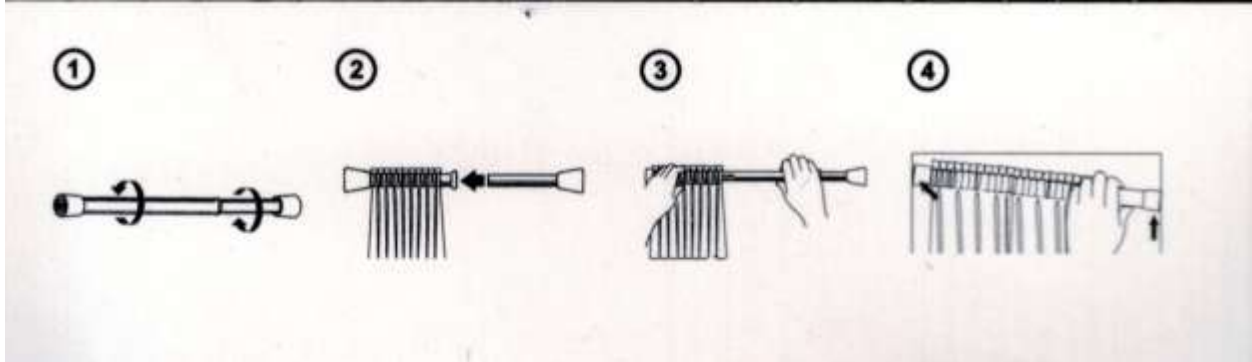

1. Twist rod to loosen the rod, you can now extend the rod to desired length.
2. Slide draperies either over the end of the rod or open up the rod and slide in drapery.
3. Affix the rod in the desired location, use twist motion to tighten the rod and lock it in place.
4. Use twist motion to loosen the rod in case you need to remove the rod.