

2013

Owner's Manual

Lift'n Buddy LNB-350/300



Copyright 2013, Lift'n Buddy

Lift'n Buddy
1854 NDSU Research Circle N
Fargo, ND 58102
701.499.5290 (phone)
1.855.LIFT.BUD (toll free)
701.499.3610 (fax)

2 Year
Warranty



Table of Contents

Delivery Inspection	2
Responsibility of Owners and Users	3
Safety Label Compliance	4
Important Operational Information	5
Caution	6
Assembly Requirements	7
Lift'n Buddy Design Diagrams	9
Battery Information	11
Operating Your Machine	12
Troubleshooting	13
Parts List	14
Warranty	15

Delivery Inspection

Basic Components List

- Aluminum structure with wheels and High-Performance linear actuator with
 - Actuator
 - Built in battery charging pack with charging indicator
 - Actuator
 - Detachable hand control
- Lifting Platform assembly
- Compact 12-volt fully encased lead-acid battery that is 100% recyclable
- Handle grip kit

For technical questions or to order interchangeable parts please call toll free at 1.855.LIFT.BUD. Representatives are on hand to answer any questions from 9:00a – 5:00p Central time Monday – Friday.

Responsibility of Owners and Users

Inspection and Maintenance

The device shall be inspected and maintained in proper working order in accordance with the Lift'n Buddy owner's manual.

Removal from Service

Any device not in safe operating condition such as, but not limited to, excessive leakage, missing rollers, pins, or fasteners, any bent or cracked structural members, cut or frayed electric, hydraulic, or pneumatic lines, damaged or malfunctioning controls or safety devices, etc. shall be removed from service until it is repaired to the original manufacturer's standards.

Deflection

It is the responsibility of the user/purchaser to advise the manufacturer where deflection may be critical to the application.

Repairs

All repairs shall be made by qualified personnel in conformance with Lift'n Buddy instructions.

Operators

Only trained personnel and authorized personnel shall be permitted to operate the lift.

Before Operation

Before using the device, the operator shall have:

- Read and/or had explained, and understood, the manufacturer's operating instructions and safety rules.
- Inspected the device for proper operation and condition. Any suspect item shall be carefully examined and a determination made by a qualified person as to whether it constitutes a hazard. All items not in conformance with Lift'n Buddy specification shall be corrected before further use of the equipment.

During Operation

The device shall only be used in accordance with this owner's manual.

- Do not overload.
- Ensure that all safety devices are operational and in place.

Modifications or Alterations

Modifications or alterations to any Lift'n Buddy industrial positioning equipment shall be made only with written permission from Lift'n Buddy.

SAFETY LABEL COMPLIANCE

To aid in understanding the concept and the importance of the symbol and signal word, the following has been excerpted from ANSI Z535.4.

Safety Alert Symbols

A symbol which indicates a potential personal injury hazard is composed of an equilateral triangle surrounding an exclamation mark. The safety alert symbol shall not be used to alert persons to property-damage-only accidents.



For use with DANGER signal word
(Red Background)



For use with WARNING signal word
(Orange Background)



For use with CAUTION signal word
(Yellow Background)

Signal Words

The meaning of different signal words as defined by ANSI Z535.6 and Z535.4 standards may be provided in collateral materials. The following artwork may be used for this purpose.



DANGER indicates a hazardous situation which, if not avoided, will result in death or serious injury.



WARNING indicates a hazardous situation which, if not avoided, could result in death or serious injury.



CAUTION, used with the safety alert symbol, indicates a hazardous situation which, if not avoided, could result in minor or moderate injury.



NOTICE is used to address practices not related to personal injury.

Important Operational Information

Read and understand all instructions before using this product.

- Do not exceed the manufacturer's load rated capacity. Read capacity sticker on the hand truck or load capacity rating in the specifications section of this operation manual if you are unsure.
- NEVER allow untrained operators or children to play with, sit, stand, ride on or operate the Lift'n Buddy.
- NEVER use the lifting capabilities to lift or transport a human being.
- Do not raise or lower a load while you are en-route. Wait until you are in the loading area and have stopped before raising or lowering the load.
- When loading keep your feet clear of the wheels and lifting/lowering tongue.
- Do not place hands or objects between the frame rails when lifting/lowering device is activated.
- Make sure fingers and hands are not caught in, on, or between the hand truck and other objects.
- Place the load so that it will not slip, shift or fall off the lifting platform. If hauling a large load, use straps to secure it.
- Make sure the platform is all the way under the load. Always load towards the rear.
- Do not throw, drop or bounce objects onto the hand truck.
- Keep the center of gravity of the load as low as possible by placing heavier objects under lighter objects.
- When pushing the load, make sure the weight is carried by the axle and not the handles.
- If you have an obstructed view, use an assistant to help in handling the load.
- The load should never obstruct your view when maneuvering the hand truck.
- Do not walk backward with the hand truck unless entering elevators, going up stairs, or ramps.
- When going down an incline, keep the hand truck in front of you so that it can be controlled at all times.
- Operators should push the hand truck at an appropriate walking pace.
- Always stand behind the hand truck when operating the lift.
- Never place an item on the lift that can roll off or tip over the unit. Only carry loads that lay flat on the platform to prevent roll over

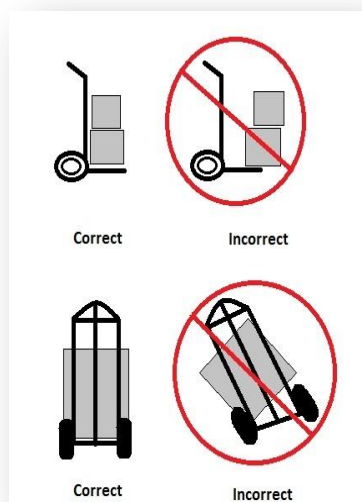

Make sure the load is securely placed towards the back of the hand truck. If the weight of the load is over the tip of the platform it may cause the unit to fall forwards.

Make sure not to tip or tilt the hand truck when transporting a load. For your safety and the security of your load maneuver on level, even ground only.

⚠ CAUTION

- When hauling a load up a ramp more force is required to move the same weight, as well as to slow down a loaded hand truck while moving down ramps.
- Be careful when approaching and turning corners. In tight corners or aisles load weight may need to be reduced.
- Floors that are damaged, cracked or uneven can catch wheels or castors in them. Dirty, dusty, oily, slippery or wet floors will reduce the ability of the operator to maintain traction. Without friction, the operator may slip and fall due to exerting excessive force to move the load.
- Operators should wear steel-toe boots while using the Lift'n Buddy products.
- Operators should receive training on how to maneuver heavy loads.
- Use common sense.



Never place feet between lifting plate and bottom plate as lowering mechanism can crush objects in its path.



Hands and arms may become injured if placed between a load and lift plate.



Hands and arms may become injured if placed in between the lift mechanism and frame.



Keep your face and head back when operating lift mechanism as actuator rod travels up with the platform and may cause injury.

ASSEMBLY REQUIREMENTS

The Lifti'n Buddy will arrive in a partially assembled condition. The following assembly is required.

Lift platform is inserted into the wheeled hand truck frame. Upper clevis pin is to be inserted into the actuators rod eye.

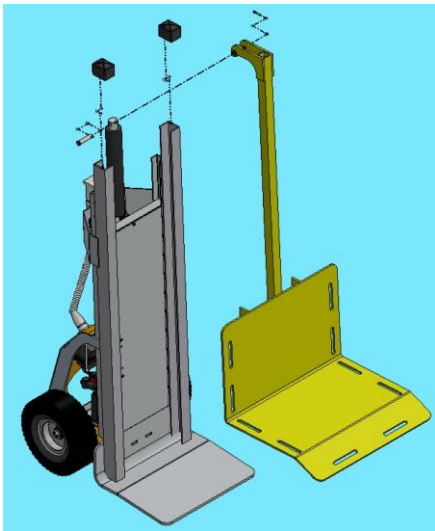

Figure 1

Remove control cover to expose wiring harness and battery compartment. After the battery is installed and connected replace the control cover.



Figure 2

The wiring harnesses use keyed disconnects to facilitate proper assembly and disassembly.



Figure 3



Figure 4

Place battery into its holder and secure it with the hook & loop strap. Connect the red battery lead to the red positive terminal and black lead to the negative battery terminal.



Figure 5



Figure 6

Reconnect the wiring harness leads securely.
Replace the control cover.



Figure 7

Attach the hand control to the disconnect receptacle located on the face of the control cover. A hook for holding any excess control cord is provided under the hand control mount plate.



Figure 8

NOTICE

Next Steps

The Lift'n Buddy is now assembled for use. Please become familiar with the function of this new tool. Read this manual's section on the battery and how to properly charge it before using and operating the device.



Mechanical Components

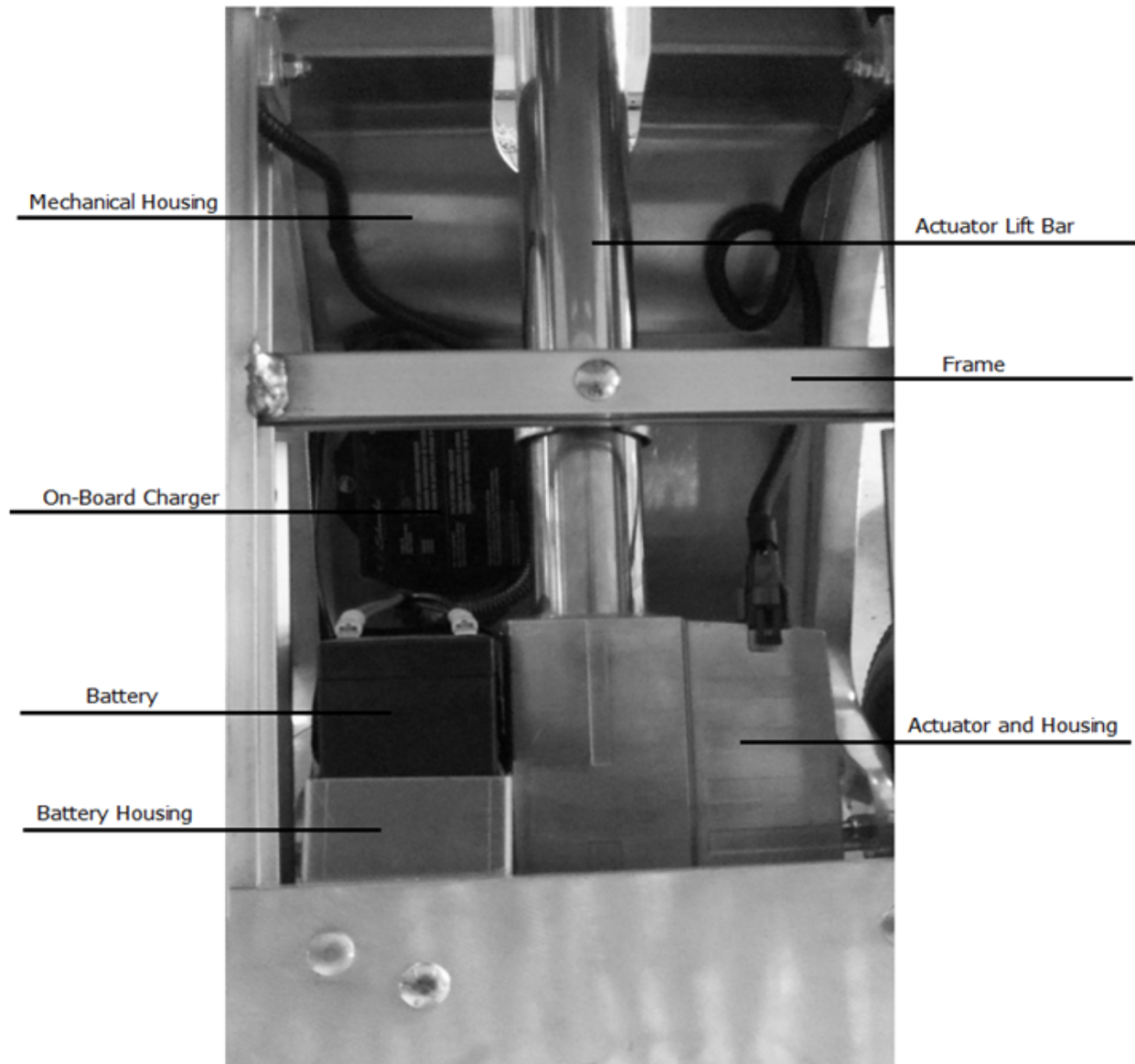

Note: This layout represents a basic unit. If you have ordered a customized Lift'n Buddy the components may look different than those listed in this manual.

Battery Information

The battery comes fully charged from the factory however it is recommended that you:

- Charge the battery before use.
- Charge the battery at the end of every day.
- Do not use unit if the battery has gone days without a charge or it will reduce the lifespan of the battery. Battery lifespan depends upon hours of usage.
- Only use Lift'n Buddy batteries. If your battery or charger needs replacement only use Lift'n Buddy recommended batteries and charging units.



The Lift'n Buddy comes with a rechargeable 12v 10AHr battery and a built-in battery charging unit. The battery charging unit is provided within the structure of the Lift'n Buddy and needs only to be attached to a power source via direct connection or with a proper extension cord.

The charging unit provided will not overcharge the battery if left plugged into power source.

Battery Warning

CAUTION

The battery is fully encased and generally safe however if damaged by human error, cracking or leaking may occur.

- NEVER touch the battery if it is cracked or leaking.
- ALWAYS use provided battery charging kit. Never attach an improper charging device, it may cause battery to overcharge and swell which can lead to cracking or leaking.
- If the battery is damaged wear protective eye wear and gloves when replacing.
- We recommend you have a technician replace any damaged parts of the Lift'n Buddy.

CAUTION

When charging the battery, there are a few things to keep in mind.

- Remember to never attach the charging unit into a damaged extension cord.
- Do not use in a power supply unit where other machinery may be plugged into.
- Keep area near power outlet free of debris.
- Never tug or pull on the cord to remove it from the outlet.

Operating Your Machine

Before using your Lift'n Buddy make sure to read the entire Operator's Manual. Familiarize yourself with the control switch and lifting speed. Practice using the hand truck without a load; make sure to know the lifting and lowering functions before loading and unloading. If your Lift'n Buddy has customized or has supplementary parts, install them using the directions provided. Always use the manufacturer's provided battery charger to charge the battery properly.

Step one:

Make sure the Lift'n Buddy is charged and the battery charging unit is unplugged from the power supply.

Step Two:

On the back of the machine is the operators interface hand control. This hand control can be removed from its mount saddle for remote operation. There are two buttons for operation marked "UP" and "DOWN". Press the appropriate button to lift or lower the Lift'n Buddy platform.

Step Three:

Make sure you have a clear path. Test the wheels by rolling the Lift'n Buddy back and forth without a load. Verify wheels are securely attached to their axle.

Step Four:

Place a load onto the platform (that is within weight capacity) and make sure the load is properly secured. Always lower the platform completely before maneuvering. Tilt the unit back on its wheels and visually check that the wheel pressure is not weak due to the load.

Step Five: Go on your way! Enjoy your Lift'n Buddy.

Troubleshooting Guide

PROBLEMS THAT MAY OCCUR	CAUSES	SOLUTION
Unit will not power on or travels slower than speed listed	Low or dead battery, Loose Terminals, Load limit exceeded, Power switch malfunction, fuse has activated	Charge battery for proper length of time, Insure all terminals are secure, Review Max load for unit, Replace Power switch, inspect and replace fuse.
Unit has intermittent power problems	Loosened terminals, Damaged wire leads	Insure all terminals are secure, Check wires for damage or wear
Platform only travels in one direction	Loosened terminals on Directional, Malfunctioning Relay	Insure all terminals are secure, Replace control relay
The battery does not receive a charge	Improper connection to power source, Loosened terminals, Power source not properly sending a charge	Insure charging device is securely connected to power source, Check any extension cords for damage, Insure all terminals are secure
The unit or platform is not level and/or is leaning	Wheel mounting problem Uneven surface	Check axle and wheel for damage or loose connection. Check that ground is level
For all other troubleshooting questions call toll free- 1.855.LIFT.BUD.		

Replacement Parts

Please contact our parts department for replacement parts. For proper service please provide the unit serial number to correctly identify the appropriate configuration of your device.

Typical replacement parts are listed below

- Wheels
- Actuator
- Battery
- Handle kit
- Clevis pins
- Axle
- Contactor
- Control Fuse
- Power Fuse

Lift'n Buddy Warranty

Lift'n Buddy will guarantee this product against material or manufacturing defects provided the truck has not been abused and is used under normal conditions. Lift'n Buddy will provide replacement parts for those deemed defective by Lift'n Buddy under the terms listed below.

LNB-350/300

All non-wear parts and components are covered for 2 years.

Custom Units

All non-wear parts and components are covered for 2 years.

All warranty periods begin at the date of purchase. This warranty does not include labor or miscellaneous costs involved in the replacement of components determined to be defective.

All wear items such as batteries, wheels, bearings; bushings have a limited warranty against defects in faulty material and workmanship for a 90-day period from date of invoice. Please note that prior authorization from Lift'n Buddy is needed on all repair warranty work.

In order to claim for warranty, you must supply the serial number, as well as, date of purchase. Any truck used under adverse conditions is NOT covered under any warranty. Bent, twisted or misaligned platforms are clear signs of abuse and are not covered under warranty.



*Due to continuing product development program, specifications are subject to change without notice.

Contact your authorized Lift'n Buddy dealer to confirm the most recent specifications.