

# ITEM # ABARL47 / ABARL53 INSTALLATION INSTRUCTIONS

## READ AND UNDERSTAND ALL WARNINGS BEFORE ASSEMBLY

### PACKAGE CONTENTS:



TWO PIECES RACKS (EACH INCLUDES END CAP AT EITHER SIDE)



TWO EACH  
SUPPORT BRACES



TWO KEYS

### SPECIFICATIONS:

ABARL47 = ALUMINUM RACK 47 INCH LENGTH

ABARL53 = ALUMINUM RACK 53 INCH LENGTH

EACH INCLUDES ANTI-THEFT LOCKING MECHANISM. EASY NO-DRILL INSTALLATION, FITS MOST CARS/SUVS WITH ROOF MOUNTS. NO DRILLING REQUIRED FOR INSTALLATION. YOU WILL NEED ONE PHILLIPS SCREWDRIVER FOR ASSEMBLY (NOT INCLUDED)

### **⚠ WARNING**

Do not secure load with bungee cords or any strap that stretches. Secure properly with tie-down straps so they don't come loose during transport.

### **⚠ WARNING**

NOT RECOMMENDED FOR USE WITH KAYAKS

### **⚠ ATTENTION**

BE AWARE OF YOUR VEHICLE HEIGHT:  
Adding accessories on top of the vehicle changes the height requirements.

Do not use product if any part of the rack is damaged or worn. Unsecured accessories or cargo falling in road can cause serious accidents and injury or death.

Drive safely, especially over bumps. Never use crossbars off-road.

Objects that extend forward or behind your vehicle must be tied down front and rear to the bumper or tow hooks on your vehicle.

Obey speed limits and traffic cautions. Speed should be reduced to adapt to the road condition and load being carried.

**QUESTIONS? CONTACT BUFFALO CORPORATION CUSTOMER SERVICE 636-532-9888**

# ITEM # ABARL47 / ABARL53 INSTALLATION INSTRUCTIONS

## READ AND UNDERSTAND ALL WARNINGS BEFORE ASSEMBLY

**DO NOT EXCEED  
165 LB MAX LOAD  
(INCLUDES ALL ACCESSORIES)**

### **⚠ WARNING**

Remove roof bars and accessories when entering an automatic car wash.

#### **ROOF BAR SPACING**

THE ROOF BARS SHOULD BE NO LESS THAN 36 INCHES APART.

USE FOLLOWING CALCULATION TO DETERMINE SUGGESTED SPACING:

TAKE 30% OF OVERALL LENGTH OF ITEM BEING CARRIED. (EXAMPLE: IF ITEM IS 12 FEET LONG, RACKS SHOULD BE 45-48 INCHES APART.)

USE CAUTION AT ALL TIMES. BE AWARE OF DRIVING CONDITIONS, WEATHER AND SURROUNDINGS. FLYING DEBRIS FROM UNSECURED ROOF RACKS CAN CAUSE INJURY AND DEATH.

#### **EXITING THE VEHICLE**

WHEN YOU EXIT THE VEHICLE USE CAUTION, BE AWARE OF ITEMS WHICH MAY HAVE SHIFTED.

### **⚠ WARNING**

Do not secure load with bungee cords or any strap that stretches. Secure properly with tie-down straps so they don't come loose during transport.

#### **ROOF BAR HEIGHT**

BE AWARE OF YOUR VEHICLE HEIGHT. ADDING ACCESSORIES TO VEHICLE CHANGES THE HEIGHT REQUIREMENTS OF BRIDGES, GARAGES AND OVERHEAD CEILINGS AND RAMPS.

#### **WEIGHT**

DO NOT EXCEED THE WEIGHT OF THE RACK. ADDING WEIGHT TO YOUR ROOF WILL CHANGE THE VEHICLE PERFORMANCE. USE CAUTION.

#### **WIND**

SECURING ITEMS TO THE ROOF INCREASES ITS CROSS SECTION SURFACE AREA, AND WILL INCREASE THE NEGATIVE EFFECTS THAT WIND GUSTS CAN HAVE ON STABILITY AND HANDLING.

# ITEM # ABARL47 / ABARL53 INSTALLATION INSTRUCTIONS

READ AND UNDERSTAND ALL WARNINGS BEFORE ASSEMBLY



**1**

Insert key to unlock and remove End Cap



**2**

Remove Channel Strip Insert from bottom of rack



**3**

Attach the support brace to the existing mount at front of vehicle



**4**

Attach the support brace on the opposite mount



**5**

Measure distance between support braces

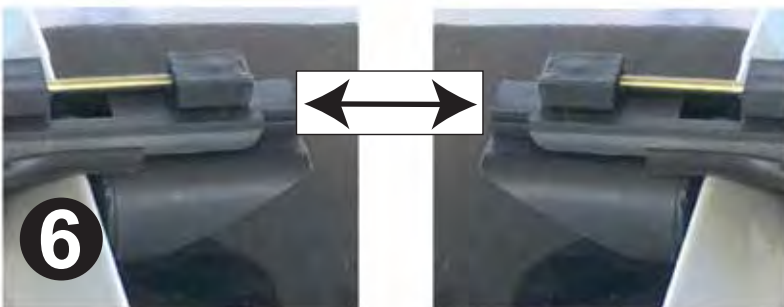

**6**

Note: the distance is measured between the outer edge of each support brace



**7**

Cut Channel Strip Insert to that length. (Channel Strip helps reduce wind noise)

**DO NOT EXCEED  
165 LB MAX LOAD  
(INCLUDES ALL ACCESSORIES)**



# ITEM # ABARL47 / ABARL53 INSTALLATION INSTRUCTIONS

**READ AND UNDERSTAND ALL WARNINGS BEFORE ASSEMBLY**



**8**  
Slide Channel Strip Insert into the bottom of rack



**9**  
Loosen screw and slide rack, short Channel Strip Insert at bottom, into support brace



**10**  
Slide rack into the support brace on the opposite side. (Trim Channel Strip again if rack doesn't fit completely )



**11**  
Center the rack, so it is evenly spaced between the two support braces



**12**  
Use phillips screwdriver and tighten screw on both sides



**13**  
Insert key, unlock end cap, then insert. Once in place, lock end cap. Repeat on opposite side

## QUESTIONS?

CONTACT BUFFALO CORPORATION

CUSTOMER SERVICE

636-532-9888

**DO NOT EXCEED  
165 LB MAX LOAD  
(INCLUDES ALL ACCESSORIES)**



**14**  
Repeat the process on back of vehicle