

ORIGINAL KETTLE PREMIUM LIMITED EDITION

ASSEMBLY GUIDE
GUÍA DE MONTAJE
ENSEMBLE GUIDE



22 inch
(57 cm)

Read owner's guide before using the grill.

Lea la guía del usuario antes de usar el asador.

Lisez le guide d'utilisation avant d'utiliser le barbecue.



FOR LIFE!



Unlock Grilling Happiness

Registration is easy and we only ask a few quick questions. In less than two minutes, activate your unique Weber-ID, and unlock a lifetime of Weber knowledge and guidance. Stay inspired along the way.



United States:

Phone
1-800-446-1071

Online
weber.com

Email
support@weberstephen.com



Únete al mundo de las parrilladas

Registrarse es muy sencillo y sólo hay que contestar un par de preguntas rápidas. En menos de dos minutos, habrás activado tu propio identificador Weber-ID y tendrás acceso a toda una vida de experiencia y conocimientos al estilo Weber. No volverás a quedarte sin ideas.



México

Téléphone
01 800 0093237

En Línea
weber.com

Email
support@weberstephen.com



Goûtez à toutes les joies du barbecue

L'enregistrement facile prend moins de deux minutes. Répondez à quelques questions pour activer un identifiant unique vous donnant un accès pour la vie à l'expertise et aux conseils de Weber. Vous serez inspiré tout le long de votre parcours de chef.



Canada :

Téléphone
1-800-446-1071

En Ligne
weber.com

Courriel
support@weberstephen.com



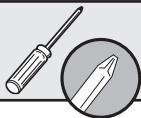

1-

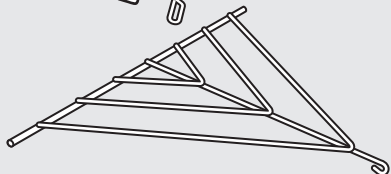
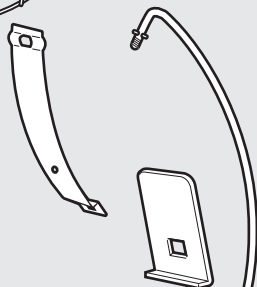
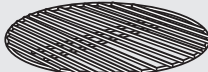
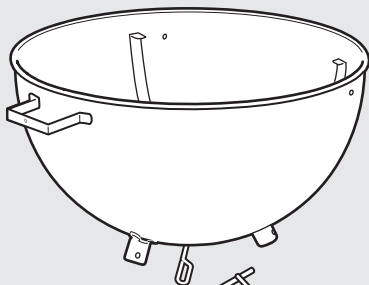
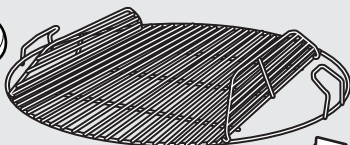
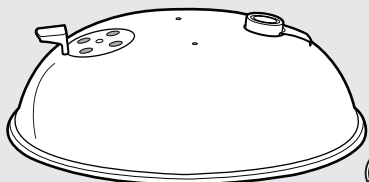
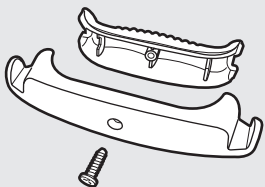
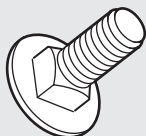

3-

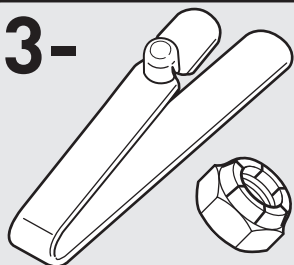

2-

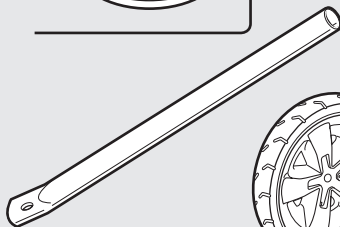
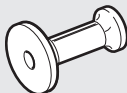

5-



1

3-

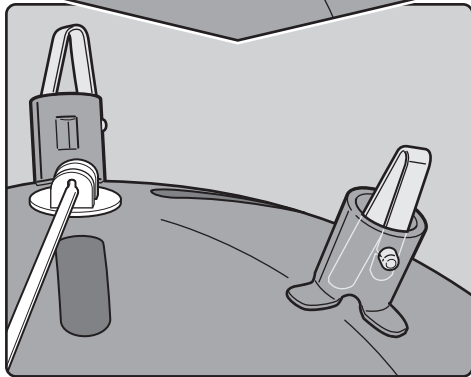
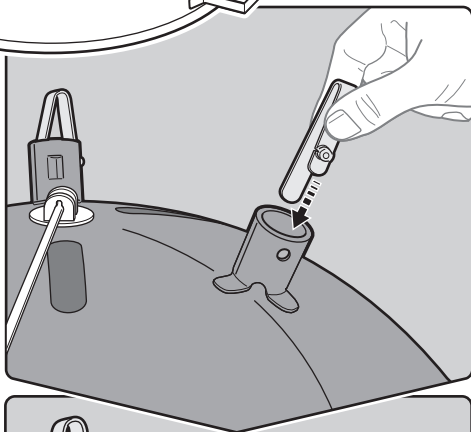
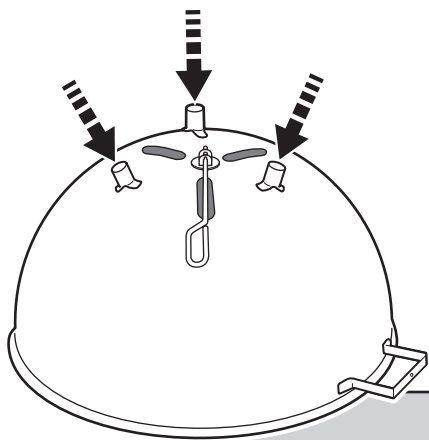
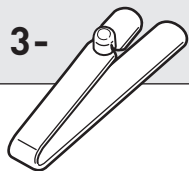

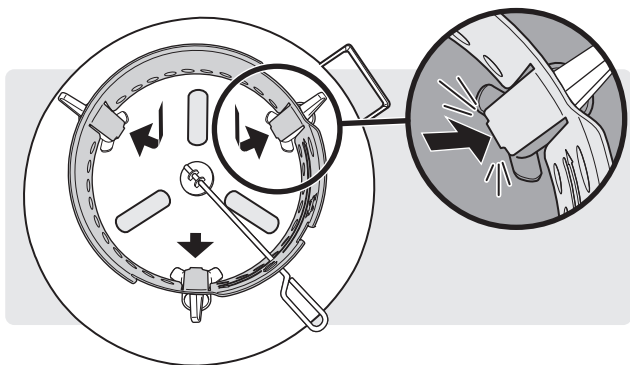
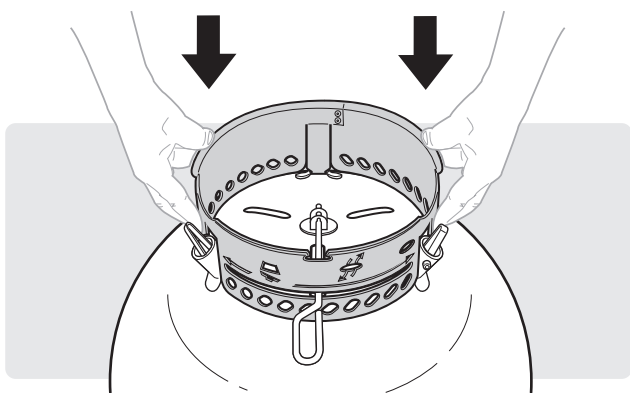
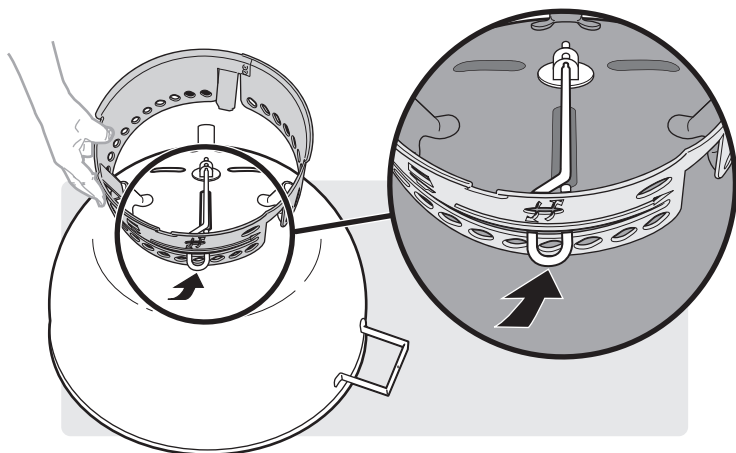

3

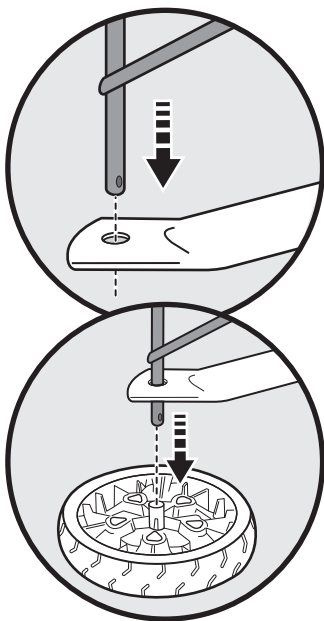
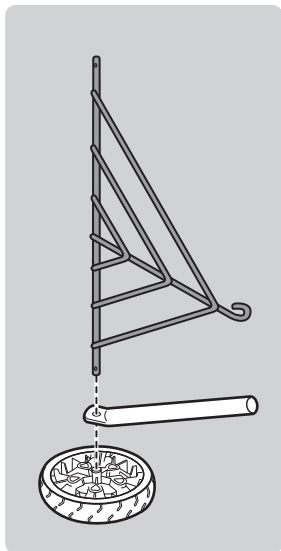

4

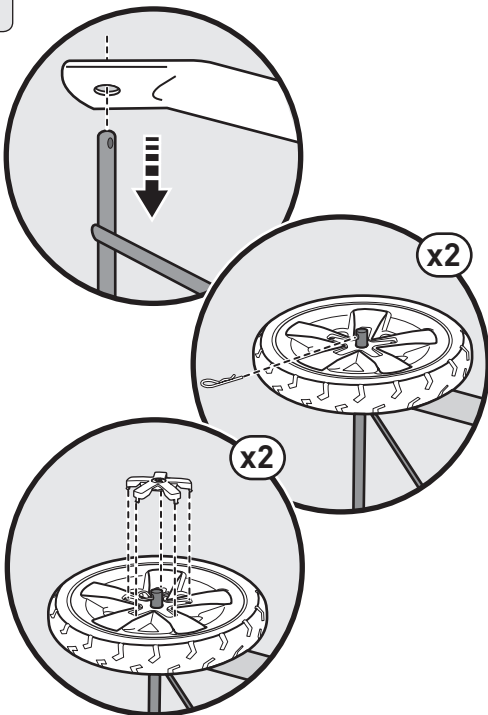
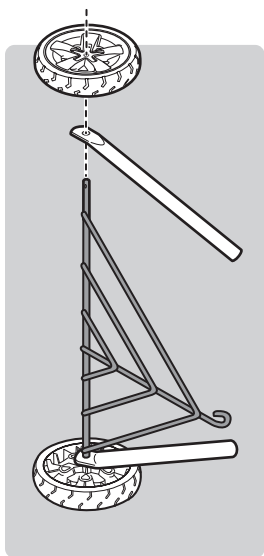

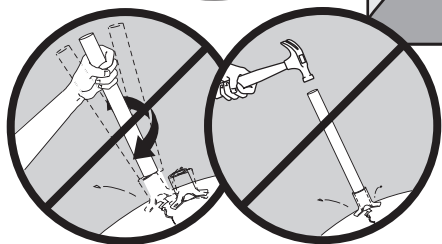
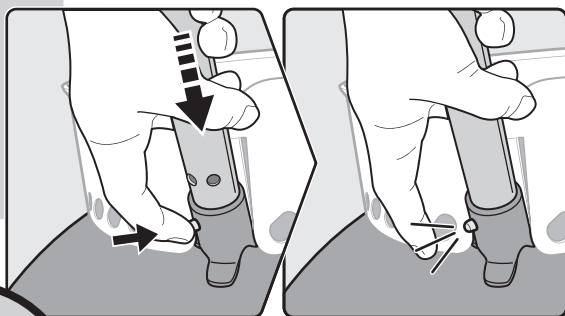
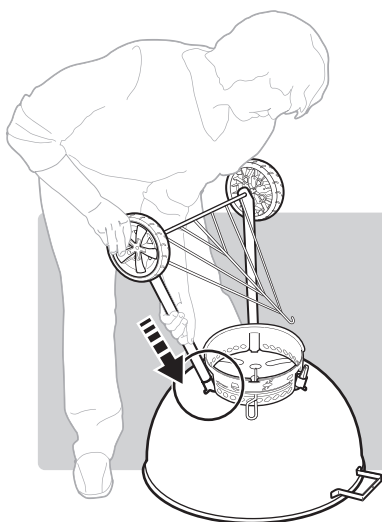
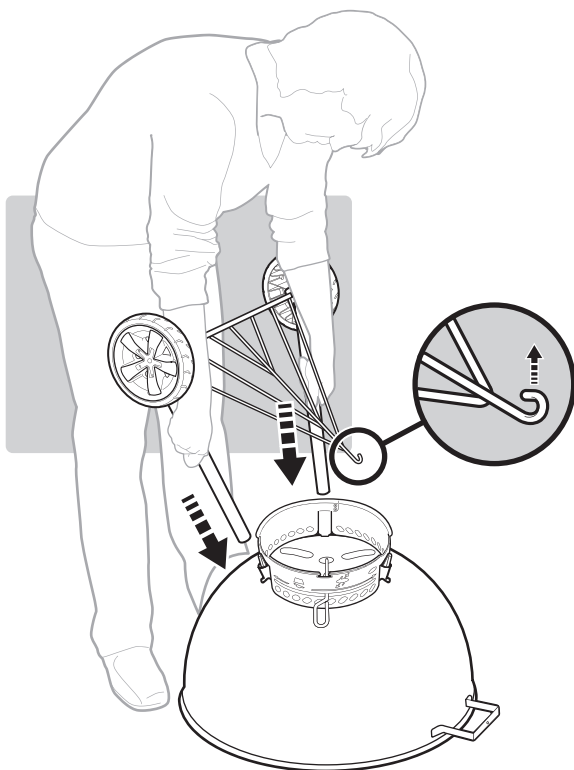
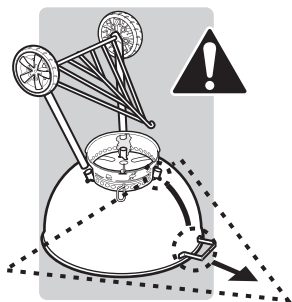

6

1-

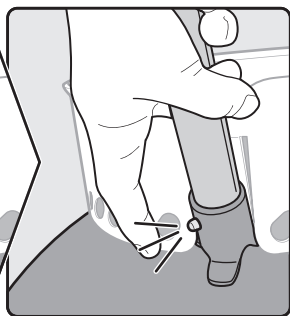
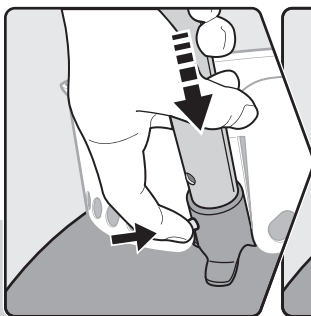
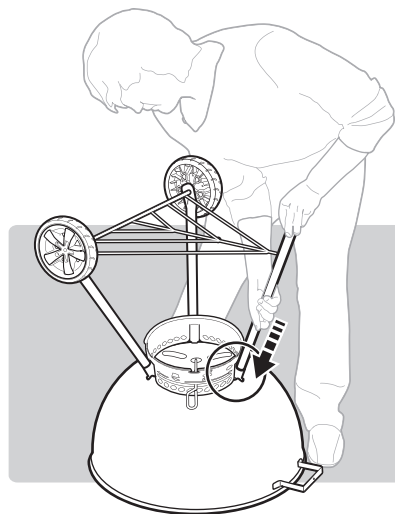
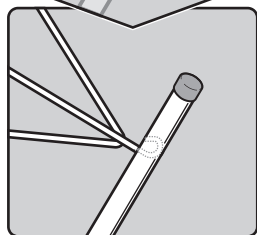
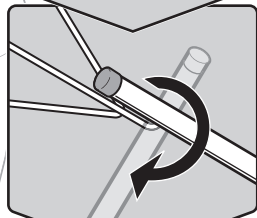
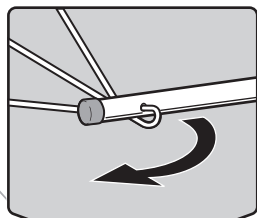
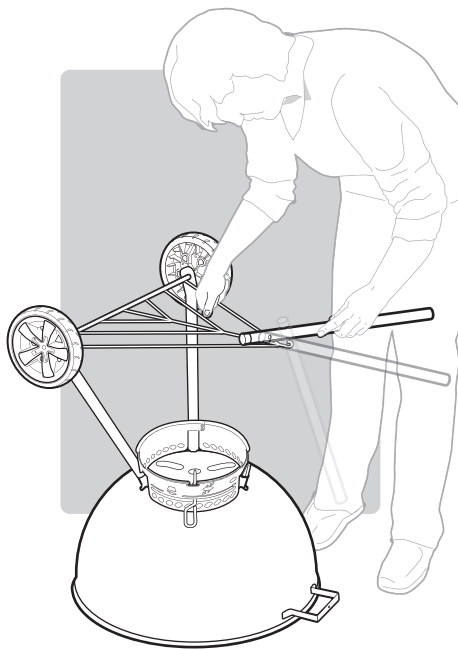
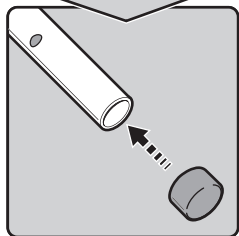
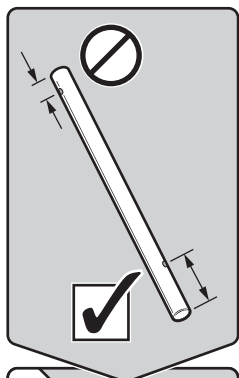

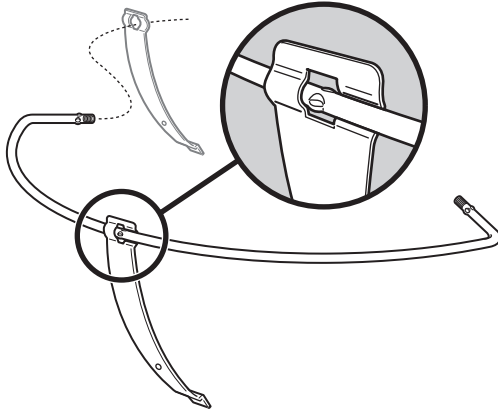
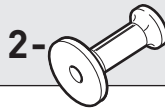
7

4-

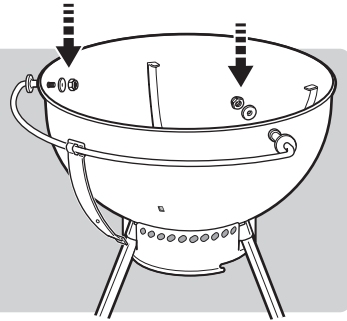
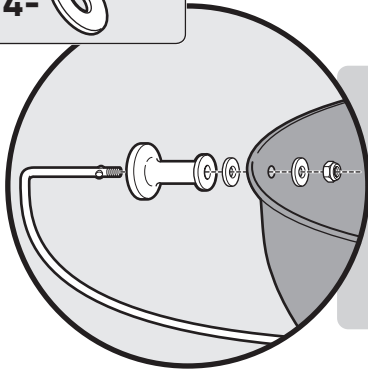

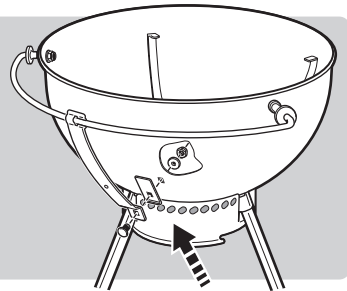
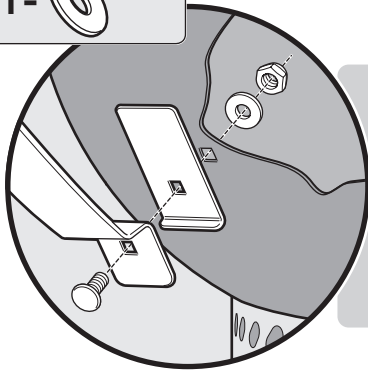

1-

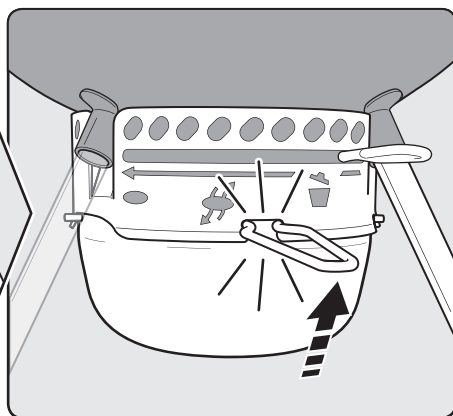
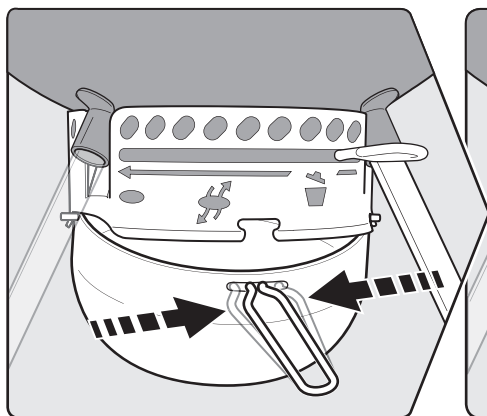
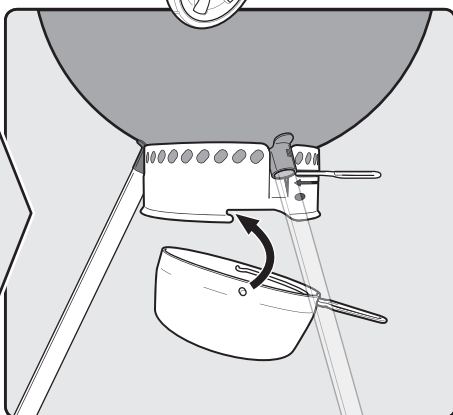
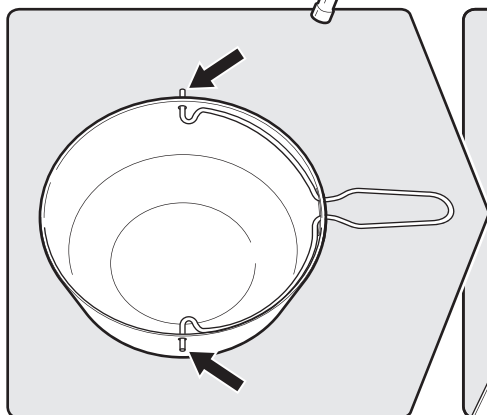
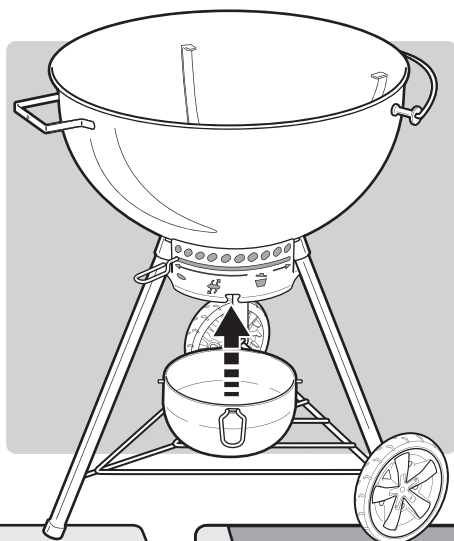

9

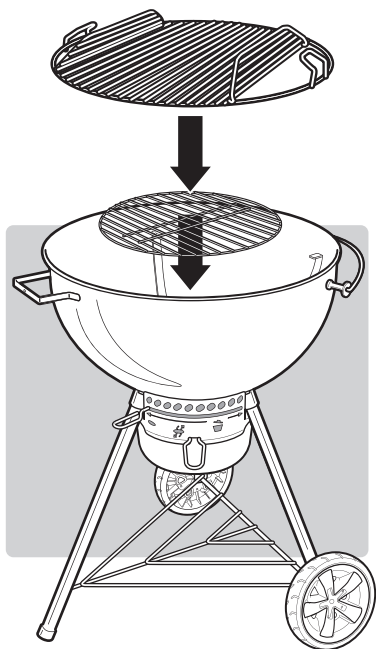

10



1-

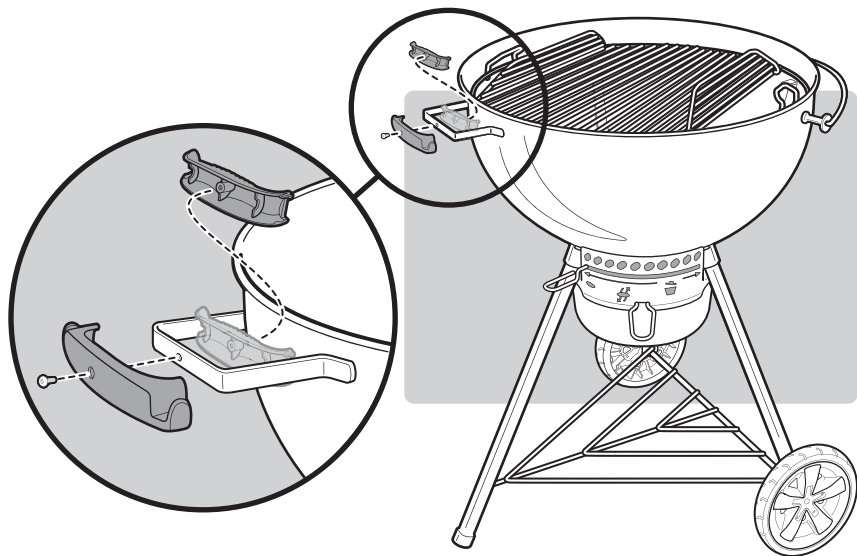

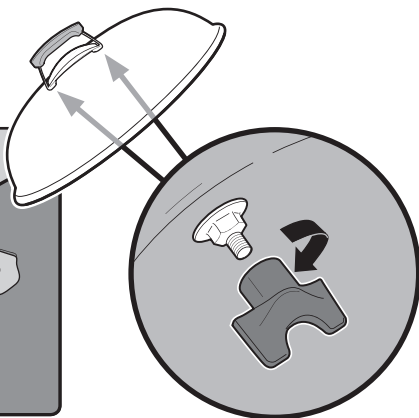
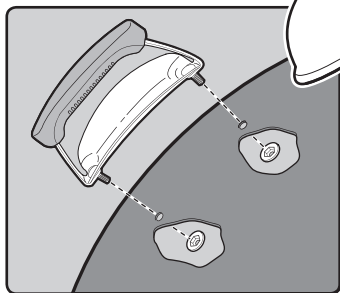
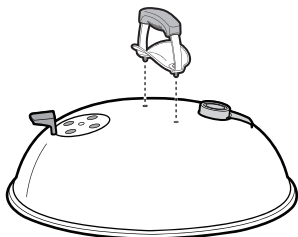
11**2-**

- ⚠ DO NOT OVER TIGHTEN.
- ⚠ NO APRIETE.
- ⚠ NE PAS TROP SERRER.

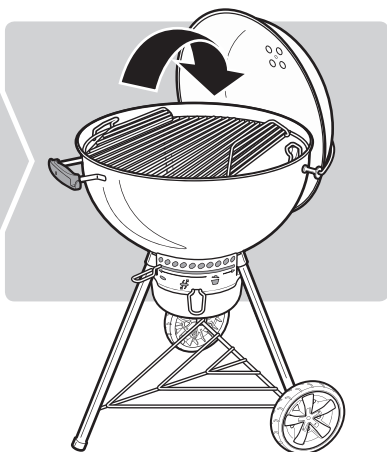
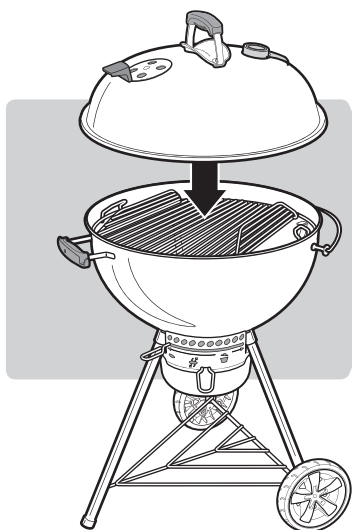
**12**

Don't forget to register.

No olvides registrarte.

N'oubliez pas d'enregistrer votre produit.



Serial Number
Número de serie
Numéro de série



Replacement Parts | Exploded View
Piezas de Repuesto | Vista Seccionada
Pièces de Remplacement | Vue Éclatée

22 inch_Original_Premium_Kettle_LE_XV_US_042417

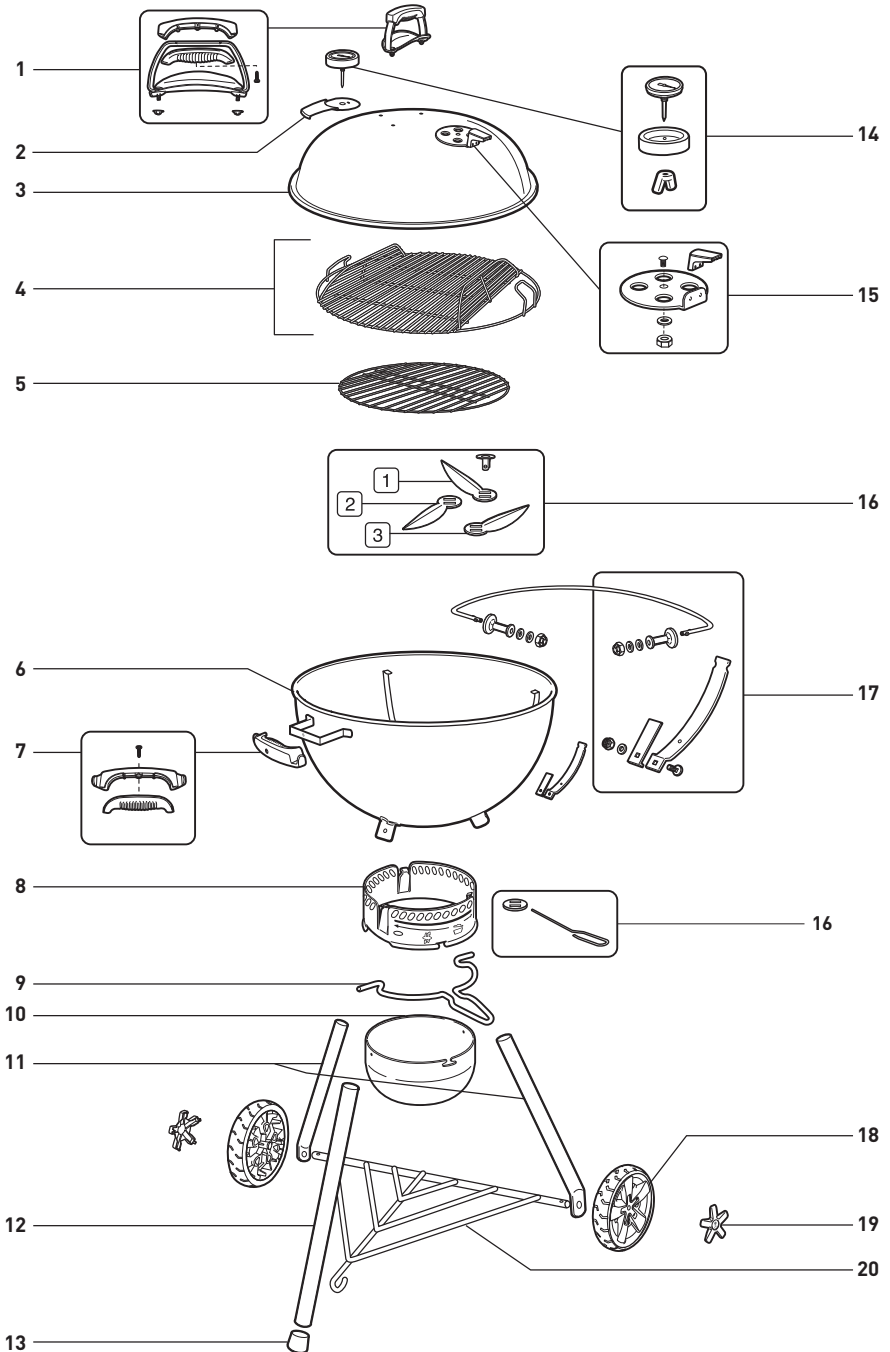

Exploded View List

1. Lid Handle Assembly
2. Logo Plate
3. Lid
4. Hinged Cooking Grate
5. Charcoal Grate
6. Bowl
7. Tool Hook Handle Assembly
8. Ash Catcher Ring
9. Ash Catcher Handle
10. High Capacity Ash Catcher
11. Wheel Leg
12. Front Leg
13. Leg Cap
14. Thermometer Assembly
15. Lid Damper Assembly
16. ONE-TOUCH Cleaning System
17. TUCK-AWAY Lid Holder & Lower Support Assembly
18. Wheel
19. Hub Cap
20. Triangle

Lista De Vista Seccionada

1. Conjunto de la agarradera de la tapa
2. Placa conlogotipo
3. Tapa
4. Rejilla para cocinar con bisagra
5. Rejilla de carbón
6. Tazón
7. Conjunto de la herramienta de agarradera de gancho
8. Anillo de receptor de ceniza
9. Asa del receptor de ceniza
10. Receptor de ceniza de alta capacidad
11. Pata con rueda
12. Pata frontal
13. Tapa de la pata
14. Conjunto del termómetro
15. Conjunto del amortiguador de la tapa
16. Sistema de limpieza ONE-TOUCH
17. Conjunto del sujetador de tapa y soporte inferior TUCK-AWAY
18. Rueda
19. Tapa del buje
20. Triángulo

Liste En Vue Éclatée

1. Ensemble de poignée du couvercle
2. Plaquette logo
3. Couvercle
4. Grille de cuisson articulée
5. Panier de briquettes
6. Bol
7. Ensemble de poignée de crochets à outils
8. Anneau du receveur de cendres
9. Poignée du receveur de cendres
10. Receveur de cendres à haute capacité
11. Pied à roue
12. Pied façade
13. Capuchon de pied
14. Thermomètre
15. Ensemble d'aération du couvercle
16. Système de nettoyage ONE-TOUCH
17. Ensemble porte couvercle et support inférieur TUCK-AWAY
18. Roue
19. Clip de fixation
20. Triangle



REPLACEMENT PARTS

To obtain replacement parts, contact the local retailer in your area or log onto weber.com.

PIEZAS DE REPUESTO

Para adquirir piezas de repuesto, ponte en contacto con tu distribuidor local o visita weber.com.

PIÈCES DE REMPLACEMENT

Pour obtenir des pièces de remplacement, communiquez avec le détaillant de votre région ou connectez-vous au site weber.com.

WEBER ACCESSORIES

Essential tools and cookware to get the most out of your grilling experience.

Herramientas y utensilios de cocina fundamentales para sacar el máximo provecho de cualquier parrillada.

Outils et ustensiles de cuisine essentiels à une expérience de cuisson formidable.



#7403

#6493



#6533

#6532

#6645

#6752



#17950



#7417

#7649

#7416

#7447

59517

072117
enUS / esMX / frCA