

Garage Door Closer

Model GT-100A

1. INTRODUCTION

Congratulations on your purchase of the Skylink® Garage Door Closer Model GT-100A. Skylink® Garage Door Closer is very easy to install, and provides you with the peace of mind you have been looking for by knowing your garage door will not be left open anymore. Skylink® Garage Door Closer consists of 2 units:

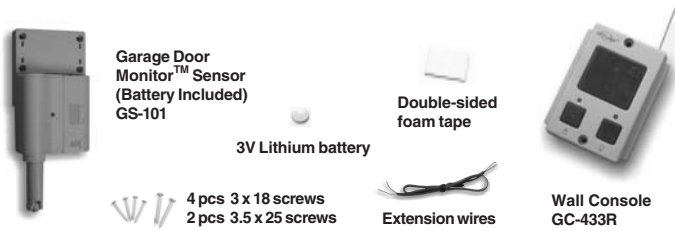

Wall Console does not require any battery to operate and it can replace most of the existing garage door opener's push buttons. Garage Door Sensor is battery operated and can be mounted on to the garage door by double sided tape or screws. These 2 units operate wirelessly which simplifies the installation.

Programming is very simple, you can select the time you would like the door to be closed after it has been opened. The selectable door closing times are 2 minutes, 5 minutes, 10 minutes and 20 minutes.

WARNING

Before installing the Skylink® garage door closer, ensure your garage door is equipped with an external entrapment protection device, such as an infrared beam sensor which "sees" an object obstructing the door without having actual contact with the object. A Garage door opener does that not have the auto reversing mechanism should be replaced by one that has the auto reversing mechanism feature and the garage door closer must not be installed on garage a door opener without this feature.

Without a properly working safety reversal system, a person could be seriously injured or killed by a closing garage door.

2. INSTALLATION

WARNING

Unplug the power cord of your garage door opener before installation to ensure power is not connected.

The installation involves 2 units:
1) Garage Door Monitor™ Sensor
2) Wall Console

Garage Door Monitor™ Sensor

Step 1 – Select a spot on your garage door to mount the sensor

Before you install the sensor onto the garage door, make sure the garage door is closed. The sensor assembly should be mounted on one of the vertical supports of your garage door near the bottom.

When the door is closed, the detection rod should be retracted. When the door is open, the detection rod will be extended.

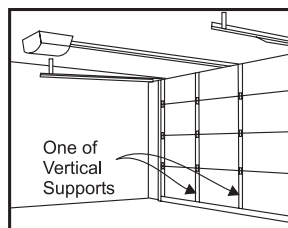
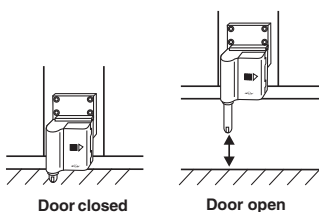
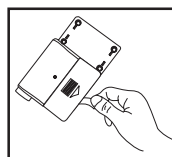

2. INSTALLATION (CONT)

Step 2 – Mount the sensor on to your garage door

You can mount the sensor onto your garage door with double-sided foam tape if the surface of your garage door is smooth and clean enough to provide a good adhesive surface, such surface can usually be found on a metal garage door. Please ensure the surface is smooth and clean. **Important: The bottom of the sensor should be 1/2 inch above the ground.** (Refer to Diagram A)

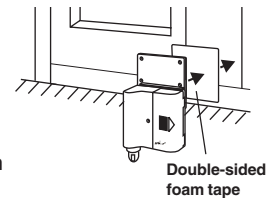

For wooden garage doors, it is recommended to mount the sensor with screws on to the garage door with 3 x 18 screws provided.

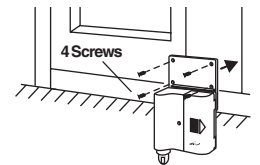

Note:

When the garage door is opening/closing, make sure the sensor does not interfere with the safety reversing sensor or safety beam sensor supplied with your existing garage door opener.

Note: Ensure you straighten up the antenna on the receiver to receive the best possible reception.

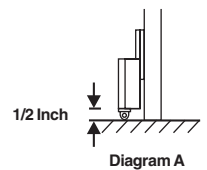

Wall Console

The GC-433R Wall Console replaces most garage door "push buttons" or "wall consoles". There are 2 different kinds of "push buttons":

- If you have a push button, you can replace the push button by the GC-433R.
- If you have a Chamberlain®, Lift-Master®, Sears® Multi-Functional Wall Console, you can replace the push button by GC-433R.

Replace	Connect in Parallel
All Brands - Push Button	Other Brands, other Wall Consoles
Chamberlain®, Lift-Master®, Sears® - Wall Console	

Replace

1. Remove the existing screws holding the push button of wall console.
2. Disconnect the 2 wires that are connected to the existing push button / wall console.
3. Connect these 2 wires to the 2 terminals on the GC-433R wall console. Tighten the screws on the terminals to secure the wiring.
4. Mount the GC-433R onto the wall with 2 screws provided and straighten up its antenna for best reception.
5. You may power up the garage door opener by plugging in the AC cord.
6. Follow instructions in "Charging Up Wall Console GC-433R".

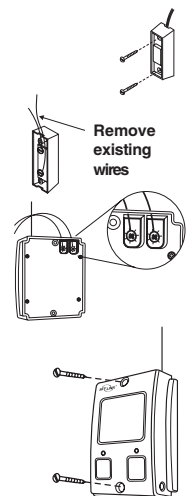

2. INSTALLATION (CONT)

Connect in Parallel

1. Remove the existing screws holding the push button of wall console.
2. Remove the 2 screws that secure the wires on the existing wall console.
3. Connect one end of the extension wires provided in this kit to the 2 terminals on the existing wall console, the other end to the GC-433R terminals. Polarity DOES NOT matter. Note: Do not remove any wiring from the existing wall console.
4. Mount both wall consoles (original one and GC-433R) to the wall with screws and straighten up the antenna on GC-433R for best reception.
5. You may power up the garage door opener by plugging in the AC cord.
6. Follow instructions in "Charging Up Wall Console GC-433R".

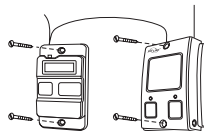
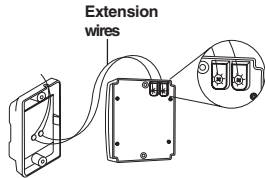
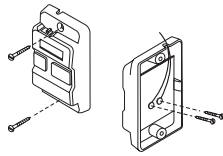

Charging Up Wall Console GC-433R

There is a power storage built-in to the GC-433R, this power storage must be charged fully before it can operate. This charging cycle will start automatically when the garage door opener is powered up.

1. After powering up the garage door opener, the GC-433R wall console will be charged.
2. During charging, the red LED will be on steadily.
3. The GC-433R is fully charged when the LED starts flashing with 2 beep sound. The actual charging time depends on the brand of garage door opener. Typical charging time ranges from 15 seconds to 2 minutes.
4. Once charging is completed, your garage door closer is ready to be operated.

Note: If you have Genie® Deluxe Wall Console, external adapter is required. Follow instructions below "To connect an external adapter".



TROUBLESHOOTING

If you do not see the LED flashing and hear 2 beeps after 3 minutes, ensure the wire connections are secured. If so, it could mean that your garage door opener is too old and you may need to add an external adapter to supply power to the GC-433R. Please consult with Skylink's customer service.

To connect an external adapter:

1. Plug in one end of the adapter to an AC outlet.
2. Plug in the other end of the plug to the GC-433R as shown.
3. GC-433R will be charged and when it is fully charged, the LED will flash and you will hear 2 beep sound.

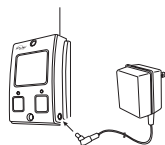

Rating of the transformer: 12V DC, 100mA \ominus \oplus \oplus
Diameter of DC plug : 3.5mm

3. OPERATION

After installing the Skylink® wall console, you may connect the power to the garage door opener.

The garage door closer monitors the door position in order to determine when the door needs to be closed. The Garage Door Sensor will send wireless signal to the wall console to report the door's position. User can set the wall console so it will close the door after it has been opened for a predetermined period of time.

Door Closer Delay Timer

User has the option to program how long the door should be closed after it has been open. This is called "Door Closer Delay Timer". To change the setting of this timer, there is a slide switch on the side of the wall console.

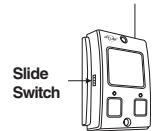

The highest position represents **2 minutes**;
2nd position from the top represents **5 minutes**;
3rd position from the top represents **10 minutes**;
The lowest position represents **20 minutes**;

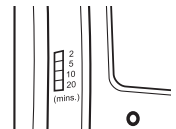

Follow the procedure below to test the function of the garage door closer.

- 1) The garage door should be in fully closed position.
- 2) Press the open / close button (push button) on the wall console, the garage door will open.
- 3) Once the door is opened, the wall console will beep and the "Timer / Learn" LED will flash indicating the door is open, and it will close the door after the preset door close delay time.
- 4) The beeping rate will increase as the timer is running out, meaning the door is about to close.
- 5) When the timer expires, the garage door will be closed automatically.

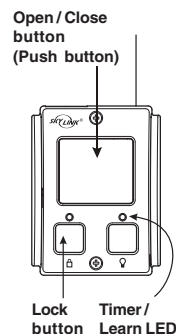

Disable Door Closer Delay Timer

Cancel Door Closer Delay Timer (when the timer is running)

The door closer delay timer can be cancelled temporarily. If you want the garage door to stay open for a longer period of time, such as when you are working in the garage or kids are playing outside, the auto closer feature can be cancelled temporary.

To cancel the door closer delay timer when it is running:

- 1) Press the push button once when the timer is running (i.e. door is opened).
- 2) The red timer LED will stop flashing and beeping will stop indicating the timer is cancelled for that sequence.
- 3) The door will remain open and will not be closed automatically, until the next door opening sequence, the timer will start again.

Deactivate Door Closer Delay Timer

It is possible to deactivate the door closer delay timer. When the feature is deactivated, opening the garage door will not activate the timer, therefore, the door will not be closed automatically until the timer is activated again.

To deactivate the door closer delay timer:

- 1) Press and hold the push button for 10 seconds.
- 2) The timer red LED will stay on, meaning the timer is now disabled.
- 3) Auto closer feature is now deactivated.

To activate the door closer delay timer:

- 1) Press and hold the push button for 10 seconds when the timer is deactivated, until the timer red LED changes from on to off.
- 2) The door closer delay timer is now activated.
- 3) Opening the door will start the door closer delay timer.

3. OPERATION (CONT)

Operation

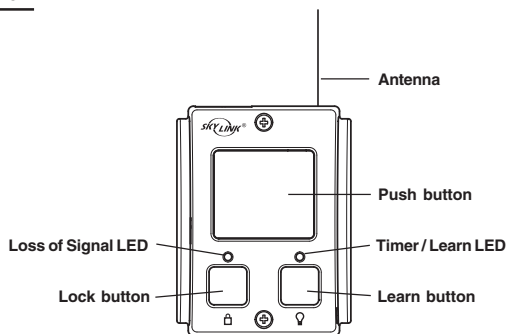

Push Button

Press the push button to open or close the garage door.

Lock Button

Lock feature is designed to prevent Skylink® handheld remotes such as Skylink® Keychain Remote Model 4B-201 (sold separately) to operate the garage opener.



To activate the lock feature

1. Press and hold the lock button for approx. 2 seconds, then release it.
2. When the lock feature is activated, the red LED underneath the push button will flash rapidly.

Note: If a valid wireless remote signal is received while the lock feature is activated, wall console will beep to reminding you the wall console is locked.

To deactivate the lock feature (unlock)

1. Press and hold the lock button for approx. 2 seconds, then release it.
2. When the lock feature is deactivated, the red LED underneath the push button will flash slowly indicating the wall console is in normal operating mode and the lock feature is deactivated.

If you have a Chamberlain®, Lift-Master®, or Sears® Multi-Function Wall Console, the lock button will lock/unlock both the Skylink® handheld remote, as well other Chamberlain®, Lift-Master®, Sears® remote controls.

Learn Button

Skylink® Wall Console can be used as a garage door opener receiver. It does not only operate as a garage door closer, additional handheld remote controls can be added. Additional remote controls are sold separately.

To program Skylink's remote control / sensor

1. Press the learn button for approx. 5 seconds.
2. The "Timer / Learn" red LED will be on, release the learn button.
3. Activate the Skylink® remote control. If the Skylink® remote control has multiple buttons, press the button you would like to operate.
4. The "Timer / Learn" LED will be off after it has successfully programmed the remote control.
5. You can now press the programmed remote to operate the garage door opener.

If you have a Chamberlain®, Lift-Master®, or Sears® Multi-Function Wall Console, the learn button also works as a light button. Pressing this button slightly will turn the light on the garage door opener on / off.

3. OPERATION (CONT)

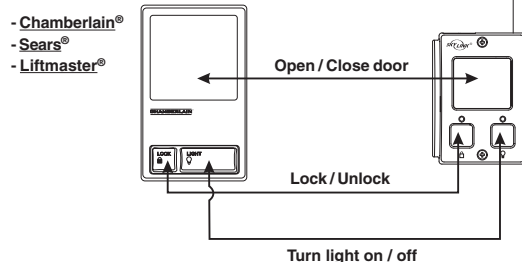

Important!

Ensure both the lock and light functions operate properly. Depends on which mode you are in:

	Lock Button	Light Button
Full Function Mode*	Lock /Unlock both GC-433R and Garage Door Opener	Turn light on / off
Simple Mode	Only lock / unlock GC-433R	No Function

* For Chamberlain®, Lift-Master®, Sears® Wall Console ONLY.

Pressing these buttons on the GC-433R should not activate anything else, such as opening or closing the garage door. If it does, you may need to change between Full Function Mode and Simple Mode. Refer to "Garage Door Opener operating Mode" below.

Erase Skylink® remote controls / sensors

To erase unwanted remote control(s), first erase all remote controls and sensors, then program the ones you would like to keep.

Erase all remote controls / sensors

1. Press and hold the learn button for 15 seconds.
2. The "Timer / Learn" red LED will flash rapidly meaning all remote have been erased.
3. You have now successfully erased all the remote controls and sensors. Follow the instructions "To program Skylink's remote control" to add the remote control(s) you would like to keep.

Loss of Signal

Skylink® Wall Console also monitors the status of the garage door sensor. If the garage door sensor fails to communicate with the wall console, the loss of signal LED will flash indicating a trouble condition for the sensor. There are 2 types of sensors. The flashing is different depending on the type of sensor:

Garage Door Sensor: One flash at a time
Audio Sensor (Optional Accessory): Two flashes at a time

When the loss of signal is flashing, please check the following:

- Check the battery of the sensor.
- The LED on the sensor should flash when the sensor is triggered.

For the detail of how the Audio Sensor works, please refer to "Accessories".

Garage Door Opener Operating Mode

The operation for different brands of opener is slightly different, so while the GC-433R is charging, it also identifies the brand of your garage door opener. Mainly there are 2 operating modes:

Full Function Mode: Chamberlain®, Lift-Master®, Sears® with Multi-Function Wall Console
Simple Mode: Other brands

3. OPERATION (CONT)

If your garage door opener is in Full Function Mode, i.e. Chamberlain®, Lift-Master®, Sears®, the garage door, you can use both the lock button and light button on the GC-433R to operate the lock function and light function on your garage door opener.

If your garage door opener is in Simple Mode, the lock and light buttons cannot be used to operate the lock and light functions on your garage door opener. You need to use the buttons on the original Multi-Functional Wall Console to execute these functions.

To identify your GC-433R has selected the properly brand, press both the lock and light buttons on your GC-433R (for less than 3 seconds) and observe the red LED above the lock button.

	Red LED above lock button
Full Function Mode	ON
Simple Mode	OFF

Note: While pressing both buttons together to check the operating mode, you may change the lock status. Please refer to section "Lock Button" to ensure you don't lock the GC-433R or your garage door opener while checking the operating mode.

4. ACCESSORIES

Optional accessories can be added to the garage door closer.

4-Button Keychain Remote – Model 4B-201

- Keychain remote can be programmed to the garage door closer so it operates the garage door opener like an ordinary remote control.
- It transmits Skylink® rolling code.
- Multiple buttons allow operation of multiple garage door openers and lighting / appliances control.



Audio Sensor – Model AS-101

- The Audio Sensor is to be used in conjunction with the Skylink® garage door closer and any CO detector (sold separately). It is used to detect the CO emission inside the garage.
- When the CO level exceeds the safety limit, the alarm from the CO detector will sound, which will trigger Skylink's Audio Sensor. Skylink® wall console will open the garage door for 10 minutes to improve air circulation. Door will then be closed automatically after the CO level resumes within the safety limit.

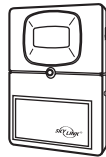

5. FCC

This device complies with Part 15 of the FCC Rules. Operation is subject to the following two conditions: (1) This device may not cause harmful interference, and (2) This device must accept any interference received, including interference that may cause undesired operation.

WARNING:

Changes or modifications to this unit not expressly approved by the party responsible for compliance could void the user's authority to operate the equipment.

NOTE:

This equipment has been tested and found to comply with the limits for a Class B digital device, pursuant to Part 15 of the FCC Rules. These limits are designed to provide reasonable protection against harmful interference in a residential installation. This equipment generates, uses and can radiate radio frequency energy and, if not installed and used in accordance with the instructions, may cause harmful interference to radio communications.

However, there is no guarantee that interference will not occur in a particular installation. If this equipment does cause harmful interference to radio or television reception, which can be determined by turning the equipment off and on, the user is encouraged to try to correct the interference by one or more of the following measures:

- Reorient or relocate the receiving antenna.
- Increase the separation between the equipment and receiver.
- Connect the equipment into an outlet on a circuit different from that to which the receiver is connected.
- Consult the dealer or an experienced radio/TV technician for help.

6. WARNING

To prevent possible SERIOUS INJURY or DEATH from a closing garage door:

- Activate door ONLY when it can be seen clearly, is properly adjusted, and there are no obstructions to door travel.
- ALWAYS keep garage door in sight until completely closed. NEVER permit anyone to cross path of closing garage door.

7. WARRANTY

If, within one year from date of purchase, this product should become defective (except battery), due to faulty workmanship or materials, it will be repaired or replaced, without charge. Proof of purchase and a Return Authorization are required.

8. CUSTOMER SERVICE

If you would like to order Skylink's products or have difficulty getting them to work or download latest information & user manual, please :

1. visit our FAQ section at www.skylinkhome.com, or
2. email us at support@skylinkhome.com, or
3. call our toll free at 1-800-304-1187 from Monday to Friday, 9 am to 5 pm EST.
Fax (800) 286-1320

CUSTOMER SERVICE

17 Sheard Avenue, Brampton, Ontario, Canada L6Y 1J3
Email: support@skylinkhome.com
<http://www.skylinkhome.com>
P/N. 101Z515
US Patent. 6,597,291
® are registered trademarks of their respective corporations
©2008 SKYLINK GROUP