



## Use & Care Guide



### 18V 2-in-1 Cordless *Swivel-Stick*™ Vacuum

MODEL NO.VSB1801NA



**Intertek**  
3084514  
Conforms to UL  
Standard UL1017  
Certified to CSA STD  
C22.2 NO.243

[www.vacmaster.com](http://www.vacmaster.com)  
Cleva North America, Inc.  
Greenville, SC 29607  
(866) 384-8432  
Made in China

# TABLE OF CONTENTS

SECTION	PAGE
Important Safety Instructions.....	3
Warranty.....	7
Technical Specs.....	7
Getting to Know Your Vacuum.....	8
General Assembly Instructions.....	9
Operating Instructions.....	12
Maintaining Your Vacuum.....	14
Troubleshooting.....	17

Thank you for purchasing this Vacmaster® vacuum cleaner.  
With it you are obtaining a high quality product that is engineered for optimal performance.

## **FOR YOUR SAFETY**

Read and understand this manual before use.  
Keep this manual and your sales check (receipt) in a safe place for future reference.

# IMPORTANT SAFETY INSTRUCTIONS

When using an electrical appliance, basic precautions should always be followed, including the following:

**READ ALL INSTRUCTIONS BEFORE USING THIS VACUUM CLEANER.**

Failure to follow the warnings and instructions may result in electric shock, fire and/or serious injury.



**WARNING - To reduce the risk of fire, electric shock, or injury:**

1. Do not use outdoors or on wet surfaces.
2. Do not allow to be used as a toy. Close attention is necessary when used by or near children, pets or plants.
3. Use only as described in this manual. Use only manufacturer's recommended attachments.
4. Do not use if charging plug is damaged. If appliance is not working as it should, has been dropped, damaged, left outdoors, or dropped into water, return it to a service center.
5. Do not pull or carry the charging adapter by cord, use cord as a handle, close a door on cord, or pull cord around sharp edges or corners. Do not run appliance over cord. Keep cord away from heated surfaces.
6. Do not unplug by pulling on charging cord. To unplug, grasp the plug, not the cord.
7. Do not handle charger, including charger plug, and charger terminals with wet hands.
8. Do not put any object into openings. Do not use with any opening blocked; keep free of dust, lint, hair, and anything that may reduce air flow.
9. Keep hair, loose clothing, fingers, and all parts of body away from openings and moving parts.
10. Use extra care when cleaning on stairs.
11. Do not use to pick up flammable or combustible liquids, such as gasoline, or use in areas where they may be present.
12. Do not pick up anything that is burning or smoking, such as cigarettes, matches, or hot ashes.
13. Do not use without dust cup or filter.

14. Prevent unintentional starting. Ensure the switch is in the off-position before connecting to hand vacuum, picking up or carrying the appliance.
15. Recharge only with the charger specified by the manufacturer. A charger that is suitable for one type of battery pack may create a risk of fire when used with another battery pack.
16. Under abusive conditions, liquid may be ejected from the battery; avoid contact. If contact accidentally occurs, flush affected area with water. If liquid contacts eyes, additionally seek medical help. Liquid ejected from the battery may cause irritation or burns.
17. Do not use a battery pack or appliance that is damaged or modified. Damaged or modified batteries may exhibit unpredictable behavior resulting in fire, explosion or risk of injury.
18. Do not expose a battery pack or appliance to fire or excessive temperature. Exposure to fire or temperature above 130°C may cause explosion.
19. Follow all charging instructions and do not charge the battery pack or appliance outside of the temperature range specified in the instructions. Charging improperly or at temperatures outside of the specified range may damage the battery and increase the risk of fire.
20. Have servicing performed by a qualified repair person using only identical replacement parts. This will ensure that the safety of the product is maintained.
21. Do not modify or attempt to repair the appliance or the battery pack except as indicated in the instructions for use and care.
22. Always turn off this appliance before connecting or disconnecting motorized nozzle.
23. Do not charge the unit outdoors.
24. Use only the charger supplied by manufacturer to recharge.
25. Do not incinerate the appliance even if it is severely damaged. The batteries can explode in a fire.

SAVE THESE INSTRUCTIONS

---

**NOTE:** This equipment has been tested and found to comply with the limits for a Class B digital device, pursuant to Part 15 of the FCC Rules. These limits are designed to provide reasonable protection against harmful interference in a residential installation. This equipment generates, uses and can radiate radio frequency energy and, if not installed and used in accordance with the instructions, may cause harmful interference to radio communications. However, there is no guarantee that interference will not occur in a particular installation. If this equipment does cause harmful interference to radio or television reception, which can be determined by turning the equipment off and on, the user is encouraged to try to correct the interference by one or more of the following measures:

- Reorient or relocate the receiving antenna.
- Increase the separation between the equipment and receiver.
- Connect the equipment into an outlet on a circuit different from that to which the receiver is connected.
- Consult the dealer or an experienced radio/TV technician for help.

This device complies with part 15 of the FCC Rules. Operation is subject to the following two conditions: (1) this device may not cause harmful interference, and (2) this device must accept any interference received, including interference that may cause undesired operation.

For Household Use Only

## **Product Disposal**

This product contains an internal Lithium-ion battery pack formulated from environmentally sensitive materials. This product must be disposed of properly with due care for the environment. Do not dispose of product with household garbage. Consult your local waste authority for information regarding available recycling or disposal options.

# WARRANTY

FOR ONE YEAR from the date of sale, this product is warranted against defects in material or workmanship when it is assembled, operated and maintained according to all supplied instructions.

WITH PROOF OF SALE, a defective appliance will be replaced free of charge. For warranty coverage details to obtain free replacement, visit the web page: [www.vacmaster.com](http://www.vacmaster.com) or call (866) 384-8432.

- This warranty does not cover filters, which are expendable parts that can wear out from normal use within the warranty period.
- This warranty is void if this product is ever used for other than private household purposes.
- This warranty gives you specific legal rights, and you may also have other rights which vary from state to state.

# TECHNICAL SPECS

Cordless Vacuum Cleaner  
Voltage: 18VDC

Battery Charger:  
Model: HOYOA® HYCH0102120470U  
Input: 100-240VAC, 50/60Hz  
Output: 21.25VDC, 470mA

# GETTING TO KNOW YOUR VACUUM

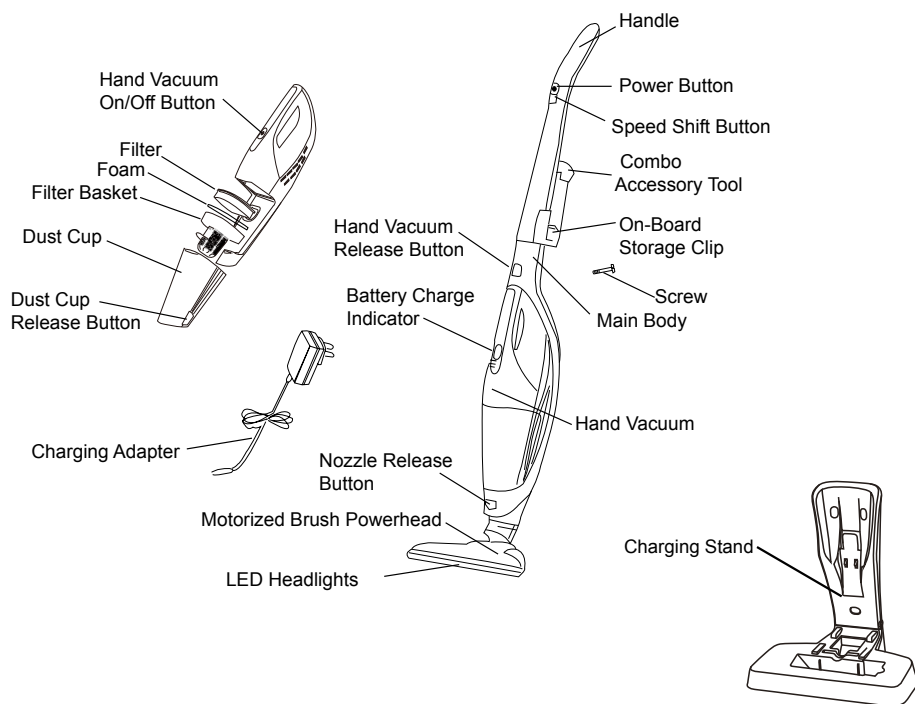

## REPLACEMENT PARTS

Item	Part No.
Filter	VMSTRF1
Foam	561022105
Charging Stand	561022108
Combo Accessory Tool	561022109
Charging Adapter	561022106
On-Board Storage Clip	561022107

Available online at [www.vacmaster.com](http://www.vacmaster.com)  
or call (866) 384-8432.



# GENERAL ASSEMBLY INSTRUCTIONS

## Assembly Instructions:

- 1) Fit the end of the **main body** onto the neck of the motorized **powerhead** and click into place.
  - 2) Insert the **handle** into the top of the main body and fix in position with the supplied locking **screw**.
- Note: Do not over-tighten. Use only hand tools and moderate torque.

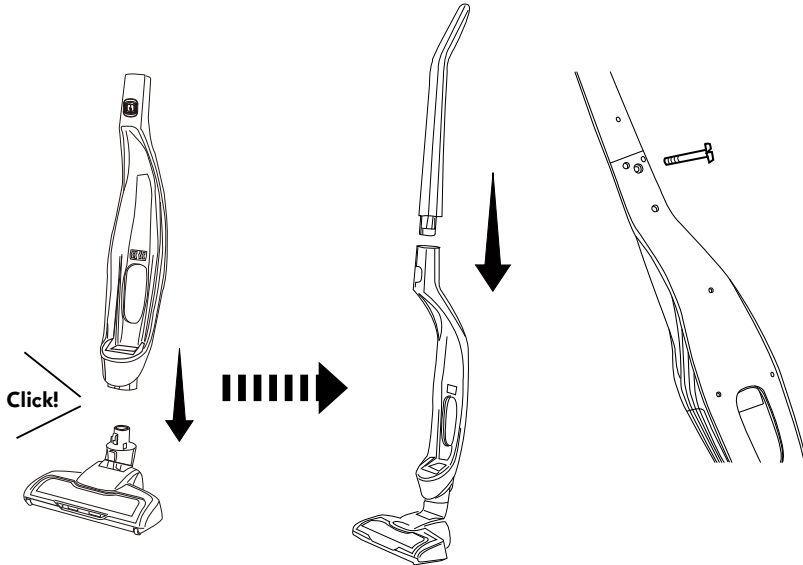

- 3) Insert the **hand vacuum** into the main body and click into place.

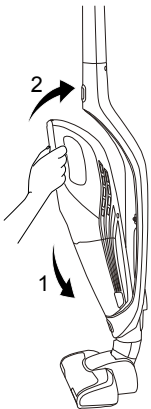

4) Insert **vacuum support** into **charging base** and lock into place.

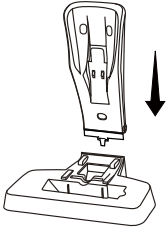

5) Insert the **charging adapter** into the charging port on the side of charging base.

6) Plug the adapter into a wall outlet.

Note: Use only the charger supplied with your cleaner to recharge.

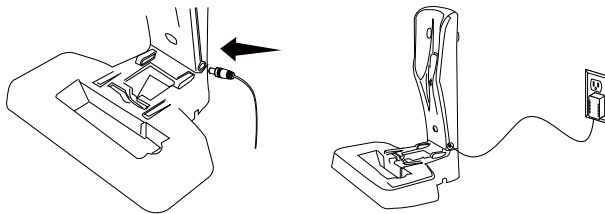

7) Insert **on-board storage clip** onto handle and slide down lightly.

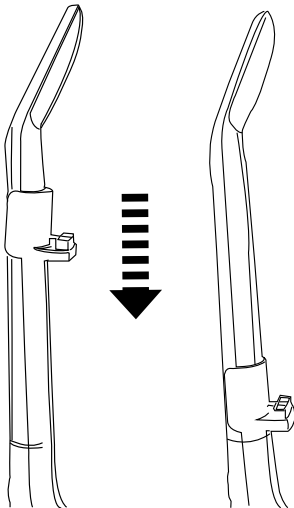

## Charging Instructions:

- 1) Before charging, make sure unit is OFF. Insert the vacuum cleaner onto the charger as shown. Make sure the **charging adapter** is plugged into an outlet.

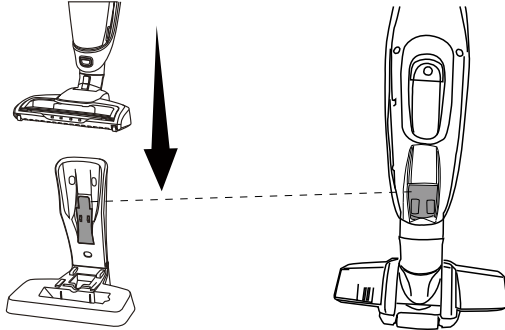

- 2) The **battery indicator** will show the progress of the charge. While the vacuum is being charged, the battery charge indicator will be flashing. Once fully charged, the indicator will light up continuously.

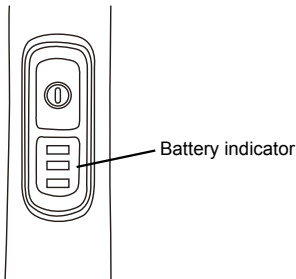

Battery Light	Indication
No Light	Charger not connected
Flashing Light	Charging battery
Solid Light	Battery fully charged

- 3) For improved battery performance, keep the vacuum cleaner on the charging base while not in use. Do not start the vacuum cleaner while it is on the charging base.

Caution: To optimize the battery longevity, charge the vacuum cleaner for at least 5 hours before using for the first time.

Never charge the batteries in temperatures above 37 °C (98.6 °F) or below 0 °C (32 °F). It is normal for the charger to become warm when charging.

# OPERATING INSTRUCTIONS

## Using Your Vacuum Cleaner:

Once vacuum cleaner is charged, lift off the charging base.

- 1) To start the vacuum, push the **Power button**. The vacuum automatically starts in the HIGH speed position.



- 2) To switch the speed to LOW, push the **speed shift button**. Press this button again to switch back to HIGH speed.

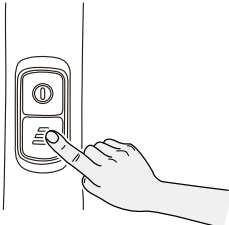

- 3) To stop the vacuum, push the Power button.

## Using Your Hand Vacuum:

- 1) To remove the **hand vacuum**, press the **release button** and detach from the **main body**.
- 2) To turn on, press the power button located on the **handle**.

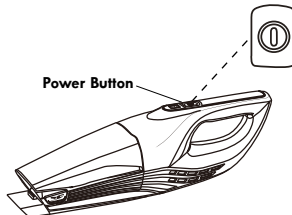
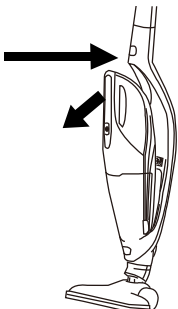

3) To clean difficult to reach areas, use the **crevice tool** or **dusting brush** by inserting the end of the tool into the **hand vacuum**.

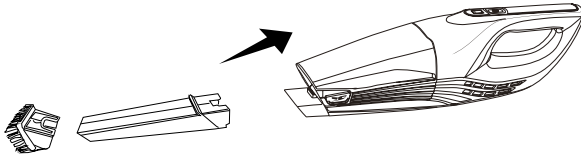

**!** CAUTION

Moving parts! To reduce the risk of personal injury, **DO NOT** touch the brush roll when vacuum is on. Contacting the brush roll while it is rotating can cut or cause other injuries. Always turn off before servicing. Use caution when operating near children.

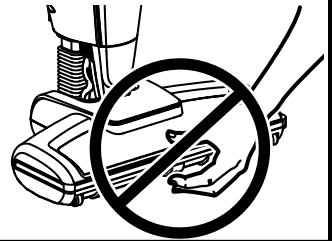

# MAINTAINING YOUR VACUUM

## CAUTION

To reduce the risk of shock, remove vacuum cleaner from the charging base, and turn off before performing any service or maintenance.

### Emptying the Dust Container & Cleaning the Filter

- 1) Remove the **hand vacuum** from the **main body** by pressing the **release button**.
- 2) Hold the unit over a trash bin and use one hand to press the two **dust cup release buttons** to separate the **dust cup** from the hand vacuum body.
- 3) Remove the **filter basket** from the dust cup. Empty the contents of the dust cup into a **trash bin**.

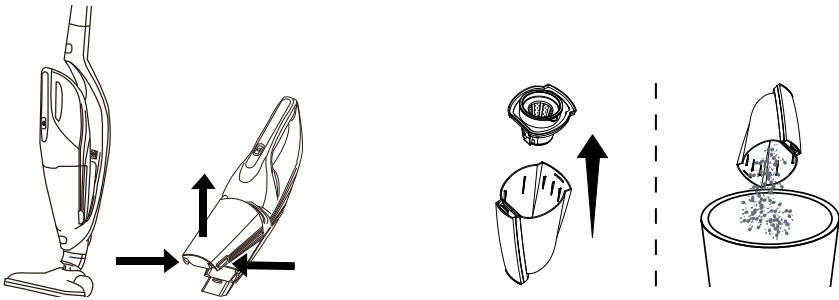

- 4) Remove the filter and foam from the filter basket. With your **dusting brush** attachment, brush accumulated debris from the side screens of the filter basket and from the filters.
- 5) After repeated use, it may be necessary to wash the plastic filter basket, filter and the foam. Hand wash the basket and foam in lukewarm water. After washing, set aside and allow to air dry for 24 hours.

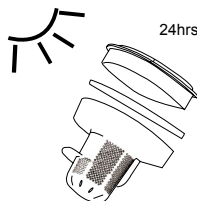
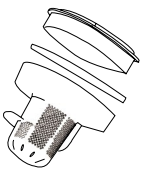

**IMPORTANT:** The filter, foam and basket must be completely dry before reuse.  
6) Insert the clean and dry foam along with the filter into the basket. Fit the basket into the dust cup and reconnect the dust cup to the hand vacuum.

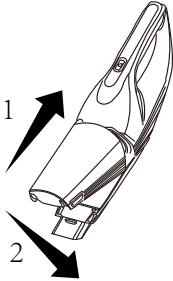

**Note:** Use warm water when cleaning the foam.



## **WARNING**

Do not operate vacuum cleaner without filter installed.

## **Cleaning the Motorized Powerhead & Blockages**

The brush roll may accumulate debris such as strings, hair and fibers. This type of debris can wrap around the brush and diminish its ability to clean effectively.

### **To Remove Brush Roll for Manual Cleaning:**

- 1) Make sure the vacuum cleaner is OFF then remove the hand vacuum and set aside.
- 2) Turn unit over to access the brush roll. As shown below, slide tab down to unlock, then rotate the lock up and out of the way.

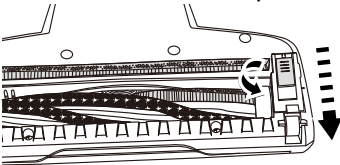

- 3) Lift the brush roll out of the housing. Clean off debris and anything wrapped around the brush. Use a pair of scissors to remove threads, etc.
- 4) Place the brush roll back into the housing by aligning the round end to the **powerhead** first, then inserting the square end correctly into place.

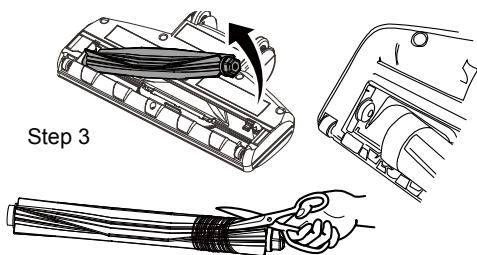

Step 3

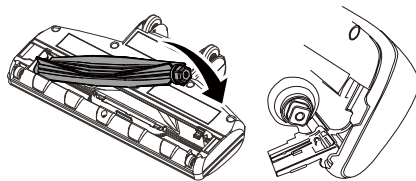

Step 4

5) Lock the brush in place by sliding the tab in the direction of the arrow.

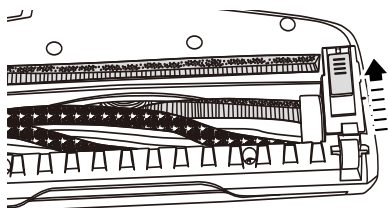

### To Remove Powerhead Blockages:

1) To clean out the **powerhead**, press the **nozzle release button** and pull the **powerhead** away from the main vacuum body.

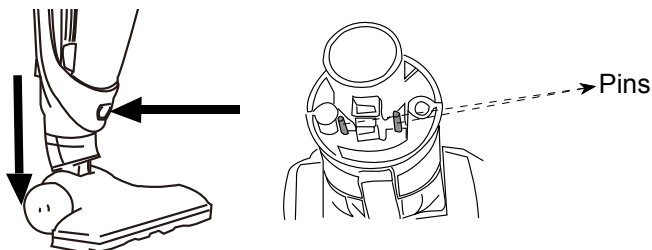

2) Carefully remove any debris or blockage from the inside of the powerhead.

3) Reattach the powerhead onto the vacuum body.

**Note:** Do not damage pins; do not use scissors or other sharp objects to remove a blockage from the powerhead as these may damage the powerhead.



# TROUBLESHOOTING

Should you have any problem(s) with your vacuum cleaner, review the table below for solutions to minor performance issues.



## WARNING

Disconnect electrical supply before performing maintenance to the vacuum cleaner. Failure to do so could result in electrical shock or personal injury.

PROBLEM	POSSIBLE CAUSE	SOLUTION
Vacuum will not power on.	Battery may be depleted.	Charge the battery as instructed on page 11.
	Wrong charger being used.	Be sure to use only the charger supplied with your product.
	Hand vacuum is not installed properly.	Remove hand vacuum and reattach ensuring that it is securely in place.
	Adapter plug is not fully plugged into the charging base.	Be sure the adapter plug is fully inserted in the charging base.
	Charging adapter is not fully plugged into outlet.	Be sure charging adapter is fully plugged into outlet.
Battery charge indicator does not illuminate.	Charging adapter is not plugged in.	Be sure the charging adapter is plugged in properly to the outlet and to the charging port on the bottom of the charging adapter.
	Debris accumulated on the metal charge contacts on the hand vacuum, main body and charging adapter.	Be sure no debris is accumulated on the metal charger contacts on the hand vacuum, main body and charging adapter.
	The electrical outlet is out of power.	Ensure that the outlet is supplying power to the charger.

Motorized brush not turning.	Brush roll is jammed.	Remove obstruction. Follow instructions on page 15 and 16.
	Brush roll needs to be reset.	Turn the unit off and remove the obstruction, then turn back on.
	Brush roll is not installed well.	Remove brush roll and reinstall following instructions on page 15 and 16.
Vacuum not picking up or suction power is weak.	Dust cup is full.	Empty dust cup.
	Filter needs cleaning.	Follow filter cleaning instructions on page 14.
	Filter needs to be replaced.	To purchase online at <a href="http://www.vacmaster.com">www.vacmaster.com</a> or call (866) 384-8432.
	Battery may be depleted.	Charge the battery as instructed on page 11.
	Dust cup is not installed well.	Check dust cup for correct installation and ensure it is snapped firmly in place.
Dust escapes from vacuum.	Filter is missing or installed incorrectly.	Check filter for correct installation.
	Filter is damaged and needs to be replaced.	To purchase online at <a href="http://www.vacmaster.com">www.vacmaster.com</a> or call (866) 384-8432.
	Dust cup installed incorrectly.	Position dust cup correctly and snap firmly into place.
Vacuum turns off on its own.	Battery may be depleted.	Charge the battery as instructed on page 11.

For further questions, call our support team at (866) 384-8432.