

TROUBLESHOOTING:

	Possible Cause	Corrective Action
Bulb will not light.	1. Bulb is burned out.	1. Replace light bulb.
	2. Power is off.	2. Make sure power supply is on.
	3. Faulty wire connection.	3. Check wiring.
Fuse blows or circuit breaker trips when light is turned on.	Crossed wires or power wire is grounding out.	Check wire connections.

PRODUCT MAINTENANCE:

1. To clean the outside of the fixture, use a dry or slightly dampened clean cloth (use clean water, never a solvent) to wipe the shade and surface of the fixture.
2. To clean the inside of the fixture, first disconnect power to the fixture by turning off the circuit breaker or by removing the fuse at the fuse box. Next, use a dry or slightly dampened clean cloth (use clean water, never a solvent) to wipe the inside shade and interior surface of the fixture.
3. Do not use any cleaners with chemicals, solvents or harsh abrasives. Use only a dry soft cloth to dust or wipe carefully.

LIMITED WARRANTY

The manufacturer warrants this lighting fixture to be free from defects in materials and workmanship for a period of five (5) years from date of purchase. This warranty applies only to the original consumer purchaser and only to products used in normal use and service. If this product is found to be defective, the manufacturer's only obligation, and your exclusive remedy, is the repair or replacement of the product at the manufacturer's discretion, provided that the product has not been damaged through misuse, abuse, accident, modifications, alterations, neglect or mishandling. This warranty shall not apply to any product that is found to have been improperly installed, set-up, or used in any way not in accordance with the instructions supplied with the product. This warranty shall not apply to a failure of the product as a result of an accident, misuse, abuse, negligence, alteration, or faulty installation, or any other failure not relating to faulty material or workmanship. This warranty shall not apply to the finish on any portion of the product, such as surface and/or weathering, as this is considered normal wear and tear. **The manufacturer does not warrant and specially disclaims any warranty, whether express or implied, of fitness for a particular purpose, other than the warranty contained herein. The manufacturer specifically disclaims any liability and shall not be liable for any consequential or incidental loss or damage, including but not limited to any labor / expense costs involved in the replacement or repair of said product.**



INSTRUCTION MANUAL

Interior Decorative Lighting

4 Light Island Pendant

Sadie

Home Depot SKU (529-976) UPC (773546217101)
Brushed Nickel Finish

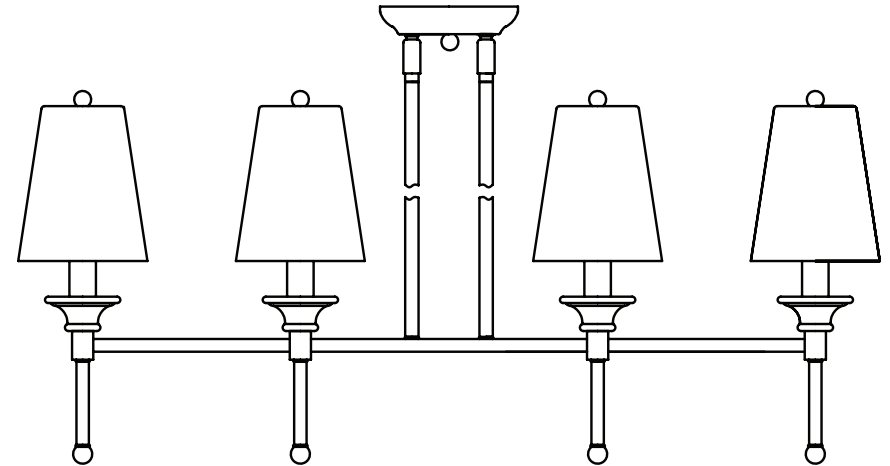

Thank you for purchasing this Hampton Bay interior decorative lighting. This product has been manufactured with the highest standards of safety and quality.

FEATURES:

Shimmering elegance and sparkle to your decor, the jewel-like crystal accents of this fixture will be reflected by the light coming from within. Royal black fabric shades help complete and accentuate this fixture.

Standard: 12" rod lengths to make desired height.

QUESTIONS, PROBLEMS, MISSING PARTS:

Before returning to your local Home Depot, please call our Customer Service Team at 1-877-527-0313 or visit www.homedepot.com. Please reference your **SKU# (529-976)** or **UPC# (773546217101)**.

CAUTION:

1. Before starting installation of this fixture or removal of a previous fixture, disconnect the power by turning off the circuit breaker or by removing the fuse at the fuse box.
2. CONSULT A QUALIFIED ELECTRICIAN IF YOU HAVE ANY ELECTRICAL QUESTIONS.
3. If you have any non-electrical questions about this fixture, please contact our Customer Service Team at 1-877-527-0313 or visit www.homedepot.com. Please reference your **SKU# (529-976)** or **UPC# (773546217101)**.
4. Keep your receipt and these Instructions for Proof of Purchase.

TOOLS REQUIRED FOR ASSEMBLY & INSTALLATION (not included):



Safety goggles

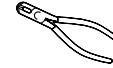

Wire Strippers

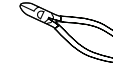

Wire Cutters

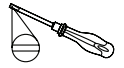

Flathead Screwdriver

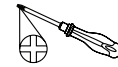

Phillips Screwdriver



Electrical Tape



B10 Bulb 60W (x4)



Ladder

ADDITIONAL PARTS (included) (Parts are not to scale):

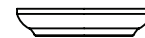

4. Canopy



5. Ball Nut



10. Lower Hex Nut (x2)



11. Lock Washer



12. Metal Washer



13. Retaining Screw



14. Decorative Cap

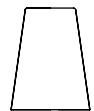

15. Glass Shade

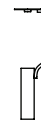

17. Candle Sleeve with Glass Holder



20. Bottom Finial



22. 12" Bottom Rod

ASSEMBLY INSTRUCTIONS:

1. Carefully unpack the fixture; lay out all parts on clean surface.
2. Screw-in tightly and attach the 12" rod (part of main fixture body), followed by the 12" bottom rod (22) to the fixture nipple (21).
3. Tighten the retaining screw (13) to hold the end-piece (part of fixture body) to the top-most 12" rod (part of fixture body). (Adjust the desired height by removing the rods).
4. Draw the wires (including the grounding wire) through the canopy (4) and attach the canopy (4) to the end-piece with the metal washer (12), lock washer (11) and tighten with lower hex nut (10).
5. Attach bottom finial (20) to each Candelabra Bobeche (19).
6. Place candle sleeve with glass holder (17) over socket (18).

GLASS AND BULB INSTALLATION:

1. Install 60W max B10 chandelier bulbs (not included).
2. Place glass shade (15) onto candle sleeve with glass holder (17).
3. Tighten and secure glass shade (15) with decorative cap (14).

ASSEMBLY:

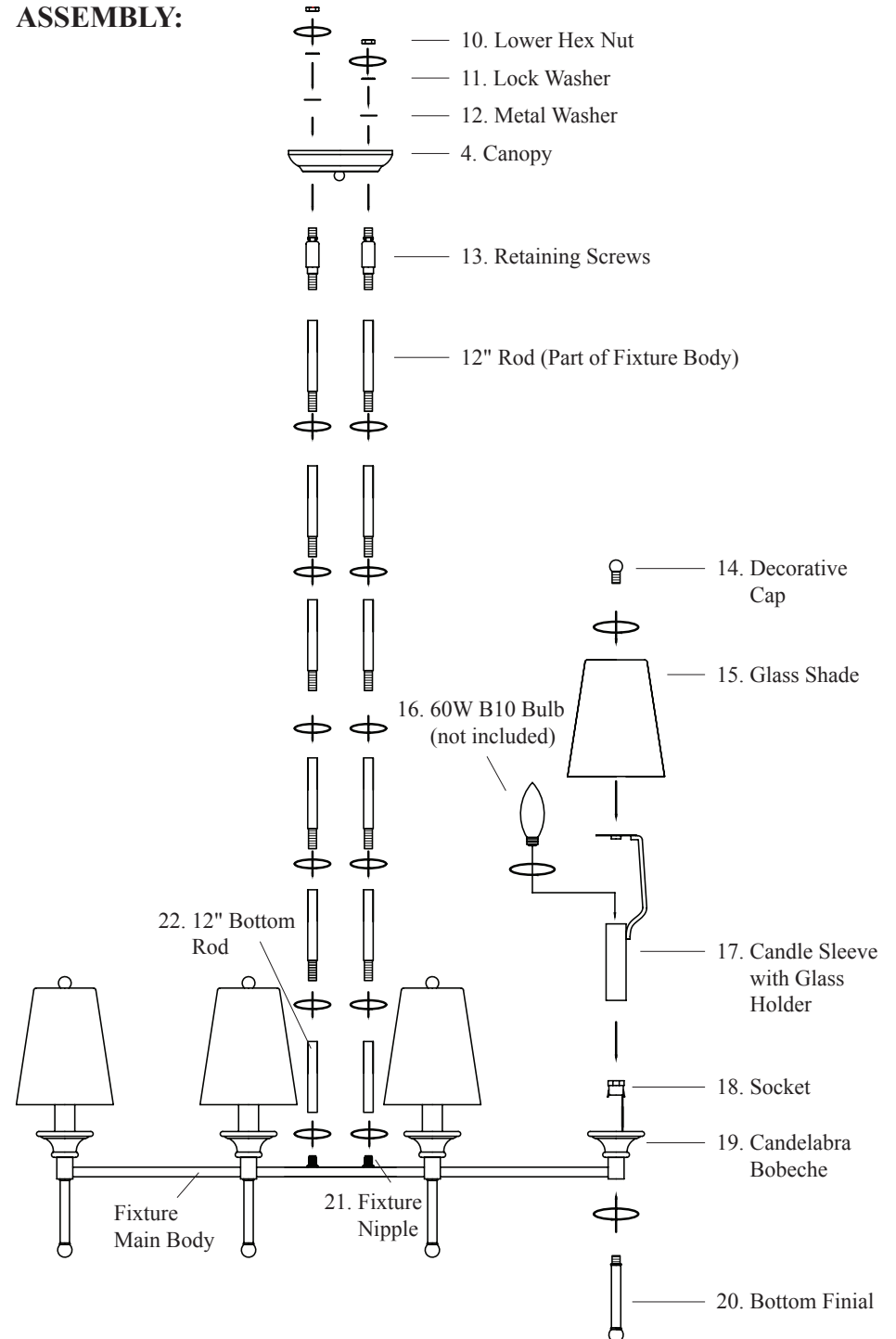

PARTS INCLUDED FOR INSTALLATION

(parts are not to scale):

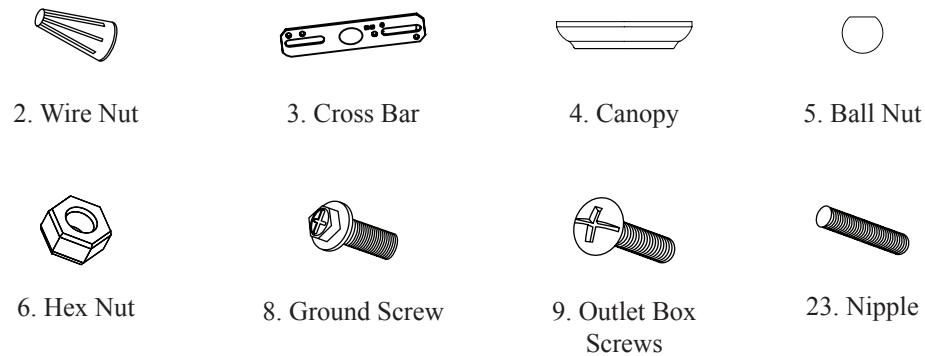

ASSEMBLY INSTRUCTIONS:

1. Screw the cross bar (3) to the junction box (1) with the outlet box screws (9). Hand tighten until snug.
2. Pliers are required for the next step. Thread one hex nut (6) onto the top end of the nipple (23).
3. Thread the nipple (23) into the center lock hole of the cross bar (3).
4. Using pliers, thread the hex nut (6) against the cross bar (3) and hand-tighten until snug.
5. Use wire nuts (2) (included) to connect the wires. Connect the house ground wire from the fixture ground wire. (Refer to Figure #1)
6. Connect the house white (or ribbed) wire to the fixture supply wire (black or smooth side). (Refer to Figure #1)
7. Connect the house black (or red) wire to the fixture supply wire (black or smooth side). (Refer to Figure #1)
8. Wrap each connection with approved electrical tape and carefully stuff all of the connected wires into the outlet box. (Refer to Figure #1)
9. Thread another hex nut (6) onto the bottom end of the nipple (23) and adjust to proper location for canopy (4) and ball nut (5).
10. Pass the canopy (4) over the end of the nipple (23) and secure with the ball nut (5). Hand-tighten until snug.

INSTALLATION:

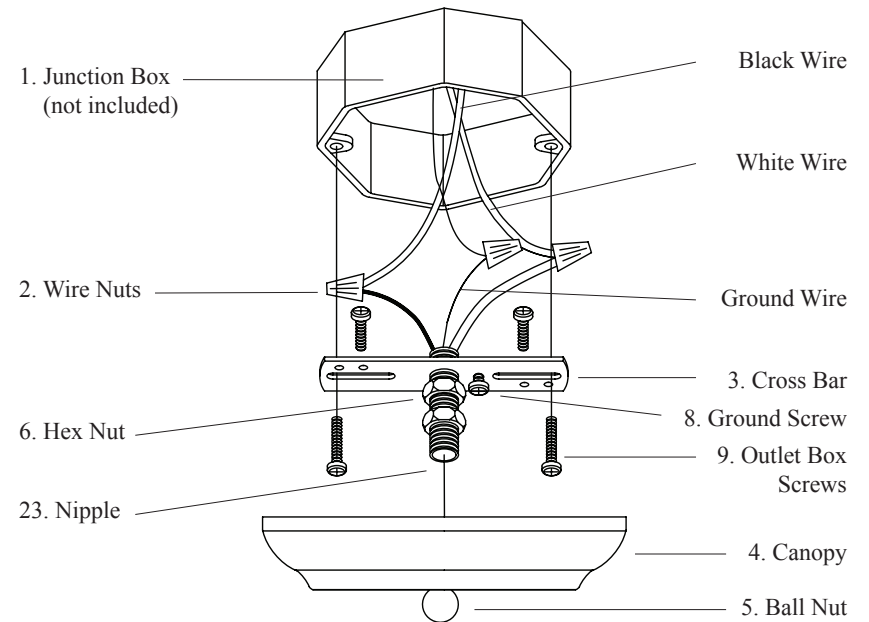

Figure #1

