



## Safety Information

# IMPORTANT SAFETY INSTRUCTIONS

When using electrical products, basic precautions should always be followed including the following:

- a) **READ AND FOLLOW ALL SAFETY INSTRUCTIONS.**
- b) This product is for indoor use only. The electrical rating 0.4 A 120 V 60 Hz.
- c) This seasonal use product is not intended for permanent installation or use.
- d) Do not mount or place near gas or electric heaters, fireplace, candles or other similar sources of heat.
- e) Do not secure the wiring of the product with staples or nails, or place on sharp hooks or nails.
- f) Do not let lamps rest on the supply cord or on any wire.
- g) Unplug the product when leaving the house, when retiring for the night, or if left unattended.
- h) This is an electric product – not a toy! To avoid risk of fire, burns personal injury and electric shock it should not be played with or placed where small children can reach it.
- i) Do not use this product for other than its intended use.
- j) Do not hang ornaments or other objects from cord, wire, or light string.
- k) Do not close doors or windows on the product or extension cords as this may damage the wire insulation.
- l) Do not cover the product with cloth, paper or any material not part of the product when in use.
- m) This product employs overload protection (fuse). A blown fuse indicates an overload or short-circuit situation. If the fuse blows, unplug the product from the outlet. Also unplug any additional strings or products that may be attached to the product. Replace the fuse as per the User Servicing Instructions (following product marking for proper fuse rating) and check the product. If the replacement fuse blows, a short-circuit may be present and the product should be discarded.
- n) This product is equipped with push-in type lamps. Do not twist lamps.
- o) This product has a polarized plug (one blade is wider than the other) as a feature to reduce the risk of electric shock. This plug will fit in a polarized outlet only one way. If the plug does not fit fully in the outlet, reverse the plug. If it still does not fit, contact a qualified electrician. Do not use with an extension cord unless plug can fully inserted. Do not alter or replace the plug.
- p) Read and follow all instructions that are on the product or provided with the product.

## q) SAVE THESE INSTRUCTIONS.

## Pre-Assembly

### Package Contents

Part	Description	Quantity
A	Tree top	1
B	Tree center	1
C	Tree bottom	1
D	Tree stand	1
E	Power supply cord with a foot pedal switch	1

## 7.5' Warm White/Multi LED Color Changing self Shape One Plug Tree

SKU# 1001302140

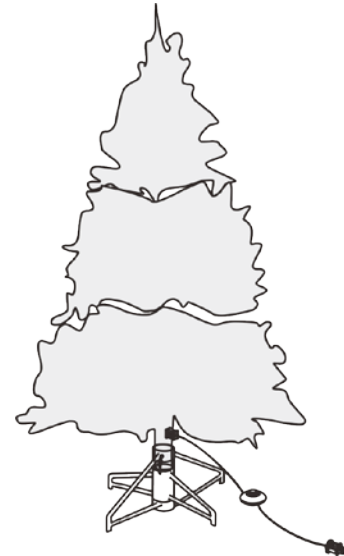

## Assembly

### Assembling the tree stand

- Step 1. Choose a location near a wall outlet.
- Step 2. Open the stand to a 90 degree angle until the hole lines up with the hole on the tube.
- Step 3. Screw an eye bolt into the hole.

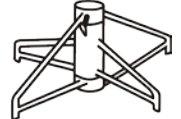
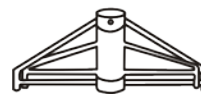

**CAUTION! – ALWAYS UNPLUG YOUR TREE FROM ITS POWER SOURCE BEFORE ASSEMBLING OR DISASSEMBLING.**

### Assembling the tree

- Please remove protective covers from the base of the pole for each tree section before assembling.
- Step 1. Insert tree bottom (C) into the tree stand (D) and tighten the screw. (See Fig. 1)
- Step 2. Insert tree center (B) into the tree bottom (C). (See Fig. 2)
- Step 3. Insert the tree top (A) into the tree center (B). (See Fig. 3)
- Step 4. Connect the end connector of power cord with foot pedal switch (E) with the connector found on the bottom section (C) in correct direction (always match the connection on the end connector of power cord to the concave on the connector found on the bottom section (C) according to the magnified drawing on Fig. 4).
- Step 5. Allow branches to fall into place or gently pull branches up and out. When adjusting branches be sure that all wires are free of branch hinges. (See Fig. 5)
- Step 6. Shape the branches. Starting with tips closest to the pole, shape one tip to the right, one to the left and one at the center of the main stem. Repeat pattern for each branch. (See Fig. 6)
- Step 7. Plug the well-connected power supply cord from the bottom section (C) into electrical outlet. Please note this tree comes with a foot pedal switch for changing functions. This tree is Color Changing, the 8 lighting options available are:
  - 1. Steady Warm White
  - 2. Flashing Warm White
  - 3. Slow Fade Warm White
  - 4. Steady Multicolor

5. Flashing Multicolor
6. Slow Fade Multicolor
7. Sequential Multicolor & Warm White
8. Slow Fade Multicolor & Warm White

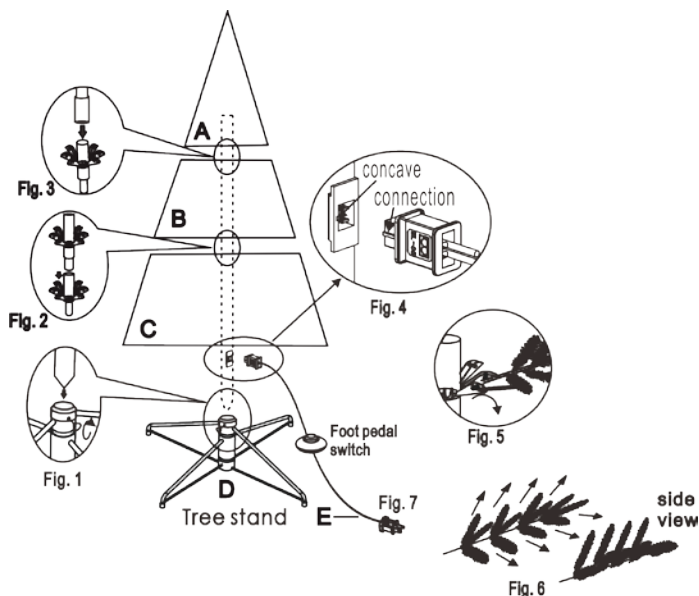

## Operation

### Turning on the tree

NOTE: If some bulbs do not light or flicker, search for any loose, broken bulbs and/or missing bulbs. Replace bulbs promptly with the replacement bulbs provided in order to maintain the performance and life expectancy of your tree.

Step 1. Connect each tree section well and plug the power cord into a wall outlet.

## Maintenance

### Fuse Replacement

A) Extension cord fuse replacement (1 replaceable 3 A, 125 V fuse is located in the plug):

Note: This plug will fit in a polarized outlet only one way. If the plug does not fit fully in the outlet, reverse the plug.

1. Grasp plug and remove from its power source.
2. Locate blown fuse by sliding access cover on top of plug towards prongs.
3. Remove blown fuse by turning the plug over. Fuses should fall into your hand (gentle tapping may be required).
4. Locate spare replacement fuse included in plug.
5. Insert spare replacement fuse. Close fuse cover by sliding fuse access cover towards the cord.

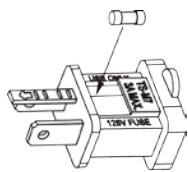

**CAUTION:** To reduce risk of fire – replace fuse in extension cord with only 3 A, 125 V fuse. Do not replace attachment plug. Discard product if the attachment plug is damaged.

### Replacing the bulbs

1. Grasp plug and remove from its power source.
2. Unlock the lamp lock on the socket of the bulb.
3. Pull bulb AND plastic base straight out of socket. Do not twist bulbs while you are removing them.
4. Replace burnt out bulb with 3.0 V, 0.06 W LED bulb ONLY. (Additional bulbs are included for your convenience.)
5. Relock the lamp lock on the socket of the bulb.

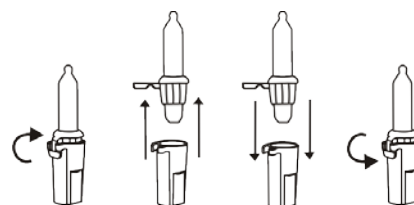

If the new lamp base does not fit in lampholder, follow these steps:

- Pull reflector out.
- Remove the base of the burned-out bulb by straightening the bulb leads, and gently pull bulb out.
- Thread leads of new bulb through holes in old base with one lead in each hole.
- After bulb is fully inserted into base, bend each lead up so that the leads will touch the contacts inside the bulb holder.
- Insert the reflector into the base.

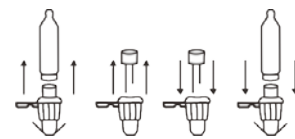

**CAUTION! — ALWAYS UNPLUG YOUR TREE FROM ITS POWER SOURCE BEFORE ATTEMPTING FUSE AND BULB REPLACEMENT.**

## Care and Cleaning

- Step 1. Remove all ornaments and decorations.
- Step 2. Unplug the plug cord from the wall outlet. And remove your power supply cord with an on/off foot pedal switch from bottom section (C) and save it.
- Step 3. Gently lift the tree top straight up to remove from the center section and fold all branches towards the pole.
- Step 4. Repeat this step for the center and bottom tree sections.
- Step 5. Carefully place all tree sections into a shipping box and tape it shut.
- Step 6. Store your tree in a cool, dry place away from sunlight.

## Troubleshooting

Problem	Solution
The tree does not light	Ensure that all tree sections are connected well into each other and that the tree is plugged into the wall outlet.
	Check for blown fuses at the power cord plug. Replace as needed with the replacement fuses provided.
	Check for loose, broken, or missing bulbs and replace as needed with the replacement bulbs provided.
	If you are still experiencing problems with the tree please call 1-877-527-0313 for instructions.

**Warning:** Please note that changes or modifications not expressly approved by the party responsible for compliance could void the user's authority to operate the equipment.

**NOTE:** This equipment has been tested and found to comply with the limits for a Class B digital device, pursuant to Part 15 of the FCC Rules. These limits are designed to provide reasonable protection against harmful interference in a residential installation. This equipment generates, uses and can radiate radio frequency energy and, if not installed and used in accordance with the instructions, may cause harmful interference to radio communications.

**However, there is no guarantee that interference will not occur in a particular installation. If this equipment does cause harmful interference to radio or television reception, which can be determined by turning the equipment off and on, the user is encouraged to try to correct the interference by one or more of the following measures:**

- Reorient or relocate the receiving antenna.**
- Increase the separation between the equipment and receiver.**
- Connect the equipment into an outlet on a circuit different from that to which the receiver is connected.**
- Consult the dealer or an experienced radio/TV technician for help.**

UL Model No. TME7.5-6(0.4)