



Fresh air in your house!



VK Series

For High Static Pressure Application

INLINE CENTRIFUGAL FANS



Please see performance table for Energy Star Rated Models

The VENTS VK Series duct mounted centrifugal inline fans are suitable for a wide range of residential and commercial exhaust or supply air applications, such as bathrooms, kitchens, restaurants or equipment cooling.

The VENTS VK inline fans assure efficient and reliable operation. The fans are fitted with backward curved centrifugal impeller driven by powerful sealed external rotor motor with lifelong bearings and thermal protection. This powerful combination enables the VENTS VK fans to deliver exceptional airflow performances even in high static pressure systems. The fans' casing is made of high quality, UV-resistant plastic (flame rating – 5VA). The VENTS VK fans are specially designed for simple installation and years of maintenance free operation. The VENTS VK fans are supplied with an easy to fit mounting bracket and can be mounted at any angle and at any point along the duct.

Applications

- Bathroom exhaust
- Kitchen ventilation
- Living area
- Whole house ventilation
- Duct boosting
- Workshops & smoking areas

Benefits

- Sizes available from 4" - 12^{3/8"})
- High static pressure applications
- Backward curved centrifugal impeller
- Quiet external rotor motor with thermal overload protection
- Ideal for long duct runs
- Quiet and powerful
- Vibration free operation
- Energy efficient
- Maintenance free
- Easy installation
- Corrosion resistant
- UV resistant, durable 5VA plastic
- Pre-wired and supplied with mounting bracket for easy installation
- ETL listed

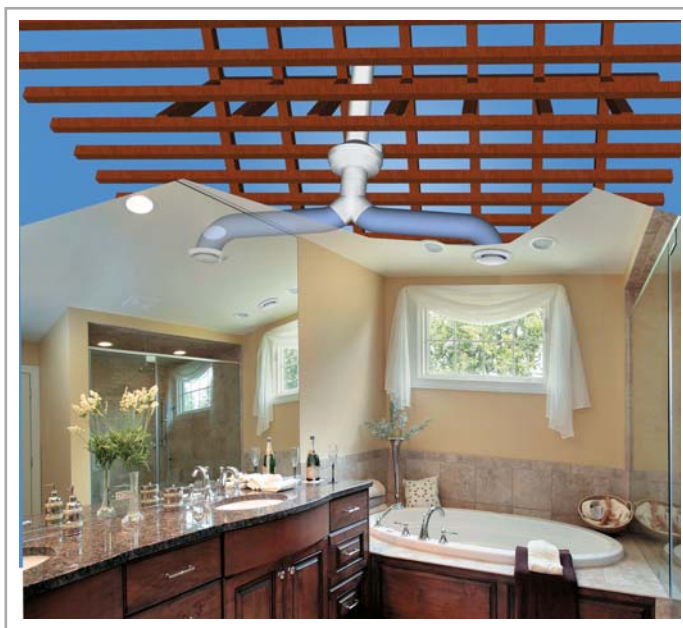

Tel: 888-640-0925
513-348-3853
Fax: 513-268-4597

Sales@ventsus.com
VentsUS.com
11013 Kenwood Road,
Cincinnati, Ohio 45242



Dimensions

Model	Measurements [in.]							lbs
	ØD	ØD1	B	L	L1	L2	L3	
VK 100	3 15/16"	9 13/16"	10 5/8"	9 1/16"	1 3/16"	1 1/16"	1 3/16"	4.7
VK 125	4 15/16"	9 13/16"	10 5/8"	8 11/16"	1 3/16"	1 1/16"	1 3/16"	4.9
VK 150	5 7/8"	11 13/16"	12 3/16"	11 1/4"	1 3/16"	1 3/16"	1 3/16"	5.7
VK 200	7 7/8"	13 3/8"	13 15/16"	10 7/8"	1 3/16"	1 3/16"	1 9/16"	8.8
VK 250	9 13/16"	13 3/8"	13 15/16"	10 7/16"	1 3/16"	1 3/16"	1 9/16"	9.9
VK 315	12 3/8"	15 3/4"	16 5/16"	16 5/16"	1 9/16"	2 3/16"	1 9/16"	11.2

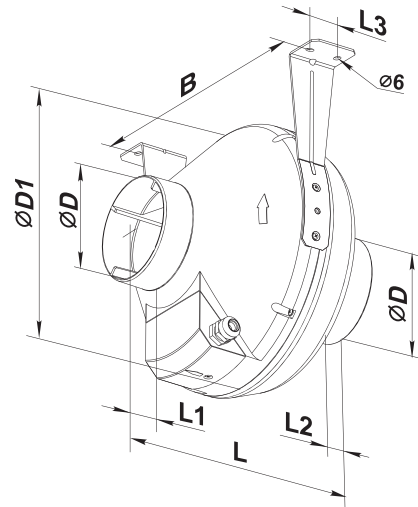

Performance

Model	Energy Star certified	Duct dia	Sones	RPM*	Watts*	CFM vs. Static Pressure (Ps) in WG										Volt / Hz
						0"	0.125"	0.2"	0.25"	0.375"	0.5"	0.75"	1.0"	1.25"	1.5"	
VK 100		4"	8.5	3088	106	162	155	150	147	141	134	120	104	87	67	120 / 60
VK 125		5"	7.1	2960	114	235	222	214	207	193	178	151	123	99	72	120 / 60
VK 150		6"	7.2	2907	113	317	300	289	282	265	247	212	178	132	68	120 / 60
VK 200	✓	8"	8.1	2650	142	583	560	544	532	497	462	390	320	255	196	120 / 60
VK 250		10"	10.2	2604	293	735	699	675	658	625	558	507	432	369	307	120 / 60
VK 315	✓	12 3/8"	11.5	2741	271	837	800	772	755	707	659	564	474	387	307	120 / 60

* The parameters RPM, Watts are indicated at 0.2 in WG static pressure.

Specification

Voltage: 120 V, 60 Hz

Motor: Single-phase external rotor motor with backward curved centrifugal impellers

Duct compatibility: Ø 4", 5", 6", 8", 10", 12 3/8"

Airflow capacity: up to 837 CFM

Sones: 7.1 – 11.5

Power consumption: 106 – 293 W

Suitable for working airstreams up to 122 °F

IPX4 protection

Thermal overload protection

Mounting bracket and power cord included

Five year warranty

Contacts

Tel: 888-640-0925

513-348-3853

Fax: 513-268-4597

Sales@ventsus.com

VentsUS.com

11013 Kenwood Road, Cincinnati, Ohio 45242

VENTS-US reserves the rights to modify any of its products features, designs, components, and specifications at any time and without notice to maintain the development and quality of manufactured goods.

