

Multipurpose EPS Insulation Panels

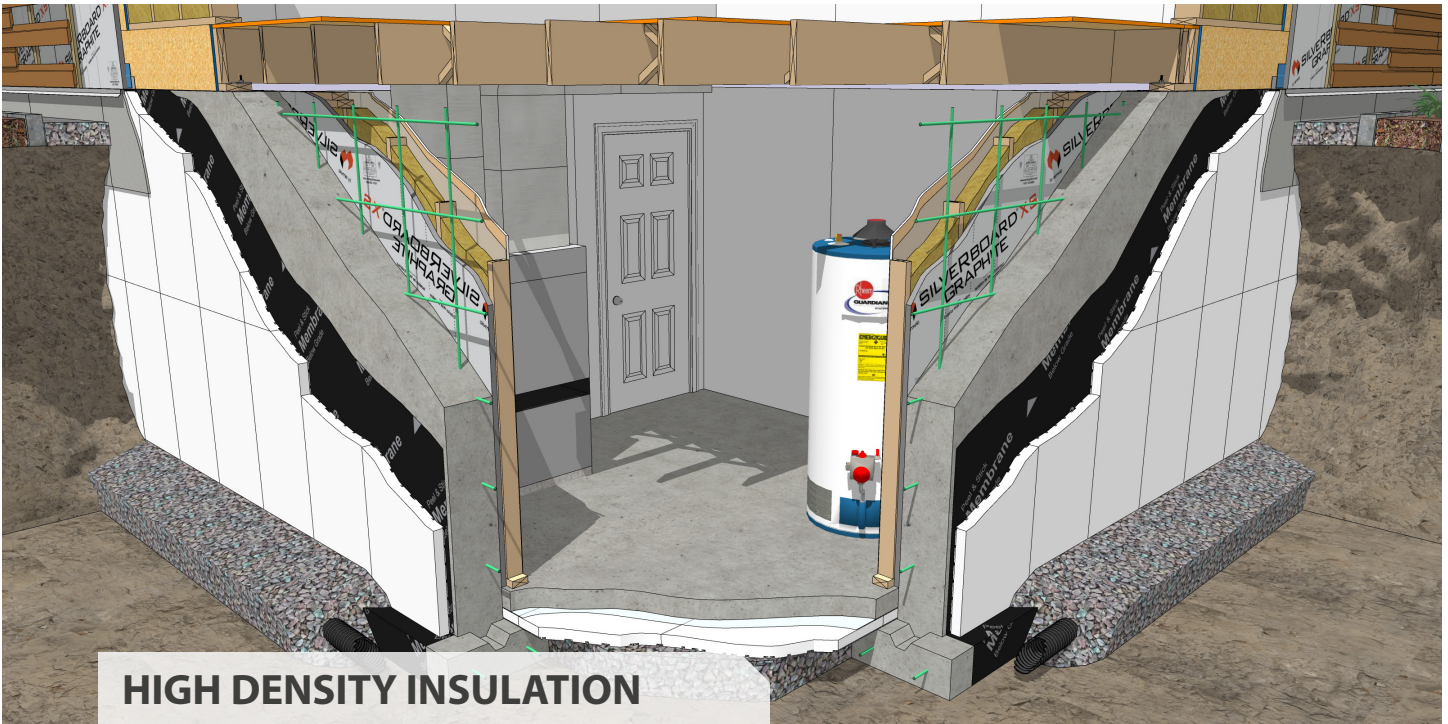

HIGH DENSITY INSULATION

Amvic's multipurpose rigid insulation is a Do-It-yourself (DIY) molded panel using closed cell Expanded Polystyrene (EPS) with one flat face. The second face of the panel has bi-directional channels that can be used as either venting or water drainage, depending on the application.

The combination of high density EPS and moisture management pattern offers a highly versatile product.

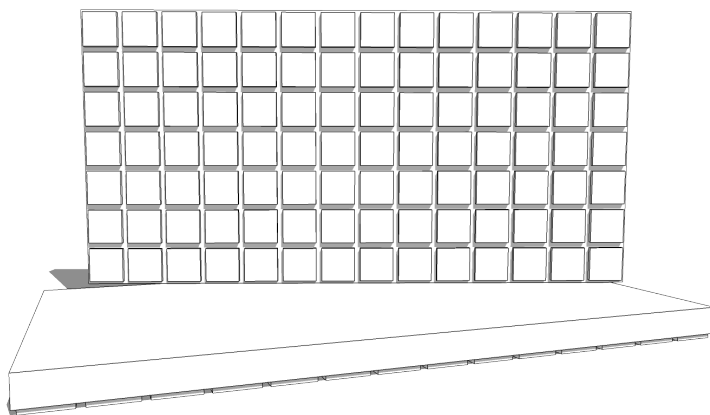

Amvic Advantage

- Suitable for use in both above and below grade applications in residential, commercial, agricultural and industrial construction.
- Exceptional Long-Term Thermal Resistance (LTTR) and increased R-Value in lower temperatures.
- High vapor permeance allowing wall assemblies to dry over time.
- No off-gassing and does not contain HFCs, CFCs or HCFCs.
- Each panel is easy to handle due to the low weight, smaller size and can be easily cut.
- Provides additional protection to the waterproofing during the backfill stage when used on exterior of foundation wall.
- Load capacity of panels is 3000 pounds per square foot.

Physical Properties Table

Specification for Rigid Polystyrene Insulation	CAN/ULC-S701 ASTM C578	Type 2 Type II
Thermal Resistance	ASTM C518 @ 75°F (24°C)	10 F.ft ² .hr/Btu (1.76 m ² K/W)
Compressive Strength	ASTM D1621	22 psi (152 kPa)
Water Absorption (Max.)	ASTM D2842	3%
Water Vapor Permeance	ASTM E96	1.47 US perm (84.1 ng/Pa.s.m ²)
Flexural Strength	ASTM C203	39.6 psi (273 kPa)
Dimensional Stability (Max.)	ASTM D2126	1.50%
Limiting Oxygen Index	ASTM D2863	>24.0%
Density		1.5 lb/ft ³ (22 kg/m ³)

Availability

Amvic's multipurpose EPS panels come in 2x4' (610x12919mm) sheet size and are 2-3/8" (60mm) thick.

Applications

- Interior of foundation walls
- Exterior of foundation walls
- Frost walls
- Exterior above grade walls
- Roofs

Warranty

Amvic supports building owners, designers and contractors by offering a 20-year, limited thermal warranty on Amvic's multipurpose EPS panels. This warranty is available to the building owner at the time the building is completed and is transferable to any subsequent owner during the 20-year period.

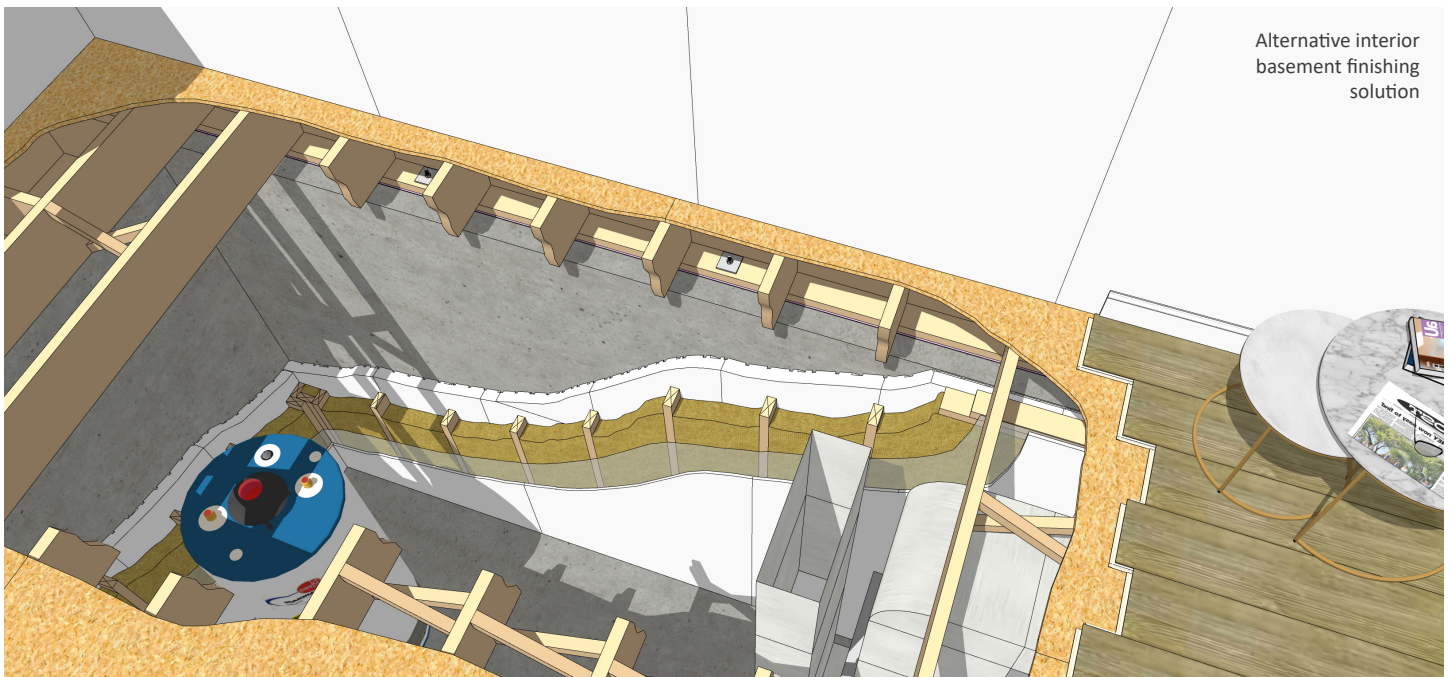

Below Grade Interior Installation

- Foam plastic (EPS) insulation is permitted in residential construction provided it is protected from the interior space by an approved thermal barrier such as 1/2" (13mm) gypsum (drywall) board, high density 2" (51mm) mineral wool or 5.5" (140mm) mineral wool batt insulation with 2x6 wood stud wall.

Below Grade Exterior Installation

- Once the water/damp proofing is installed and cured, starting at a corner, apply a quarter size spot of EPS compatible adhesive on the channeled side of the board, and attach the board so that the channels are placed in the vertical plane to the foundation wall.
- The top of the panel should be placed flush with the underside of the sill plate. Appropriate flashing details at this location are required.
- The bottom edge of the panel should have a 1/4" to 1/2" (6mm to 13mm) gap between the top of the footing to ensure proper drainage to the drainage system.

