



## Safety Information

**WARNING:** This is not a toy and is not intended for use by children.

(A) Do not mix old and new batteries.

(B) Do not mix alkaline, standard (carbon-zinc), or rechargeable (nickel-cadmium) batteries.

(C) Do not dispose of the battery in fire as the battery may leak and explode.

(D) Use type "AA" batteries.

(E) Remove used batteries promptly.

(F) Remove batteries from battery box of lights which is not to be used for an extended period of time.

For indoor use only.

## 11" B/O Warm White LED Wooden house

SKU# 1003182401



## Instruction of Battery box

Step 1: Carefully take the product out of the box.

Step 2: Please note there is a battery compartment on the bottom of the wooden house. Slide the cover according to the arrow and then open it. (See Fig. 1)

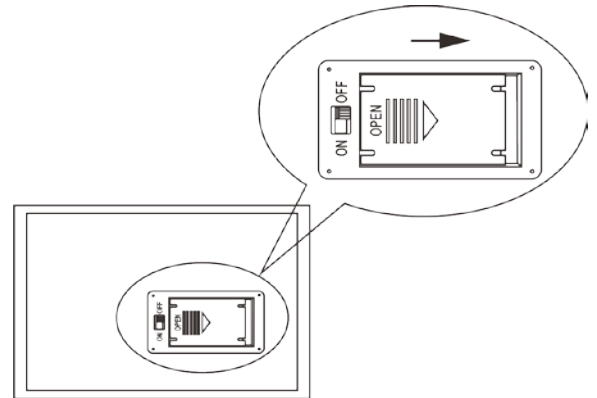

Fig. 1

Step 3: Place two new "AA" batteries (not included) into the holders according to the "+" and "-" directions as shown in magnified drawing in Fig. 2. Close the cover. Turn the switch to ON position.

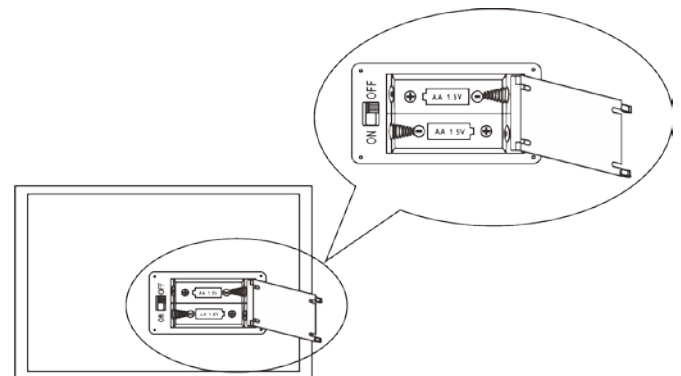

Fig. 2

Step 4: Turn the switch to "OFF" position when not in use to conserve battery life.